

WS-418 002

Department of Mines, Minerals and Energy
Division of Gas and Oil

Operations Name: B. R. Ringley VP2714
Permit #: 2609

Department of Mines, Minerals and Energy
Division of Gas and Oil
P. O. Box 1416
Abingdon, Virginia 24210
703/676-5423

COMPLETION REPORT

ENTERED



WELL TYPE: Oil Gas Coalbed Methane or Injection well

Date Well Completed: 6-3-94 Total Depth of Well: LTD=6120 DTD=6125

Attach the Drilling Report, if not previously submitted. In addition, submit any changes in casing or tubing that were approved after the Drilling Report was submitted.

STIMULATION RECORD

Zone 1: Berea Formation Stimulated With: 75 Q Foam
w/ 63000# 20/40 sand - 921320 SCF N₂ - 1941 BF
Perforated: 5846 TO 5967 No. of Perforations: 25 Perforation Size: .34"
Formation Broke Down at: Hydrostatic PSIG Average Injection Rate: 16.7 BPM (55 DH)
ISIP 1564 PSIG 5 MIN SIP 1251 PSIG Average Injection Pressure 3055 PSIG
Date Stimulated 6-3-94

Zone 2: _____ Formation Stimulated With: _____
Perforated: _____ TO _____ No. of Perforations: _____ Perforation Size: _____
Formation Broke Down at: _____ PSIG Average Injection Rate: _____
ISIP _____ PSIG _____ MIN SIP _____ PSIG Average Injection Pressure _____ PSIG
Date Stimulated _____

Zone 3: _____ Formation Stimulated With: _____
Perforated: _____ TO _____ No. of Perforations: _____ Perforation Size: _____
Formation Broke Down at: _____ PSIG Average Injection Rate: _____
ISIP _____ PSIG _____ MIN SIP _____ PSIG Average Injection Pressure _____ PSIG
Date Stimulated _____

FINAL PRODUCTION: _____ Natural After Stimulation
BOD MCFD HOURS TESTED ROCK PRESSURE HOURS TESTED
Zone (1) Berea 1328 6 635 4.75 days
Zone (2) _____
Zone (3) _____
Final Production if Gas Zones are Commingled _____ MCFD _____ Hours Tested _____ PSIG _____ Hours Tested

* Use additional sheets with this format, if more than three (3) zones were stimulated.

Permittee: EQUITABLE RESOURCES EXPLORATION (Company)

By: Susan Q Foster (Signature)

Department of Mines, Minerals and Energy
Division of Gas and Oil

Operations Name: B. R. Ringley VP2714
Permit #: 2609

Department of Mines, Minerals and Energy
Division of Gas and Oil
P. O. Box 1416
Abingdon, Virginia 24210
703/676-5423

DRILLING REPORT

Pursuant to VR-480-05-22.1, § 1.36, the undersigned Permittee submits this report on well VP2714 in the
Lipps District of the Wise County, Virginia on 19th day,
AUGUST month, 1994.

LOCATION

County: Wise District: Lipps
Surface Elevation: 2776.54 Elevation of Kelly Bushing: 2786.54 Quadrangle: Coeburn
14786 FT. S. of Latitude 37°00'00" and 10423 FT. W. of Longitude 82°22'30"

Attach a final location plot as required by VR 480-05-22.1, § 1.36.

DRILLING DATA

Date Drilling Commenced: 5-16-94 Drilling Contractor: Union Drilling
Date Drilling Completed: 5-27-94 Rig Type: X Rotary Cable Tool
Total Depth of Well: LTD=6120 DTD=6125

GEOLOGICAL DATA

Fresh Water at:	<u>71</u> Feet	<u>Damp</u>	SPM	<u>2050</u> Feet	<u>Damp</u>	SPM
	<u>251</u> Feet	<u>1/4" stream</u>	SPM	<u>2270</u> Feet	<u>1/4" stream</u>	SPM
Salt Water at:	Feet		GPM	Feet		GPM
	Feet		GPM	Feet		GPM

COAL SEAMS:

NAME	TOP	BOTTOM	THICKNESS	MINING IN AREA		
				YES	NO	MINED OUT
	<u>375</u>	<u>378</u>	<u>3</u>			
	<u>386</u>	<u>388</u>	<u>2</u>			
	<u>428</u>	<u>438</u>	<u>10</u>			<u>X</u>
	<u>2680</u>	<u>2684</u>	<u>4</u>			

GAS AND OIL SHOWS:

FORMATION	TOP	BOTTOM	THICKNESS	IPF (MCFD/BOPD)	PRESSURE	HOURS TESTED
		<u>4438</u>		<u>158 MCFD</u>		
		<u>4501/4596/5869</u>		<u>60 MCFD</u>		
		<u>6024</u>		<u>84 MCFD</u>		
		<u>6125</u>		<u>133 MCFD</u>		

Department of Mines, Minerals and Energy
Division of Gas and Oil

Operations Name: B. R. Ringley VP2714
Permit #: 2609

Cuttings or samples are X are not ___ available for examination by a member of the Virginia Division of Mineral Resources
Cuttings or samples have ___ have not X been furnished to the Virginia Division of Mineral Resources

ELECTRIC LOGS AND SURVEYS

List logs run on wellbore: GR/CDL/SNL/DIL/TLT (Conventional)
GR/SLD/TLT (Coals)*

Did log disclose vertical location of a coal seam? Yes X* No ___

SURVEY RESULTS

DEPTH OF SURVEY	DIRECTION/DISTANCE/DEGREES FROM TRUE VERTICAL	DEPTH OF SURVEY	DIRECTION/DISTANCE/DEGREES FROM TRUE VERTICAL
250	1°	1600	1°
380	1°	1800	1 1/2°
403	1°	2000	1°
600	1°	2200	1°
800	1°	2400	1°
1000	1 1/4°	2600	1°
1200	1/2°	2682	1°
1400	1°	2800	1/2°

CASING AND TUBING

	SIZE	TOP	BOTTOM	LENGTH	CEMENT USED (IN CU/FT)	DATE CEMENTED	PACKERS OR BRIDGE PLUGS KIND SIZE SET AT
<u>Conductor</u>	16"		22'				
<u>Surface</u>	11 3/4"		483'	473'	250(295)	5-18-94	
<u>Water Protection</u>	8 5/8"		2923'	2913'	548(883)	5-23-94	
<u>Coal Protection</u>							
<u>Other Casing and Tubing Left in Well</u>	4 1/2" 2 3/8"		6075' 5922'	6065'	300(432)	5-27-94	

Liners

REMARKS: Shut down, fishing jobs, depths and dates, caving, lost circulation, etc.

Department of Mines, Minerals and Energy
Division of Gas and Oil

Operations Name: B. R. Ringley VP2714
Permit #: 2609

DRILLER'S LOG

Compiled by Geology

GEOLOGIC AGE	FORMATION	GENERAL LITHOLOGY	COLOR	DEPTH		THICKNESS	REMARKS
				TOP	BOTTOM		
Pennsylvanian	Wise & Norton FM			0	1600	1600	
	Lee FM			1600	2545	945	
	Pocahontas			2545	2940	395	
	Sand & Shale			2940	3430	490	
Mississippian	Ravencliff			3430	3602	172	
	Avis			3602	3658	56	
	Sand & Shale			3658	4152	494	
	Maxon Sands			4152	4244	92	
	Sand & Shale			4244	4512	268	
	Little Lime			4512	4582	70	
	Big Lime			4582	5272	690	
	Weir			5272	5758	486	
	Coffee Shale			5758	5838	80	
	Berea			5838	5970	132	
Devonian	Shale			5970	6121	151	
	Logger's Total Depth				6121		

Permitted: EQUITABLE RESOURCES EXPLORATION (Company)

By: Susan A. Foster (Signature)

10,423'

LATITUDE: 37°00'00"

LONGITUDE: 82°22'30"

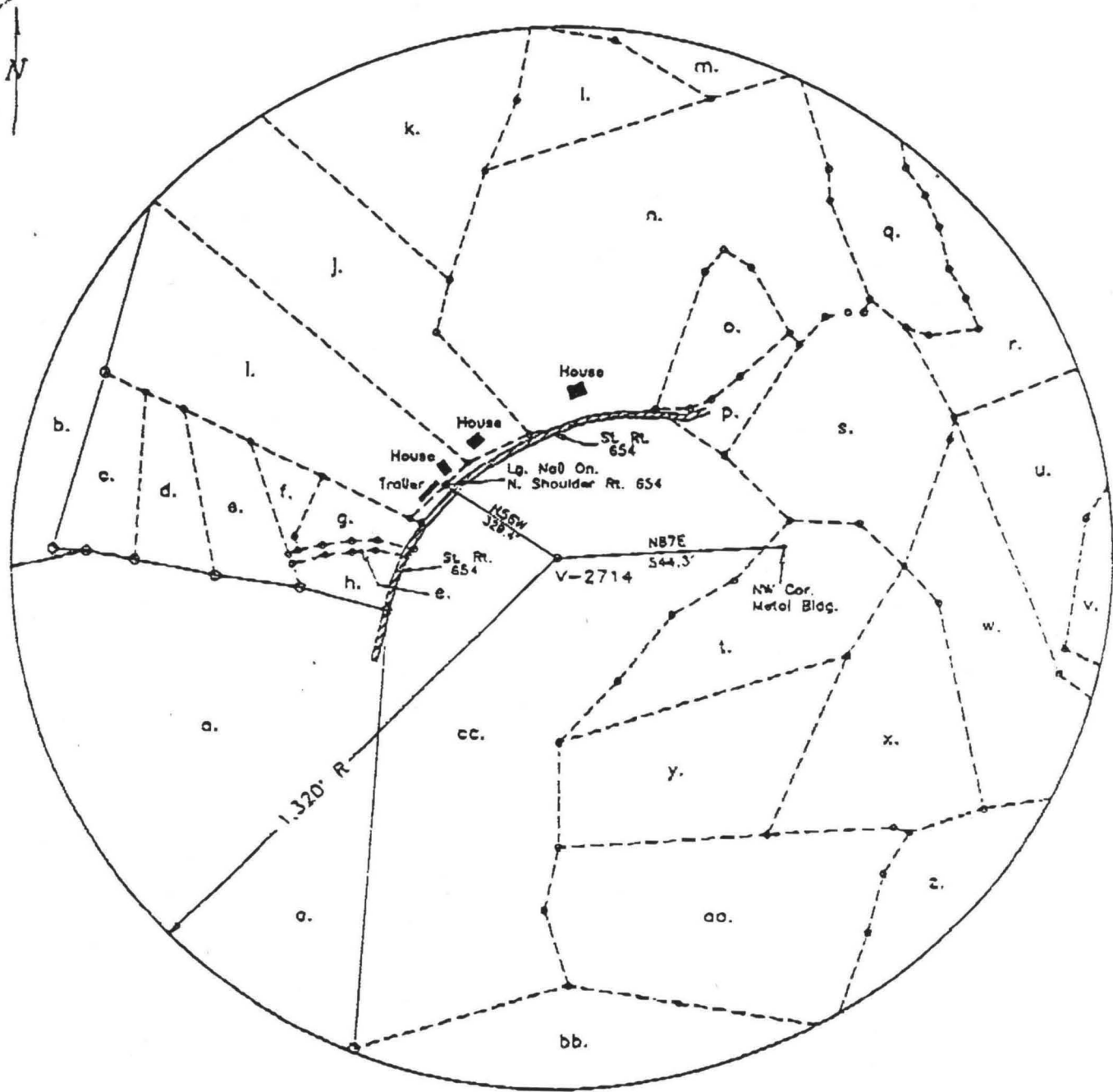

AREA OF WELL UNIT = 125.66 AC.
 Well Elevation Determined By
 Trigometric Leveling from MCC Survey Mark No. TC-77.1

Well Coordinates (VA State Plane)
 N251597.54 E857676.37

WELL LOCATION MAP

COMPANY EQUITABLE RESOURCES EXPLORATION WELL NAME AND NUMBER V-2714
 TRACT NO. WI-211 ELEVATION 2776.54 QUADRANGLE COBURN
 COUNTY WISE DISTRICT LIPPS SCALE 1"=400' DATE 8-19-93
 This plot is a new plot X; an updated plot _____; or a final plot _____
 + Denotes the location of a well on United States topographic Maps, scale 1"=24,000, latitude and longitude lines being represented by border lines shown.

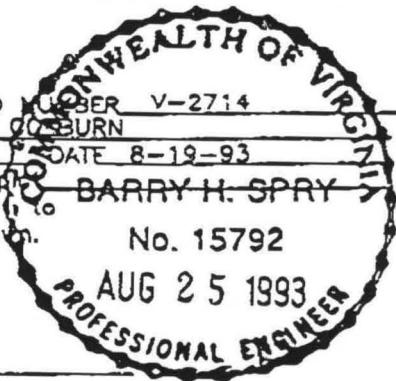

Barry H. Spry
 Licensed Professional Engineer or Licensed Land Surveyor