

COMMONWEALTH OF VIRGINIA
 DEPARTMENT OF CONSERVATION AND ECONOMIC DEVELOPMENT
 DIVISION OF MINERAL RESOURCES
 Box 3667, University Station, Charlottesville, Virginia

WWCR# 179
 VDMR# 545

WATER WELL COMPLETION REPORT

OWNER: U.S. Forest Service Mailing Address: P.O. Bldg. Harrisonburg, Va.
~~XXXX~~ Little Fort Recreation Area Mailing Address: _____
 DRILLER: Valley Drilling Corp. Mailing Address: Clearbrook, Va.
 WELL LOCATION: County Shenandoah Approx. 1 miles X
East (direction) of Powells Mountain and _____ ft miles of _____

(Give direction and distance in feet or tenths of mile from two reference points - roads, towns, rivers, etc. - on county highway or other map.)

WATER CONDITIONS

DEPTH
 STATIC WATER LEVEL 21'6"
 WATER ZONES (fissures or formations supplying water)
 (from) (to) (from) (to)
82' ft. _____ ft.
 QUANTITY OF WATER
 WELL PUMPED (or bailed) at 19.5 Gal. per Min. with
? feet DRAWDOWN after 2 HOURS PUMPING.
 FLOW (natural) 19.5 G.P.M. HEAD _____ ft. (above ground)
 REMARKS: Pumped by compressed air

QUALITY OF WATER

COLOR Clear TASTE None
 ODOR None OTHER ---
 ANALYSIS: AVAILABLE - Yes No ATTACHED Yes No
 TEMPERATURE _____
 WATER _____ (from) _____ (to) _____ ft. ft.
 (salt, brackish, iron, sulfur, acid, other)
 USE OF WATER: Domestic Town Industry Farm Public

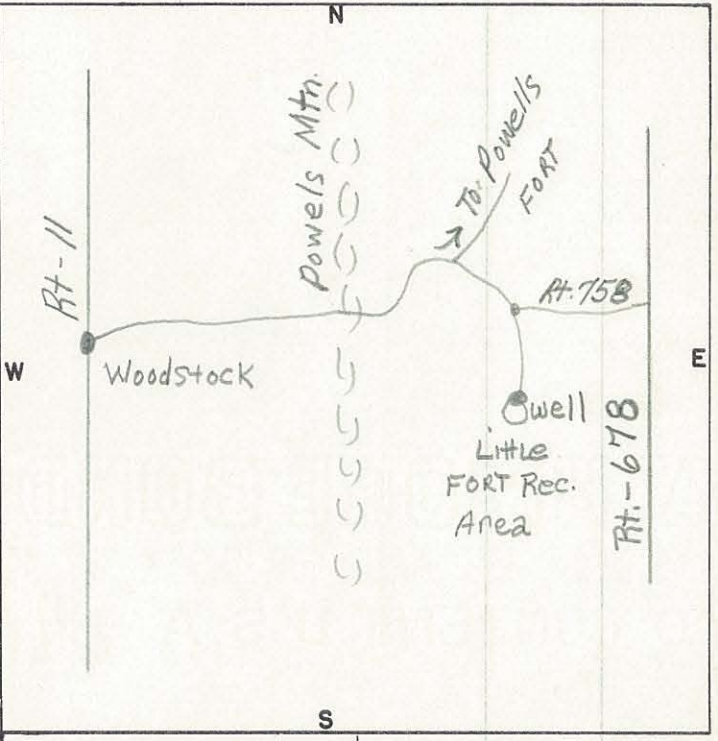

CONSTRUCTION

RIG TYPE (or method) Rotary drill
 (rotary, cable, bored, driven, etc...)
 DATE: Started Jan. 9, 1961 completed 3/10/61
 TOTAL DEPTH 88'10" ft.
 BEDROCK at 30 ft.

| HOLE SIZE | | | CASING SIZE | | |
|-----------|--------|--------|-------------|--------|------|
| (diam) | (from) | (to) | (diam) | (from) | (to) |
| 9" | 0 | 50 | 6" | 0 | 50 |
| 5 | 50 | 88'10" | | | |

SCREEN (or perforations)
 (diam.) (from) (to) (opening size)
 _____ in _____ ft. _____ ft. _____

GROUTING INFORMATION

METHOD USED Hand poured
 GROUTING MATERIAL Cement & Water
 DEPTH OF GROUTING 50

PUMP (installed)

TYPE _____ Cap. (gpm) _____
 H.P. _____ Depth of intake _____ ft.

REMARKS: Completion delayed because of inclement weather
Geol. - Onendaga Shale (RHD)

Log of well (over)

COMMONWEALTH OF VIRGINIA
 DEPARTMENT OF CONSERVATION AND ECONOMIC DEVELOPMENT
 DIVISION OF MINERAL RESOURCES

Box 3667, University Station, Charlottesville, Virginia

179
 W-545

WATER WELL COMPLETION REPORT

OWNER: U.S. Forest Service Mailing Address: P.O. Bldg. Harrisonburg, Va.
 TENANT: Little Fort Recreation Area Mailing Address: _____
 DRILLER: Valley Drilling Corporation Mailing Address: Clearbrook Virginia
 WELL LOCATION: County Shenandoah Approx. 1 miles
East of (direction) of Powells Mountain and _____ ft miles of _____

WATER CONDITIONS
 DEPTH
 STATIC WATER LEVEL 21'-6"
 WATER ZONES (fissures or formations supplying water)
 (from) (to) (from) (to)
82' ft. _____, _____ ft.
 _____ ft. _____, _____ ft.
 QUANTITY OF WATER
 WELL PUMPED (or bailed) at 19.5 Gal. per Min. with
2 feet DRAWDOWN after 2 HOURS PUMPING.
 FLOW (natural) 19.5 G.P.M. HEAD _____ ft. (above ground)
 REMARKS: Pumped by Compressed Air

QUALITY OF WATER
 COLOR Clear TASTE None
 ODOR None OTHER _____
 ANALYSIS: AVAILABLE— Yes No ATTACHED Yes No
 TEMPERATURE _____
 WATER (from) _____ ft. (to) _____ ft.
 (salt, brackish, iron, sulfur, acid, other)
 USE OF WATER: Domestic Town Industry Farm Public

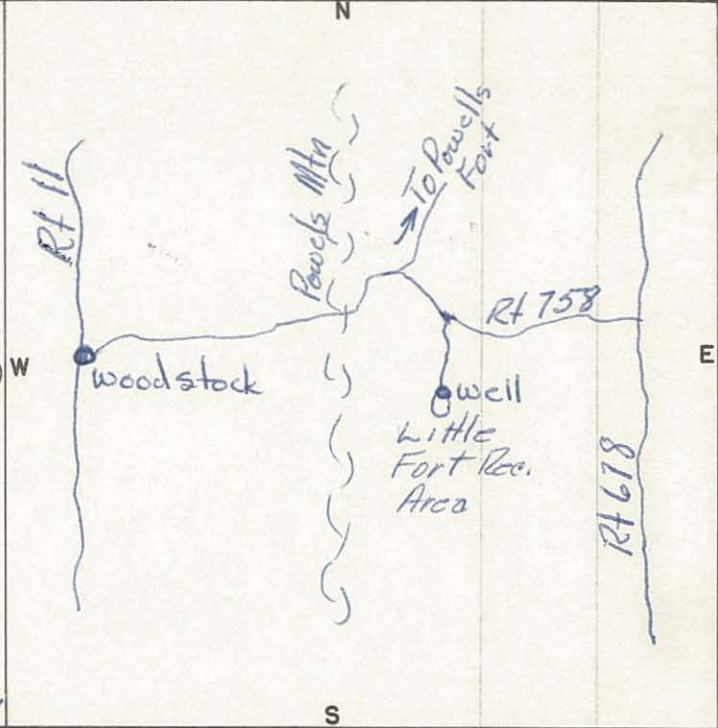

CONSTRUCTION
 RIG TYPE (or method) Rotary Drill
 (rotary, cable, bored, driven, etc...)
 DATE: Started Jan 19, 1961 Completed 3-10-61
 TOTAL DEPTH 88'-10" ft.
 BEDROCK at 30' ft.

| HOLE SIZE | | | CASING SIZE | | |
|-----------|--------|--------|-------------|--------|------|
| (diam) | (from) | (to) | (diam) | (from) | (to) |
| 9" | 0 | 50 | 6" | 0 | 50' |
| 5" | 50 | 88'40" | | | |

SCREEN (or perforations)
 (diam.) (from) (to) (opening size)
 _____ in _____ ft _____ ft _____

GROUTING INFORMATION
 METHOD USED Hand poured
 GROUTING MATERIAL Cement & Water
 DEPTH OF GROUTING 50'

PUMP (installed)
 TYPE _____ Cap. (gpm) _____
 H.P. _____ Depth of intake _____ ft.

REMARKS: Completion delayed because of inclement weather.
Shed - Sandoga Shale (RHR)

Log of well (over)

FURNISHED BY U.S. Forest Service

DATE: 3-13-61

| DEPTH (feet) | | TYPE OF SOIL OR ROCK PENETRATED (gravel, clay, etc., hardness, color, etc) | REMARKS (water, caving, shot, screen, sample, etc) |
|--------------|---------|--|---|
| FROM | TO | | |
| 0 | 30 | Sand & loam yellow to grey | no surface water |
| 30 | 88'-10" | Slate (Dark Grey) | Water first struck at 82' |
| | | <p>WATER CONDITIONS</p> <p>DEPTH _____</p> <p>STATIC WATER LEVEL _____</p> <p>WATER ZONES (pressures or formations supplying water) _____</p> <p>QUANTITY OF WATER _____</p> <p>WELL PUMPED (or bailed) of _____ gal per min with _____ feet drawdown after _____ hours pumping.</p> <p>FLOW (natural) _____ G.P.M. HEAD _____ ft (above ground)</p> <p>REMARKS: _____</p> <p>QUALITY OF WATER</p> <p>COLOR _____</p> <p>TASTE _____</p> <p>ODOR _____</p> <p>ANALYSIS AVAILABLE - Yes <input type="checkbox"/> No <input checked="" type="checkbox"/> ATTACHED YEAR _____</p> <p>TEMPERATURE _____</p> <p>WATER _____</p> <p>USE OF WATER: Domestic <input type="checkbox"/> Town <input type="checkbox"/> Industrial <input type="checkbox"/> Farm <input type="checkbox"/> Public <input type="checkbox"/> _____</p> | |
| | | <p>CONSTRUCTION</p> <p>RIG TYPE (or method) _____</p> <p>DATE: Started _____ Completed _____</p> <p>TOTAL DEPTH _____</p> <p>BEDROCK at _____</p> <p>GRouting INFORMATION</p> <p>METHOD USED _____</p> <p>GRouting MATERIAL _____</p> <p>DEPTH OF GRouting _____</p> <p>REMARKS: _____</p> | |
| | | <p>PUMP (installed) _____</p> <p>TYPE _____</p> <p>Cap (gpm) _____</p> <p>H.P. _____</p> <p>Depth of intake _____</p> | |
| | | <p>CASING SIZE</p> <p>HOLE SIZE</p> <p>SCREEN (or perforations)</p> | |

