

INTERVAL SHEET

Page 1

VDMR WELL NO. 403

Sample Interval: from 10 to 420

PROP: A. Yurgaitis

Total Depth 455

COMP: Hugo Stribling

Oil Gas Water Exploratory

COUNTY: Fauquier
Bethel Academy Subdivision

Cuttings Core Other

From-To	From-To	From-To	From-To	From-To
10-	300 - 310	-	-	-
10- 20	310 - 320	-	-	-
20- 30	320 - 330	-	-	-
30- 40	330 - 340	-	-	-
40- 50	340 - 350	-	-	-
50- 60	350 - 360	-	-	-
60- 70	360 - 370	-	-	-
70- 80	370 - 380	-	-	-
80- 90	380 - 390	-	-	-
90- <u>100</u>	390 - <u>400</u>	-	-	-
100- 110	400 - 410	-	-	-
110- 120	410 - 420	-	-	-
120- 130	-	-	-	-
130- 140	-	-	-	-
140- 150	-	-	-	-
150- 160	-	-	-	-
160- 170	-	-	-	-
170- 180	-	-	-	-
180- 190	-	-	-	-
190- <u>200</u>	-	-	-	-
200- 210	-	-	-	-
210- 220	-	-	-	-
220- 230	-	-	-	-
230- 240	-	-	-	-
240- 250	-	-	-	-
250- 260	-	-	-	-
260- 270	-	-	-	-
270- 280	-	-	-	-
280- 290	-	-	-	-
290- <u>300</u>	-	-	-	-

Washed Samples

Complete set of sample intervals

COMMONWEALTH OF VIRGINIA
DEPARTMENT OF CONSERVATION AND ECONOMIC DEVELOPMENT
DIVISION OF MINERAL RESOURCES

Box 3667, University Station, Charlottesville, Virginia

WWCR-#49
VDMR-#403

WATER WELL COMPLETION REPORT

OWNER: A. Yurgartio (developer) Mailing Address: The Plains, Va.
 TENANT: New Bethel Subdivision Mailing Address: Warrenton, Va.
 DRILLER: Hugo Stribling Mailing Address: Morrisville, Va.
 WELL LOCATION: County Fauquier Approx. 2.3 ^{XX} miles
N (direction) of Warrenton and 0.9 ft miles N.E. of junction of state rts. 628 & 17
(Give direction and distance in feet or tenths of mile from two reference points - roads, towns, rivers, etc. - on county highway or other map.)

WATER CONDITIONS

DEPTH

STATIC WATER LEVEL 40.29'
 WATER ZONES (fissures or formations supplying water)
 (from) (to) (from) (to)
 _____ ft. _____, _____ ft. _____
 _____ ft. _____, _____ ft. _____

QUANTITY OF WATER

WELL PUMPED (or bailed) at * Gal. per Min. with
 _____ feet DRAWDOWN after _____ HOURS PUMPING.
 FLOW (natural) _____ G.P.M. HEAD _____ ft. (above ground)
 REMARKS: *approx. 25-30 gpm-test by air

QUALITY OF WATER

COLOR _____ TASTE _____
 ODOR _____ OTHER _____
 ANALYSIS: AVAILABLE - Yes No ATTACHED Yes No
 TEMPERATURE 54°F
 _____ WATER (from) _____ ft. (to) _____ ft.
(salt, brackish, iron, sulfur, acid, other)

USE OF WATER: Domestic Town Industry Farm Public

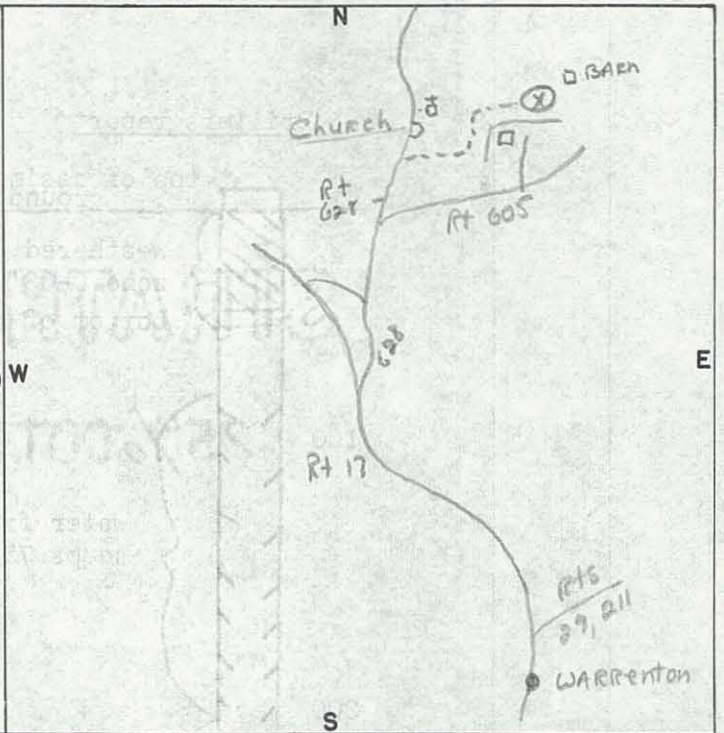

CONSTRUCTION

RIG TYPE (or method) (Air)
(rotary, cable, bored, driven, etc..)
 DATE: Started _____; Completed 3/17/60
 TOTAL DEPTH 455 ft.
 BEDROCK at approx. 63' ft.

GROUTING INFORMATION

METHOD USED _____
 GROUTING MATERIAL _____
 DEPTH OF GROUTING _____

HOLE SIZE

(diam) (from) (to) ft
6 in 0 455 ft

CASING SIZE

(diam) (from) (to) ft
6 in 0 65' ft

SCREEN (or perforations)

(diam) (from) (to) ft (opening size)

PUMP (installed)

TYPE _____ Cap. (gpm) _____
 H.P. _____ Depth of intake _____ ft.

REMARKS: Well found bridged at 67' on 3/21/60-cleared by driller 4/1/60
(X) Driller reports "main flow" at 300'
Well cuttings in repository #403 (Catoctin Formation)
Source of information: Elec. log & owner (RHD)

LOG

FURNISHED BY _____

DATE: _____

DEPTH (feet)		TYPE OF SOIL OR ROCK PENETRATED (gravel, clay, etc., hardness, color, etc)	REMARKS (water, caving, shot, screen, sample, etc)
FROM	TO		
<p><u>Drillers report</u></p> <p style="margin-left: 40px;">top of casing ground surface-590' el.</p> <p style="margin-left: 40px;">50 weathered zone 0-63' bottom of casing-65'</p> <p style="margin-left: 40px;">100</p> <p style="margin-left: 40px;">300 water from numerous seeps 75-300'</p> <p style="margin-left: 40px;">400 no more water 300-455'</p> <p style="margin-left: 40px;">455 very hard drilling 400-455'</p>			