



Commonwealth of Virginia
Department of Mines, Minerals, and Energy
Division of Gas and Oil
P.O. Box 1416; Abingdon, VA 24212
Telephone: (276) 676-5423

Tracking Number: 59
Company: CNX Gas Company LLC
File Number: RU-0387
Operations Name: CBM BL112 W/PL
Operation Type: Coalbed/Pipeline
Drilling Report Type: Original

DRILLING REPORT (DGO-GO-14)

1. Drilling Data

Date drilling commenced: 8/11/2006 Drilling Contractor: NOAH HORN
Date drilling completed: 8/16/2006 Rig Type: Rotary Cable Tool
Driller's Total Depth (feet): 2,575
Log Total Depth (feet): 2,561 Coal Seam At Total Depth Pocahontas

2. Final Location Plat (as required by 4 VAC25-150-360.C.)

Permitted State Plane X: 986,582 Final Plat State Plane X: 986,577
Permitted State Plane Y: 280,887 Final Plat State Plane Y: 280,886

Plat Previously Submitted Or...

List of Attached Items:

Description	FileName
BL112	BL112 FINAL PLAT.pdf

3. Geological Data

Fresh Water At:

Depth (in feet)	Rate	Unit of Measure
120	DAMP	

Salt Water At:

Depth (in feet)	Rate	Unit of Measure
-----------------	------	-----------------

Coal Seams

List of Attached Items:

Description	FileName
BL112	BL112 EXHIBIT A.pdf

Gas and Oil Shows

List of Attached Items:

Description	FileName
BL112	BL112 GAS SHOW.jpg

4. Electric Logs (As required by 4VAC25-150-280.A.)

List all logs run: DENSITY,GAMMA,CALIPER,TEMP,DEVIATION

Did logs disclose vertical locations of a coal seam? Yes No

5. Survey Results (As required by 4VAC25-150-280.B.2)

List of Attached Items:

Description	FileName
BL112	BL112 DEVIATION LOG.pdf

6. Casing and Tubing Program

List of Attached Items:

Description	FileName
BL112	BL112 CASING.jpg

7. Remarks

Use this space to note any conditions or occurrences, such as lost circulation, fishing jobs, junk left in hole, sidetracks, squeeze jobs, etc., not shown above. Include data and depth of condition/occurrence.

8. Drillers Log

Compiled By: _____

List of Attached Items:

Description	FileName
BL112	BL112 DRILLERS LOG.pdf

9. Comments

10. Signature

Permitee: CNX Gas Company LLC Date: 11/29/2006 (Company)

Signed By: LESLIE ARRINGTON Title: MANAGER (Signature)

INTERNAL USE ONLY

Submit Date: 11/29/2006

Status: Inspr Approved

Date: 11/30/2006

Final PDF Date: 1/31/2007

7/25
9/29/06

← 4,430' →

LATITUDE: 37° 05' 00"

BEARING BASIS:
VIRGINIA STATE PLANE - SOUTH ZONE - NAD'27

LONGITUDE: 81° 57' 30"

10,830'

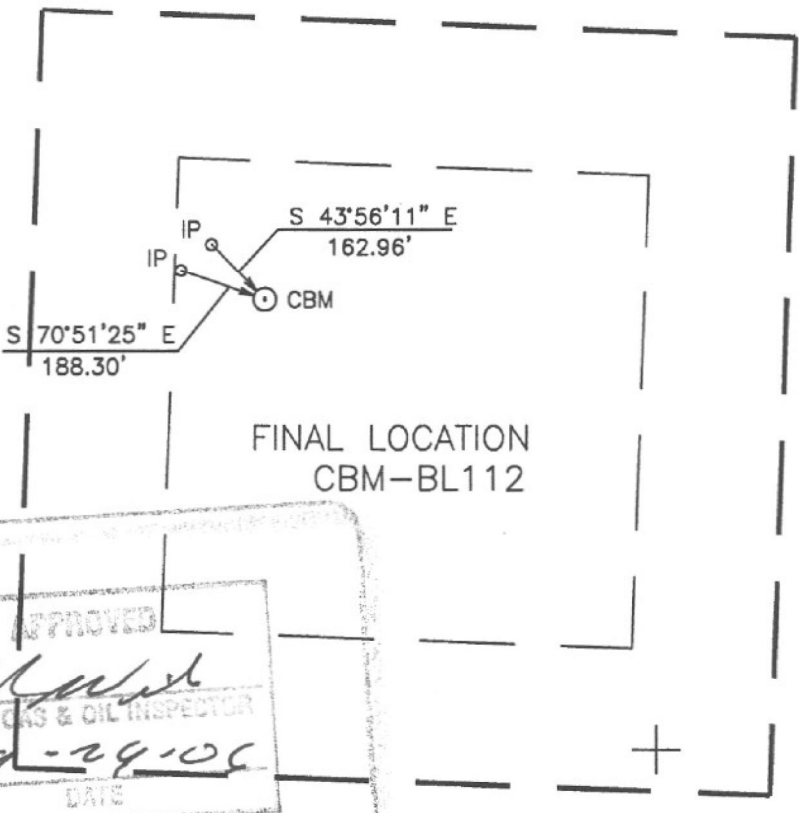

FINAL LOCATION
CBM-BL112

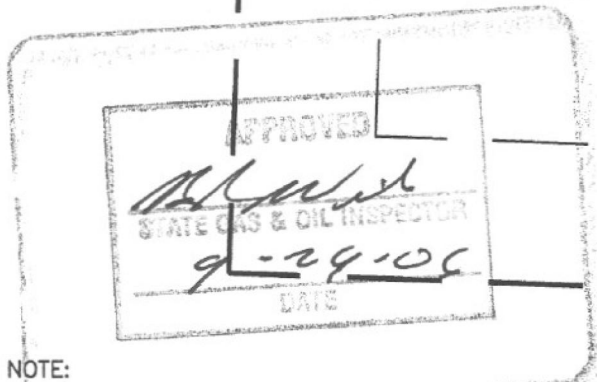

NOTE:
THIS WELL WAS DRILLED WITHIN 10 FT. OF PROPOSED LOCATION
ACCORDING TO 4 VAC 25-150-290 AND 45.1-361.30.

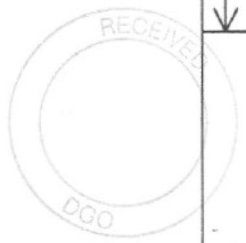

WELL LOCATION PLAT

BL112FNL
PGP27/72-0601/17

COMPANY CNX GAS COMPANY, LLC. WELL NAME OR NUMBER CBM-BL112

TRACT NUMBER GENT ROYALTY PARTNERS, LLC QUADRANGLE HONAKER

DISTRICT: NEW GARDEN

WELL COORDINATES (VIRGINIA STATE PLANE): STATE PLANE: N 280,885.55 E 986,577.17

ELEVATION: 2339.46' METHOD USED TO DETERMINE ELEVATION: BY TRIG. LEVELS FROM CONSOL. INC. BM'S

COUNTY RUSSELL Scale: 1" = 400' Date 08-25-06

THIS PLAT IS A NEW PLAT _____; AN UPDATED PLAT _____; OR A FINAL LOCATION PLAT X

+ Denotes the location of a well on United States Topographic Maps, scale to 24,000 latitude and longitude lines being represented by border lines as shown (Optional)

Licensed Professional Engineer or Licensed Land Surveyor (Affix Seal)

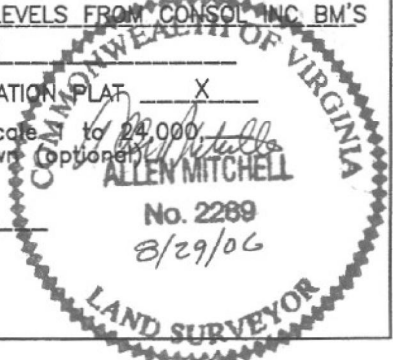

Exhibit A

Well Name: CBM-BL112

SURFACE ELEV: 2339.46 EASTING: 986577.17 NORTHING: 280885.55

SEAM	DEPTH FROM (FT)	DEPTH TO (FT)	ELEVATION (TOSE)	THK. (FT)	REMARKS
	1.00	80.00	2338.46	79.00	
COAL	80.00	82.30	2259.46	2.30	
	82.30	240.00	2257.16	157.70	
COAL	240.00	240.30	2099.46	0.30	
	240.30	261.80	2099.16	21.50	
COAL	261.80	262.00	2077.66	0.20	
	262.00	318.80	2077.46	56.80	
COAL	318.80	320.00	2020.66	1.20	
	320.00	419.50	2019.46	99.50	
COAL	419.50	421.70	1919.96	2.20	
	421.70	476.40	1917.76	54.70	
COAL	476.40	476.60	1863.06	0.20	
	476.60	498.40	1862.86	21.80	
COAL	498.40	498.90	1841.06	0.50	
	498.90	578.50	1840.56	79.60	
COAL	578.50	580.80	1760.96	2.30	
	580.80	689.60	1758.66	108.80	
COAL	689.60	693.00	1649.86	3.40	
	693.00	718.40	1646.46	25.40	
COAL	718.40	719.50	1621.06	1.10	
	719.50	725.90	1619.96	6.40	
COAL	725.90	726.10	1613.56	0.20	
	726.10	846.60	1613.36	120.50	
*COAL	846.60	846.80	1492.86	0.20	
	846.80	914.00	1492.66	67.20	
*COAL	914.00	915.00	1425.46	1.00	
	915.00	1048.70	1424.46	133.70	
*COAL	1048.70	1048.90	1290.76	0.20	
	1048.90	1060.20	1290.56	11.30	
*GC1	1060.20	1061.00	1279.26	0.80	
	1061.00	1200.60	1278.46	139.60	
*SE2	1200.60	1201.50	1138.86	0.90	
	1201.50	1215.60	1137.96	14.10	
*SE3	1215.60	1215.90	1123.86	0.30	
	1215.90	1246.00	1123.56	30.10	
*LS1	1246.00	1246.30	1093.46	0.30	
	1246.30	1247.00	1093.16	0.70	
*LS2	1247.00	1248.20	1092.46	1.20	
	1248.20	1296.80	1091.26	48.60	
*COAL	1296.80	1297.30	1042.66	0.50	
	1297.30	1307.00	1042.16	9.70	
*LS3	1307.00	1309.10	1032.46	2.10	
	1309.10	1368.70	1030.36	59.60	
*UH2	1368.70	1370.00	970.76	1.30	
	1370.00	1376.00	969.46	6.00	
*UH3	1376.00	1376.40	963.46	0.40	
	1376.40	1390.00	963.06	13.60	
*COAL	1390.00	1390.80	949.46	0.80	
	1390.80	1437.80	948.66	47.00	
*MH1	1437.80	1439.80	901.66	2.00	
	1439.80	1524.00	899.66	84.20	
*MH2	1524.00	1526.10	815.46	2.10	
	1526.10	1528.00	813.36	1.90	
*COAL	1528.00	1528.20	811.46	0.20	

	1528.20	1533.80	811.26	5.60
*COAL	1533.80	1534.00	805.66	0.20
	1534.00	1551.50	805.46	17.50
*P11	1551.50	1552.50	787.96	1.00
	1552.50	1575.30	786.96	22.80
*P10	1575.30	1576.50	764.16	1.20
	1576.50	1629.80	762.96	53.30
*LH1	1629.80	1632.80	709.66	3.00
	1632.80	1635.00	706.66	2.20
*COAL	1635.00	1635.30	704.46	0.30
	1635.30	1637.70	704.16	2.40
*COAL	1637.70	1638.00	701.76	0.30
	1638.00	1661.50	701.46	23.50
*P91	1661.50	1663.60	677.96	2.10
	1663.60	1727.00	675.86	63.40
*P81	1727.00	1727.30	612.46	0.30
	1727.30	1734.10	612.16	6.80
*P71	1734.10	1735.00	605.36	0.90
	1735.00	1777.90	604.46	42.90
*COAL	1777.90	1780.00	561.56	2.10
	1780.00	1866.20	559.46	86.20
*P72	1866.20	1867.50	473.26	1.30
	1867.50	1891.80	471.96	24.30
*COAL	1891.80	1892.00	447.66	0.20
	1892.00	1913.50	447.46	21.50
*COAL	1913.50	1914.10	425.96	0.60
	1914.10	1972.80	425.36	58.70
*COAL	1972.80	1973.00	366.66	0.20
	1973.00	2005.50	366.46	32.50
*P62	2005.50	2006.00	333.96	0.50
	2006.00	2049.80	333.46	43.80
*COAL	2049.80	2050.00	289.66	0.20
	2050.00	2082.80	289.46	32.80
*COAL	2082.80	2083.00	256.66	0.20
	2083.00	2096.70	256.46	13.70
*P52	2096.70	2097.80	242.76	1.10
	2097.80	2127.80	241.66	30.00
*P41	2127.80	2128.00	211.66	0.20
	2128.00	2182.30	211.46	54.30
*P43	2182.30	2183.00	157.16	0.70
	2183.00	2214.00	156.46	31.00
*P31	2214.00	2215.00	125.46	1.00
*P32	2215.00	2215.80	124.46	0.80
	2215.80	2255.90	123.66	40.10
*P34	2255.90	2256.30	83.56	0.40
	2256.30	2362.70	83.16	106.40
*P1L	2362.70	2362.90	-23.24	0.20
	2362.90	2432.50	-23.44	69.60
*SJ3	2432.50	2433.00	-93.04	0.50
	2433.00	2561.11	-93.54	128.11

NOTE: FOOTAGE NOT ADJUSTED FOR DEVIATION
 COAL SEAMS TO BE STIMULATED WERE ADJUSTED DUE TO TOPOGRAPHY.
 GAMMA-CALIPER LOG FROM 0 TO 221.00
 GAMMA-DENSITY LOG FROM 221.00 TO TD.

FILE: C:\VP\APPS\BL112.CMP

DATE: 09/06/06

FORMATION	TOP	BOTTOM	THICKNESS	IPF (MCFD/BOPD)	PRESSURE	HOURS TESTED
Lee/Norton	914	1663	749	No Show		
Pocahontas	1778	2215	437	No Show		

PLAN VIEW COMPU-LOG DEVIATION

CLIENT: Consol Energy
 LOCATION:
 HOLE ID: 06-CNX-BL-112
 DATE OF LOG: 08/15/06
 PROBE: 9136CA 955



SCALE: 50 FT/IN
 TRUE DEPTH: 2544.97 FT
 AZIMUTH: 56.6
 DISTANCE: 114.6 FT
 + = 300 FT INCR
 ○ = BOTTOM OF HOLE

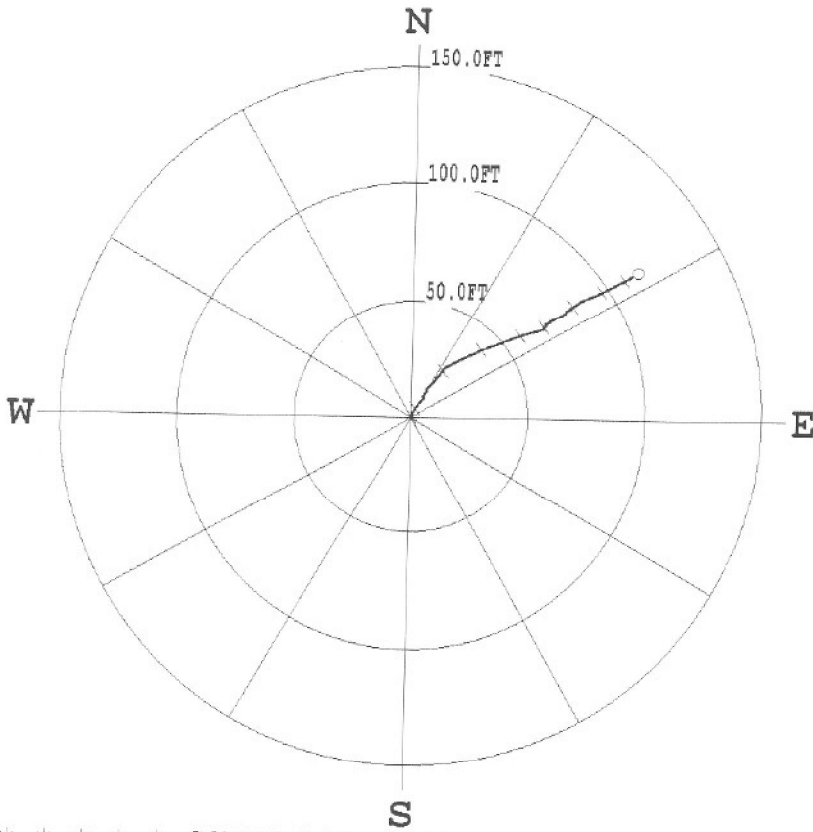

* * * * * COMPU-LOG - VERTICAL DEVIATION * * * * *

CLIENT : Consol Energy	HOLE ID. : 06-CNX-BL-112
FIELD OFFICE : Vansant, Va	DATE OF LOG : 08/15/06
DATA FROM :	PROBE : 9136CA , 955
MAG. DECL. : -6.900	DEPTH UNITS : FEET
LOG: 06-CNX-BL-112_08-15-06_18-46_9136CA_.02_-0.02_2549.13_DEVI.log	

	Casing	Casing Interval	Hole Size	Cement Used In Cu/Ft	Cemented To Surface		Date Cemented	Packers Or Bridge Plugs Kind/Size/Set
					Yes	No		
Conductor	13 3/8"	28'	16"		<input type="checkbox"/>	X	8-11-06	
Surface	7"	221.5'	8 7/8"	72 Cu/ft	X	<input type="checkbox"/>	8-14-06	Basket @ 44'
Water Protection	4 1/2"	2320'	6 1/2"	390.4 Cu/ft	X	<input type="checkbox"/>	8-15-06	
Coal Protection	4 1/2"	2320'	6 1/2"	390.4 Cu/ft	X	<input type="checkbox"/>	8-15-06	
Other Casing And Tubing Left In Well								
Liners					<input type="checkbox"/>	<input type="checkbox"/>		

DRILL DATA HOLE-NOAH HORN WELL DRILLING, INC

COMPANY: CNX

HOLE #: BL-112

LOCATION: DRILL

DRILL RIG #: 90

DATE STARTED: 08-11-06

DATED COMPLETED: 8-16-06

ELECTRIC LOGGED: YES

GROUTED: YES

DEPTH		THICKNESS	STRATA	REMARKS
FROM	TO	FT	DESCRIPTION, VOIDS ETC	
0	28	28	OVERBURDEN	
28	30	2	SAND	
30	60	30	SAND/SHALE	
60	90	30	SAND/SHALE/COAL	
90	120	30	SAND/SHALE	
120	150	30	SAND	
150	180	30	SAND/SHALE	
180	240	60	SAND	
240	265	25	SAND	
265	295	30	SAND/SHALE	
295	325	30	SAND	
325	415	90	SAND/SHALE	
415	445	30	SAND/SHALE/COAL	
445	475	30	SAND/SHALE	
475	505	30	SAND/SHALE/COAL	
505	535	30	SAND/SHALE	
535	595	60	SAND	
595	625	30	SAND/SHALE/COAL	
625	685	60	SAND/SHALE	
685	715	30	SAND/SHALE/COAL	
715	745	30	SAND/SHALE	
745	775	30	SAND/SHALE	
775	835	60	SAND	
835	895	60	SAND/SHALE	
895	955	60	SAND/SHALE/COAL	
955	985	30	SAND/SHALE	
985	1015	30	SAND/SHALE/COAL	
1015	1045	30	SAND/SHALE	
1045	1075	30	SAND	
1075	1105	30	SAND/SHALE	
1105	1225	120	SAND/SHALE/COAL	
1225	1255	30	SAND/SHALE	
1255	1285	30	SAND/SHALE/COAL	
1285	1315	30	SAND/SHALE/COAL	
1315	1345	30	SAND/SHALE	
1345	1375	30	SAND/SHALE/COAL	
1375	1405	30	SAND/SHALE	
1405	1435	30	SAND/SHALE/COAL	
1435	1465	30	SAND	
1465	1525	60	SAND/SHALE	
1525	1585	60	SAND/SHALE/COAL	
1585	1615	30	SAND	

1615	1675	60	SAND/SHALE/COAL
1675	1735	60	SANDY SHALE
1735	1765	30	SAND
1765	1795	30	SANDY SHALE/COAL
1795	1855	60	SAND
1855	1885	30	SANDY SHALE/COAL
1885	1915	30	SANDY SHALE
1915	1945	30	SAND
1945	2035	90	SANDY SHALE
2035	2095	60	SANDY SHALE/COAL
2095	2185	90	SANDY SHALE
2185	2215	30	SAND/SHALE/COAL
2215	2245	30	SAND
2245	2275	30	SANDY SHALE/COAL P-3
2275	2365	90	SANDY SHALE
2365	2395	30	SAND
2395	2425	30	SANDY SHALE
2425	2455	30	SANDY SHALE/COAL
2455	2485	30	SANDY SHALE/RS
2485	2515	30	SAND
2515	2545	30	SAND/GREEN SHALE
2545	2575	30	SAND

2575.00 FT. TOTAL DEPTH
28.00 FT. OF 13 3/8" CASING
221.50 FT. OF 7" CASING
2320.00 FT. OF 4 1/2" CASING