

API NO. 45 - 167 - 21576
WELL NAME: DAWSON COAL PC 403
DATE 10-24-91

RU 20

Virginia Oil and Gas Inspector
P. O. Box 1416
Abingdon, VA 24210
703 628-8115

REPORT OF COMPLETION OF WELL WORK

Pursuant to Regulation 4.06 of the Regulations under the Virginia Oil and Gas Act, the undersigned well operator reports completion of the type(s) of well work specified below on the referenced well in CASTLEWOOD District RUSSELL County, Virginia on 27TH day, AUGUST month, 19 91.

WELL TYPE: Oil ___/ Gas X/ Enhanced Recovery ___/ Waste Disposal ___
If Gas-Production ___/ Underground Storage ___/ Exempt by Code Section 45.1-300.B.1. from general Oil and Gas Conservation Law yes ___/ no ___
WELL WORK: Drill ___/ Deepen ___/ Redrill ___/ Stimulate ___/ Plug Off Old Formation ___/ Perforate New Formation ___/ Plug ___/ Replug ___/ Other physical change in well (specify) _____
The well work was done as shown in the Appendix(es) applicable to the type(s) of well work involved.

CONFIDENTIALITY STATUS UNDER CODE OF VIRGINIA SECTION 45.1-332

X Ninety days from the filing of this report

OR

Two years from _____, the date on which the referenced well was completed, the well being an exploratory well as defined in Code of Virginia, Section 45.1-288.21.

APPLICANT EQUITABLE RESOURCES EXPLORATION
BY C. C. Rang
ITS ENGINEER
ADDRESS 1989 E. STONE DR., KINGSPORT, TN 37660
TELEPHONE 615/378-5101

COMPLETION REPORT

WELL TYPE: Oil () Gas Production (X) Gas-Underground Storage ()
Enhanced Recovery () Waste Disposal ()

LOCATION

COUNTY RUSSELL DISTRICT CASTLEWOOD

SURFACE ELEVATION 2379.56 QUADRANGLE ST. PAUL

LATITUDE 7650 'S 37° 00' 00" LONGITUDE 8220 'W 82° 15' 00"

DRILLING DATA

DATE DRILLING COMMENCED 8-12-91 DRILLING CONTRACTOR UNION DRILLING
DATE DRILLING COMPLETED 8-16-91 ADDRESS P.O. DRAWER 40, BUCKHANNON, WV
DATE WELL COMPLETED 8-27-91 TELEPHONE NUMBER 304-472-4610
TOTAL DEPTH OF COMPLETED WELL LTD=2587 RIG TYPE X ROTARY CABLE TOOL
DTD=2585

GEOLOGICAL DATA

FRESH WATER AT (1) 359 FEET DAMP GPM: (2) FEET GPM
SALT WATER AT (1) FEET GPM: (2) FEET GPM

COAL SEAMS:

<u>NAME</u>	<u>TOP</u>	<u>BOTTOM</u>	<u>THICKNESS</u>	<u>MINING IN AREA</u>		
				<u>YES</u>	<u>NO</u>	<u>MINED OUT</u>
<u>MIDDLE SEABOARD</u>	<u>1413</u>	<u>1415</u>	<u>2</u>		<u>X</u>	
<u>LOWER SEABOARD</u>	<u>1465</u>	<u>1467</u>	<u>2</u>			
<u>WARCREEK</u>	<u>1763</u>	<u>1765</u>	<u>2</u>			
<u>LOWER HORSEPEN</u>	<u>1913</u>	<u>1915</u>	<u>2</u>			

OIL AND GAS SHOWS:

FORMATION TOP BOTTOM THICKNESS IPF (MCFD/BOPD) PRESSURE HOURS TESTED
NO SHOWS

STIMULATION RECORD

"C",WARCREEK, L. SEABOARD, M. SEABOARD
ZONE (1) POCO #3, L. HORSEPEN, UNNAMED FORMATION STIMULATED WITH 70 Q FOAM L/E
W/750 GAL 15% HCL-777980 SCF N2-13200 # 12/20 SAND-715 BBL FLUID
PERFORATED 1414 TO 2438 NO. OF PERFORATIONS 16 PERFORATION SIZE 34"
FORMATION BROKE DOWN AT 927 PSIG AVERAGE INJECTED RATE 16.44 BPM
INITIAL SHUT IN PRESSURE 1745 PSIG 5 MINUTE SHUT IN PRESSURE 1320 PSIG

STIMULATION RECORD

ZONE (2) FORMATION STIMULATED WITH
PERFORATED TO NO. OF PERFORATIONS PERFORATION SIZE
FORMATION BROKE DOWN AT PSIG AVERAGE INJECTED RATE BPM
INITIAL SHUT IN PRESSURE PSIG MINUTE SHUT IN PRESSURE PSIG

FINAL PRODUCTION: () NATURAL (XXX) AFTER STIMULATION

BOD MCFD HOURS TESTED ROCK PRESSURE HOURS TESTED
ZONE (1)
ZONE (2)
FINAL PRODUCTION IF GAS ZONES ARE COMMINGLED * 7 MCFD 6 HOURS TESTED
315 PSIG 48 HOURS TESTED

*NOT ABSOLUTE

CASING AND TUBING

	<u>SIZE</u>	<u>TOP</u>	<u>BOTTOM</u>	<u>LENGTH</u>	<u>PERFORATIONS</u> <u>FEET TO FEET</u>	<u>PACKERS OR</u> <u>BRIDGE PLUGS</u> <u>KIND SIZE SET AT</u>
CONDUCTOR	11 3/4"		21'			

CASING

Circulated
and Cemented
to Surface

	8 5/8"		365'	355'		
--	--------	--	------	------	--	--

WATER PROTECTION

(Casing Set
According to
Section
45.1-334)

	4 1/2"		2509'			
--	--------	--	-------	--	--	--

COAL PROTECTION

(Casing Set
According to
Section
45.1-334)

--	--	--	--	--	--	--

OTHER CASING &

Tubing Left
In Well

	2 3/8"		2494'			
--	--------	--	-------	--	--	--

LINERS

Remaining
In Well

--	--	--	--	--	--	--

OTHER used and not
left

Is the well underlain by Red Shale Yes No, If Yes, was coal
protection string set to Red Shales? Yes No

REMARKS: Shut down, fishing jobs, depths and dates, caving, etc.

Samples and Cuttings

Will Will not be available for examination by a member of the Virginia Division of Mineral Resources

Will Will not be furnished to the Virginia Division of Mineral Resources upon request

Will Will not require sacks to be furnished by the Virginia Division of Mineral Resources

Electric Logs and Surveys:

Type of Electric Log(s) Ran: LDT/HI-RES LDT/GR/TEMP

Did log disclose vertical location of a coal seam? Yes No

Was log made at request of a coal owner according to Section 45.1-333.B.1 of the Virginia Code? Yes No

Note: If a coal seam was located, the part of the survey from the surface through the coal is attached in accordance with Section 45.1-333.B.3 of the Virginia Code

Deviation Surveys

Deviation surveys were were not required under Section 45.1-333.C of the Virginia Code "to the bottom of the lowers published coal seam depth."

Note: If a deviation survey(s) was/were required, the survey results are as follows:

<u>Depth of Survey</u>	<u>Feet/Degree Deviated From True Vertical</u>	<u>Depth of Survey</u>	<u>Feet/Degree Deviated From True Vertical</u>
	<u>See Attachment</u>		

A continuous survey was was not required, under Section 45.1-333.C of the Virginia Code.

Note: If a continuous survey was required, the survey results are attached.

Changes in the Permitted Well Work:

The well operator did did not make any change(s) in the permitted well work, verbally approved by the Inspector or Assistant Inspector under Regulation 4.03 of the Regulations under the Virginia Oil and Gas Act, for the purpose of insuring successful completion of the well work.

NOTE: The nature and purpose of each such change, if any, is set out below or on additional sheets if such are required.

Confidentiality Status:

Confidentiality status under Section 45.1-332 of the Virginia Code:

The operator requests that information herein and log(s) be kept confidential (after COMPLETION DATE of the well) for a period of

Ninety (90) days
 two (2) years, if the well is exploratory

DRILLER'S LOG

Compiled by R. J. MACDONALD

Geological Age	Formation	General Lithology	Color	Depth		Thickness	Remarks
				Top	Bottom		
PENNSYLVANIAN	SAND SHALE & THIN COALS			0	1413	1413	
PENNSYLVANIAN	MIDDLE SEABOARD COAL			1413	1415	2	
PENNSYLVANIAN	SAND SHALE & THIN COALS			1415	1465	50	
PENNSYLVANIAN	LOWER SEABOARD COAL			1465	1467	2	
PENNSYLVANIAN	SAND SHALE & THIN COALS			1467	1763	296	
PENNSYLVANIAN	WARCREEK COAL			1763	1765	2	
PENNSYLVANIAN	SAND SHALE & THIN COALS			1765	1913	148	
PENNSYLVANIAN	LOWER HORSEPEN COAL			1913	1915	2	
PENNSYLVANIAN	SAND SHALE & THIN COALS			1915	2554	639	
MISSISSIPPIAN	RED ROCK & SHALE			2554	2587	33	
	LOGGER'S TOTAL DEPTH			2587			

DIRECTIONAL SURVEY
WELL PC 403

<u>DEPTH</u>	<u>DEGREES</u>
236	3/4°
540	1°
760	3/4°
977	1°
1190	1°
1411	1°
1596	1°
1780	1°
1990	3/4°
2212	1°
2399	1°
2585	1°

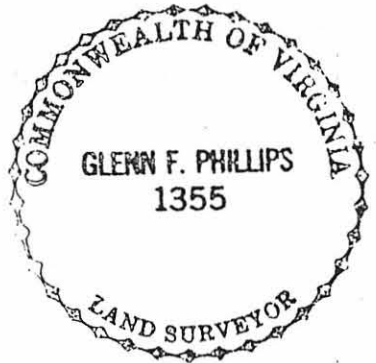
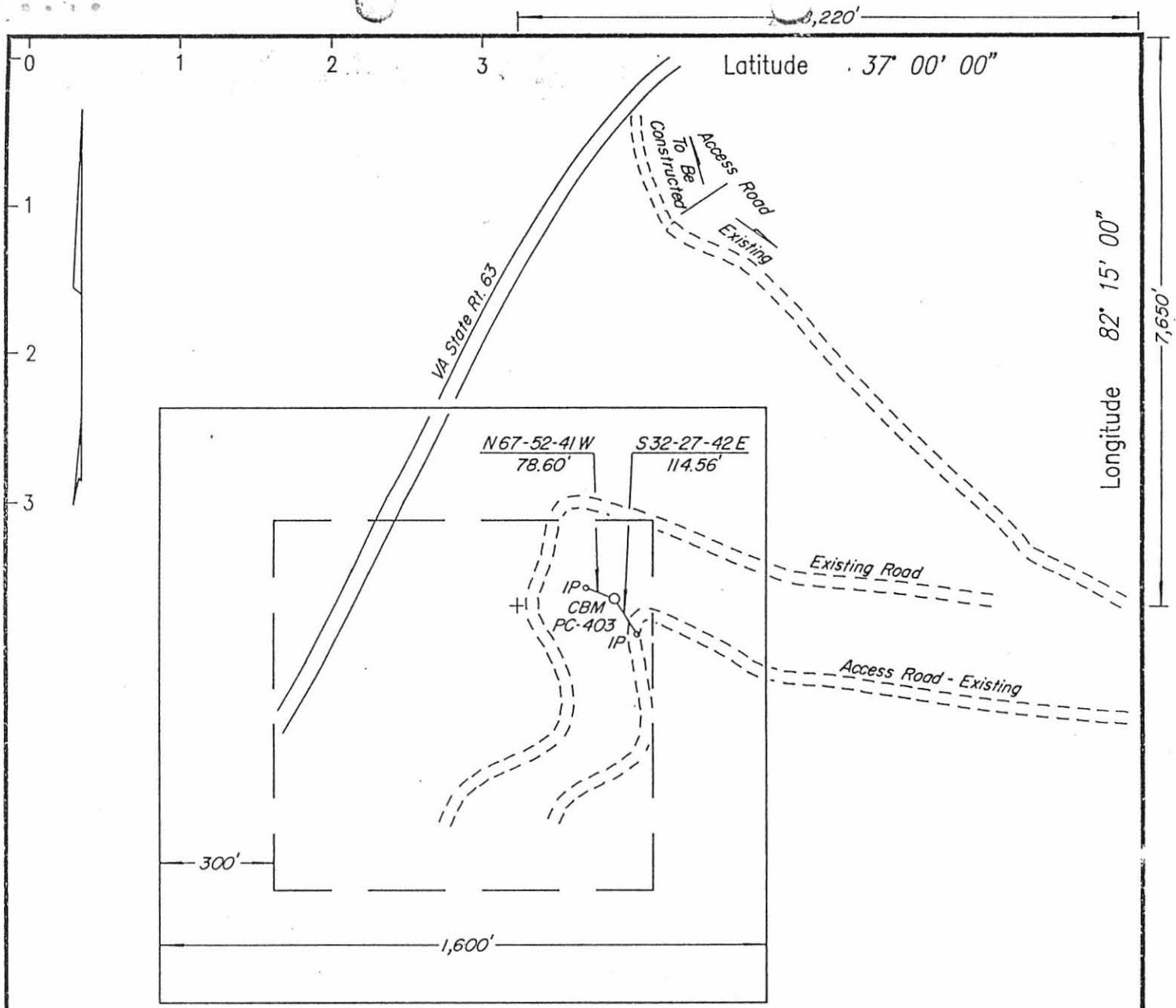

Lease No. PO-148 / T-525
 Dawson Tr.
 6000.00 Acres
 Clinchfield Coal Company /
 Pegasus Resource Company - surface & coal
 Pine Mountain Oil & Gas, Inc - oil & gas

- o - proposed well site
- * - offset well
- o- - mineral line
- o- - surface line

Well Coordinates: (Clinchfield Coal Co.)
 S 44069.95 E 30728.09

COMPANY Equitable Resources Exploration
 ADDRESS 1989 E. Stone Dr., Kingsport, TN 37660
 WELL NAME PC-403
 FARM Dawson Tr. TRACT T-525
 LEASE NO. PO-148 ELEVATION 2381.98
 ACRES 6000.00 QUADRANGLE St. Paul
 COUNTY Russell DISTRICT Castlewood
 REG. ENGINEER _____ REG. NO. _____
 CERT. LAND SURVEYOR X CERT. NO. 1355
 FILE NO. _____ DRAWING NO. _____
 DATE 8-27-1990 SCALE 1" = 400'

WELL LOCATION MAP
 Well No. PC-403

+ Denotes Location of Well on United States Topographic Maps, Scale 1 to 24,000, Latitude and Longitude Lines Being Represented by Border Lines as Shown.

CERTIFICATION OF WELL PLAT

I, the undersigned hereby certify that this plat is correct to the best of my knowledge and belief, and shows all the information required by law and the regulations of the VA Well Review Board.

Glenn F. Phillips
 Registered Engineer or Certified Land Surveyor in Charge

This plat is X new _____ updated
 This plat X is _____ is not based on a mine coordinate system established for the areas of the well locations.