

Log # 174 W # 1516 County Nansemond - 168 Date 2/25/66  
 Owner City of Norfolk - Lake Prince #2 Use Town  
 Location 6 miles northwest of Suffolk, Virginia and 7 miles east of Windsor, Virginia

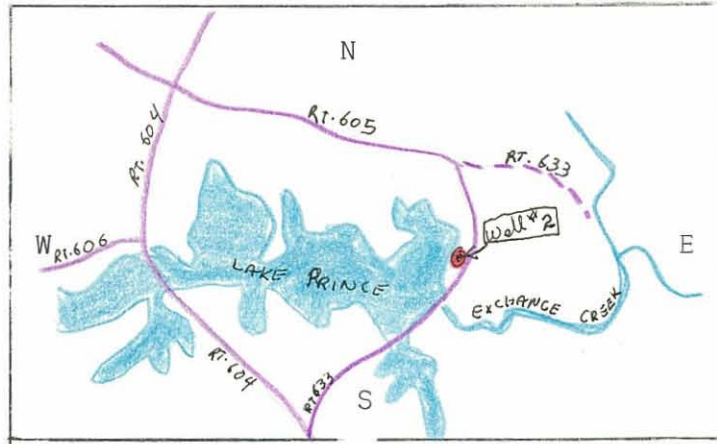

Well Data

Instrument Data

Driller: Layne & Bowler, Inc.  
 Completed: 3/9/66  
 Total Depth: 949'  
 Static W. L.: 64±  
 Casing: 20" x 427', 12" x 515'-706',  
12" x 746' - 820'  
 Bedrock  
 Hole Size: (see remarks)  
 Yield: 500± gpm  
 H<sub>2</sub>O Temp:  
 Aquifers: 435' - 545', 706' - 746', 820' - 880'  
 Elev:  
 Geology:

SP setting 10 Approx. "/min.  
 Res. " 10 " "/min.  
 Gamma " \_\_\_\_\_ " "/min.  
 T. C. " \_\_\_\_\_  
 Fluid:  
 Running Time \_\_\_\_\_ Hrs. \_\_\_\_\_ Mins.  
 Depth of Log: Elec. 940' Gamma \_\_\_\_\_  
 Ground Electrode \_\_\_\_\_

Remarks Hole size: 24" x 427', 34" x 427' - 520', 19" x 520' - 700', 30" x 700'-  
750', 19" x 750 - 815', 30" x 815' - 875', 19" x 875' - 880', 9" x 880-949'

Logged By Layne & Bowler, Inc.