

Log # 184 W # 1702 County Madison - 44 Date October 7, 1966

Owner U.S.N.P.S, Shenandoah National Park Use Public  
*Big Meadows #4*

Location One mile east of Skyline Drive at Big Meadows visitors center

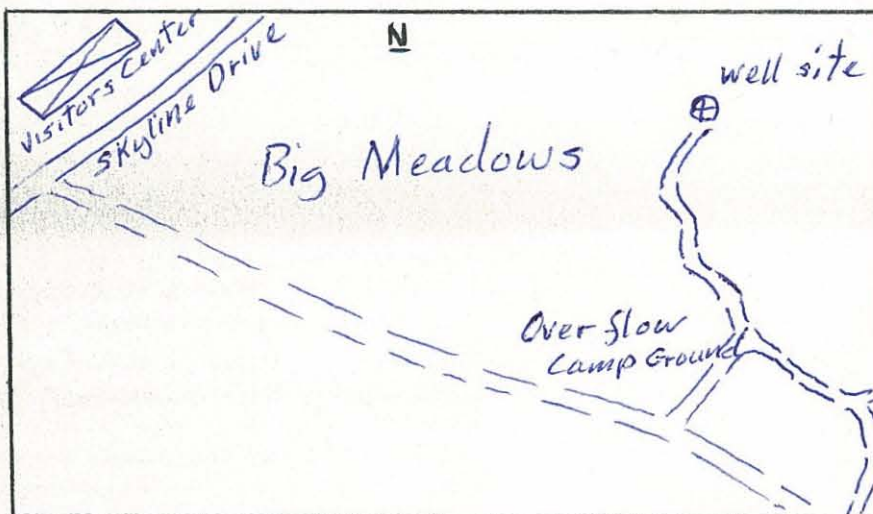

Well Data

Driller: Frank K. Martin Drilling Co.  
Completed: July 11, 1966  
Total Depth: 334'  
Static W. L.: 109'  
Casing: 6", 0 - 36'  
Bedrock: -----  
Hole Size: 10", 0-36'; 6", 36-350'  
Yield: 2 gpm  
H<sub>2</sub>O Temp: -----  
Aquifers: 160 - 165'  
Elev:  
Geology: Catoclin Greenstone

Instrument Data

SP setting 50 mv Approx. 50'/min.  
Res. " 200 mo " 50'/min.  
Gamma " .005 " 22'/min.  
T. C. " Elec. = 3, Gamma = 16  
Fluid: Fresh water  
Running Time 1 Hrs. 35 Mins.  
Depth of Log: Elec. 333 ' Gamma 333 '  
Ground Electrode Down hole

Remarks \_\_\_\_\_  
\_\_\_\_\_  
\_\_\_\_\_

Logged By T. M. Gathright