

Log # 137 W # _____ County Pulaski Date 5 Aug 64

Owner Claytor Lake State Park # 2 Use Public

Location In Park access rd. (Rt. 660) to bottom of hill and right along road to cabin, in field opposite cabin 11 and 12.

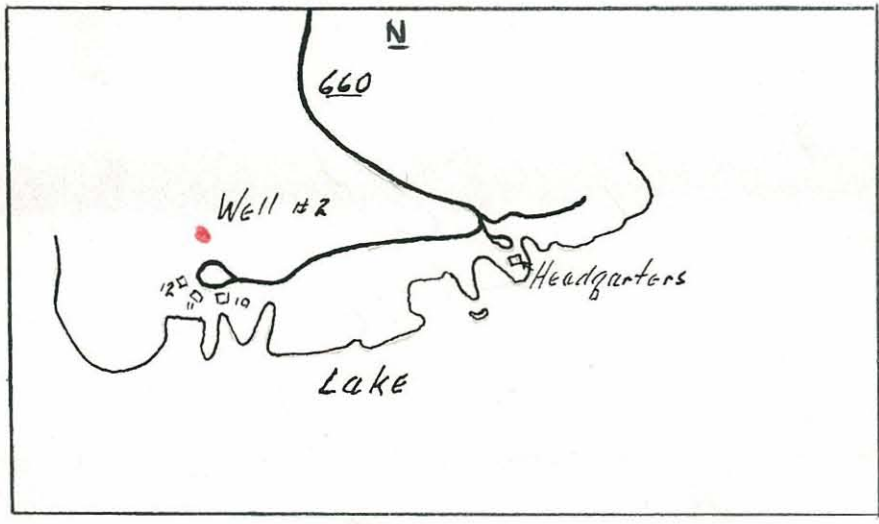

Well Data

Driller: Sydnor Pump & Well Co.

Completed:

Total Depth: 319

Static W. L.: 23.4 M-scope

Casing:

Bedrock:

Hole Size:

Yield:

H₂O Temp:

Aquifers:

Elev: 1870' topo

Geology: Alluvium, Elbrook Dolomite, and tectonic breccia

Instrument Data

SP setting 25 Mv Approx. 44 '/min.

Res. " 50 Ohm-m " 44 '/min.

Gamma " .005 Mr " 26 '/min.

T. C. " E-3, G-16

Fluid: Fresh H₂O

Running Time 2 Hrs. _____ Mins.

Depth of Log: Elec. 317 ' Gamma 317 '

Ground Electrode Down hole 5' below SWL

Remarks _____

Logged By Wilkenloh - Gathright