

Log # 103 W # \_\_\_\_\_ County Bedford - 154 Date 8/20/63

Owner Allen, N. E. Use Domestic

Location 9/10 mi. NE of Big Otter River on State Rt. 297, 50' North of Highway

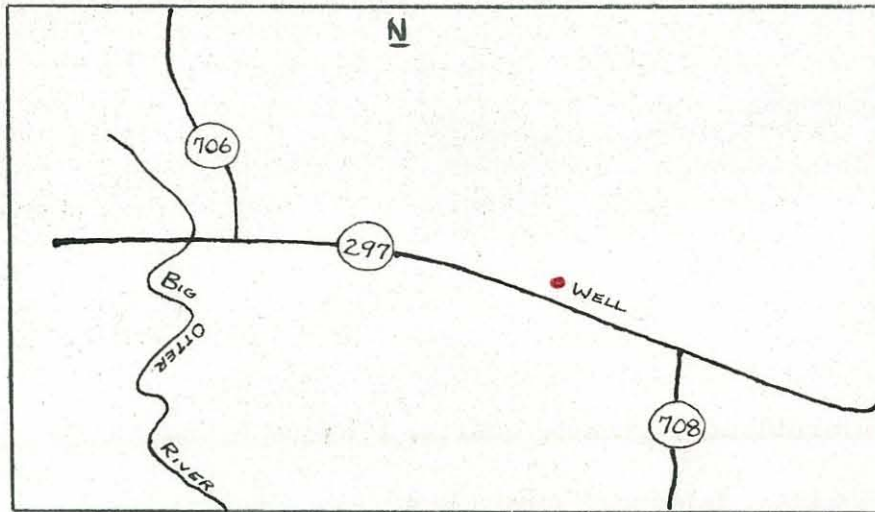

Well Data

Driller: A. T. Conner

Completed: 8/19/63

Total Depth: 1,050 1/2'

Static W. L.: 500 (driller)

Casing: 5 5/8" x 28'

Bedrock: 28'

Hole Size: 5 5/8" x 1,050 1/2'

Yield: DRY - (2 qts. 1 min or less)

H<sub>2</sub>O Temp: -

Aquifers: NONE

Elev: Approximately 820'

Geology: Lynchburg formation, lower part, strike N40 E to N50E, dip 80° northeast.

Instrument Data

↑ SP setting 50 Mv Approx. 44' /min.

Res. " 100 Ohm/m" 44' /min.

Gamma " .005 Mr 28' /min.

Gamma " .01 Mr " 28' /min.

T. C. " E-3; G-16

Fluid: Fresh Water

Running Time 30 Hrs. 30 Mins.

Depth of Log: Elec. 1,050 1/2' Gamma 1,050 1/2'

Ground Electrode in casing 20' below

water (hole artificially filled W/water for logging)

Remarks Hole shot with 8 lbs. of dynamite at 415 feet and several unrecorded depths when driller changed bits.

(over)

Logged By Wilkenloh and Whitfield

X-RAY ANALYSIS OF SAMPLES TAKEN FROM VICINITY  
OF N. E. ALLEN WELL .

Figure # 1  
( Sketch showing approximate location  
of samples collected . )

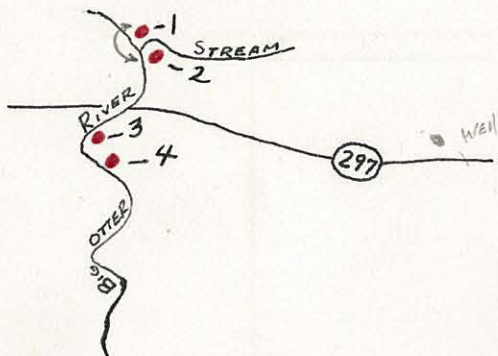

Figure # 2  
Feldspar quarry ~~A~~<sup>B</sup> ( Approximately  
one (1) mile southwest of figure # 1 )

sketch  
A B

# 1 Hornblende, garnet, quartz, feldspar - Gneiss

# 2 Quartz, feldspar, biotite - granite Gneiss

# 3 Biotite, quartz, feldspar, - probably originally Granite

# 4 Quartz, chlorite, biotite (slight feldspar) - looks like Quartzite

A Meta-gabbro - amphibole, plagioclase, sphere ?, chlorite ?

B Same composition as A, more schistose