

Log # 76 W # 754 County Albemarle - 846 Date 12/5/62

Owner National Park Service Well #5 Use Public

Location (Loft Mt.) Approximately 15 miles south of Swift Run Gap on Skyline Drive between mileposts 79 and 80; .3 mile east of Skyline Drive on dirt road.

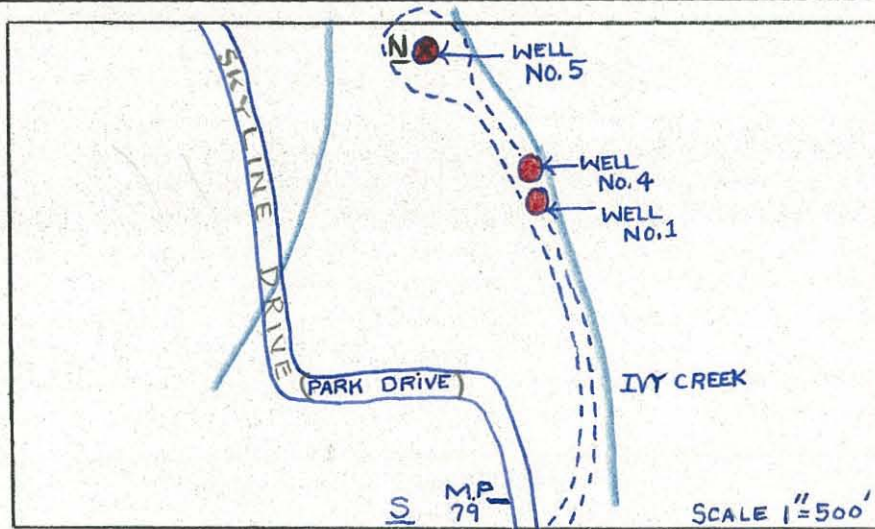

Well Data

Driller: Sydnor Pump & Well Co.

Completed: 11/27/62

Total Depth: 320 (Driller)  
319 (Logger)

Static W. L.: 15.2'

Casing: 6" x 0' - 34'9"

Bedrock: 10'

Hole Size: 10" x 33'4"  
6" x 33'4" - 320

Yield: 22 GPM

H<sub>2</sub>O Temp: 50° F.

Aquifers: 46' - 47', 50' - 51', 53' - 54',  
56' - 57', 115 - 116

Elev: 2,700' (Topo Sheet)

Geology: Cambrian - Weverton fm.  
Pre - Cambrian - Catoclin fm.

Instrument Data

SP setting ↓ 20 Mv Approx. 40'/min.

Res. " ↓ 200 ohm-M " 40'/min.

Gamma " ↓ .0025 Mr " 24'/min.  
↑ .005 Mr " 24'/min.

T. C. " E-3; G-16

Fluid: Fresh water

Running Time 1 Hrs. 30 Mins.

Depth of Log: Elec. 319 ' Gamma 319 '

Ground Electrode Down hole 3' in fresh  
water.

Remarks The Research Laboratories replaced a resistor in the right curve amplifier on Dec. 4, 1962 with this being the first log run since repairs. Several logs were run to adjust sensitivity screw. The unit appeared to function properly.

Casing approximately 1' above ground level. Well is 20' west of Ivy Creek.

Logged By Whitfield & Nottingham