

Log # 64 W # 695 County Rockingham - 409 Date 8/1/62

Owner Hartman's Truck Terminal #3 Use Industrial

Location 300 yds east U. S. 11 - 4 mi. North of Harrisonburg

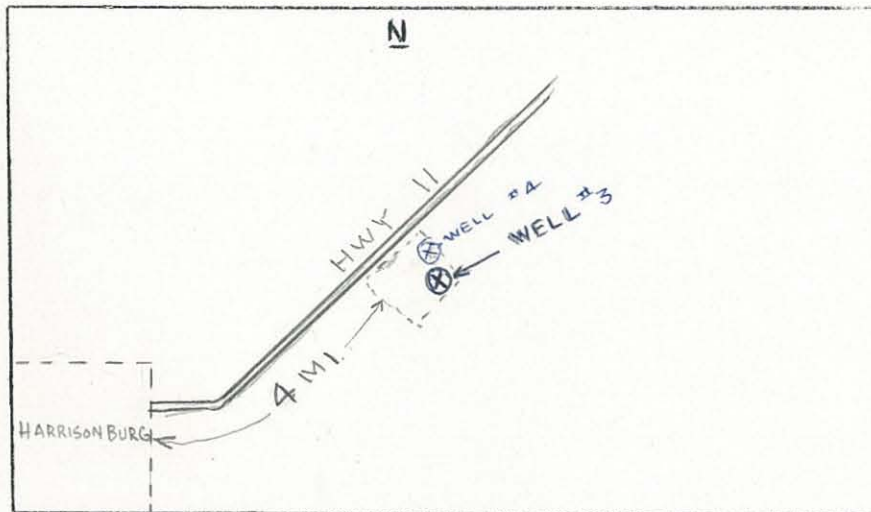

Well Data

Driller: Sydnor Pump & Well Co.
Completed: 8/1/62
Total Depth: 573 (Driller)
Static W. L.: 571 (Logger)
Casing: 5 5/8" x 104.5' (driller)
Bedrock: 19' (driller)
Hole Size: 5 5/8" x 571 (logger)
Yield: 1/2 pt./min. (driller's estimate)
H₂O Temp: ---
Aquifers: none
Elev: 1295' (top)
Geology: lower Edinburg (Athens ls.)

Instrument Data

SP setting 20 Approx. 52' /min. 8/22/62
Res. " 200 " 52' /min. "
Gamma " .0025 ↓ .005 ↑ " ↓ 28' /min. 28 ↑ 8/1/62
T. C. " G-10, E-3
Fluid: none
Running Time 1 Hrs. 45 Mins.
Depth of Log: Elec. 573 ' Gamma 571 '
Ground Electrode Down hole, 1 foot in H₂O 8/22/62

Remarks No electric log was obtained as hole was dry.
Electric log obtained 8/22/62 with fresh water in hole; artificial SWL was 47';
temperature 56°

Logged By Gardner & Whitfield