

Log # 28 W # 371 County King George - 23 Date 9/30/59

Owner U. S. Naval Proving Grounds Use Public supply

Location 1/3 mile N of dead end rt 618 and 150 yards N of well log #27.

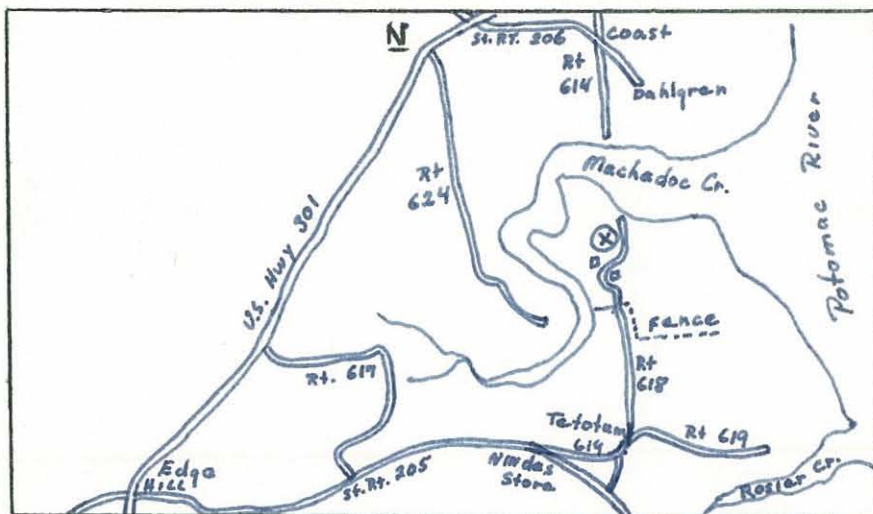

Well Data

Driller: J. T. Ellington

Completed: 9/20/59

Total Depth: 760'

Static W. L.: < 50'

Casing: none (later)

Bedrock: not reached

Hole Size: 12"

Yield: 60 gpm

H₂O Temp:

Aquifers:

Elev: ~~22'~~

Geology:

Instrument Data

SP setting 20 Mv Approx. 60' /min.

Res. " 2.5 ohm-m " 60' /min.

Gamma " .0025 Mr " 12-15' /min.

T. C. " 3

Fluid: Water (drilling fluid - salt water)

Running Time 3 Hrs. — Mins.

Depth of Log: Elec. 744 ' Gamma 694 '

Ground Electrode mud pit - salt water

Remarks Pumping level 229' *logged in rain.*
Electrical interference from nearby sub-station.

Logged By Yost and LeVan