

VIRGINIA DIVISION OF MINERAL RESOURCES  
Box 3667, Charlottesville, VA 22903

INTERVAL SHEET

Page 1 of 2

Well Repository No: W-4850

Date rec'd: Date Processed: 8/18/77 Sample Interval: from:0 to: 5690'

PROPERTY: Nell Phipps et al No. P-38 Number of samples: 219

COMPANY: Philadelphia Oil Company Total Depth: 5752'

COUNTY: Dickenson Oil or Gas:XWater: Exploratory:

From-To	From-To	From-To	From-To
0-30	740-770	1390-1420	2140-2170
30-60	770-800	1420-1450	2170-2200
60-90	800-830	1450-1480	2200-2230
90-110	830-860	1480-1510	2230-2260
110-140	860-890	1510-1540	2260-2290
140-170	890-920	1540-1570	2290-2320
170-200	920-950	1570-1600	2320-2350
200-230	950-980	1600-1630	2350-2380
230-260	980-1010	1630-1660	2380-2410
260-290	1010-1040	1660-1690	2410-2440
290-320	1040-1070	1690-1720	2440-2470
320-350	1030-1060?	1720-1750	2470-2500
350-380	1060-1090?	1750-1780	2500-2530
380-410	1070-1100	1780-1810	2530-2560
410-440	1100-1130	1810-1840	2560-2590
440-470	1090-1120	1840-1870	2590-2620
470-500	1120-1150	1870-1900	2620-2650
500-530	1150-1180	1900-1930	2650-2680
530-560	1180-1210	1930-1960	2680-2710
560-590	1210-1240	1960-1990	2710-2740
590-620	1240-1270	1990-2020	2740-2770
620-650	1270-1300	2020-2050	2770-2800
650-680	1300-1330	2050-2080	2800-2830
680-710	1330-1360	2080-2110	2830-2860
710-740	1360-1390	2110-2140	2860-2890

VIRGINIA DIVISION OF MINERAL RESOURCES  
 Box 3667, Charlottesville, VA 22903

INTERVAL SHEET  
 Continued

Page 2 of 2

Well Repository No.: W- 4850

From-To	From-To	From-To	From-To	From-To
2890-2920	4100-4110	5640- 5650	-	-
2920-2950	4110-4120	5650- 5670	-	-
2950-2980	4120-4130	5670- 5680	-	-
2980-3010	4130-4140	5680- 5690	-	-
3010-3040	4140-4150	-	-	-
3040-3070	4150-4160	-	-	-
3070-3100	-	-	-	-
3100-3130	-	-	-	-
3130-3160	4180-4190	-	-	-
3160-3190	4190-4900	-	-	-
3190-3220	4900-4910	-	-	-
3220-3250	4910-4920	-	-	-
3250-3280	4920-4930	-	-	-
3280-3310	4930-4940	-	-	-
3310-3340	4940-4950	-	-	-
3340-3370	4950-4960	-	-	-
3370-3400	4960-4990	-	-	-
3400-3430	4990-5020	-	-	-
3430-3470	5020-5050	-	-	-
3470-3500	5050-5080	-	-	-
-	5080-5110	-	-	-
3530-3560	5110-5140	-	-	-
3560-3590	5140-5170	-	-	-
3590-3620	5170-5200	-	-	-
3620-3650	5200-5230	-	-	-
3650-3680	5230-5260	-	-	-
3680-3710	5260-5290	-	-	-
3710-3740	5290-5320	-	-	-
3740-3770	5320-5350	-	-	-
3770-3800	5350-5380	-	-	-
3800-3830	5380-5410	-	-	-
3830-3860	5410-5440	-	-	-
3860-3890	5440-5470	-	-	-
3890-3920	5470-5500	-	-	-
3920-3950	5500-5530	-	-	-
3950-3980	5530-5560	-	-	-
3980-4010	5560-5590	-	-	-
-	5590-5620	-	-	-
-	5620-5630	-	-	-
-	5630-5640	-	-	-

OIL AND GAS WELL  
SUMMARY REPORT

API No. 45-051-20198-00-03 VDMR Well Rep. No. W-4850  
DMQ File No. DI-120

Operator PHILADELPHIA OIL COMPANY  
Farm NELL PHIPPS, ET AL  
Co. Well No. P-38

County DICKENSON Quadrangle NORA - 7-1/2'  
Location (UTM) N 4,102,870; E 384,370 UTM Zone 17  
(Lat. and Long.) \_\_\_\_\_

Field \_\_\_\_\_ Province APPALACHIAN PLATEAUS  
Elev. (specify) 2388.20' GR. TD 5752' Form. at TD DEVONIAN SHALE  
INITIAL FLOW - Age DEVONIAN

Date compl. or abandoned MAY 17, 1975  
Result GAS WELL  
Gas Shows \_\_\_\_\_  
Gas Pays 5616' to 5627'; 5644' to 5677'  
Main Production \_\_\_\_\_ Prod. Form. BEREA  
Age MISSISSIPPIAN

Treatment: WELL PERFORATED FORM 5616' to 5627' AND FROM 5644' to 5677'

Initial Production \_\_\_\_\_  
FINAL FLOW - 133,000 CU. FT.

Oil shows \_\_\_\_\_

Water FW \_\_\_\_\_ at \_\_\_\_\_ at \_\_\_\_\_ at \_\_\_\_\_  
SW \_\_\_\_\_ at \_\_\_\_\_ at \_\_\_\_\_ at \_\_\_\_\_

Coal 140' to 142'; 181' to 185'; 376' to 377'; 457' to 460'; 528' to 530'; 572' to 576'  
937' to 938'; 1588' to 1589'; 1771' to 1774'; 1986' to 1988'; 2008' to 2010';  
Plat X Plotted X Completion Report X 2196' to 2198'

Drillers Log X Geologic Log \_\_\_\_\_  
Samples X Interval Sheet X  
Sample Interval 0' to 5690'  
Remarks \_\_\_\_\_

Geophysical Logs S.P. \_\_\_\_\_ Res \_\_\_\_\_ Gamma X Neutron \_\_\_\_\_  
Density X Sonic \_\_\_\_\_ Other TEMPERATURE; CALIPER



COMMONWEALTH OF VIRGINIA  
DEPARTMENT OF LABOR AND INDUSTRY  
DIVISION OF MINES AND QUARRIES  
BIG STONE GAP, VIRGINIA 24219  
PHONE 703-523-0335

APPLICATION FOR PERMIT TO (DRILL) (REDRILL) (DEEPEN) OIL OR GAS WELL

(Required by Section 45.1-115, Code of Virginia, 1950, 1954 and the 1966 Cumulative Supplement. To be accompanied by Permit fee of twenty-five dollars and bond and surety therefor, as specified by Section cited. To be submitted in duplicate, one copy to be returned to applicant after action by Division of Mines and Quarries.

TO: Division of Mines and Quarries  
Drawer V  
Big Stone Gap, Virginia 24219

Box 431  
Prestonsburg, Kentucky 41653

Place  
December 13, 1974  
Date

Gentlemen:

The undersigned hereby makes application for a Permit to drill, ~~redrill, or deepen (strike out two)~~ a well for oil or gas on the Nell Phipps, et al farm, comprising 1423 acres, in the Ervinton District of Dickenson County, Virginia, having the fee title thereto, or as the case may be, under grant or lease dated April 9, 19 74 made by Nell Phipps, et al. to Philadelphia Oil Company and recorded on the 21st day of May, 19 74 in the office of the County Clerk for the said County in Book 165 page 231.

The proposed location of the well is shown on a location plat or map submitted to the Division of Mines and Quarries, by the undersigned, together with Notice of Intention to Drill, Redrill or Deepen a Well for Oil or Gas on the 13th day of December 19 74.

The proposed well will be known as Well No. P-38 of Philadelphia Oil Company (company, etc.) It is proposed to drill this well to a depth of about 5738 feet.

The proposed location is about 1890 feet distant from the nearest property or lease line; about 8700 feet distant from the nearest mining opening, ~~or quarry (strike out words not applicable)~~ and/or about 2500 feet distant from the nearest drilling, ~~or abandoned producing, or applied for (strike out words not applicable)~~ oil or gas ~~(strike out words not applicable)~~ well.

There is enclosed herewith a certified check or U.S. Postal Money Order, in the amount of twenty-five (\$25.), payable to the Treasurer of Virginia, covering fee for a Permit to Drill a Well for Oil or Gas, as required by Section 45.1-115, Code of Virginia, 1950, 1954 and the 1966 Cumulative Supplement. Bond and Surety therefor to insure compliance with the provisions of Chapter 8, Title 45, Code of Virginia, 1950 and the 1966 Supplement, for this well, in the amount of \$ 12,600.00 is submitted herewith of (give status of) Blanket Bond covering P-32 to P-55 inclusive.

Correspondence regarding this well should be addressed to Mr. Edward O. Ray, Box 431, Prestonsburg, Kentucky 41653

Very truly yours,

Signature of officer or certifying party:

Edward O. Ray  
~~XXXX~~

Edward O. Ray  
~~XXXX~~

PHILADELPHIA OIL COMPANY

Drilling Company or Operator

Box 431

Street

Prestonsburg

City or Town

Kentucky 41653

State

Space below this line is for the use of the Board only.

ACTION OF DIVISION OF MINES AND QUARRIES

Received on 12-16-, 19 74.

Approved and Permit (no. 198) granted on 12-30-, 19 74

Denied

Reasons for denial

DIVISION OF MINES AND QUARRIES

By [Signature] State Oil Gas Inspector  
Title

File No. 12-120 Well No. P-38 Permit No. 198





File No. 63-9 of New Co

Received on 1/2/75 by XXX and sent on 1/2/75 by XXX

**ACTION OF DIVISION OF MINES AND QUARRIES**

City of Louisville  
 State of Kentucky  
 Box # 121  
 Mailing Company of Orbator  
BRITISH BIT COMPANY

Reference to office or certifying body

Correspondence regarding this well should be addressed to Mr. Robert O. Egan, Box #121, Louisville, Kentucky 40202

This well is located on Lot 1-22, Block 9-23, Subdivision 1, Louisville, Kentucky 40202. The well is owned by British Bit Company. The well is being drilled to a depth of 1000 feet. The well is being drilled to a depth of 1000 feet. The well is being drilled to a depth of 1000 feet.

The well is being drilled to a depth of 1000 feet. The well is being drilled to a depth of 1000 feet. The well is being drilled to a depth of 1000 feet. The well is being drilled to a depth of 1000 feet. The well is being drilled to a depth of 1000 feet.

The well is being drilled to a depth of 1000 feet. The well is being drilled to a depth of 1000 feet. The well is being drilled to a depth of 1000 feet. The well is being drilled to a depth of 1000 feet. The well is being drilled to a depth of 1000 feet.

The well is being drilled to a depth of 1000 feet. The well is being drilled to a depth of 1000 feet. The well is being drilled to a depth of 1000 feet. The well is being drilled to a depth of 1000 feet. The well is being drilled to a depth of 1000 feet.

The well is being drilled to a depth of 1000 feet. The well is being drilled to a depth of 1000 feet. The well is being drilled to a depth of 1000 feet. The well is being drilled to a depth of 1000 feet. The well is being drilled to a depth of 1000 feet.

The well is being drilled to a depth of 1000 feet. The well is being drilled to a depth of 1000 feet. The well is being drilled to a depth of 1000 feet. The well is being drilled to a depth of 1000 feet. The well is being drilled to a depth of 1000 feet.

The well is being drilled to a depth of 1000 feet. The well is being drilled to a depth of 1000 feet. The well is being drilled to a depth of 1000 feet. The well is being drilled to a depth of 1000 feet. The well is being drilled to a depth of 1000 feet.

The well is being drilled to a depth of 1000 feet. The well is being drilled to a depth of 1000 feet. The well is being drilled to a depth of 1000 feet. The well is being drilled to a depth of 1000 feet. The well is being drilled to a depth of 1000 feet.

COMMONWEALTH OF VIRGINIA  
DEPARTMENT OF LABOR AND INDUSTRY  
DIVISION OF MINES AND QUARRIES  
BIG STONE GAP, VIRGINIA 24219

NOTICE OF INTENTION TO (DRILL) (REDRILL) (DEEPEN) OIL OR GAS WELL

(One copy of this report and three identical copies of a plat or map, on a scale not smaller than 400 feet to the inch, and showing information required by Section 45.1-114, Code of Virginia, 1950, 1954 and the 1966 Cumulative Supplement, must be submitted to the Division of Mines and Quarries, and copies sent by registered mail to all persons defined in above law, prior to obtaining a permit to drill.)

TO: Division of Mines and Quarries  
Drawer V  
Big Stone Gap, Virginia 24219

Box 431  
Prestonsburg, Kentucky 41653

Place  
December 13, 1974  
Date

Gentlemen:

The undersigned proposes to begin as soon as a permit therefor is obtained from the Division of Mines and Quarries, to drill, ~~redrill or deepen~~ (strike out two) a well for oil or gas on the Nell Phipps, et al. Farm, comprising 1423.0 acres, in the Ervinton District of Dickenson County, Virginia, having the fee title thereto, or as the case may be, under grant or lease dated April 9, 1974, made by Nell Phipps, et al., to Philadelphia Oil Co. and recorded on the 21st day of May, 1974 in the office of the County Clerk for said County in Book 165 Page 231. The proposed location of the well, as shown on the attached plat or map, is about 1.95 (feet/miles) Northeast of Wakenva, Virginia and about 2.51 (feet/miles) East of Nora, Virginia.

It is proposed to drill this well to a depth of about 5738 feet. Samples or cutting therefrom will ~~or will not~~ be available for examination by a member of the staff of the Virginia Geological Survey. Cuttings will ~~or will not~~ be furnished the Survey, upon request.

A plat or map, in triplicate, on a scale not smaller than 400 feet to the inch, showing the proposed location of the well and other information, required in Section 45.1-114, Code of Virginia, 1950, 1954 and the 1966 Cumulative Supplement is attached hereto. Copies of the plat and notice of intention to drill, redrill or deepen the aforementioned well have been sent to all interested persons as required by Section 45.1-114, above cited, as follows (list names and mail address of each. Use back of sheet if additional space is required):

1. Miss Nell Phipps, Miss Beulah Phipps and Mrs. Jettie Phipps Dalton
2. Clintwood, Virginia 24228 (Coal Owners)
3. B & C Elkhorn Coal Company, Box 2126, Pikeville, Kentucky 41501
4. (Coal Lessee)
5. \_\_\_\_\_
6. \_\_\_\_\_

Signature of officer or certifying party:

Edward O. Ray  
Name  
Edward O. Ray  
~~XXXX~~

Very truly yours,  
PHILADELPHIA OIL COMPANY  
Drilling Company or Operator  
Box 431  
Street Address  
Prestonsburg, Kentucky 41653  
City or Town and State

File DT-120 Date Received 12-16-74 Well No. P-38

(To be filled in by  
Division of Mines)

COMMONWEALTH OF VIRGINIA  
DEPARTMENT OF LABOR AND INDUSTRY

(To be filled in by  
Division of Mines)

DICKENSON  
County

DIVISION OF MINES

Well No. P-38

ERVINTON  
District

BIG STONE GAP, VIRGINIA

Permit No. 198

NORA  
Map

DEEPENED  
OIL AND GAS WELL COMPLETION REPORT  
ABANDONMENT

Office No. \_\_\_\_\_

Location Plat \_\_\_\_\_

DI-120  
File

(This report and a copy of electrical log, if made, must  
be submitted to the Division of Mines within 30 days after  
abandonment or completion of well, as required by Section  
45-113, Code of Virginia, 1950.)

Company Philadelphia Oil Company

Address P. O. Box 313  
Nora, Virginia 24272

Farm Nell Phipps, et al

Acres 1423.00

County Dickenson

District Ervinton

Well No. (Company) P-38

Elevation (ground surface) 2388.20 ft.

Location: (Give direction and distance in feet or tenths of a mile from two (2) location reference points or map coordinates shown on location plat or map previously filed with the Division of Mines or shown on quadrangle topographic map of area.)

400 feet ~~miles~~ Southeast of Lambert Cemetery and

2350 feet ~~miles~~ Southwest of Sutherland Cemetery

Surface of tract is owned in fee simple by Alger Phipps

Address Clintwood, Virginia 24228

Mineral rights are owned by Nell Phipps, et al

Address Clintwood, Virginia 24228

Location made by Mr. B. C. Spradlin

Drilling commenced May 4, 1975 Drilling contractor Union Drilling, Incorporated

Drilling completed May 17, 1975 Address P. O. Drawer 40, Buckhannon, W.Va. 26201

Well completed as <sup>gas</sup>oil well on \_\_\_\_\_

Well abandoned at \_\_\_\_\_ feet on \_\_\_\_\_; Reason \_\_\_\_\_

Well plugged on \_\_\_\_\_, 19\_\_\_\_ Affidavit filed \_\_\_\_\_, 19\_\_\_\_

Total depth 5752' (KB) feet. Steel line measurement \_\_\_\_\_ feet.

Commenced producing on not connected to pipeline system, 19\_\_\_\_

Oil Well

Initial production, oil: 1st 24 hours \_\_\_\_\_ bbls.; 2nd 24 hours \_\_\_\_\_ bbls.

After shot on \_\_\_\_\_ from \_\_\_\_\_ feet to \_\_\_\_\_ feet with \_\_\_\_\_ lbs. \_\_\_\_\_

After shot on \_\_\_\_\_ from \_\_\_\_\_ feet to \_\_\_\_\_ feet with \_\_\_\_\_ lbs. \_\_\_\_\_

After shot on \_\_\_\_\_ from \_\_\_\_\_ feet to \_\_\_\_\_ feet with \_\_\_\_\_ lbs. \_\_\_\_\_

1st 24 hours \_\_\_\_\_ bbls.; 2nd 24 hours \_\_\_\_\_ bbls.

Settled production \_\_\_\_\_ bbls. per day after producing \_\_\_\_\_ weeks

Gravity and grade of oil \_\_\_\_\_

Oil pays at (1) \_\_\_\_\_ feet to \_\_\_\_\_ feet. Oil shows at (1) \_\_\_\_\_ feet to \_\_\_\_\_ feet.

(2) \_\_\_\_\_ feet to \_\_\_\_\_ feet. (2) \_\_\_\_\_ feet to \_\_\_\_\_ feet.

(3) \_\_\_\_\_ feet to \_\_\_\_\_ feet. (3) \_\_\_\_\_ feet to \_\_\_\_\_ feet.

(4) \_\_\_\_\_ feet to \_\_\_\_\_ feet. (4) \_\_\_\_\_ feet to \_\_\_\_\_ feet.

Main production at \_\_\_\_\_ feet to \_\_\_\_\_ feet. (5) \_\_\_\_\_ feet to \_\_\_\_\_ feet.

Gas Well Final open flow - Berea - 133 MCF Gaged 10 /10ths. Water in 2 inch.

Initial open flow, gas: 6 hr. Rock 2" - 550# \_\_\_\_\_ /10ths. Mercury in \_\_\_\_\_ inch.

Volume \_\_\_\_\_ 4" - 560# cu. ft.

After shot on \_\_\_\_\_ from \_\_\_\_\_ feet to \_\_\_\_\_ feet with \_\_\_\_\_ lbs. \_\_\_\_\_

After shot on \_\_\_\_\_ from \_\_\_\_\_ feet to \_\_\_\_\_ feet with \_\_\_\_\_ lbs. \_\_\_\_\_

After shot on \_\_\_\_\_ from \_\_\_\_\_ feet to \_\_\_\_\_ feet with \_\_\_\_\_ lbs. \_\_\_\_\_

1st 24 hours \_\_\_\_\_ cu ft., 2nd 24 hours \_\_\_\_\_ cu ft.





Well No. P-38File No. DI-120Permit No. 198

## LOG

Furnished by \_\_\_\_\_ Date \_\_\_\_\_

Compiled by E. R. Minns Date 9-30-75

SAMPLE No.	FORMATION	COLOR	HARD OR SOFT	TOP (feet)	BOTTOM (feet)	THICKNESS (feet)	REMARKS OIL, GAS, WATER DEPTHS SHUT DOWN FISHING, ETC.
	Shale			0	17	17	
	Sand			17	140	123	
	Coal			140	142	2	
	Sand & Shale			142	181	39	
	Coal			181	185	4	
	Sand			185	282	97	
	Sand & Shale			282	348	66	
	Shale			348	376	28	
	Coal			376	377	1	
	Sand & Shale			377	409	32	
	Sand			409	457	47	
	Coal			457	460	3	
	Sand			460	502	42	
	Sand & Shale			502	528	26	
	Coal			528	530	2	
	Sand			530	572	42	
	Coal			572	576	4	
	Sand			576	623	47	
	Sand & Shale			623	746	123	
	Sand			746	837	91	
	Shale			837	859	22	
	Sand & Shale			859	937	78	
	Coal			937	938	1	
	Sand & Shale			938	1052	114	
	Sand			1052	1102	50	
	Sand & Shale			1102	1223	121	
	Sand			1223	1267	44	
	Shale			1267	1304	37	
	Sand			1304	1323	19	
	Shale			1323	1387	64	
	Sand & Shale			1387	1470	83	
	Sand			1470	1563	93	
	Sand & Shale			1563	1588	25	
	Coal			1588	1589	1	
	Sand			1589	1690	101	
	Sand & Shale			1690	1771	101	
	Coal			1771	1774	3	
	Sand			1774	1857	83	
	Sand & Shale			1857	1947	90	
	Sand			1947	1976	29	
	Shale			1976	1986	10	
	Coal			1986	1988	2	
	Shale & Sand			1988	2008	20	
	Coall			2008	2010	2	
	Sand & Shale			2010	2125	115	
	Sand			2125	2196	71	
	Coal			2196	2198	2	
	Sand & Shale			2198	2320	122	
	Sand			2320	2408	88	
	Shale			2408	2421	13	
	Sand & Shale			2421	2492	71	
	Sand			2492	2538	46	
	Sand & Shale			2538	2632	94	

Sand	2032	2004	32
Sand & Shale	2664	2684	20
Sand	2684	2736	52
Sand & Shale	2736	2750	14
Sandy Shale	2750	2774	24
Sand & Shale	2774	2793	19
Red Rock	2793	2815	22
Sand & Shale	2815	2984	169
Sand	2984	3024	40
Sand & Shale	3025	3286	261
Sand	3286	3343	57
Sand & Shale	3343	3457	114
Sand	3457	3510	53
Sand & Shale	3510	3545	35
Sand	3545	3630	85
Sand & Shale	3630	3733	103
Sand	3733	3766	33
Sand & Shale	3766	3830	64
Sand	3830	3930	100
Sand & Shale	3930	4025	95
Sand	4025	4050	25
Sand & Shale	4050	4357	307
Shale	4357	4415	38
Big Lime	4415	4943	528
Injun Sand	4943	5027	84
Weir Shells	5027	5140	113
Sand & Shale	5140	5250	110
Shale	5250	5483	233
Coffee Shale	5483	5605	122
Berea	5605	5685	80
Shale	5685	5750	65
Total Depth	5750		

NOTE: DRILLER'S LOG ADJUSTED TO ELECTRIC LOGS

THIS FORM MUST BE SIGNED BY AUTHORIZED PERSON:

---

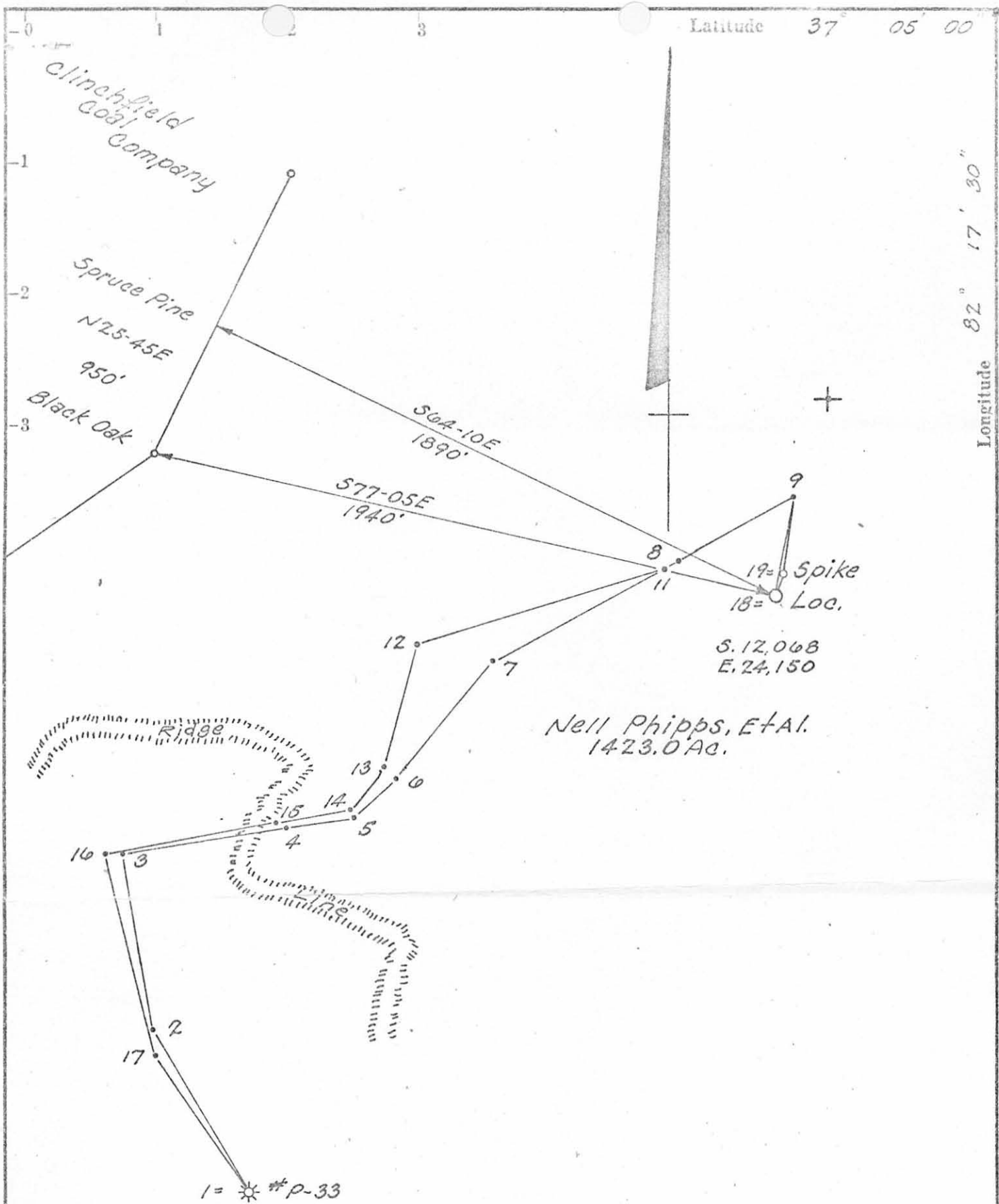

New Location. ■  
 Drill Deeper.....□  
 Abandonment.....□

Block No. 511 Map No. 13

Company Philadelphia Oil Company  
 Address Nora, Virginia  
 Farm Neil Phipps, Et Al.  
 Tract Acres 1423.00 Lease No. P.O.-106  
 Well (Farm) No. \_\_\_\_\_ Serial No. P-38  
 Elevation (Spirit Level) 2388.20'  
 Quadrangle Nora, Virginia  
 County Dickenson District Ervinton  
 Engineer Edw. Owen Ray, Jr.  
 Engineer's Registration No. 3084 L.S. 534-Ky.  
 File No. \_\_\_\_\_ Drawing No. \_\_\_\_\_  
 Date 12-4-74 Scale 1" = 400'

Commonwealth of Virginia  
 Department of Labor And Industry  
 Division of Mines  
 Big Stone, Gap

WELL LOCATION MAP

FILE NO. DI-120

PERMIT NO. 198

+ Denotes location of well on United States Topographic Maps, scale 1 to 24,000, latitude and longitude lines being represented by border lines as shown.

— Denotes one inch spaces on border line of original tracing.



(To be filled in by Division of Mines)

COMMONWEALTH OF VIRGINIA DEPARTMENT OF LABOR AND INDUSTRY

(To be filled in by Division of Mines)

DICKENSON

County

DIVISION OF MINES

Well No. P-38

ERVINTON

District

BIG STONE GAP, VIRGINIA

Permit No. 198

NORA

Map

DEEPENED OIL AND GAS WELL COMPLETION REPORT ABANDONMENT

Office No.

Location Plat

DI-120

File

(This report and a copy of electrical log, if made, must be submitted to the Division of Mines within 30 days after abandonment or completion of well, as required by Section 45-113, Code of Virginia, 1950.)

Company Philadelphia Oil Company
Farm Nell Phipps, et al
County Dickenson
Well No. (Company) P-38

Address P. O. Box 313
Nora, Virginia 24272
Acres 1423.00
District Ervinton
Elevation (ground surface) 2388.20 ft.

Location: (Give direction and distance in feet or tenths of a mile from two (2) location reference points or map coordinates shown on location plat or map previously filed with the Division of Mines or shown on quadrangle topographic map of area.)

400 feet Southeast of Lambert Cemetery and

2350 feet Southwest of Sutherland Cemetery

Surface of tract is owned in fee simple by Alger Phipps
Address Clintwood, Virginia 24228
Mineral rights are owned by Nell Phipps, et al
Address Clintwood, Virginia 24228

Location made by Mr. B. C. Spradlin
Drilling commenced May 4, 1975
Drilling completed May 17, 1975
Drilling contractor Union Drilling, Incorporated
Address P. O. Drawer 40, Buckhannon, W.Va. 26201

Well completed as gas well on oil

Well abandoned at feet on : Reason
Well plugged on , 19 Affidavit filed , 19
Total depth 5752' (KB) feet. Steel line measurement feet.
Commenced producing on not connected to pipeline system, 19

Oil Well
Initial production, oil: 1st 24 hours bbls.; 2nd 24 hours bbls.
After shot on from feet to feet with lbs. qts.
After shot on from feet to feet with lbs. qts.
1st 24 hours bbls.; 2nd 24 hours bbls.
Settled production bbls. per day after producing weeks

Gravity and grade of oil
Oil pays at (1) feet to feet. Oil shows at (1) feet to feet.
(2) feet to feet. (2) feet to feet.
(3) feet to feet. (3) feet to feet.
(4) feet to feet. (4) feet to feet.
Main production at feet to feet. (5) feet to feet.

Gas Well Final open flow - Berea - 133 M Gaged /10ths. Water in inch.
Initial open flow, gas: 6 hr. Rock - 2" - 550# /10ths. Mercury in inch.
Volume 4" - 560# cu. ft.
After shot on from feet to feet with lbs. qts.
After shot on from feet to feet with lbs. qts.
1st 24 hours cu ft., 2nd 24 hours cu ft.
Rock pressure: Initial lbs.; after hours lbs. days
Settled production cu. ft per day after producing weeks

Gas pays at (1) 5615 feet to 5627 feet. Gas shows at (1) feet to feet.
(2) 5644 feet to 5677 feet. (2) feet to feet.
(3) feet to feet. (3) feet to feet.
(4) feet to feet. (4) feet to feet.
Main production feet to feet. (5) feet to feet.

Fresh water at (1) feet, GPM; (2) feet, GPM; (3) feet, GPM.
Salt water at (1) feet; (2) feet; (3) feet; (4) feet.



Well No. P-38

File No. DI-120

Permit No. 198

# LOG

Furnished by \_\_\_\_\_ Date \_\_\_\_\_

Compiled by E. R. Minns Date 9-30-75

SAMPLE No.	FORMATION	COLOR	HARD OR SOFT	TOP (feet)	BOTTOM (feet)	THICKNESS (feet)	REMARKS OIL, GAS, WATER DEPTHS SHUT DOWN FISHING, ETC.
	Shale			0	17	17	
	Sand			17	140	123	
	Coal			140	142	2	
	Sand & Shale			142	181	39	
	Coal			181	185	4	
	Sand			185	282	97	
	Sand & Shale			282	348	66	
	Shale			348	376	28	
	Coal			376	377	1	
	Sand & Shale			377	409	32	
	Sand			409	457	47	
	Coal			457	460	3	
	Sand			460	502	42	
	Sand & Shale			502	528	26	
	Coal			528	530	2	
	Sand			530	572	42	
	Coal			572	576	4	
	Sand			576	623	47	
	Sand & Shale			623	746	123	
	Sand			746	837	91	
	Shale			837	859	22	
	Sand & Shale			859	937	78	
	Coal			937	938	1	
	Sand & Shale			938	1052	114	
	Sand			1052	1102	50	
	Sand & Shale			1102	1223	121	Jb 1200-1202
	Sand			1223	1267	44	
	Shale			1267	1304	37	
	Sand			1304	1323	19	
	Shale			1323	1387	64	
	Sand & Shale			1387	1470	83	
	Sand			1470	1563	93	
	Sand & Shale			1563	1588	25	
	Coal			1588	1589	1	
	Sand			1589	1690	101	
	Sand & Shale			1690	1771	101	
	Coal			1771	1774	3	
	Sand			1774	1857	83	
	Sand & Shale			1857	1947	90	
	Sand			1947	1976	29	
	Shale			1976	1986	10	
	Coal <i>wc</i>			1986	1988	2	
	Shale & Sand			1988	2008	20	
	Coal <i>bc</i>			2008	2010	2	
	Sand & Shale			2010	2125	115	
	Sand			2125	2196	71	
	Coal <i>ch</i>			2196	2198	2	
	Sand & Shale			2198	2320	122	
	Sand			2320	2408	88	
	Shale			2408	2421	13	
	Sand & Shale			2421	2492	71	
	Sand			2492	2538	46	
	Sand & Shale			2538	2632	94	
	Sand			2632	2664	32	
	Sand & Shale			2664	2684	20	
	Sand			2684	2736	52	
	Sand & Shale			2736	2750	14	
	Sandy Shale			2750	2774	24	
	Sand & Shale			2774	2793	19	
	Red Rock			2793	2815	22	
	Sand & Shale			2815	2984	169	
	Sand			2984	3024	40	
	Sand & Shale			3025	3286	261	
	Sand			3286	3343	57	
	Sand & Shale			3343	3457	114	