

COMMONWEALTH OF VIRGINIA
 DEPARTMENT OF CONSERVATION AND ECONOMIC DEVELOPMENT
 DIVISION OF MINERAL RESOURCES

WWCR 456
 VDMR 582

Box 3667, University Station, Charlottesville, Virginia

WATER WELL COMPLETION REPORT

OWNER: Commonwealth of Virginia Mailing Address: _____
 TENANT: U. Va. Hospital Mailing Address: U. Va. Hosp. Charlottesville, Va.
 DRILLER: C. R. Moore Mailing Address: Hazel St., Charlottesville, Va.
 WELL LOCATION: County Albemarle Approx. 25 ^{ft.}/_{miles}
 in front of (direction) of main entrance to new Hospital wing and _____ of _____
(Give direction and distance in feet or tenths of mile from two reference points - roads, towns, rivers, etc. - on county highway or other map)

WATER CONDITIONS

DEPTH

STATIC WATER LEVEL 18'

WATER ZONES (fissures or formations supplying water)

(from) (to) (from) (to)
70 ft. _____, _____ ft.
135 ft. 145, _____ ft.

QUANTITY OF WATER

WELL PUMPED (~~or bailed~~) at 25 Gal. per Min. with
~~≠~~ 60 feet DRAWDOWN after 30 HOURS PUMPING.

FLOW (natural) _____ G.P.M. HEAD _____ ft. (above ground) **W**

REMARKS: _____

QUALITY OF WATER

COLOR clear TASTE none

ODOR none OTHER _____

ANALYSIS: AVAILABLE - Yes No ATTACHED Yes No

TEMPERATURE _____

WATER (from) _____ ft. (to) _____ ft.
(salt, brackish, iron, sulfur, acid, other)

USE OF WATER: Domestic Town Industry Farm Public

CONSTRUCTION

RIG TYPE (or method) (rotary, cable, bored, driven, etc.)

DATE: Started 9/18/61; Completed 10/6/61

TOTAL DEPTH 150 ft.

BEDROCK at 45 ft.

GROUTING INFORMATION

METHOD USED Poured cement

GROUTING MATERIAL 3 yds cement

DEPTH OF GROUTING 53

HOLE SIZE

(diam) (from) (to)
12 in 0 ft 50 ft
6 50 150

CASING SIZE

(diam) (from) (to)
6 ID in 0 ft 53 ft

SCREEN (or perforations)

(diam) (from) (to) (opening size)
 _____ in _____ ft _____ ft

PUMP (installed)

not installed (10/12/61)

TYPE _____ Cap. (gpm) _____

H.P. _____ Depth of intake _____ ft.

REMARKS: Samples saved for Va. Div. of Min. Res. (14)

WATER WELL COMPLETION REPORT

456

W-582

OWNER: Commonwealth of Virginia Mailing Address: _____
 TENANT: U. Va. Hospital Mailing Address: U. Va. Hosp. Charlottesville, Va.
 DRILLER: C. R. Moore Mailing Address: Hazel St. Charlottesville, Va.
 WELL LOCATION: County ALBEMARLE CHARLOTTESVILLE Approx. 25 ft. 25 miles
in front of (direction) of main entrance to new Hospital wing of _____
(Give direction and distance in feet or tenths of mile from two reference points—roads, towns, rivers, etc.—on county highway or other map.)

WATER CONDITIONS

DEPTH
 STATIC WATER LEVEL 18'
 WATER ZONES (fissures or formations supplying water)
 (from) (to) (from) (to)
90 ft. _____ ft. _____ ft. _____ ft.
135 ft. 145 ft. _____ ft. _____ ft.
 QUANTITY OF WATER
 WELL PUMPED (or bailed) at 25 Gal. per Min. with
60 feet DRAWDOWN after 30 HOURS PUMPING.
 FLOW (natural) _____ G.P.M. HEAD _____ ft. (above ground)
 REMARKS: _____

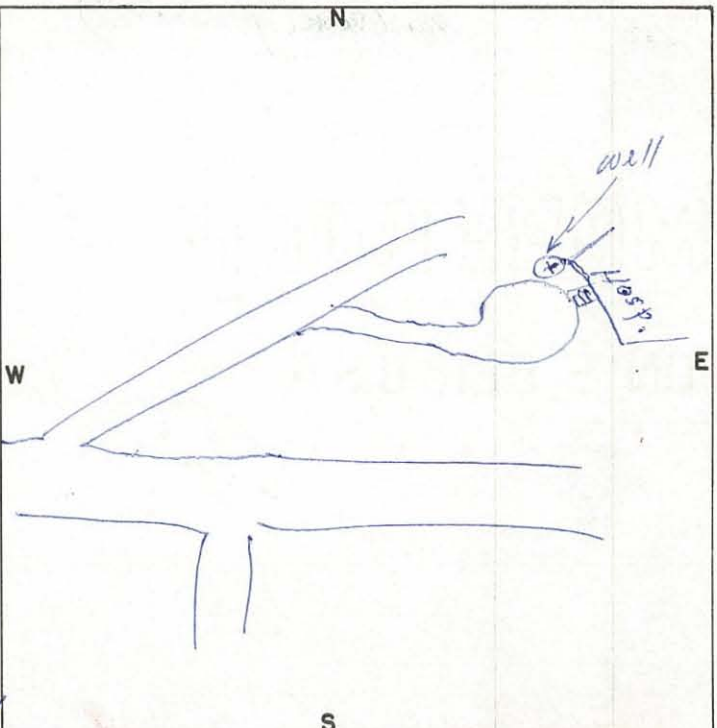

QUALITY OF WATER
 COLOR clear TASTE None
 ODOR None OTHER _____
 ANALYSIS: AVAILABLE— Yes No ATTACHED Yes No
 TEMPERATURE _____
 WATER (from) _____ ft. (to) _____ ft.
(salt, brackish, iron, sulfur, acid, other)
 USE OF WATER: Domestic Town Industry Farm Public

CONSTRUCTION

RIG TYPE (or method) _____
(rotary, cable bored, driven, etc...)
 DATE: Started 9/18/61; Completed 10/6/61
 TOTAL DEPTH 150 ft.
 BEDROCK at 45 ft.
 GROUTING INFORMATION
 METHOD USED Toured Cement
 GROUTING MATERIAL 3 yds cement
 DEPTH OF GROUTING 53

HOLE SIZE				CASING SIZE			
(diam.)	(from)	(to)		(diam.)	(from)	(to)	
<u>12</u>	<u>0</u>	<u>50</u>	ft.	<u>6 ID</u>	<u>0</u>	<u>53</u>	ft.
<u>6</u>	<u>50</u>	<u>150</u>					

SCREEN (or perforations)
 (diam.) (from) (to) (opening size)
 _____ in _____ ft. _____ ft. _____

PUMP (installed) Not installed (10/12/61)

TYPE _____ Cap. (gpm) _____
 H.P. _____ Depth of intake _____ ft.

REMARKS: Samples saved for Va. Div. of Min. Res. (74)
Savins or Moore 2267

LOG

FURNISHED BY

CR Moore

DATE:

10/12/61

DEPTH (feet)		TYPE OF SOIL OR ROCK PENETRATED (gravel, clay, etc., hardness, color, etc)	REMARKS (water, caving, shot, screen, sample, etc)
FROM	TO		
0	45	overburden (20' fill/dirt)	4 gpm @ 70'
45	75	mica schist	
75	95	granite	135-145' "River"
95	150	mica schist w/hard layers	
150		Hard Rock (granite?)	
		<p>W. W. Moore Box # 8 U. of Va. Hospital</p>	