



COMMONWEALTH OF VIRGINIA  
DEPARTMENT OF CONSERVATION AND ECONOMIC DEVELOPMENT

DIVISION OF MINERAL RESOURCES

Box 3667, University Station, Charlottesville, Virginia

WWCR-#130  
VDMR-#528

WATER WELL COMPLETION REPORT

OWNER: J. S. Lavinder Mailing Address: Rt. # 2 Martinsville, Va.  
 TENANT: Son in law Mailing Address: Same  
 DRILLER: Fitts Pump & Well Co. Mailing Address: Same  
 WELL LOCATION: County Henry Approx. 1/4 mi. ft. miles  
East (direction) of Harrison's Store Turn right here on dirt street.

(Give direction and distance in feet or tenths of mile from two reference points - roads, towns, rivers, etc. - on county highway or other map.)

**WATER CONDITIONS**

**DEPTH**

STATIC WATER LEVEL 70'

WATER ZONES (fissures or formations supplying water)

(from)	(to)	(from)	(to)
<u>80</u> ft.	<u>94</u> ft.		

**QUANTITY OF WATER**

WELL PUMPED (or bailed) at 6 Gal. per Min. with 10 feet DRAWDOWN after 2 HOURS PUMPING.

FLOW (natural) \_\_\_\_\_ G.P.M. HEAD \_\_\_\_\_ ft. (above ground)

REMARKS: small amount of storage

**QUALITY OF WATER**

COLOR clear TASTE normal

DOR none OTHER \_\_\_\_\_

ANALYSIS: AVAILABLE - Yes  No  ATTACHED Yes  No

TEMPERATURE \_\_\_\_\_  
 WATER (from) \_\_\_\_\_ ft. (to) \_\_\_\_\_ ft.  
 (salt, brackish, iron, sulfur, acid, other)

USE OF WATER: Domestic  Town  Industry  Farm  Public

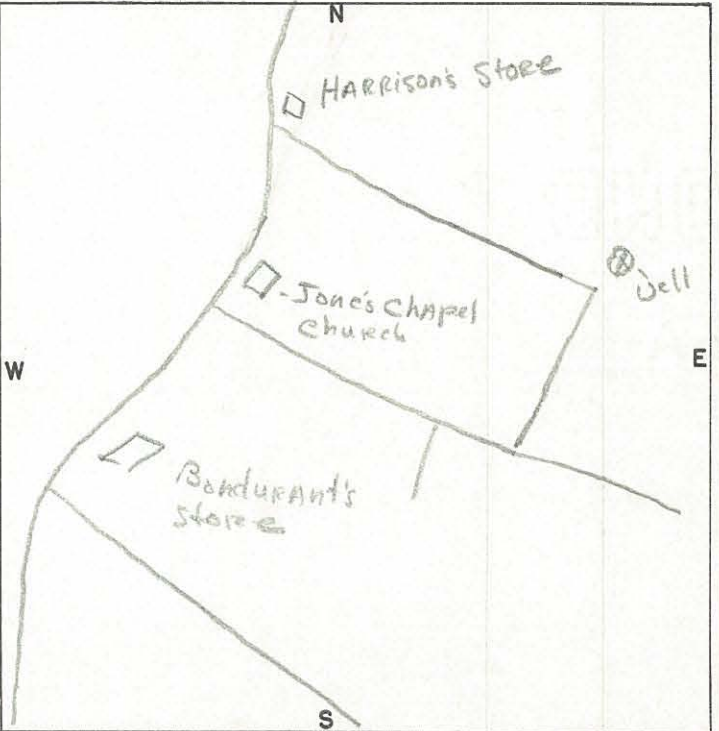

**CONSTRUCTION**

RIG TYPE (or method) Cable  
 (rotary, cable, bored, driven, etc..)

DATE: Started May 10; Completed 16, 61

TOTAL DEPTH 94 ft.

BEDROCK at 94 ft.

**GROUTING INFORMATION**

METHOD USED none

GROUTING MATERIAL \_\_\_\_\_

DEPTH OF GROUTING \_\_\_\_\_

**HOLE SIZE**

(diam) \_\_\_\_\_ in. (from) \_\_\_\_\_ ft. (to) \_\_\_\_\_ ft.

**CASING SIZE**

(diam) \_\_\_\_\_ in. (from) \_\_\_\_\_ ft. (to) \_\_\_\_\_ ft.

5, 5/8"

**SCREEN (or perforations)**

(diam.) \_\_\_\_\_ in. (from) \_\_\_\_\_ ft. (to) \_\_\_\_\_ ft. (opening size)

**PUMP (installed)**

TYPE \_\_\_\_\_ Cap. (gpm) \_\_\_\_\_

H.P. \_\_\_\_\_ Depth of intake \_\_\_\_\_ ft.

REMARKS: Well drilled in saprolite all the way from 30 ft. to finish.



COMMONWEALTH OF VIRGINIA  
DEPARTMENT OF CONSERVATION AND ECONOMIC DEVELOPMENT  
DIVISION OF MINERAL RESOURCES

W-528

Box 3667, University Station, Charlottesville, Virginia

WATER WELL COMPLETION REPORT

OWNER: J. S. Lavinder Mailing Address: Rt. #2 Martinsville, Va.  
TENANT: Son in law Mailing Address: Same  
DRILLER: Fitts Pump & Well Co. Mailing Address: Same  
WELL LOCATION: County Henry Co. Approx. 1/4 mi. East ft. miles  
(direction) of Harrison's Store Turn right here on dirt street.

(Give direction and distance in feet or tenths of mile from two reference points—roads, towns, rivers, etc.—on county highway or other map)

WATER CONDITIONS

DEPTH  
STATIC WATER LEVEL 70'  
WATER ZONES (fissures or formations supplying water)  
30 ft (from) ft. 94 (to) ft. , (from) ft. (to) ft.  
QUANTITY OF WATER  
WELL PUMPED (or bailed) at 6 Gal. per Min. with  
10 feet DRAWDOWN after 2 HOURS PUMPING.  
FLOW (natural) \_\_\_\_\_ G.P.M. HEAD \_\_\_\_\_ ft. (above ground)  
REMARKS: small amount of storage

QUALITY OF WATER  
COLOR Clear TASTE Normal  
ODOR None OTHER \_\_\_\_\_  
ANALYSIS: AVAILABLE— Yes  No  ATTACHED Yes  No   
TEMPERATURE \_\_\_\_\_  
WATER \_\_\_\_\_ (from) ft. (to) ft.  
(salt, brackish, iron, sulfur, acid, other)  
USE OF WATER: Domestic  Town  Industry  Farm  Public

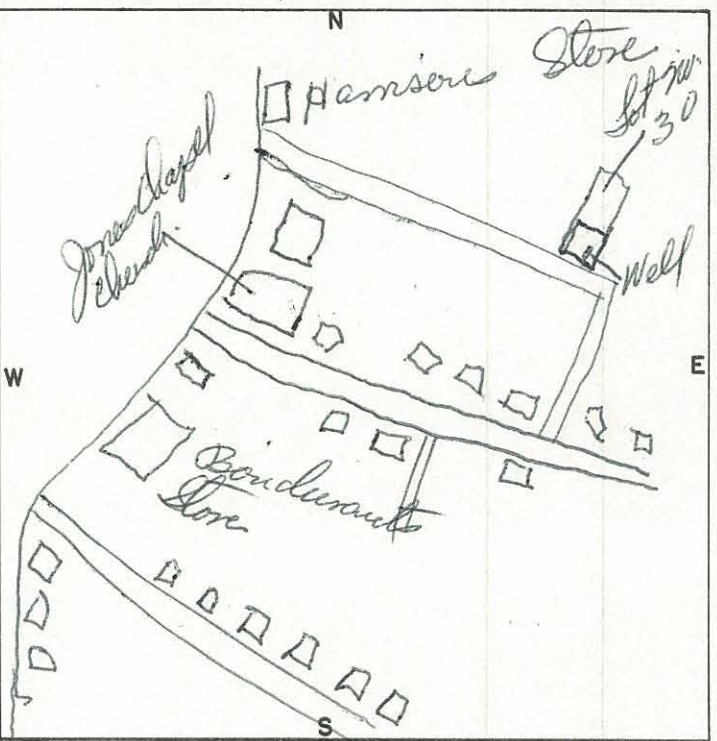

CONSTRUCTION

RIG TYPE (or method) cable  
(rotary, cable, bored, driven, etc.)  
DATE: Started may 10; Completed 16 61  
TOTAL DEPTH 94 ft.  
BEDROCK at 94 ft.  
GROUTING INFORMATION  
METHOD USED none  
GROUTING MATERIAL \_\_\_\_\_  
DEPTH OF GROUTING \_\_\_\_\_

HOLE SIZE (diam) \_\_\_\_\_ in. (from) \_\_\_\_\_ ft. (to) \_\_\_\_\_ ft.  
CASING SIZE (diam) \_\_\_\_\_ in. (from) \_\_\_\_\_ ft. (to) \_\_\_\_\_ ft.  
5, 5/8"  
SCREEN (or perforations) (diam.) \_\_\_\_\_ in. (from) \_\_\_\_\_ ft. (to) \_\_\_\_\_ ft. (opening size)

PUMP (installed)

TYPE \_\_\_\_\_ Cap. (gpm) \_\_\_\_\_  
H.P. \_\_\_\_\_ Depth of intake \_\_\_\_\_ ft.

REMARKS: Well drilled in saprolite all the way from 30 ft to finnish.

COMMONWEALTH OF VIRGINIA

## LOG

DEPARTMENT OF CONSERVATION AND ECONOMIC DEVELOPMENT  
DIVISION OF MINERAL RESOURCES

FURNISHED BY \_\_\_\_\_

DATE: \_\_\_\_\_

DEPTH (feet)		TYPE OF SOIL OR ROCK PENETRATED (gravel, clay, etc., hardness, color, etc)	REMARKS (water, caving, shot, screen, sample, etc)
FROM	TO		

VIRGINIA DIVISION OF

# RECEIVED

FEB 7 1961

# RECEIVED

MINERAL RESOURCES