

Log # 175 W # 1547 County Nansemond - 169 Date 3/19/66

Owner City of Norfolk - Lake Prince #3 Use \_\_\_\_\_ Town \_\_\_\_\_

Location 16500 feet west of Reids Ferry and 8000 feet north/northwest of Kings Fork

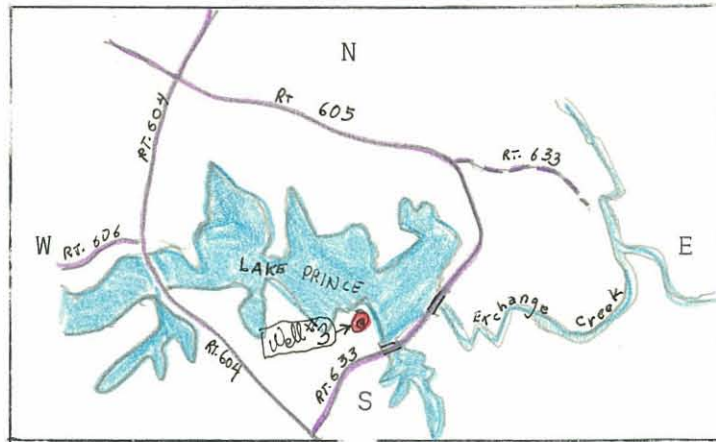

Well Data

Driller: Layne and Bowler, Inc.  
Completed: 3/29/66  
Total Depth: 1020  
Static W. L.: \_\_\_\_\_  
Casing: 20' x 368', Casing & Screening - 12" x 368-959'  
Bedrock \_\_\_\_\_  
Hole Size: \_\_\_\_\_  
Yield: \_\_\_\_\_  
H<sub>2</sub>O Temp: \_\_\_\_\_  
Aquifers: \_\_\_\_\_  
Elev: \_\_\_\_\_  
Geology: \_\_\_\_\_

Instrument Data

SP setting 10 Approx. \_\_\_\_\_ °/min.  
Res. " 5 " \_\_\_\_\_ °/min.  
Gamma " \_\_\_\_\_ " \_\_\_\_\_ °/min.  
T. C. " \_\_\_\_\_  
Fluid: \_\_\_\_\_  
Running Time \_\_\_\_\_ Hrs. \_\_\_\_\_ Mins.  
Depth of Log: Elec. 1020 ° Gamma \_\_\_\_\_ °  
Ground Electrode \_\_\_\_\_  
\_\_\_\_\_

Remarks \_\_\_\_\_  
\_\_\_\_\_  
\_\_\_\_\_

Logged By Layne & Bowler, Inc.