

Log # 215N W # 2497 County Mecklenburg #83 Date 9/22/69

Owner Chase City Well #15 Use Municipal

Location On south side of T600, between T 1021 and State Road 92.

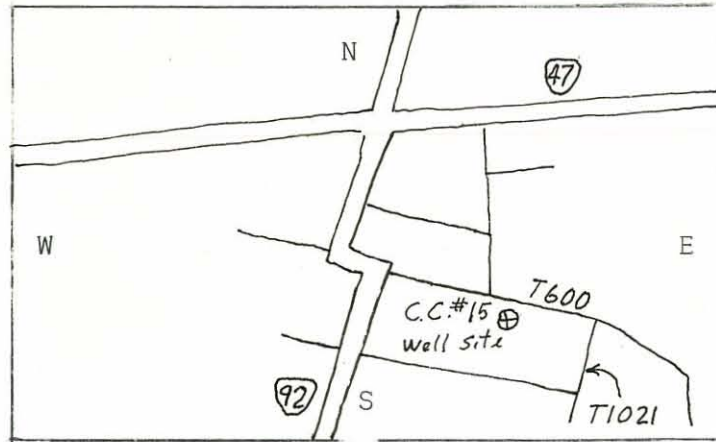

Well Data

Driller: C. C. Powell
Completed: April 4, 1969
Total Depth: 300'
Static W. L.: 32' (logger)
Casing: 63' 10"
Bedrock 60'
Hole Size: 12" x 0-63', 6" x 63'-300'
Yield: 100 gpm
H₂O Temp:
Aquifers: 73-75, 120-121, 184-185'
Elev:
Geology: Hornblende Gneiss

Instrument Data

SP setting 100 MV Approx. 50'/min.
Res. " 200 Ohm-m 50'/min.
Gamma " _____ " '/min.
T. C. " _____
Fluid: Fresh Water
Running Time _____ Hrs. 45 Mins.
Depth of Log: Elec. 297' Gamma _____
Ground Electrode Mud pit

Remarks Caliper Log (295')

Logged By Fulkerson and Gathright