

Log # 194 W # _____ County Southampton (232*) Date 4/20/67

Owner Norfolk & Western Railway Use Industrial

Location 200 yards east of intersections of highways 713 & 739 at Sebrell.

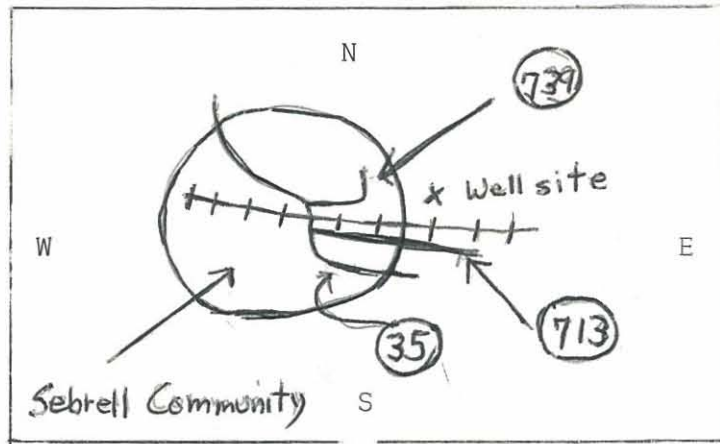

Well Data

Driller: _____

Completed: _____

Total Depth: 80

Static W. L.: _____

Casing: 4"

Bedrock _____

Hole Size: _____

Yield: _____

H₂O Temp: _____

Aquifers: _____

Elev: _____

Geology: _____

Instrument Data

SP setting _____ Approx. _____ /min.

Res. " _____ " _____ /min.

Gamma " .005 Mr. " 27 /min.

T. C. " 16

Fluid: Fresh water

Running Time _____ Hrs. 20 Mins.

Depth of Log: Elec. _____ Gamma 79

Ground Electrode _____

Remarks * May be 364

May be 364.

Logged By Winters & Teifke