

Log # 163 W # None County Augusta 339 Date April 28

Owner Rosenfeld Shopping Center #3 Use Public

Location 300 feet east of Co. Rte. # 613 at point $\frac{1}{2}$ mile south of inter-
section with U. S. Rte. #11.

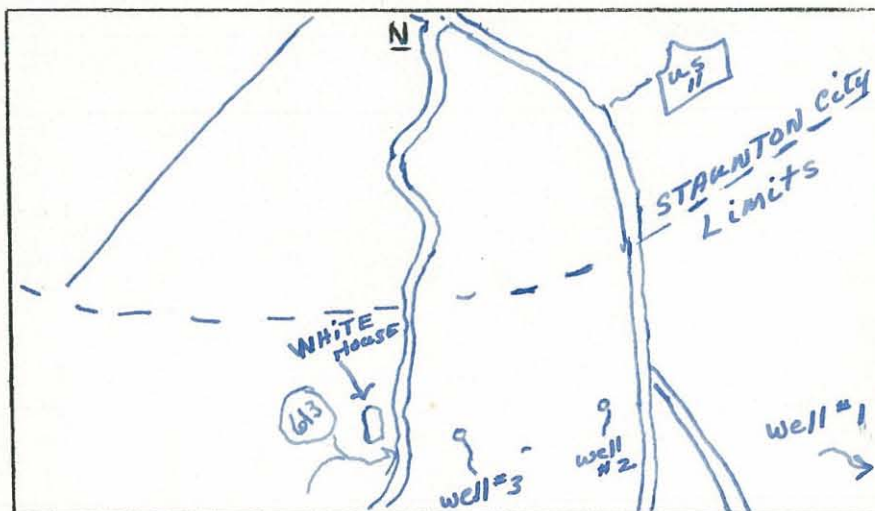

Well Data

Driller: C. R. Moore

Completed: 7/24/64

Total Depth: 250'

Static W. L.: 24'-50' (from driller)
(20' when logged)

Casing: 8" from 0 to 30'
6 $\frac{1}{2}$ " from 0 to 97'

Bedrock:

Hole Size: 6 $\frac{1}{2}$ "

Yield: 284 gpm

H₂O Temp: -

Aquifers: 0-70' (cased off), 95' & 240'.

Elev:

Geology: Conococheague Fm.

Instrument Data

SP setting 50 Approx. 48'/min.

Res. " 200 " 48'/min.

Gamma " .01 " 20'/min.

T. C. " E-3, G-16

Fluid: Fresh water

Running Time 1 Hrs. 10 Mins.

Depth of Log: Elec. 229 ' Gamma 229 '

Ground Electrode 30' below SWL

Remarks _____

Logged By _____