

Log # 131 W # 1072 County Page 84 Date 21 June

Owner S. N. P. Lewis Mt. #1 Use Public

Location 20' E. of Skyline Drive at entrance to Lewis Mt. camping area.

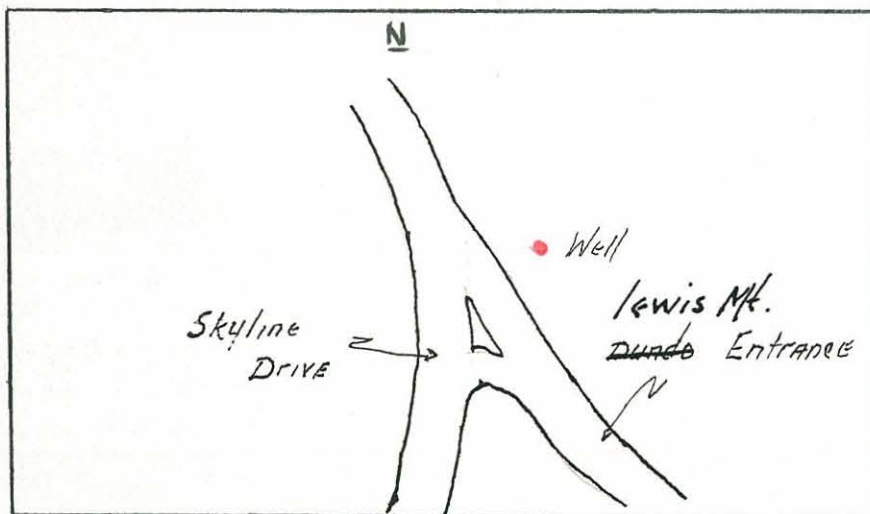

Well Data

Instrument Data

Driller: Frank W. Martin Drilling Co. SP setting 20 Mv Approx. 46'/min.

Completed: 1 June 64 Res. " 200 Ohm-m " 46'/min.

Total Depth: 300 (driller), 303 (logger) Gamma " .005 Mr " 30'/min.

Static W. L.: 56' (driller), 64.9' T. C. " E-3, G-16  
M-scope

Casing: 7" x 52' Fluid: Fresh water

Bedrock: Running Time 1 Hrs. 0 Mins.

Hole Size: 10" - 0-52', 6" - 52-300' Depth of Log: Elec. 301 ' Gamma 301 '

Yield: 15 GPM Ground Electrode 75' down hole

H<sub>2</sub>O Temp: \_\_\_\_\_

Aquifers: 54-55', 104-105'

Elev: 3350 - Lewis Mt. Plat

Geology: Catocin, Swift Run, & Pedlar formations

Remarks \_\_\_\_\_  
\_\_\_\_\_  
\_\_\_\_\_

Logged By Wilkenloh - Gatlin