

Log # 128 W # 992 County Albemarle - 930 Date 4/20/64

Owner Morton Frozen Foods, Inc. #6 Use Industrial

Location 250' South of St. Route 240 & 15' West of Main Plant Building

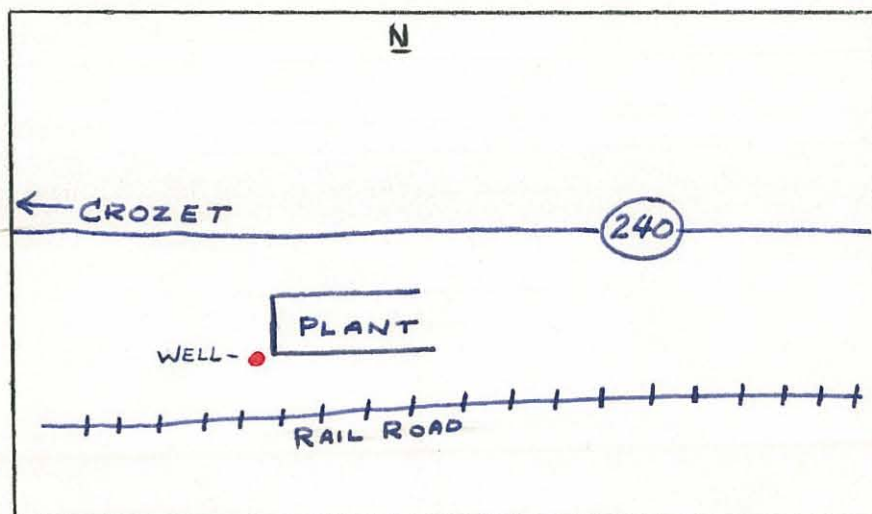

Well Data

Driller: C. R. Moore

Completed: 4/18/64

Total Depth: 1100' (logger)

Static W. L.: 263 (tape)

Casing: 6" x 51

Bedrock:

Hole Size: 12" x 0 - 51  
6 1/2" x 51'-620', 6" x 620'-1100'

Yield:

H<sub>2</sub>O Temp:

Aquifers: 1040' & 1070'

Elev:

Geology:

Instrument Data

SP setting 50 Mv Approx. 47' /min.

Res. " 200 Ohm-m " 47' /min.

Gamma " .01 Mr " 25' /min. .005 21/m'

T. C. " E-3, G-10

Fluid: Fresh water

Running Time 2 Hrs. 45 Mins.

Depth of Log: Elec. 1100' Gamma 1100'

Ground Electrode in 1' deep pit 15'

from well

Remarks Logging speed slows a/depth

Logged By DeKay & Sheffield