

Log # 122 W # \_\_\_\_\_ County Stafford - 48 Date 4 & 18 Mar. '64

Owner Hamilton Hills - Test Hole #3 Use Public

Location On N. Side of Rt. 676, 0.65 miles E. of U. S. 1 at Cranes Corner.

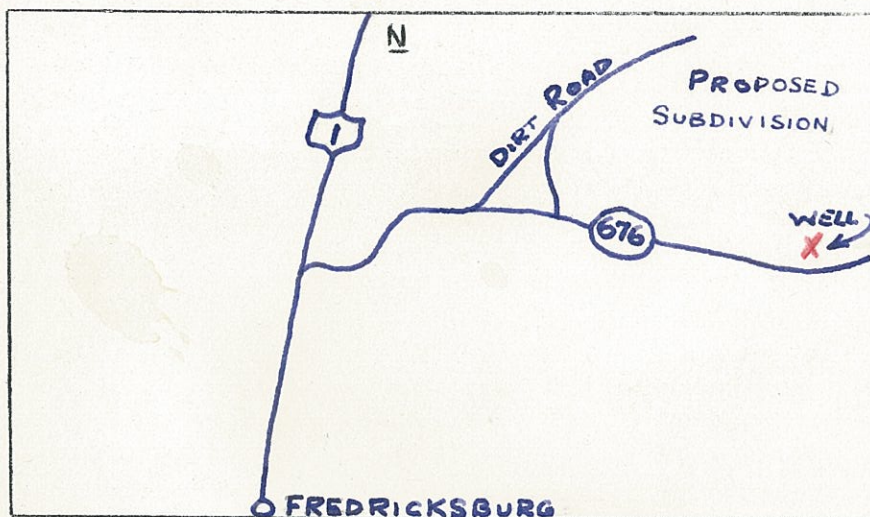

Well Data

Driller: John T. Ellington

Completed:

Total Depth: 475' Driller

Static W. L.: 60.8' (18 Mar.)

Casing: 280'

Bedrock: 260

Hole Size: 12"-0'260, 6" 260-475

Yield: 18 GPM

H<sub>2</sub>O Temp:

Aquifers: 135-140      145-150

Elev: Approx. 130' (topo)

Geology: 0-260 Coastal Plain  
Patuxent Fm.  
260-475 Piedmont

Instrument Data

SP setting ↓ 20 MV Approx. 46' /min.

Res. " ↓ 200 " 46' /min.

Gamma " ↓ .01 ↑ 1.005 " ↑ ↓ 30 ' /min.

T. C. " E-3, G-14

Fluid: Fresh water mud

Running Time 1 Hrs. 10 Mins.

Depth of Log: Elec. 280 ' Gamma 280 '

Ground Electrode In hole in fresh water mud

SP Setting ↑ 20 MV Approx. 44' Min.

Res. " ↑ 200 " 44' Min.

Gamma " ↑ .005 " 28' Min.

T. C. E-3, G-16

Fluid: Fresh water - Depth: 400 '

4 Mar.  
0-280'

18 Mar.  
260-400'

Remarks Well was logged in 2 sections, Mar. 4 0-280 uncased, Mar. 18 drilled to 475, logged 260-400'. Hole obstruction at 400'.

Logged By Wilkenloh - Sheffield