

Log # 119 W # - County Orange - 50 Date 2/8/64

Owner Colonial Pipeline Company Use Industrial

Location N.W. side of State Route 20, 3 miles S.W. of Locust Grove.

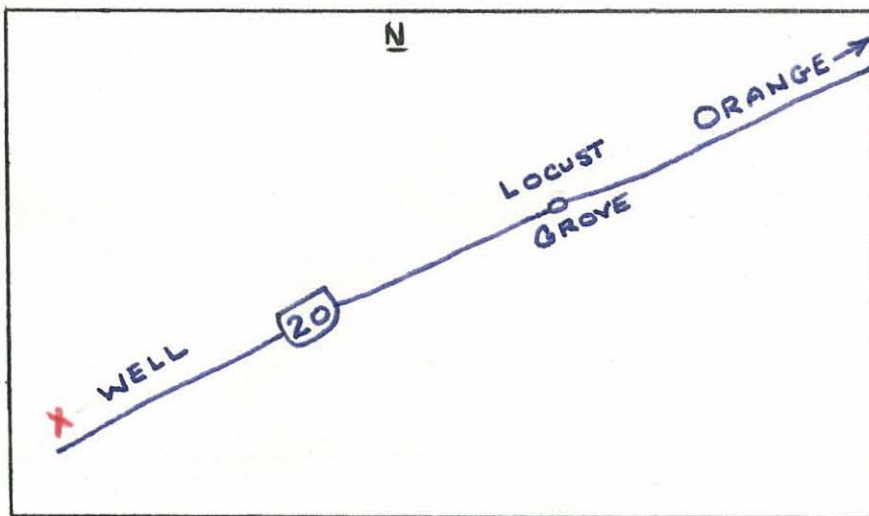

Well Data

Driller: J. T. Ellington
Completed: 2/8/64
Total Depth: 231' (driller)
Static W. L.: *
Casing: 41"
Bedrock: 18"
Hole Size: 6"
Yield: 1 gpm
H₂O Temp: 55° F
Aquifers: 115
Elev: 400' (topo)
Geology: chlorite gr gn

Instrument Data

SP setting 20 ↑ Approx. 45' /min.
Res. " 50 ↑ " 45' /min.
Gamma " .005 ↑ " 28' /min.
T. C. " E 3, G 16
Fluid: Fresh water
Running Time 1 Hrs. 0 Mins.
Depth of Log: Elec. 231 ' Gamma 231 '
Ground Electrode down hole in water

Remarks * SWL 41' 2 days after air lift. SWL during logging; approximately 128' up log, 136' down log.

Logged By DeKay & Wilkenloh