

Log # 108 W # 870 County Rockingham #455 Date 10/3/63

Owner Ashby Heights #3 (J. Horsley) Use Public

Location 1 mile southeast of Harrisonburg, 350 yards northeast of state route 659 (Port Republic Rd.)

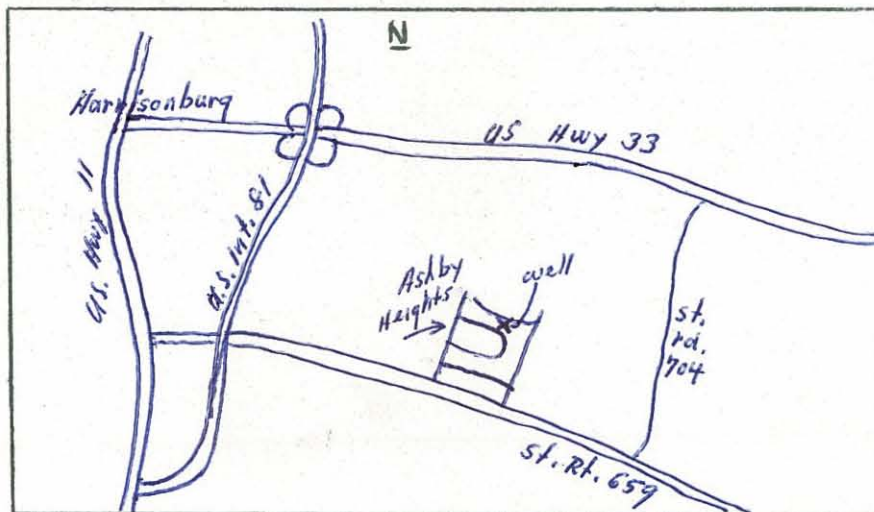

Well Data

Driller: C. R. Moore

Completed: 8/9/63

Total Depth: 781' (driller)

Static W. L.: 144' (logger)

Casing: 6½" x 51'

Bedrock: 3'

Hole Size: 6½" x 781'

Yield: 3½ gpm

H₂O Temp: 56.8 F

Aquifers: 372-375'

Elev: 1500' (topo.)

Geology: Beekmantown dol. (cherty near top of Hill)

Instrument Data

SP setting 100 Mv Approx. 58' /min. up log

Res. " 200 ohm-m " 47' /min. down log

Gamma " .005 Mr " 30' /min. down log

T. C. " E 3, G16

Fluid: Fresh water

Running Time 1 Hrs. 30 Mins.

Depth of Log: Elec. 777 ' Gamma 778 '

Ground Electrode down hole, 10' in water

Remarks Pump interference 228'-520' (resistance log). Pump is in storage & pressure tanks located 20' from well.

Logged By DeKay & Wilkenloh