

Log # 95 W # 851 County _____ Page - 72 Date 7/1/63

Owner SNP Headquarters # 1 Use Public

Location Approximately 4 miles E. of Luray, Virginia on U. S. Highway 211;
approximately 300 yds N. of U. S. Highway 211.

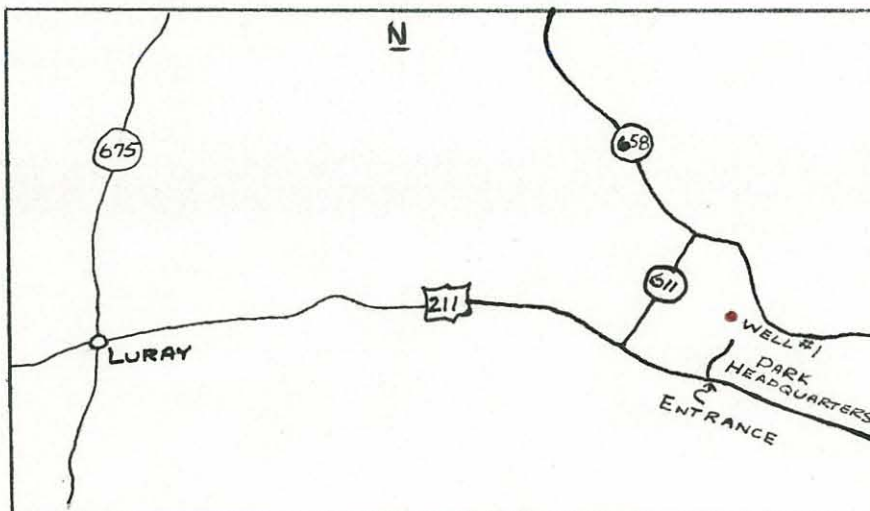

Well Data

Driller: Sydnor

Completed: 6/5/63

Total Depth: 280' (driller)

Static W. L.: 43.10' (tape)

Casing: 6 7/16" x 0-52'

Bedrock: 11'
10" x 0'-50'

Hole Size: 6 1/4 x 50'-280'

Yield: 15 GPM

H₂O Temp: 56° F.

Aquifers: 56'-57', 89'-107', 117'-118',
149'-150' (driller)

Elev: 1,210' (topo)

Geology: Catoctin greenstone

Instrument Data

SP setting 50 Mv Approx. 48'/min.

Res. " 200 Ohm/m " 48'/min.

Gamma " .0025 Mr " 28'/min.

Gamma " .005 Mr " 28'/min.

T. C. " E-3; G-16

Fluid: Fresh Water

Running Time 1 Hrs. 45 Mins.

Depth of Log: Elec. 275' Gamma 273'

Ground Electrode 3' below SWL in casing

Remarks Casing 2' above ground level. Well # 1 is 8' 2" higher in elevation than
Well # 2 and is approximately 528 ft. W. of Well # 2.

Logged By Whitfield and Wilkenloh