

Log # 78 W # 715 County Albemarle - 839 Date 12/5/62

Owner National Park Service Well #1 Loft Mt. #3 Use Public

Location (Loft Mt.) Approximately 15 miles south of Swift Run Gap on Skyline Drive between mileposts 79 and 80; .3 mile east of Skyline Drive on dirt road.

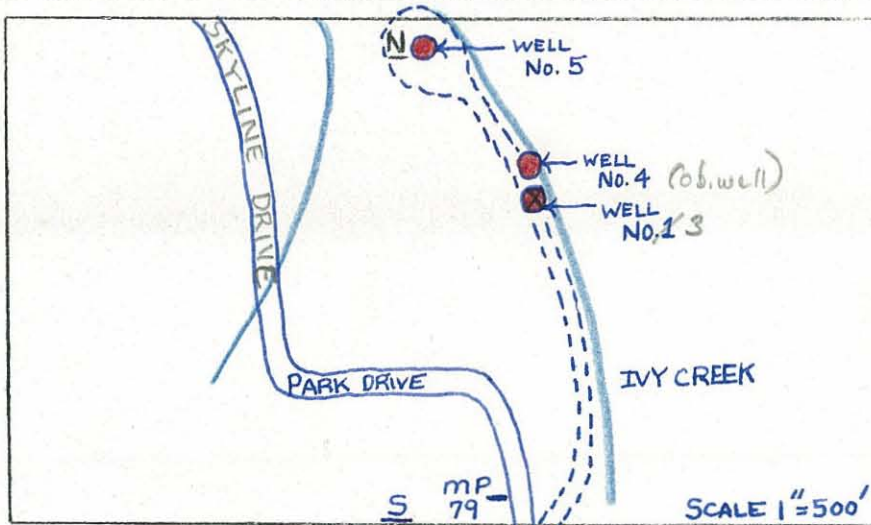

Well Data

Driller: Marvin Seek  
Completed: 9/10/62  
Total Depth: 303 (Driller)  
301 (Logger)  
Static W. L.: 9.7'  
Casing: 6" x 0' - 65'  
Bedrock: 47'  
Hole Size: 10" x 0' - 64'  
6" x 64' - 303'  
Yield: 20 GPM  
H<sub>2</sub>O Temp: 49° F.  
Aquifers: 123, 134  
Elev: 2,700' (Topo Sheet)  
Geology: Pre-Cambrian - Catoctin fm.

Instrument Data

SP setting ↑ 20 Mv Approx. 32' /min.  
Res. " ↑ 200 ohm-M " 32' /min.  
Gamma " ↓ .005 Mr " 28' /min.  
T. C. " E-3; G-16  
Fluid: Fresh water  
Running Time 1 Hrs. 10 Mins.  
Depth of Log: Elec. 301 ' Gamma 301 '  
Ground Electrode Down hole 2' in fresh  
water

Remarks Casing approximately 4' above ground level. Well #1 is 100' South of  
Well #4; 1000' North of milepost #79. Well is 15' West of Ivy Creek

Logged By \_\_\_\_\_  
Whitfield & Nottingham