

Log # 65 W # 692 County Albemarle - 837 Date 8/20/62

Owner Cushman Va. Corp. Use Municipal

Location Approximately .8 mile north of Farmington Country Club House
off Brook Rd. on a private road.

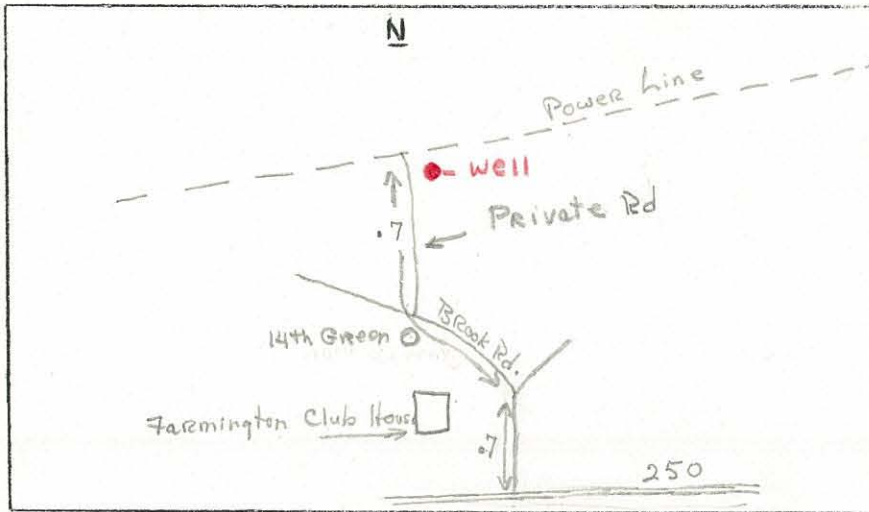

Well Data

Driller: C. R. Moore & Frank
Completed: 7/28/62
Total Depth: 307 (driller)
296 (logger)
Static W. L.: 50' (driller)
50' (logger)
Casing: 6" x 71' (driller)
70' (logger)
Bedrock: 23'
Hole Size: 12-1/2" x 25
8" x 48
Yield: 30 gpm
H₂O Temp: 56°
Aquifers: 137-147 & 277-297
Elev: 555' (topo)
Geology: Lovington fm.

Instrument Data

SP setting 20 Mv Approx. 48' /min. ↑
Res. " 200 Ohm-m " 48' /min.
Gamma " .0025 Mr " 32' /min. ↓ & 28' /min.
T. C. " E 3, G 16
Fluid: Fresh water
Running Time 2 Hrs. 10 Mins.
Depth of Log: Elec. 296 ' Gamma 296 '
Ground Electrode 1' in water down hole

Remarks Well probably filled in from 307' to 296'
Power lines cross within 20 yards of well site
SWL by tape from top of casing - 50'

Logged By Whitfield and Nottingham