

Log # 27 W # 367 County King George - 21 Date 9/3/59

Owner U. S. Naval Proving Grounds Use Municipal supply

Location 1/4 mile N of dead end rt. 618 and 1/4 mile S of dead end route 624.

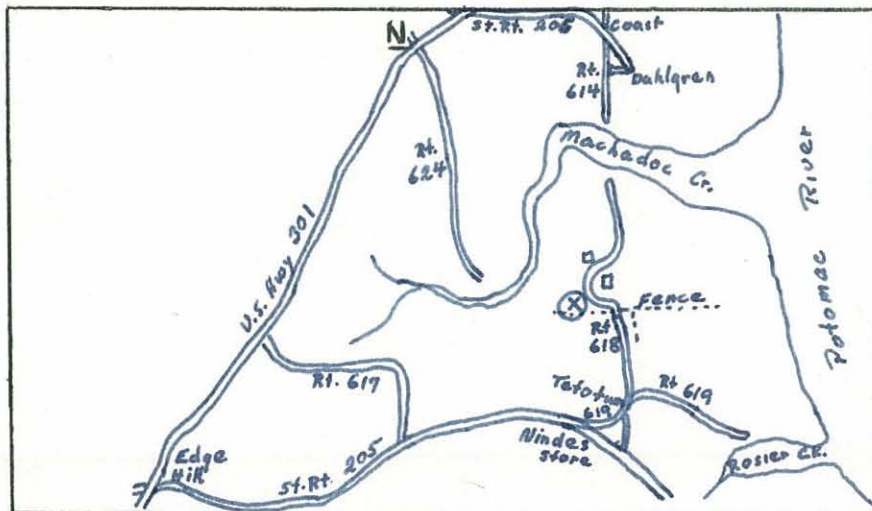

Well Data

Driller: J. T. Ellington

Completed: 9/3/59

Total Depth: 820'

Static W. L.: 20'

Casing: none (8" & 6" casing to be installed)

Bedrock: not reached

Hole Size: 14" to 400', 7 1/2" to 820'

Yield: \approx 25 gpm

H₂O Temp: \approx 52° F.

Aquifers:

Elev: \neq 22'

Geology:

Instrument Data

SP setting 20 Mv. Approx. 60' /min.

Res. " 5 ohm-m " 60' /min.

Gamma " .005 Mr " 12' /min.

T. C. " 3

Fluid: Water (drilling fluid salt water)

Running Time 2 Hrs. 30 Mins.

Depth of Log: Elec. 760 ' Gamma 685 ' (bridges)

Ground Electrode Down hole \approx 1" in water

Remarks Hole bridged at 685 & 760
Electric substations amplices electrical interference on electric logs.
Later deepened to 1000 feet.

Logged By DeKay and LeVan