

Log # 7 W # --- County Albemarle -50 Date 8/58

Owner C. G. Allen Use Domestic

Location Glenaire Subdivision, 150 yards N of route 250,  $\frac{1}{2}$  2 miles W. of 104.

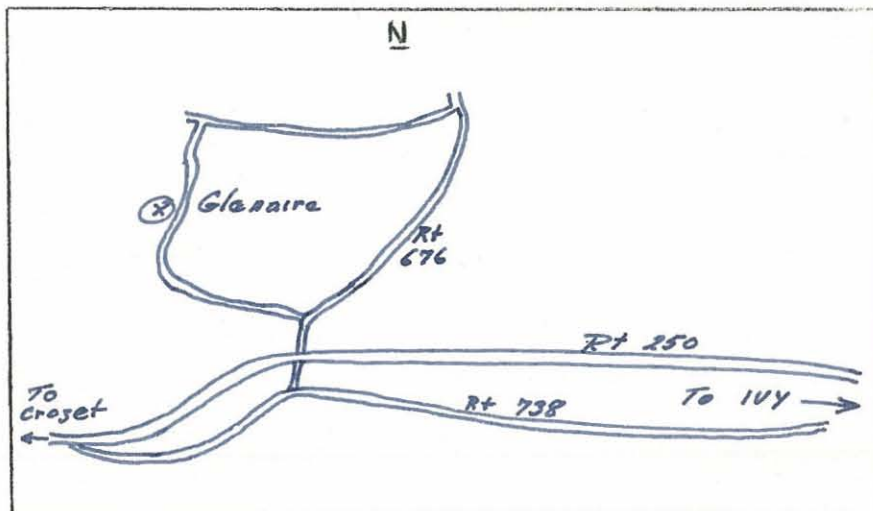

Well Data

Driller: Perkins & Cauldwell

Completed: 4/26/58

Total Depth: 100'

Static W. L.: 24'

Casing: 50'

Bedrock: 16'

Hole Size: 6"

Yield: 15 gpm

H<sub>2</sub>O Temp:

Aquifers:

Elev: ~~600~~

Geology:

Instrument Data

SP setting not run Approx. -'/min.

Res. " not run " -'/min.

Gamma " .01 Mr " 20'/min.

T. C. " 3

Fluid: Fresh Water

Running Time 0 Hrs. 45 Mins.

Depth of Log: Elec. -' Gamma 99'

Ground Electrode Down hole, in water

Remarks Samples not saved.

Logged By LeVan & Cross