



Commonwealth of Virginia
 Department of Mines, Minerals, and Energy
 Division of Gas and Oil
 P.O. Box 1416; Abingdon, VA 24212
 Telephone: (276) 676-5423

Tracking Number: 61
 Company: CNX Gas Company LLC
 File Number: RU-0389
 Operations Name: CBM BJ110 W/PL
 Operation Type: Coalbed/Pipeline
 Drilling Report Type: Original

DRILLING REPORT (DGO-GO-14)

1. Drilling Data

Date drilling commenced: 7/26/2006 Drilling Contractor: NOAH HORN
 Date drilling completed: 8/1/2006 Rig Type: Rotary Cable Tool
 Driller's Total Depth (feet): 2,545
 Log Total Depth (feet): 2,526 Coal Seam At Total Depth Pocahontas

2. Final Location Plat (as required by 4 VAC25-150-360.C.)

Permitted State Plane X: 984,259 Final Plat State Plane X: 984,492
 Permitted State Plane Y: 283,484 Final Plat State Plane Y: 283,894

Plat Previously Submitted Or...

List of Attached Items:

Description	FileName
BJ110	BJ110 FINAL PLAT.pdf

3. Geological Data

Fresh Water At:

Depth (in feet)	Rate	Unit of Measure
-----------------	------	-----------------

Salt Water At:

Depth (in feet)	Rate	Unit of Measure
-----------------	------	-----------------

Coal Seams

List of Attached Items:

Description	FileName
BJ110	BJ110 EXHIBIT A.pdf

Gas and Oil Shows

List of Attached Items:

Description	FileName
BJ110	BJ110 GAS SHOW.jpg

4. Electric Logs (As required by 4VAC25-150-280.A.)

List all logs run: DENSITY,GAMMA,CALIPER,TEMP,DEVIATION

Did logs disclose vertical locations of a coal seam? Yes No

5. Survey Results (As required by 4VAC25-150-280.B.2)

List of Attached Items:

Description	FileName
BJ110	BJ110 DEVIATON LOG.pdf

6. Casing and Tubing Program

List of Attached Items:

Description	FileName
BJ110	BJ110 CASING.jpg

7. Remarks

Use this space to note any conditions or occurrences, such as lost circulation, fishing jobs, junk left in hole, sidetracks, squeeze jobs, etc., not shown above. Include data and depth of condition/occurrence.

BASKET AT:184

8. Drillers Log

Compiled By: LESLIE ARRINGTON

List of Attached Items:

Description	FileName
BJ110	BJ110 DRILLERS LOG.pdf

9. Comments

HARDCOPY PREVIOUSLY APPROVED BY INSPECTOR

10. Signature

Permitee: CNX Gas Company LLC Date: 11/29/2006 (Company)

Signed By: LESLIE ARRINGTON Title: MANAGER (Signature)

INTERNAL USE ONLY

Submit Date: 11/29/2006

Status: Inspr Approved

Date: 11/30/2006

Final PDF Date: 1/9/2007

RU-389

6,630'

LATITUDE: 37° 05' 00"

BEARING BASIS:
VIRGINIA STATE PLANE - SOUTH ZONE - NAD'27

LONGITUDE: 81° 57' 30"

8,315'

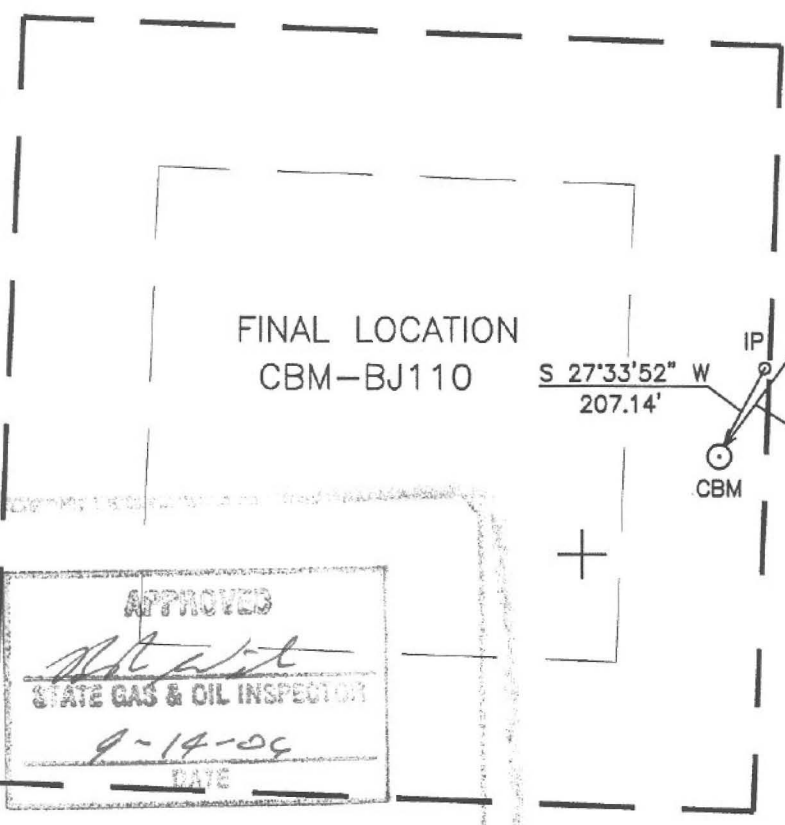

APPROVED
[Signature]
STATE GAS & OIL INSPECTOR
9-14-06
DATE



NOTE:
THIS WELL WAS DRILLED WITHIN 10 FT. OF PROPOSED LOCATION
ACCORDING TO 4 VAC 25-150-290 AND 45.1-361.30.

Supplement
JGS 9/13/06

WELL LOCATION PLAT

BJ110FNL
PGP27/35-0601/12

COMPANY CNX GAS COMPANY, LLC. WELL NAME OR NUMBER CBM-BJ110

TRACT NUMBER GENT ROYALTY PARTNERSHIP ETAL QUADRANGLE HONAKER

DISTRICT: NEW GARDEN

WELL COORDINATES (VIRGINIA STATE PLANE): STATE PLANE: N 283,894.31 E 984,491.87

ELEVATION: 2270.51' METHOD USED TO DETERMINE ELEVATION: BY TRIG. LEVELS FROM CONSOL INC BM'S

COUNTY RUSSELL Scale: 1" = 400' Date 08-02-06

THIS PLAT IS A NEW PLAT _____; AN UPDATED PLAT _____; OR A FINAL LOCATION PLAT _____



Denotes the location of a well on United States Topographic Maps, scale 1" = 24,000, latitude and longitude lines being represented by border lines as shown (optional).

[Signature]

Licensed Professional Engineer or Licensed Land Surveyor (Affix Seal)

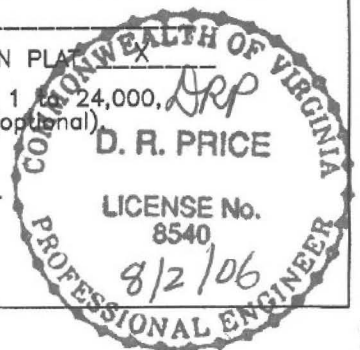

Exhibit A

Well Name: CBM-BJ110

SURFACE ELEV: 2270.51 EASTING: 984491.87 NORTHING: 283894.31

SEAM	DEPTH FROM (FT)	DEPTH TO (FT)	ELEVATION (TOSE)	THK. (FT)	REMARKS
	1.00	178.10	2269.51	177.10	
KN2	178.10	180.80	2092.41	2.70	
	180.80	282.90	2089.71	102.10	
COAL	282.90	283.40	1987.61	0.50	
	283.40	314.70	1987.11	31.30	
AL1	314.70	315.20	1955.81	0.50	
	315.20	370.90	1955.31	55.70	
AL2	370.90	372.00	1899.61	1.10	
	372.00	479.00	1898.51	107.00	
RA2	479.00	480.80	1791.51	1.80	
	480.80	520.70	1789.71	39.90	
RA3	520.70	521.10	1749.81	0.40	
	521.10	625.70	1749.41	104.60	
JB1	625.70	626.00	1644.81	0.30	
	626.00	642.20	1644.51	16.20	
JB3	642.20	643.40	1628.31	1.20	
	643.40	723.40	1627.11	80.00	
T2	723.40	725.00	1547.11	1.60	
	725.00	785.00	1545.51	60.00	
*TI	785.00	786.20	1485.51	1.20	
	786.20	791.60	1484.31	5.40	
*COAL	791.60	791.70	1478.91	0.10	
	791.70	920.00	1478.81	128.30	
*US1	920.00	920.70	1350.51	0.70	
	920.70	962.60	1349.81	41.90	
*LC4	962.60	965.90	1307.91	3.30	
	965.90	1107.10	1304.61	141.20	
*GC1	1107.10	1107.60	1163.41	0.50	
	1107.60	1108.00	1162.91	0.40	
*GC1	1108.00	1108.90	1162.51	0.90	
	1108.90	1203.20	1161.61	94.30	
*SE1	1203.20	1203.80	1067.31	0.60	
	1203.80	1255.80	1066.71	52.00	
*SE2	1255.80	1256.80	1014.71	1.00	
	1256.80	1279.10	1013.71	22.30	
*SE3	1279.10	1279.30	991.41	0.20	
	1279.30	1300.20	991.21	20.90	
*LS1	1300.20	1300.40	970.31	0.20	
	1300.40	1302.00	970.11	1.60	
*LS2	1302.00	1303.10	968.51	1.10	
	1303.10	1371.80	967.41	68.70	
*LS3	1371.80	1375.80	898.71	4.00	
	1375.80	1408.70	894.71	32.90	
*COAL	1408.70	1410.40	861.81	1.70	
	1410.40	1412.90	860.11	2.50	
*COAL	1412.90	1413.40	857.61	0.50	
	1413.40	1432.40	857.11	19.00	
*UH2	1432.40	1433.00	838.11	0.60	
	1433.00	1478.70	837.51	45.70	
*MH1	1478.70	1480.00	791.81	1.30	
	1480.00	1560.00	790.51	80.00	
*COAL	1560.00	1561.80	710.51	1.80	
	1561.80	1575.40	708.71	13.60	
*COAL	1575.40	1576.30	695.11	0.90	

	1576.30	1580.50	694.21	4.20
*MH2	1580.50	1582.10	690.01	1.60
	1582.10	1604.70	688.41	22.60
*P11	1604.70	1606.90	665.81	2.20
	1606.90	1653.50	663.61	46.60
*P10	1653.50	1655.00	617.01	1.50
	1655.00	1655.40	615.51	0.40
*P10	1655.40	1657.30	615.11	1.90
	1657.30	1697.00	613.21	39.70
*LH1	1697.00	1697.20	573.51	0.20
	1697.20	1697.40	573.31	0.20
*LH2	1697.40	1699.20	573.11	1.80
	1699.20	1753.30	571.31	54.10
*P81	1753.30	1753.40	517.21	0.10
	1753.40	1755.00	517.11	1.60
*COAL	1755.00	1755.40	515.51	0.40
	1755.40	1760.40	515.11	5.00
*P82	1760.40	1761.00	510.11	0.60
	1761.00	1808.50	509.51	47.50
*COAL	1808.50	1811.10	462.01	2.60
	1811.10	1893.50	459.41	82.40
*P72	1893.50	1895.00	377.01	1.50
	1895.00	1920.60	375.51	25.60
*COAL	1920.60	1920.90	349.91	0.30
	1920.90	1943.80	349.61	22.90
*COAL	1943.80	1944.30	326.71	0.50
	1944.30	2019.80	326.21	75.50
*P62	2019.80	2020.40	250.71	0.60
	2020.40	2094.80	250.11	74.40
*P51	2094.80	2095.10	175.71	0.30
	2095.10	2222.70	175.41	127.60
*COAL	2222.70	2222.90	47.81	0.20
	2222.90	2255.00	47.61	32.10
*P31	2255.00	2256.40	15.51	1.40
	2256.40	2256.60	14.11	0.20
*P32	2256.60	2257.30	13.91	0.70
	2257.30	2299.40	13.21	42.10
*P34	2299.40	2299.80	-28.89	0.40
	2299.80	2469.10	-29.29	169.30
*SJ3	2469.10	2469.80	-198.59	0.70
	2469.80	2525.95	-199.29	56.15

NOTE: FOOTAGE NOT ADJUSTED FOR DEVIATION
 COAL SEAMS TO BE STIMULATED WERE ADJUSTED DUE TO THE GAS
 WELL'S PROXIMITY TO FLATROCK CREEK.
 GAMMA-CALIPER LOG FROM 0 TO 266.00
 GAMMA-DENSITY LOG FROM 266.00 TO TD.

FILE: C:\VP\APPS\BJ110.CMP

DATE: 08/08/06

FORMATION	TOP	BOTTOM	THICKNESS	IPF (MCFD/BOPD)	PRESSURE	HOURS TESTED
Lee/Norton	785	1699	914	(See Below)		
Pocahontas	1808	2256	448	(See Below)		
Total IPF				No Show		

	Casing	Casing Interval	Hole Size	Cement Used In Cu/Ft	Cemented To Surface		Date Cemented	Packers Or Bridge Plugs Kind/Size/Set
					Yes	No		
Conductor	18"	15'	22"		<input type="checkbox"/>	X	7-27-06	
Surface	13 3/8"	34'	16"			X	7-27-06	
Water Protection	4 1/2"	2332.66'	6 1/2"	363.3 Cu/ft	X	<input type="checkbox"/>	8-01-06	
Coal Protection	4 1/2"	2332.66'	6 1/2"	363.3 Cu/ft	X	<input type="checkbox"/>	8-01-06	
Other Casing And Tubing Left In Well	7"	265.8'	8 7/8"	64.9 Cu/ft		X	7-27-06	
Liners					<input type="checkbox"/>	<input type="checkbox"/>		

PLAN VIEW COMPU-LOG DEVIATION

CLIENT: Consol Energy
 LOCATION:
 HOLE ID: 06-CN- BJ-110
 DATE OF LOG: 08/01/06
 PROBE: 9136CA 955

MAG DECL: -6.9

SCALE: 50 FT/IN
 TRUE DEPTH: 2509.27 FT
 AZIMUTH: 69.2
 DISTANCE: 134.0 FT
 + = 300 FT INCR
 ○ = BOTTOM OF HOLE

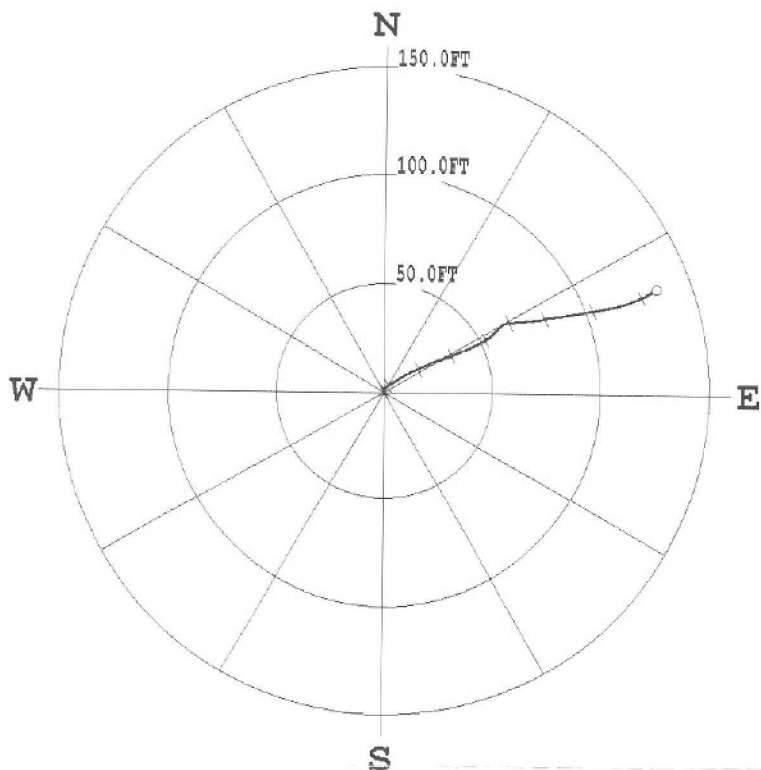

* * * * * COMPU-LOG - VERTICAL DEVIATION * * * * *

CLIENT	: Consol Energy	HOLE ID.	: 06-CN- BJ-110
FIELD OFFICE	: Vansant, Va	DATE OF LOG	: 08/01/06
DATA FROM	:	PROBE	: 9136CA , 955
MAG. DECL.	: -6.900	DEPTH UNITS	: FEET
LOG: 06-CN- BJ-110_08-01-06_04-46_9136CA_.02_-0.02_2514.33_DEVI.log			

	Casing	Casing Interval	Hole Size	Cement Used In Cu/Ft	Cemented To Surface		Date Cemented	Packers Or Bridge Plugs Kind/Size/Set
					Yes	No		
Conductor	18"	15'	22"		<input type="checkbox"/>	X	7-27-06	
Surface	13 3/8"	34'	16"			X	7-27-06	
Water Protection	4 1/2"	2332.66'	6 1/2"	363.3 Cu/ft	X	<input type="checkbox"/>	8-01-06	
Coal Protection	4 1/2"	2332.66'	6 1/2"	363.3 Cu/ft	X	<input type="checkbox"/>	8-01-06	
Other Casing And Tubing Left In Well	7"	265.8'	8 7/8"	64.9 Cu/ft		X	7-27-06	
Liners					<input type="checkbox"/>	<input type="checkbox"/>		

FORMATION	TOP	BOTTOM	THICKNESS	IPF (MCFD/BOPD)	PRESSURE	HOURS TESTED
Lee/Norton	785	1699	914	(See Below)		
Pocahontas	1808	2256	448	(See Below)		
Total IPF				No Show		

1855	1915	60	SAND
1915	1945	30	SAND/SHALE
1945	1975	30	SANDY SHALE/COAL
1975	2005	30	SAND
2005	2035	30	SANDY SHALE/COAL
2035	2065	30	SAND
2065	2095	30	SANDY SHALE
2095	2215	120	SAND
2215	2245	30	SANDY SHALE
2245	2255	10	SAND
2255	2257	2	COAL P-3
2257	2275	18	SANDY SHALE
2275	2305	30	SANDY SHALE/COAL
2305	2365	60	SAND/SHALE
2365	2425	60	SAND
2425	2545	120	SAND/SHALE

2545.00 FT. TOTAL DEPTH

15.00 FT. OF 18" CASING

34.00 FT. OF 13 3/8" CASING

265.80 FT. OF 7" CASING

2332.66 FT. OF 4 1/2" CASING