



Commonwealth of Virginia
 Department of Mines, Minerals, and Energy
 Division of Gas and Oil
 P.O. Box 1416; Abingdon, VA 24212
 Telephone: (276) 676-5423

Tracking Number: 120
 Company: Equitable Production Company
 File Number: DI-1421
 Operations Name: VC-551139 W/PL
 Operation Type: Coalbed/Pipeline
 Drilling Report Type: Original

DRILLING REPORT (DGO-GO-14)

1. Drilling Data

Date drilling commenced: 10/22/2005 Drilling Contractor: GASCO
 Date drilling completed: 10/26/2005 Rig Type: Rotary Cable Tool
 Driller's Total Depth (feet): 2,941
 Log Total Depth (feet): 2,922 Coal Seam At Total Depth PENN COAL

2. Final Location Plat (as required by 4 VAC25-150-360.C.)

Permitted State Plane X 909,510 Final Plat State Plane X: 909,504
 Permitted State Plane Y: 280,608 Final Plat State Plane Y: 280,607

Plat Previously Submitted Or...

List of Attached Items:

Description	FileName
551139	551139 WELL LOCATION PLAT (FINAL).pdf

3. Geological Data

Fresh Water At:

Depth (in feet)	Rate	Unit of Measure

Salt Water At:

Depth (in feet)	Rate	Unit of Measure

Coal Seams

List of Attached Items:

Description	FileName
551139	551139 COAL SEAMS.jpg

Gas and Oil Shows

List of Attached Items:

Description	FileName
551139	551139 GAS AND OIL SHOWS.jpg

4. Electric Logs (As required by 4VAC25-150-280.A.)

List all logs run: GR/DENSITY/TEMP/INDUCTIN/NEUTRON

Did logs disclose vertical locations of a coal seam? Yes No

5. Survey Results (As required by 4VAC25-150-280.B.2)

List of Attached Items:

Description	FileName
551139	551139 SURVEY RESULTS.jpg

6. Casing and Tubing Program

List of Attached Items:

Description	FileName
551139	551139 CASING DATA.jpg

7. Remarks

Use this space to note any conditions or occurrences, such as lost circulation, fishing jobs, junk left in hole, sidetracks, squeeze jobs, etc., not shown above. Include data and depth of condition/occurrence.

CEMENT BASKETS: 120

8. Drillers Log

Compiled By: TODD TETRICK

List of Attached Items:

Description	FileName
551139	551139 DRILLERS LOG.pdf

9. Comments

10. Signature

Permitee: Equitable Production Company Date: 1/17/2007 (Company)

Signed By: TODD TETRICK Title: MANAGER (Signature)

INTERNAL USE ONLY

Submit Date: 1/17/2007

Status: Inspr Approved

Date: 2/23/2007

Final PDF Date: 2/26/2007

DF 1421

8,465'

Well Coordinates: (Geographic N27)
37.044766° -82.237380°

Latitude 37° 05' 00"

Lease No. 241490L / T-451
H. G. Wampler
1,868.00
ACIN LLC - coal
Alpha Land & Reserves LLC - coal lessee
WBRD LLC - coal
Dickenson-Russell Coal Company LLC - coal lessee
Pine Mountain Oil & Gas, Inc. - oil, gas & CBM
Gas 58.77 Ac. 100.00%

DMR Permit
No. 1701841

Longitude 82° 12' 30"

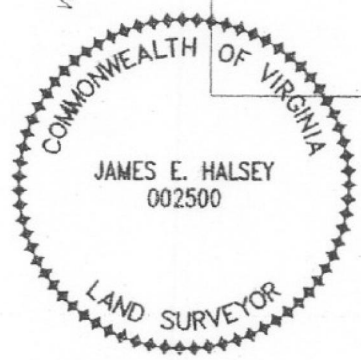
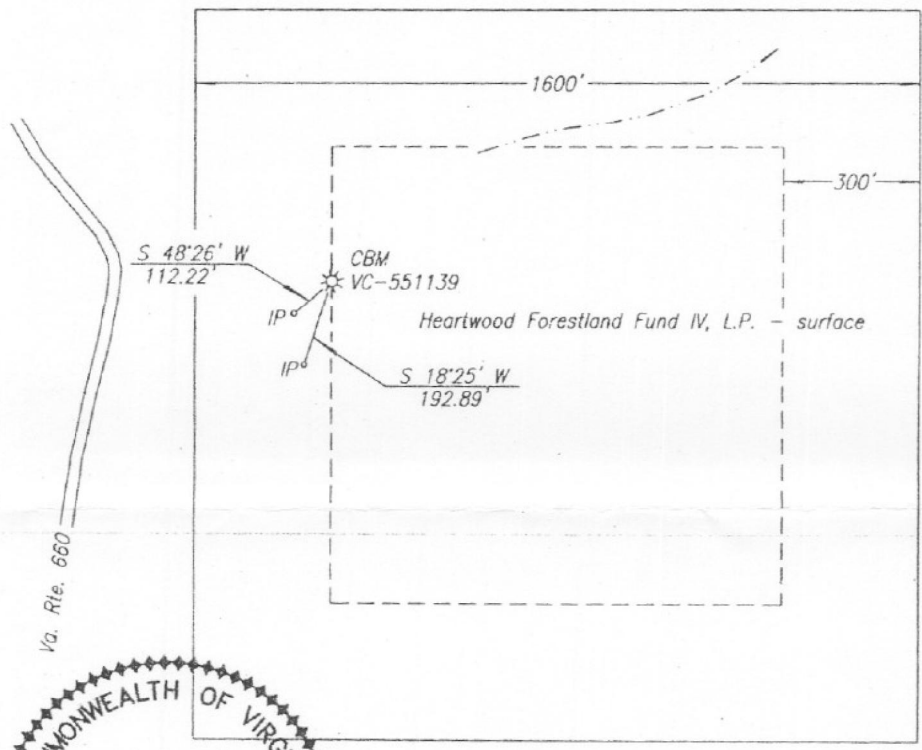

The undersigned hereby certifies that the final location is within ten (10') feet of the location shown on the well plat dated 8-26-2005.

Well Coordinates: (VA St. Plane S. Zone, Calculated from CCC coordinates)
N 280,607 E 909,504

Well Coordinates: (Clinchfield Coal Co.)
S 20,092.46 E 42,600.26

FINAL PLAT

Area of Unit = 58.77 Ac.

Well elevation determined by GPS survey from BM Y 108

WELL LOCATION PLAT

COMPANY Equitable Production Company WELL NAME AND NUMBER VC-551139
TRACT NO. T-451 ELEVATION 2,782.1' QUADRANGLE Duty
COUNTY Dickenson DISTRICT Ervinton SCALE 1" = 400' DATE 10-24-2005

This Plat is a new plat ; an updated plat ; or a final location plat

+ Denotes the location of a well on United States topographic Maps, scale 1 to 24,000, latitude and longitude lines being represented by border lines as shown.

James E. Halsey
Licensed Professional Engineer or Licensed Land Surveyor

Coal Seams & Open Mines

<u>Type</u>	<u>From</u>
Coal	187-188,212-213,275-276,296-297,611-612,721-722,
Coal	802-803,890-892,1139-1141,1318-1321,1401-1403,
Coal	1557-1560,1754-1757,2150-2152,2190-2192,2211-2213
Coal	2287-2289,2348-2350,2618-2620,2670-2672,2688-2690

Gas and Oil Shows**Gas Tests**

<u>Depth</u>	<u>Remarks</u>
196	N/S
404	N/S
606	N/S
796	N/S
1,007	N/S
1,212	N/S
1,403	N/S
1,593	N/S
1,816	N/S
2,006	N/S
2,217	TSTM
2,406	TSTM
2,493	TSTM
2,502	TSTM
2,723	TSTM
2,939	TSTM

Survey Results

<u>Depth</u>	<u>Direction/Distance/Degrees From True Vertical</u>
196	1/4
404	1/4
606	1/4
796	1/4
1,007	1/4
1,212	1/4
1,403	1/4
1,593	1/2
1,816	1/4
2,006	1/4
2,217	1/2
2,406	1/4
2,493	1/2
2,502	1/2
2,723	1/2
2,939	1/2

Casing Data

Casing Outside Diameter	Casing Interval	Hole Size	Cement used in Cu. ft.	Cmtd To Surface	Date Cemented	Cement Baskets
12 3/4	0- 22	15				
8 5/8	0- 344	12 1/4	165.20	Y	10/22/2005	120
4 1/2	0- 2805	6 1/2	553.35	Y	10/25/2005	

Tubing Size

2 3/8
5/8

Footage

2,686.45'
2,492.7'

Drillers Log

Permit: 6956

Well: VC551139

<u>Formation Name</u>	<u>Depth Top</u>	<u>Depth Bottom</u>	<u>Formation Thickness</u>
Ailv	1,052.20	1,054.50	2.30
sand & shale	1,054.50	1,142.30	87.80
Raven	1,142.30	1,148.80	6.50
sand & shale	1,148.80	1,260.40	111.60
Jawbone Rider	1,260.40	1,262.00	1.60
sand & shale	1,262.00	1,305.00	43.00
Jawbone	1,305.00	1,311.50	6.50
sand & shale	1,311.50	1,411.00	99.50
Tiller	1,411.00	1,412.30	1.30
sand & shale	1,412.30	1,550.40	138.10
Upper Seaboard A	1,550.40	1,552.60	2.20
sand & shale	1,552.60	1,582.00	29.40
Upper Seaboard	1,582.00	1,583.60	1.60
sand & shale	1,583.60	1,723.40	139.80
Greasy Creek	1,723.40	1,726.10	2.70
sand & shale	1,726.10	1,805.40	79.30
Middle Seaboard	1,805.40	1,806.90	1.50
sand & shale	1,806.90	1,851.50	44.60
Lower Seaboard	1,851.50	1,852.90	1.40
sand & shale	1,852.90	1,911.00	58.10
Unnamed A	1,911.00	1,911.50	0.50
sand & shale	1,911.50	1,985.00	73.50
Upper Horsepen	1,985.00	1,985.50	0.50
sand & shale	1,985.50	2,123.30	137.80
C Seam Rider	2,123.30	2,124.30	1.00
sand & shale	2,124.30	2,133.50	9.20
C Seam	2,133.50	2,134.90	1.40
sand & shale	2,134.90	2,166.20	31.30
War Creek	2,166.20	2,169.50	3.30
sand & shale	2,169.50	2,206.50	37.00
Unnamed C	2,206.50	2,207.60	1.10
sand & shale	2,207.60	2,223.50	15.90
Becklev	2,223.50	2,226.60	3.10
sand & shale	2,226.60	2,273.40	46.80
Lower Horsepen	2,273.40	2,275.40	2.00
sand & shale	2,275.40	2,335.80	60.40
X Seam	2,335.80	2,337.90	2.10
sand & shale	2,337.90	2,459.20	121.30
Pocahontas #8	2,459.20	2,460.10	0.90
sand & shale	2,460.10	2,595.50	135.40
Pocahontas #6	2,595.50	2,599.00	3.50
sand & shale	2,599.00	2,642.00	43.00
Pocahontas #5	2,642.00	2,644.30	2.30
sand & shale	2,644.30	2,688.80	44.50
Pocahontas #4	2,688.80	2,689.30	0.50
sand & shale	2,689.30	2,809.00	119.70
Pocahontas #3	2,809.00	2,809.00	0.00
sand & shale	2,809.00	2,939.00	130.00

Total Depth of Well: 2,941.00

Permittee: EQUITABLE PRODUCTION COMPANY (Company)

By:  (Signature)

11/12/06