

Best Sand & Gravel Company, Inc.
 Brooks Pit - Wayne County Road 111

Sample Source	Sand	Surface	Surface	Surface	Surface	Core Hole Samples (Depth from Surface)							Typical Cement Raw Mix
	Overburden	L.S.& Sand	L.S.& Sand	L.S. #1	L.S. #2	18 ft	27 ft	37 ft	47 ft	57 ft	67 ft	77 ft	
	%	%	%	%	%	%	%	%	%	%	%	%	
SiO ₂	88.8	51.5	39.7	39.6	36.9	23.0	17.5	19.6	28.0	20.5	20.9	28.8	14.5
CaO	1.2	22.2	26.9	25.7	27.9	38.3	43.4	40.5	36.6	41.9	38.6	36.4	43.5
Fe ₂ O ₃	1.6	1.6	2.1	2.2	2.1	2.2	1.7	1.7	2.1	1.9	1.6	1.1	1.5
Al ₂ O ₃	4.1	1.3	1.9	1.7	1.7	1.5	1.4	1.2	1.5	1.3	1.2	1.1	3
MgO	tr.	0.8	0.9	0.9	0.9	1.0	1.0	0.9	1.1	1.1	1.2	1	1
K ₂ O	tr.	0.4	0.6	0.5	0.5	0.6	0.4	0.5	0.6	0.5	0.5	0.5	
P ₂ O ₅	0.05	0.15	0.3	0.2	0.2	0.2	0.2	0.1	0.2				
Cr ₂ O ₃	0.3	0.1	0.1	0.2	0.1	0.1	0.1	0.09	0.1	0.1	0.1	0.07	
SO ₃	0.07	0.09	0.1	0.1	0.1	0.1	0.1	0.4	0.4	0.9	0.8	0.4	
TiO ₂	0.4	0.05	0.09	0.1	0.06	0.1	0.07	0.05	0.1	0.03	0.06	0.07	
SrO	0.01	0.35	0.04	0.04	0.04	0.0	0.04	0.03	0.04	0.04	0.07	0.03	
MnO	0.02	0.02	0.03	0.02	0.03	0.0	0.02	0.03	0.03	0.03	0.03	0.03	
V ₂ O ₅	0.04	0.01	tr.	tr.	0.02	tr.	tr.	0.01	0.01	tr.	tr.	tr.	
MoO ₃	tr.	0.01	0.01	tr.	tr.	tr.	tr.	tr.	tr.	tr.	tr.	tr.	
ZrO ₂	0.03	0.01	tr.	tr.	0.01	0.0	tr.	tr.	0.01	tr.	tr.	0.01	
CL								0.01					
L.O.I.	0.66	21.7	27.1	28.7	29.3	32.8	34.0	35.0	29.1	31.5	34.8	29.3	34.5

Walter Lee - Driller
Charles Wilkes

Maxwell Property
Wayne County, N. C.

3-22-82

WY-C-1-82

0	0	
3'-0"	3'-0"	Fine to medium White Sand
11'-0"	11'-0"	Coarse gray To Brown Sand Concrete Quality
14'-0"	14'-0"	marl Core washed away
17'-0"	17'-0"	0'-9" core Buff colored marl
27'-0"	27'-0"	5'-3" core Buff colored marl
37'-0"	37'-0"	3'-4" core Brownish colored marl
47'-0"	47'-0"	6'-0" core Light gray marl
57'-0"	57'-0"	9'-7" core Light gray marl
67'-0"	67'-0"	4'-11" core Light gray marl
77'-0"	77'-0"	9'-4" core Light gray marl
82'-0"	82'-0"	10'-0" core Light gray marl
		1'-0" core Light gray marl + sand

9'-4" Total Core

Fine portion ground up In good marl all the way

Terminated Hole Still in marl + Caliche Sand

87

WAY-C-1-82

Garry Jones' picks

WAY-T-3-82

17 ft : Middle Eocene : Inner shelf

INNER

Planktics : *Subbatina cocæna* s.l.

Pseudohastigerina micrafrans-wilcoxensis, etc. many other

SHELF

22 ft : "

26 ft : "

28 ft : "

30 ft : "

32 ft : "

34 ft : "

36 ft : "

MIDDLE

SHELF

38 ft :

82 ft : middle Eocene

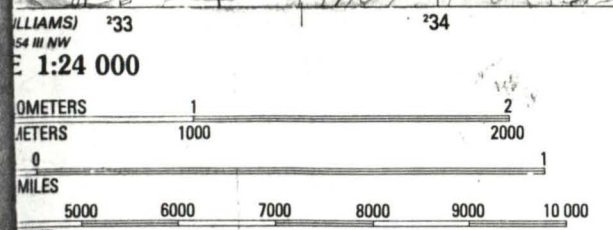
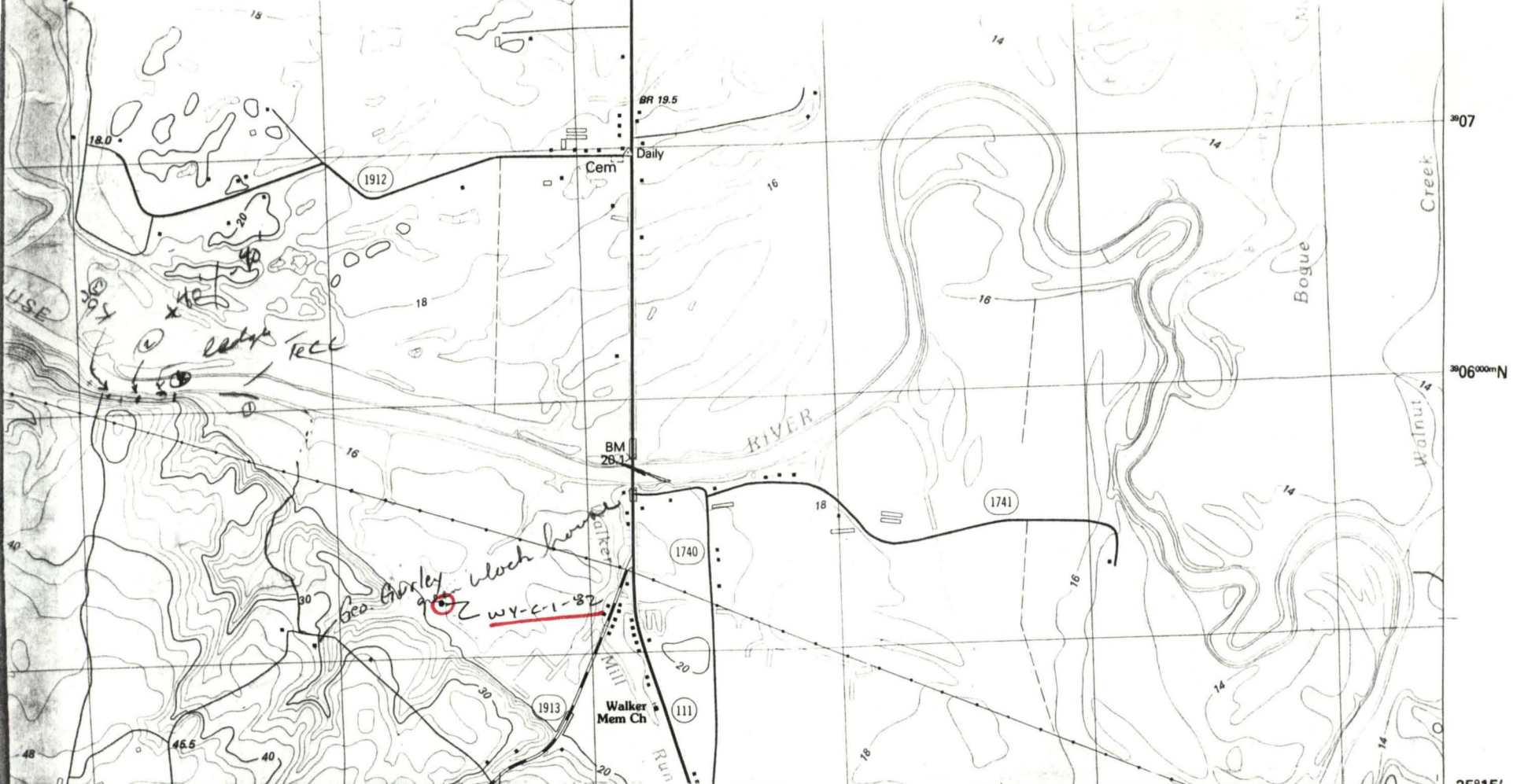

VERTICAL DATUM OF 1929
TO THE NEAREST

STANDARDS
NIA 22092
AVAILABLE ON REQUEST

WY-C-1-82



QUADRANGLE LOCATION
CONTOURS AND ELEVATIONS
IN METERS

ROAD CLASSIFICATION

Primary highway, hard surface Light-duty road, hard or improved surface ...

Secondary highway, hard surface Unimproved road ...

Interstate Route
 U. S. Route
 State Route

SOUTHEAST GOLDSBORO, N. C.
SW/4 GOLDSBORO 15' QUADRANGLE
N3515 - W7752.5/7.5

MARKED

1982
DMA 5454 IV SW - SERIES V842

(SEVEN SPACES)
5454 IV SW

WY-C-1-82

SOUTHERN TESTING AND RESEARCH LABORATORIES, INC.

Consulting Analytical Chemists

P. O. BOX 1849 - 607 PARK AVENUE
WILSON, NORTH CAROLINA 27893
TELEPHONE (919) 237-4175

ANALYSIS REPORT

For J. R. Reid, Jr.
2200 Tyson Street
Raleigh, N. C. 27612

Date May 7, 1982

Analysis No. 645F 1-4

Sample of MARL

Marked

Received from
Above, 4/2/82

Core Hole # 1

<u>LAB. #</u>	<u>MARKS</u>	<u>NEUTRALIZING VALUE (CaCO₃)</u>
645F 1	Sample #1, Maxwell Site, 19 Feet	73.5%
645F 2	Sample #2, Maxwell Site, 41 Feet	78.8%
645F 3	Sample #3, Maxwell Site, 60 Feet	78.4%
645F 4	Sample #4, Maxwell Site, 76 Feet	72.5%

Respectfully Submitted

**SOUTHERN TESTING AND RESEARCH
LABORATORIES, INC.**

SOUTHERN TESTING AND RESEARCH LABORATORIES, INC.

Consulting Analytical Chemists

P. O. BOX 350 - 607 PARK AVENUE
WILSON, NORTH CAROLINA 27893
TELEPHONE (919) 237-4175

ANALYSIS REPORT

For Crushed Stone Consultants, Inc.
2200 Tyson Street
Raleigh, N. C. 27612

Date November 19, 1980

Analysis No. 158B 1

Sample of CALCIUM CARBONATE

Marked

Received from
Above, 11/14/80

Neutralizing Value as CaCO_3 80.85%

*Limestone Sample
Taken from Auger
Flight*

Respectfully Submitted

**SOUTHERN TESTING AND RESEARCH
LABORATORIES, INC.**

SOUTHERN TESTING AND RESEARCH LABORATORIES, INC.

Consulting Analytical Chemists

P. O. BOX 1849 - 607 PARK AVENUE
WILSON, NORTH CAROLINA 27893
TELEPHONE (919) 237-4175

ANALYSIS REPORT

For J.R. Reid, Jr.
Raleigh,
North Carolina 27612

Date May 7, 1982

Analysis No. 645F 5

Sample of MARL

Marked Sample #5, Maxwell Site
(combined samples of 1,2,3,4)

Received from
Above, 4/2/82

Core Hole #1

Neutralizing Value as CaCO ₃	73.0%
Calcium	34.00%
Equiv. CaCO ₃	84.91%
Magnesium	0.73%
Equiv. MgCO ₃	2.53%
Silica	27.84%

Respectfully Submitted

SOUTHERN TESTING AND RESEARCH
LABORATORIES, INC.