

WY-T-2-84

6/19/84

Per conversation w/ Robbie Cox, Driller for  
Cox Drilling Co, INC. - Observations by him while  
drilling a test hole (H<sub>2</sub>O purposes) on 6/18/84 -  
WY-T-2-84 - BROGDEN

- 0-3 Very soft Brown Clay  
3-10 " " Brown clay + med. coars. Sand  
10-30 " " Brown - Black clay - Coars.  
30-50 " " Light grey fine to med. Sand w/ clay layers  
50-68 SAME  
70-76 Hard Black clay  
76-90 Light grey fine to med. Sand + clay (Loose).  
90-110 SAME  
110-120 SAME Hole took in water.  
120-122 Hard clay  
122-130 Tight clay, fine - med. Sand (Charcoal)  
130-140 SAME  
140-150 Very tight Black clay  
150-157 SAME  
157-170 SAME  
170-190 SAME with some Brown clay.

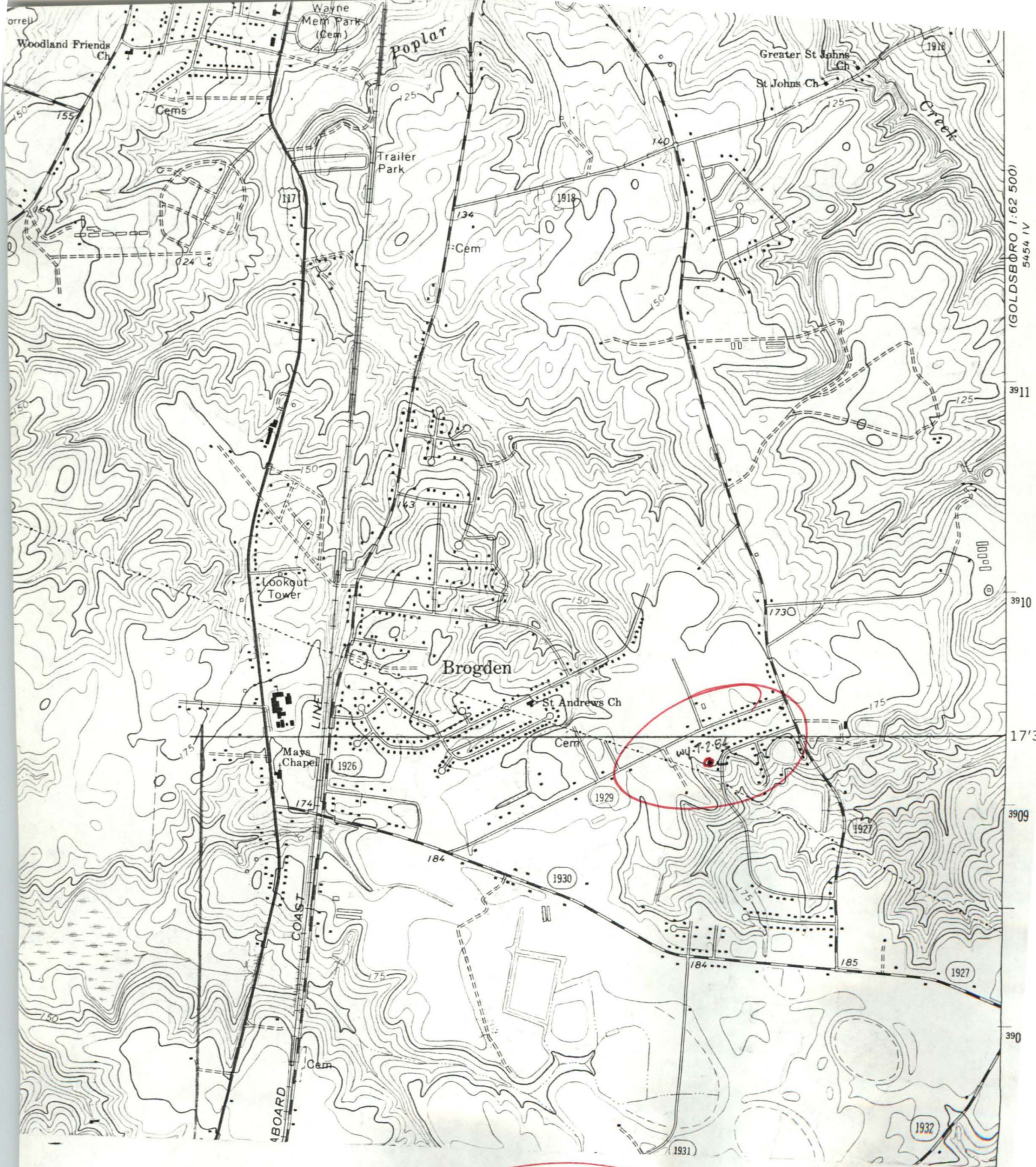

(GOLDSBORO 1:62 500)  
5454 IV

3911

3910

17'3

3909

390

WY-T-2-84

SOUTH EAST

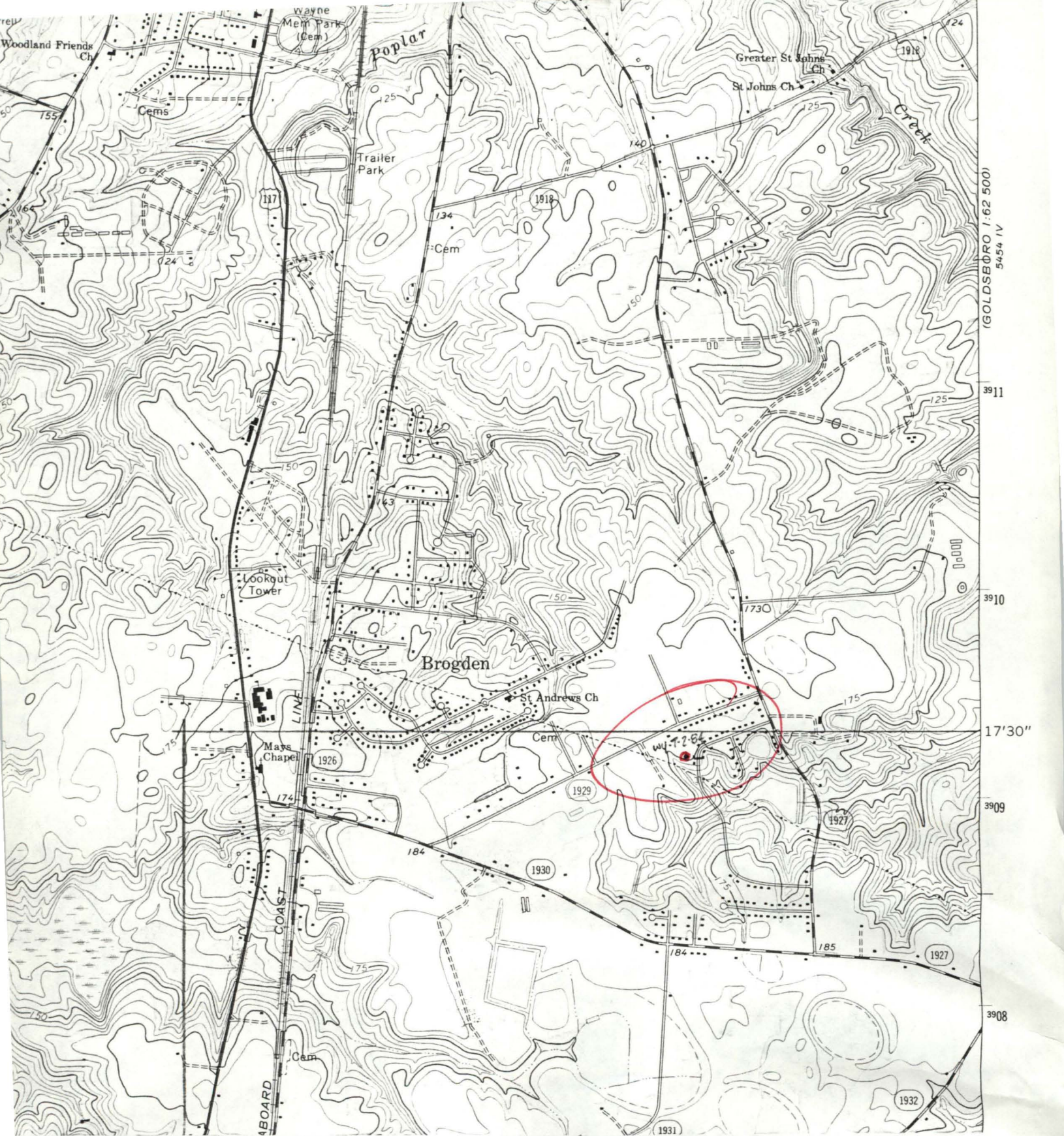

WY-T-2-84

SOUTH WEST  
GOLDSBORO 7.5'