

Depth	Type	Genus	Species	Grain	Comments	Hole	Lithology and other comments
0-10		NO FAUNA					(u) sandy mud grey clay (w) white sd v-fg; v. poorly sorted, loosely consolidated ss v-fg + grey clay
10-20		"					(u) pale grey/brown clay, + very sandy pale grey clay + SA M-FG (10%) (w) white c-fg sd (most m-fg) + pale grey/brown clay + very sandy pale grey to white clay
20-30		"					(u) v. sandy grey clay (w) m-fg white sd, Abund lg chunks of woody lignite; very sandy clay (grey) + TR pebbles + dk grey clay.
30-40		"					(u) v. sandy (f-vfg) Lt brown clay (w) fg sd, pale grey, + TR lignite, mica, clay, glauconite
40-50		PPD		R			(u) v. sandy (fg) brown clay (w) grey sd fg, + 9% glauconite 1% lignite, + sandy clay + TR mica + SHL FGMS (MARINE)
50-60		PPD		R			(u) dk brn sandy (fg) clay (w) f-vfg sd, 3% glauc. + TR lignite + mica. + v. sandy dk brown clay + TR. SHL FGMS
60-70		NO FAUNA					(u) v. sandy brown clay + TR lignite - (sd is m-fg) (w) white m-fg sd with Abund lg chunks of lignite + TR clay + mica (NO glauc)
70-80		"					(u) c-fg white sd + TR clay + lignite (w) white m-fg sd, + 1% lignite, TR mica + grey clay

Depth	Type	Genus	Species	Grain	Comments	Hole	Lithology and other comments
80-90		NO FAUNA					(u) FG-SD \approx sm 9% dk grey clay + lignite (w) Pale grey-white m-FG-SD + Lg chunks lignite, + sandy grey clay + TR mica.
90-100		"					(u) DK. BRN. mod. soy. clay (w) F-VFG white SD + 5% fine lignite particles; Lg lignite chunks + TR clay + mica
100-110		"					(u) DK. BROWN sandy, lignitic clay (w) C-FG grey lignite SD (2-3% colored grains) + sandy clay + lignite.
110-120		"					(u) TAN + BROWN sandy clay (SD is FG) (w) SALT + pepper sand, F-VFG dk particles - clay, marcasite, pyrite, glauconite, lignite
120-130		"					(u) Pale grey slightly sandy clay (w) white SD FG, + TR mica + Hematite
130-140		"					(u) Mottled yellow/grey sandy clay (w) white SD c-FG (1% colored grains) + v. R. TR lignite + sandy clay
140-150		"					(u) V. Sandy grey clay (w) white SD v.c-FG + TR v. sandy clay colored grains
150-160		"					(u) V. sandy (c-FG) grey clay (w) LAA
160-170		"					(u) V. sandy (c-FG) grey clay (w) white SD, v.c-FG + TR v. sandy clay

Depth	Type	Genus	Species	Quant.	Comments	Hole	Lithology and other comments
170-180		NO FAUNA					(u) v. sandy grey clay (w) white sd. VC-FG + TR v. sandy clay
180-190		"					(u) LAA (w) LAA
190-200		"					(u) pale grey v. sandy clay (w) white sd VC-FG + TR v. sandy clay + pale grey clay
200-210		"					(u) LAA (w) LAA
210-220		"					(u) grey (some stained red/orange) v. sandy clay (w) white sd C-FG + TR hematite
220-230		"					(u) v. sandy grey clay (w) white sd C-FG
230-240		"					(u) LAA (w) LAA + VR. TR hematite + marcasite
240-250		"					(u) v. sandy grey clay (w) v. C-FG white sd + TR sandy clay + VR TR ls nite
250-260		"					(u) darker grey sandy clay (w) VC-FG white sd + TR sandy clay + ls nite
260-270		"					(u) pale grey v. sandy clay (w) LAA
270-280		"					(u) pale grey v. sandy clay (w) VC-FG white sd + TR hematite
280-290		"					(u) v. sandy grey clay (w) VC-FG white sd + TR grey clay + [ls nite - Prob CVD]
290-300		"					(u) LAA - some VC-G-SD (w) sd VC-FG - Lt grey + Hematite, pebbles, samples poorly washed.

Depth	Type	Genus	Species	Quant	Comments	Hole	Lithology and other comments
300-310		NO FAUNA					(u) mottled grey + red sandy clay + TR mica. (w) M-FG white SD + sandy or silty grey clay, + TR Hematite
310-320		"					(u) C-FG dingy white SD + TR clay (w) VC-MG white SD + TR pebbles
320-330		"					(u) LAA (w) VC-FG white SD + TR clay; usnite; hematite
330-340		"					(u) grey sandy clay (w) mixed grey, tan, yellowish clays + SD C-FG white + TR Hematite ^{pearly washed} _{sample.}
340-350		"					(u) dingy white sand + Abund. clay (w) SD-white C-FG + clay, grey, yellow, red, brown + TR Hematite
350-360		"					(u) dingy white SD + Abund clay (w) LAA
360-370		"					(u) LAA (w) LAA
370-380		"					(u) SAND, dingy white, VC-MG (w) M-CG pale grey SD + 10% L ₃ white feldspar
380-390		"					(u) M-CG SD, dingy white + clay (w) M-CG pale grey SD + mixed grey, red, yellow + brown clay + TR feldspar + Hematite

Depth	Type	Genus	Species	Quant.	Comments	Hole	Lithology and other comments
390-400		NO FOUND					(u) M-CG SD + Abund clay (w) M-VC G SD - grey, grey + red sandy clay, feldspar, + TR pebbles + hematite
400-410		"					(u) Sandy red ^{+ grey} clay (w) grey + brown clay, white SD c - FG, + TR feldspar + hematite
410-420		"					(u) Red + grey clay + sandy clay (w) LAA + inc % Hematite
420-430		"					(u) Red + grey sandy clay + grey clay (w) Brown, grey, yellow + white clay + SD c - FG, + feldspar + Hematite
430-440		"					(u) Red + grey sandy clay (w) Red, yellow, white, brown + grey clay & very little sand + Hematite, + TR feldspar, + VR Pyrite
440-450		"					(u) orange sandy clay (w) LAA + inc % SD
450-460		"					(u) orange sandy clay (w) Brown, yellow, white + grey clay + yellow + white SD c - FG + hematite + TR feldspar
460-470		"					(u) orange/grey sandy clay (w) LAA + few pebbles + TR unidentified XLN rocks
470-480		"					(u) Mottled grey, white + orange sandy clay (w) grey, brown + yellow clay + SD VC - FG (TR pebbles) + hematite + feldspar + Granite + TR unidentified XLN rocks

Depth	Type	Genus	Species	Grain	Comments	Hole	Lithology and other comments
480-490							(U) mottled red + grey sandy clay (W) Pale grey, yellow + brownish clay + SD c-fg + hematite + feldspar (V.R. TR. XLN rocks)
490-500							(U) LAA (W) LAA (note 1/2 of SD is yellow (+TR XLN rocks))
500-510							(U) Very sandy (CG) mottled red + grey clay (W) yellow + grey sand VC-FG-Angular + Pale grey clay. (TR, RW, XLN rocks)
510-520							(U) V. sandy (CG) grey mottled clay. (W) yellow + white SD VC-FG, angular, + pale grey + brownish clay + hematite + feldspar (includes TR biotite)
520-530							(U) LAA
530 TD							(W) LAA XLN rocks present include feldspars + TR biotite. note: these lower samples could be re-examined for presence of minerals which disappear first in weathering processes, like biotite.

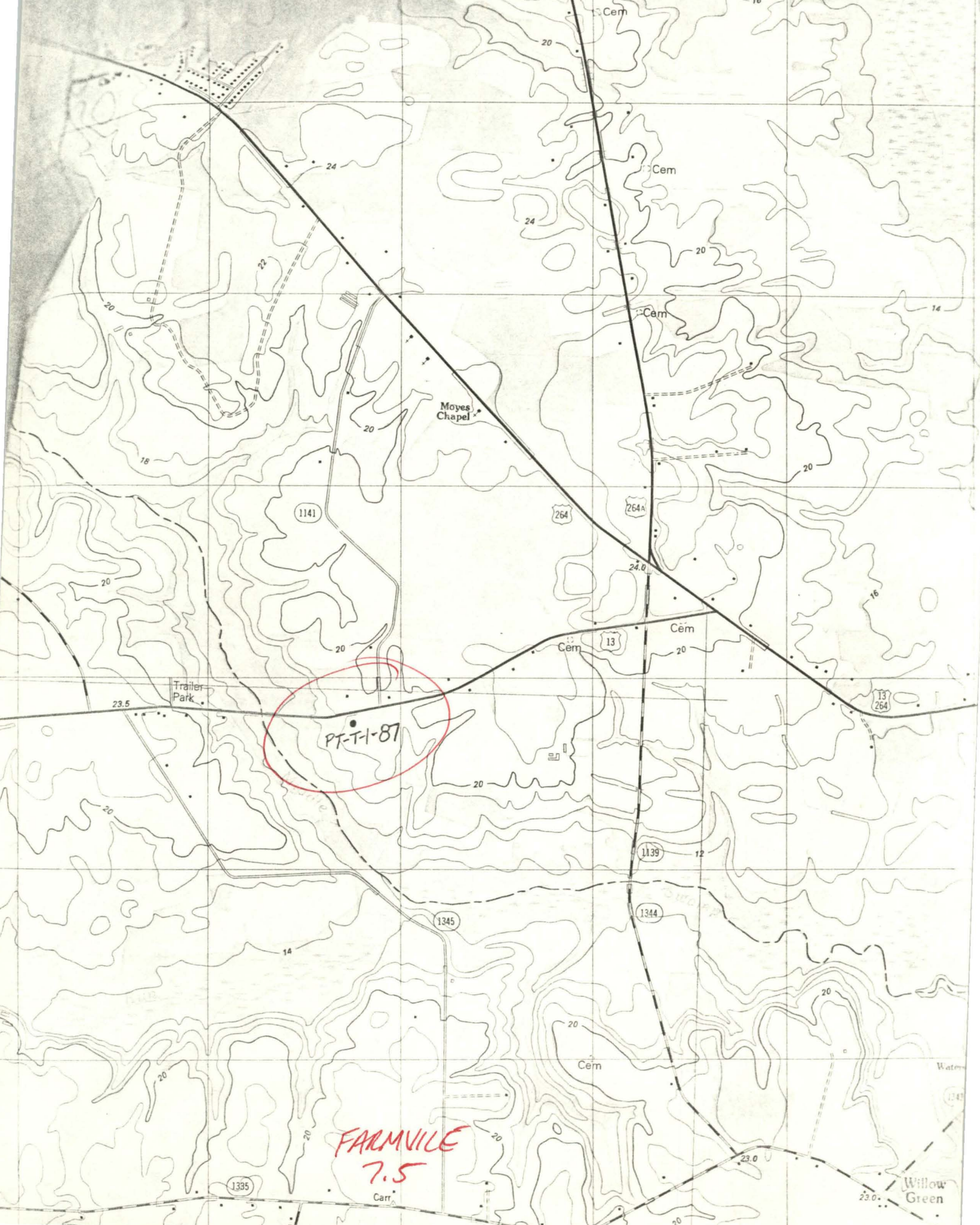

PT-T-1-87

Moyes Chapel

Trailer Park

FARMVILLE
7.5

Willow Green

1141

264

264A

13

13
264

1139

1344

1345

1335

Carr.

Water

Cem

Cem

Cem

Cem

23.0

23.0

20

20

16

14

20

24

20

24

22

20

18

20

20

20

20

20

20

20

20

20

20