

(SEE GENERAL FILE "GEOHERMAL VPI/DOE"  
FOR REFERENCE)

LN-T-1-79

N.C.

III. STATE FUEL PRODUCTION (1973) (C-6)

Type	Number	Units	Trillion Btu
Coal mines	0	0 thousand tons	0
Natural gas (liq.)	0	0 thousand bbl	0
Natural gas wells	0	0 million cu. ft.	0
Crude oil wells	0	0 thousand bbl	0

IV. GEOLOGY

The surface of the basement complex to the north of Wilmington dips to the southeast attaining a maximum onshore depth of approximately 10,000 ft. in the vicinity of Cape Hatteras. Coastal plain sediments, which range in age from Cretaceous to Recent, form a southeasterly thickening wedge that overlies the Precretaceous basement complex. An onshore positive basement structure, trending northwest-southeast, is the dominant structural feature south of Wilmington. This feature, the Cape Fear Arch, is covered by a thin (about 1500 ft.) veneer of sedimentary rocks.

V. RESOURCE DATA

The DOE/DGE sponsored geothermal drilling program drilled eleven 1000 ft. gradient holes in the North Carolina coastal plain. The geothermal gradients varied from 22°C/km to 41°C/km (1.2°F/100 ft. to 2.2°F/100 ft.). Since the depth to basement is 2000 to 3000 ft. over much of the coastal plain, estimates of temperatures at basement are modest, i.e., 30°C to 44°C (86 to 112°F). However for several holes on the mainland, to the west of Cape Hatteras, and where the depth to basement is 4000 to 5000 ft., temperatures at basement are estimated to be as high as 85°C (185°F) (3).

VI. GEOHERMAL ACTIVITIES

The geothermal gradient test holes sponsored by the DOE/DGE drilling program have been completed and the results have been assessed by VPI&SU. APL/JHU has conducted and published a study of the energy markets in the northern coastal region of the state (6). APL has forwarded information to a utility (Carolina Power and Light) on the nature and prospects for geothermal energy.

VII. LEGAL ACTIVITIES

NCSL may conduct a workshop for state legislature to consider geothermal legislation.

10. Environmental Impact Assessments, Division of Budget Management, 116 W. Jones St., Raleigh, NC 27603, Crys Baggett, Clearinghouse Supervisor, (919) 733-7061.
11. State Coupled Reservoir Assessment Program, VPI&SU, Blacksburg, VA 24061, Prof. John Costain, Geothermal Program, (703) 961-5096.

REFERENCES AND LIST OF SIGNIFICANT REPORTS

- (1) P. M. Brown, J. A. Miller, and F. M. Swain, "Structural and Stratigraphic Framework and Spatial Distribution of Permeability of the Atlantic Coastal Plain, North Carolina to New York," U.S.G.S. Professional Paper 796, 1972.
- (2) "Evaluation and Targeting of Geothermal Energy Resources in the Southeastern United States, Progress Report Oct 1, 1978 - March 30, 1979," VPI&SU, Blacksburg, VA, DOE Report VPI-SU-5648-5.
- (3) "Geothermal Resources of the Eastern United States," Gruy Federal, Inc., Arlington, VA, DOE Report DOE/ET/28373-T2.
- (4) "Geothermal Energy Market Study in the Atlantic Coastal Plain, Definitions of Markets for Geothermal Energy in the Northern Atlantic Coastal Plain," APL/JHU GEM-002 (QM-80-075), May 1980.

COMMON REFERENCES

(C-1), (C-4), (C-5), (C-6), and (C-7).

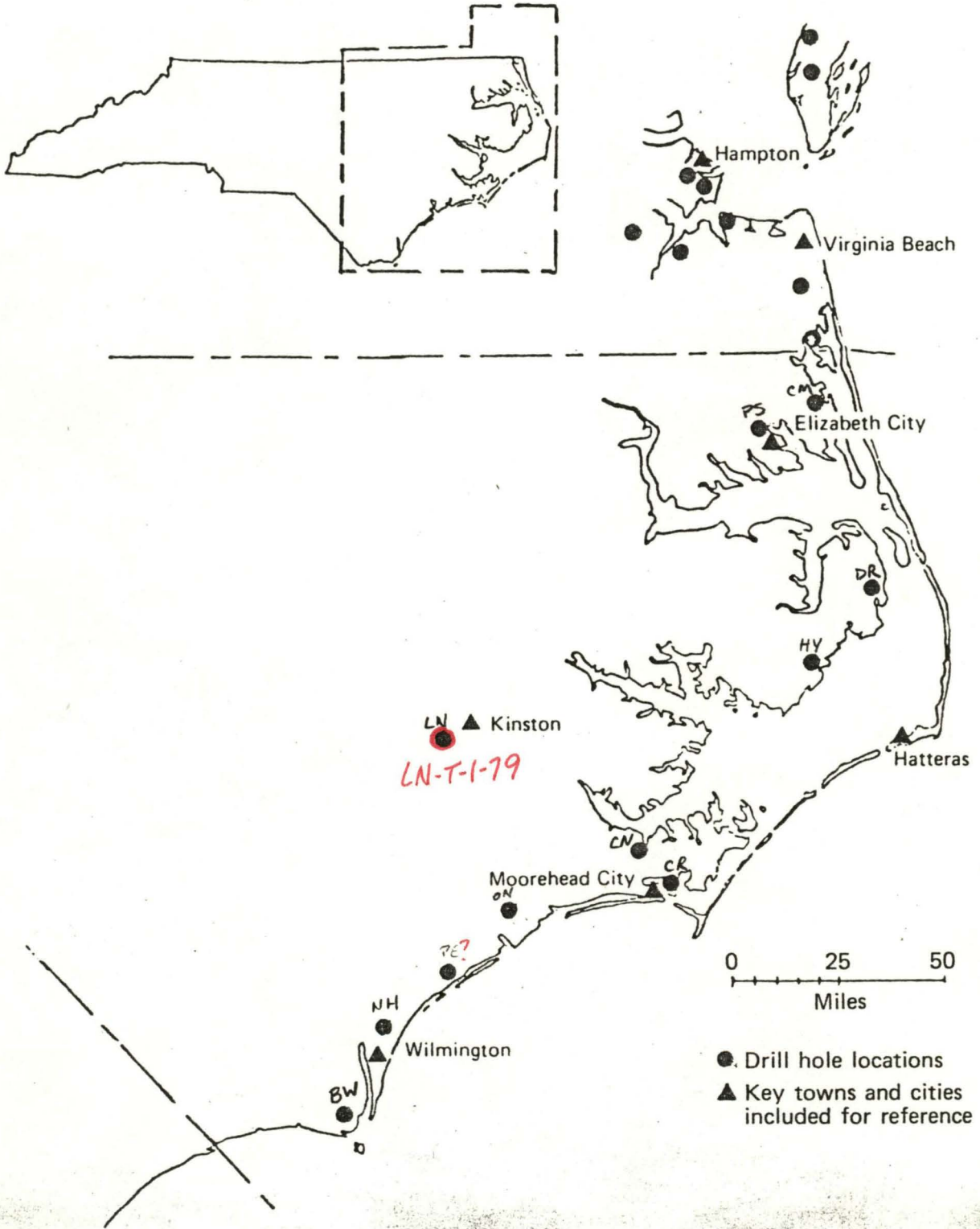

Locations of gradient test holes — Eastern North Carolina.

TABLE C-3.1

HOLE	LATITUDE	LONGITUDE	INTERVAL (M)	GRADIENT SIGMA (REGR, N) (°C/KM)	COND SIGMA (N)	HEAT FLOW	ESTIMATED BASEMENT SURFACE DEPTH TEMPERATURE (KM) (°C)
<del>BW-T-1-79</del> SOUTHPORT, N.C. C14A	33 58.00	77 58.20	60-463	32 *			.465 32
WILMINGTON, N.C. C14	34 12.00	77 53.40	45-380	29 *			.385 28
SNEADS FERRY, N.C. C15A	34 31.60	77 27.30	30-475	31 *			.495 31
JACKSONVILLE, N.C. C15	34 39.00	77 19.00	50-500	30 *			.505 31
<del>N-T-1-79</del> KINSTON, N.C. C16A	35 15.70	77 35.30	69-217	23 *			.210 21
CHERRY POINT, N.C. C16	34 54.70	76 53.30	80-308	22 *			.84 36
BEAUFORT, N.C. C17	34 46.30	76 38.70	45-302	25 *			1.36 51
ENGLEHARD, N.C. C18	35 31.20	75 59.26	49-304	36 *			1.84 81
STUMPY POINT, N.C. C19	35 45.12	75 47.65	53-269 187.1-221.7 196.7-205.8 248.1-296.3	40 * 57.05±0.77(0.988, 68)1 60.01±6.71(0.842, 17)2 54.14±1.38(0.966, 56)3		1.94 1.9±0.1 2.0±0.3 2.1±0.6	1.78 85
ELIZABETH CITY, N.C. C20	36 16.81	76 12.58	50-313	31 *			.95 44
BELLCROSS, N.C. C21	36 19.59	76 03.54	23-308	33 *			1.22 55
CREEDS, VA. C22	36 36.38	76 00.43	89-307	34 *			1.08 50
OCEANA, VA. C23	36 48.09	76 02.62	75-296	38 *			.94 49
NORFOLK, VA. C24	36 57.40	76 16.20	17-316 152.4-173.3 161.7-174.3 252.8-316.7 303.2-308.5	37 * 44.14±0.57(0.994, 41)2 49.00±1.64(0.975, 25)2 24.75±0.04(1.000, 124)1 29.13±2.17(0.957, 10)2		1.34 1.5±0.2 1.7±0.3 0.9±0.2 1.1±0.4	
SUFFOLK, VA. C25	36 51.01	76 28.83	21-307 295.8-309.9	43 * 26.85±0.39(0.996, 23)1		1.44 1.4±0.3	.557 39

C-30

COSTAIN, J.K., GLOVER, L. II, and SINHA, A.K., 1979,

FROM: EVALUATION AND TARGETING OF GEOTHERMAL ENERGY RESOURCES IN THE SOUTHEASTERN UNITED STATES.

PROGRESS REPORT

OCT 1, 1978 - MARCH 30, 1979

PROGRESS REPORT

VPI &amp; SU-5648-5

# GEOTHERMAL HOLES

ADJUSTED LAT/LONG'S.

WELL CODE	SEQUENCE #	LAT	LONG	SAMPLES	COMMENTS
BW-T-1-79	14A	3358.00	775812	<del>FROM</del> W <del>TO</del> 0 - 1340	SouthPort, N.C.
CM-T-1-79	21	3619 35	760332	80 - 970 W	BELLCROSS, N.C.
CR-T-1-79	17	344618	763842	0 - 960 W	BEAUFORT, N.C.
CA-T-4-79	16	345442	765318	0 - 960 W	CHERRY POINT, N.C.
DR-T-1-79	19	35457	754739	0 - 950 W	STUMPY POINT, N.C.
HY-T-1-79	18	353112	755916	0 - 980 W	ENGLEHARD, N.C.
LN-T-1-79	16A	<del>351542</del> <sup>351419</sup>	<del>773518</del> <sup>773540</sup>	0 - 750 W	KINSTON, N.C.
NH-T-1-79	14	341200	775324	0 - 1250 W	WILMINGTON, N.C.
ON-T-1-79	15	3439.00	7719.00	0 - 960 W	JACKSONVILLE, N.C.
PS-T-1-79	20	361649	761235	0 - 1000 W	ELIZABETH CITY

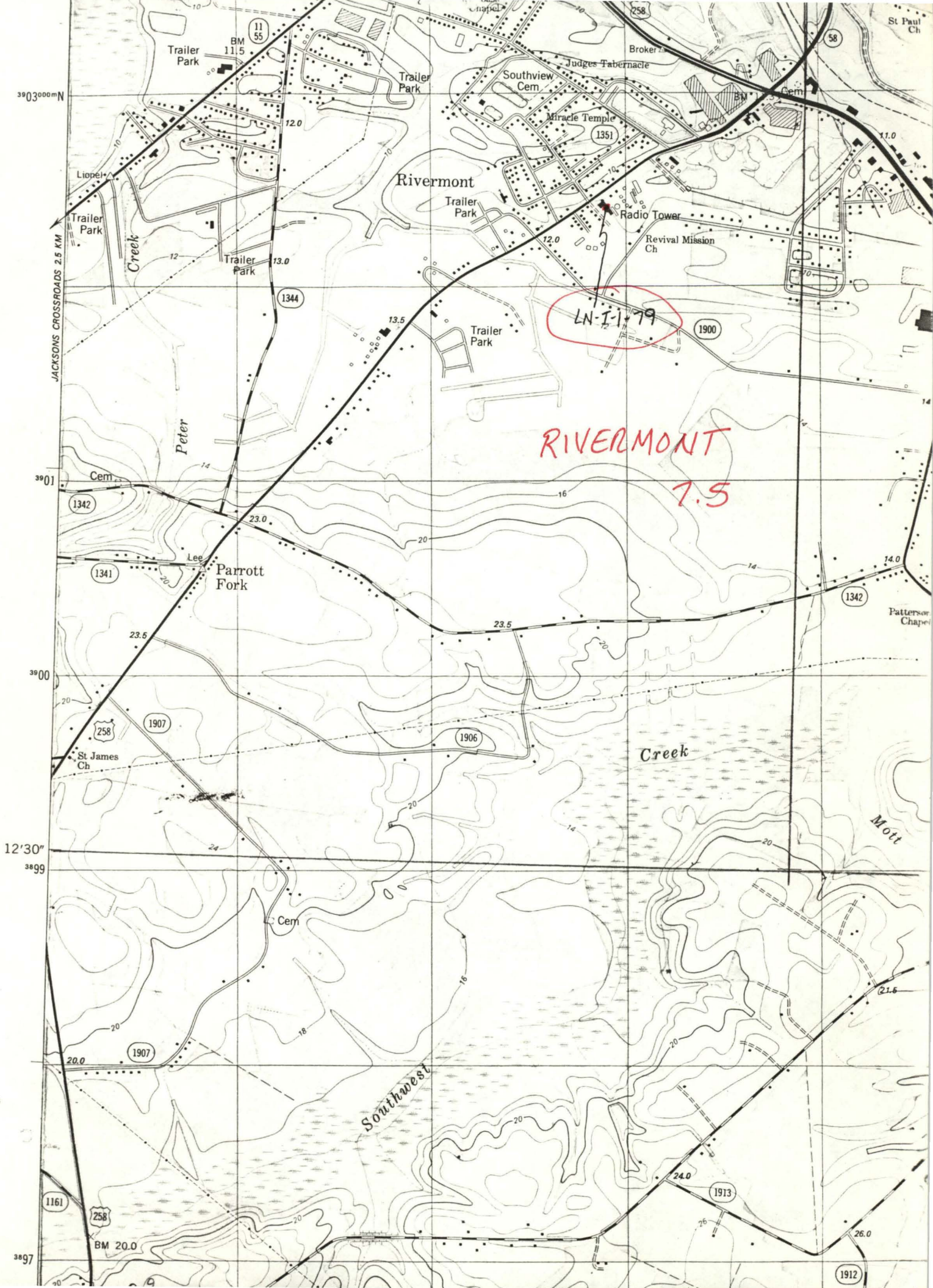

LN-1-1-79

RIVERMONT  
7.5

JACKSONS CROSSROADS 2.5 KM

39°03'00"N

39°00'

12°30'

39°07'

1912