

N 502,000

24

BVD. N.C. STATE HIGHWAY 24

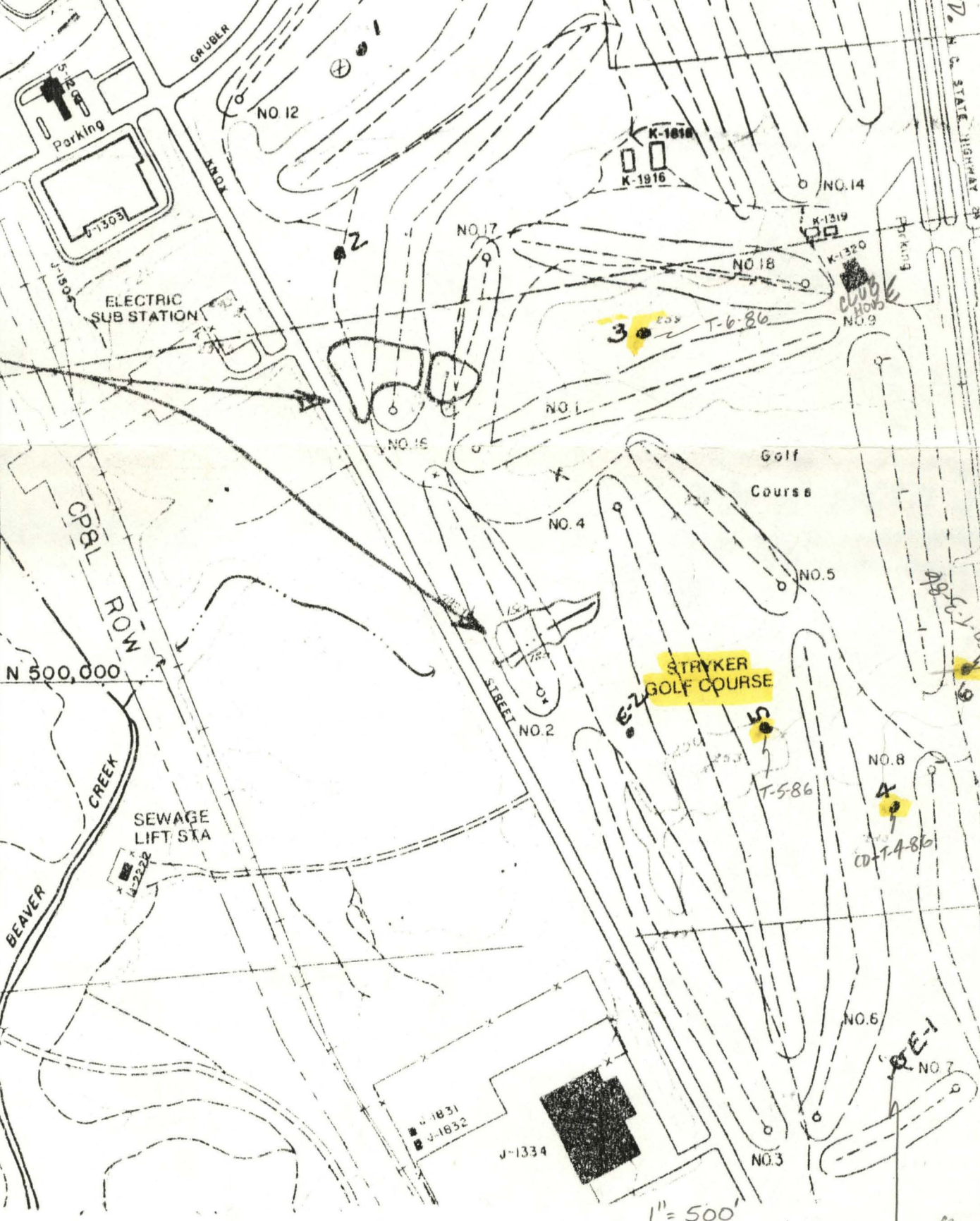

ELECTRIC SUB STATION

STRYKER GOLF COURSE

CPBL ROW

N 500,000

BEAVER CREEK

SEWAGE LIFT STA

Golf Course

NO. 8

CD-7-86

NO. 6

NO. 7

SHEET 7

1" = 500'

EXISTING PRODUCING WELL IRRIGATION AS TO 2/13/86

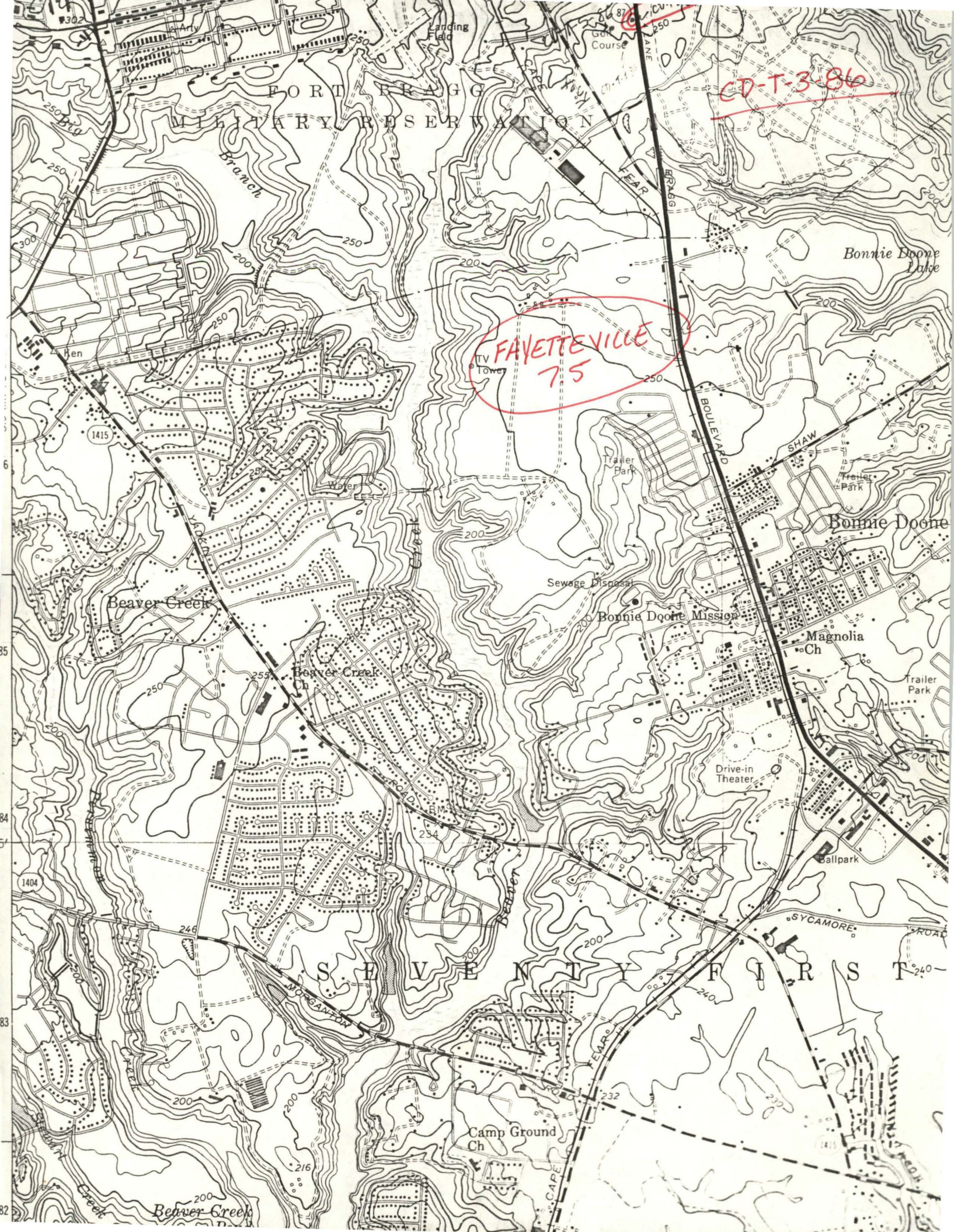

~~CD-T-3-86~~

FAVETTEVILLE
75

FORT BRAGG
MILITARY RESERVATION

Bonnie Doone
Lake

Bonnie Doone

Beaver Creek

Beaver Creek
Ch

Bonnie Doone Mission

Magnolia
Ch

SEVENTY-FIFTH

Camp Ground
Ch

Beaver Creek