





NORTH CAROLINA DEPARTMENT OF NATURAL RESOURCES & COMMUNITY DEVELOPMENT  
WELL RECORD DIVISION OF ENVIRONMENTAL MANAGEMENT  
P. O. Box 27687 - RALEIGH, N.C. 27611 919-733-2020

U-41, A-1-7

DRILLING CONTRACTOR \_\_\_\_\_ REG. NO. \_\_\_\_\_ WELL CONSTRUCTION PERMIT NO. **CU 2399**

1. WELL LOCATION: (Show sketch of the location below)

Nearest Town: Cedar Creek County: Cumberland  
SP 2015 + N.C. 210: Seabrook Sch. Quadrangle No. U-41, A-1 (A)  
(Road, Community or Subdivision and Lot No.)

2. OWNER: GWE

DRILLING LOG

3. ADDRESS: Raleigh

DEPTH FROM \_\_\_\_\_ TO \_\_\_\_\_ FORMATION DESCRIPTION \_\_\_\_\_

4. TOPOGRAPHY: draw, valley, slope, hilltop (flat) (circle one)

5. USE OF WELL: Supply DATE: 7-28-81

6. DOES THIS WELL REPLACE AN EXISTING WELL? no

7. TOTAL DEPTH: 290 RIG TYPE OR METHOD: DRIVEPOINT

8. FORMATION SAMPLES COLLECTED: YES \_\_\_\_\_ NO \_\_\_\_\_

9. CASING: Depth Inside Wall thick. type  
Dia. or weight/ft.  
From 0 to 25 ft 1/4 .014 Galv.

10. GROUT: Depth Material Method  
From \_\_\_\_\_ to \_\_\_\_\_ ft \_\_\_\_\_

If additional space is needed, use back of form

11. SCREEN: Depth Dia. Type & Opening  
From 25 to 29 ft 1/4 .014 Galv.

LOCATION SKETCH  
(Show distance to numbered roads, or other map reference points)

12. GRAVEL: Depth Size Material  
From \_\_\_\_\_ to \_\_\_\_\_ ft \_\_\_\_\_

13. WATER ZONES (depth): \_\_\_\_\_

14. STATIC WATER LEVEL: 10.46 ft. <sup>above</sup> <sub>below</sub> top of casing  
Casing is 90 ft. above land surface ELEV: \_\_\_\_\_

15. YIELD (gpm): 9 METHOD OF TESTING: HAWK PUMP

16. PUMPING WATER LEVEL: \_\_\_\_\_ ft.  
after \_\_\_\_\_ hours at \_\_\_\_\_ gpm.

17. CHLORINATION: Type HTH Amount 1/2 cup

18. WATER QUALITY: \_\_\_\_\_ TEMPERATURE (°F) 22°C

19. PERMANENT PUMP: Date Installed \_\_\_\_\_  
Type \_\_\_\_\_ Capacity \_\_\_\_\_ (gpm) HP \_\_\_\_\_  
Make \_\_\_\_\_ Intake Depth \_\_\_\_\_  
Airline Depth \_\_\_\_\_

20. HAS THE OWNER BEEN PROVIDED A COPY OF THIS RECORD AND INFORMED OF THE DEPARTMENTS REQUIREMENTS AND RECOMMENDATIONS? \_\_\_\_\_

21. REMARKS Sp. Cond. 30 WELL PULLED & ENLARGED (SEE - U-41, A-1)  
I do hereby certify that this well was constructed in accordance with N.C. Well Construction Regulations and Standards and that this well record is true and exact.

Timothy Hill  
SIGNATURE OF CONTRACTOR OF AGENT DATE \_\_\_\_\_

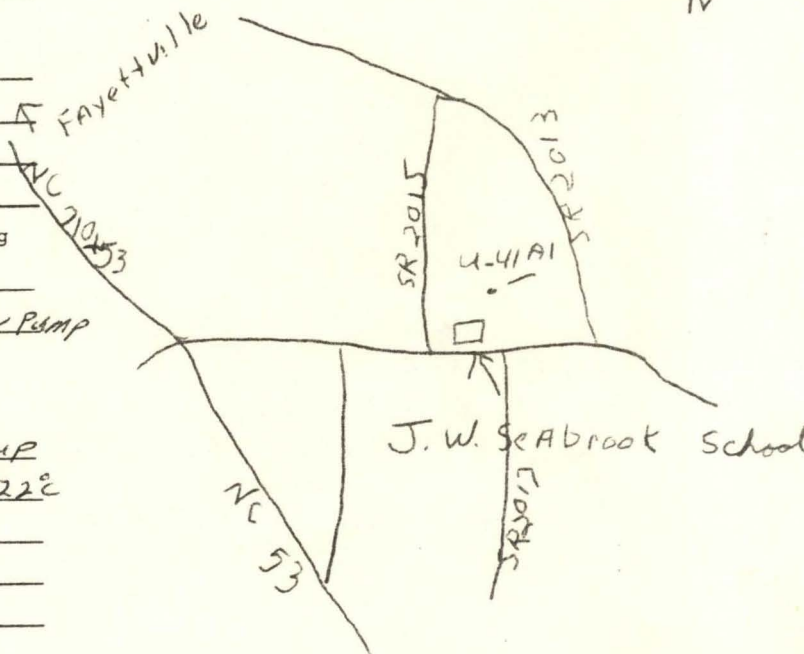

Seabrook Rsch. Sta. U-41, a,

2

CUM-T-3-81

NORTH CAROLINA

DEPARTMENT OF NATURAL AND ECONOMIC RESOURCES

GROUNDWATER SECTION

SEABROOK School  
U-41A-3

Lithologic Log

Well No.: \_\_\_\_\_  
Field \_\_\_\_\_  
Office \_\_\_\_\_  
USGS \_\_\_\_\_

Log by: Timmy Hill Date 7-29-81 County Cumberland

Location, Town Seabrook Elem school - Cedar Creek

Owner GW Driller T.H. Date Drilled 7-29-8-3 81

Depth 280 ft.; Diam. 5 7/8 in.; Cased to 44' ft.; Elev. \_\_\_\_\_ ft. above MSL

Cuttings  T.H. Elec. Log  RW Gamma log  RW

Description	Depth (feet)		Thickness (feet)
	from	to	
white, yellow, gray med grain sand	0	5	15 sec
Brown med grain sand	5	10	13 sec
" " " "	10	15	19 sec
Brown med grain sand w/ white clay	15	20	11 sec
gravel sand w/ white clay	20	25	19 sec
gravel sand w/ wood chips + gray clay	25	30	2m 07 sec
gray clay w/ wood chips + gravel sand	30	35	3m 22 sec
SAME AS ABOVE	35	40	1m 50 sec
" " "	40	45	1m 45 sec
Gray clay	45	50	6m 50 s
gray clay	50	55	9m 05 s
Gray clay	55	60	5m 35 s
gray + white clay	60	70	21m 20 s
white clay	70	80	23m 05 s
white clay	80	90	20m 55 s
white clay w/ med grain sand	90	100	12m 57 s
SAME AS ABOVE	100	110	11m 27 s
white clay	110	120	16m 10 s
various color clays	120	130	18m 30 s



2

DEPARTMENT OF NATURAL AND ECONOMIC RESOURCES  
GROUNDWATER SECTION

441A-2

Lithologic Log

Supply Well,

Well No.: \_\_\_\_\_ Field \_\_\_\_\_  
Office \_\_\_\_\_  
USGS \_\_\_\_\_

Log by: \_\_\_\_\_ Date 7-29-81 County CUMBERLAND

Location, Town SenBrook St. - SE 210 - CedarCreek. NC.

Owner G.W. KINSTON. Driller Jim GREER. Date Drilled 7-29-81

Depth 39' ft.; Diam. 6" in.; Cased to 32 ft.; Elev. 2' ft. above MSL

Cuttings yes' Elec. Log No Gamma log No

Description	Depth (feet)		Thickness (feet)
	from	to	
Red + Brown Sand	0	4'	
lt Brown to Dark Brown Sand.	4'	9'	
Med. Brown Sand	9	14'	
Black clay + Sand	14	19'	lt 42ft.
" " + "	19	24'	
" " + "	24	29'	26' WATER. COARSE SAND.
Med. Brown clay + Sand	29	39'	

NOTE: Blue + gray clay last 5' Feet on of Argea.

Total Depth	SCREEN	Date	Elev.	MP (LS)	SWL (M.P)	GPM	Well Dia,
29'	25' 29'	8/26/81		1.6'	8.85'	9	4"

(9)

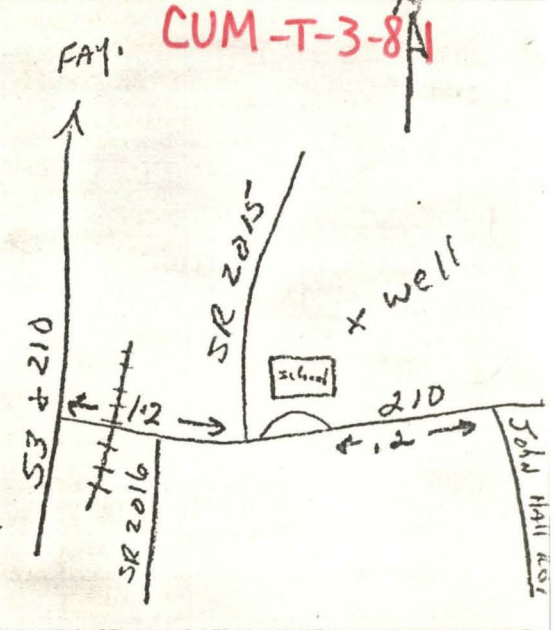

3459 15  
78 45 15

J.W. Seabrook School - Cedar Creek - Cumberland Co.

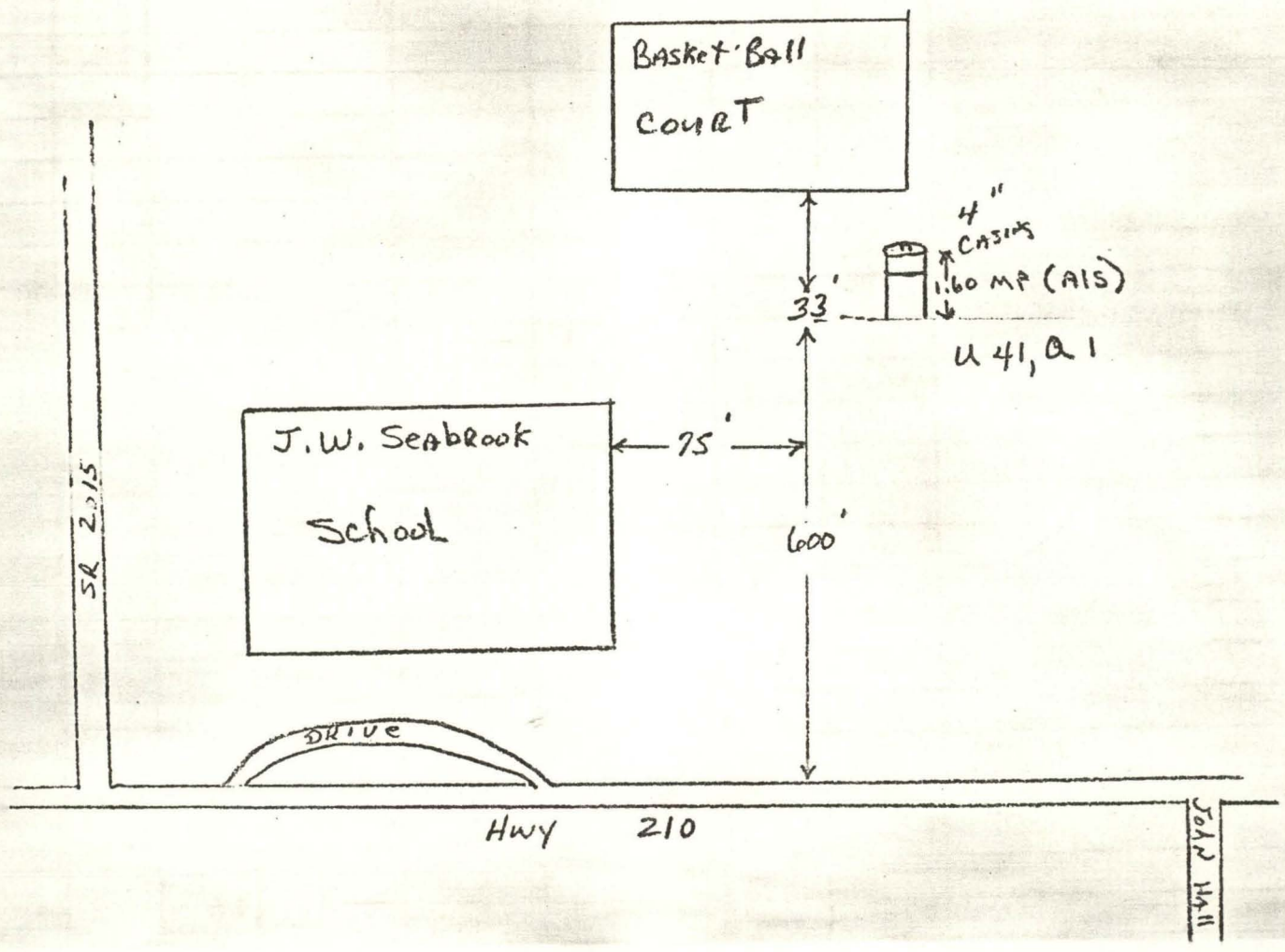

CUM-T-3-81

Board of Education, Cumberland County

Fayetteville, North Carolina 28302

919 437 4111

August 1, 1981

NORTH

W. W. HALL, CHAIRMAN  
J. W. BELMAN, DE. V. P.  
L. W. BUCKMAN  
D. S. FRANCIS STRICKLAND  
A. W. WARNER

LEWIS J. SUPERINTENDENT  
W. H. HARRIS, ASST. SUPERINTENDENT  
W. H. HARRIS, ASST. SUPERINTENDENT  
W. H. HARRIS, ASST. SUPERINTENDENT  
W. H. HARRIS, ASST. SUPERINTENDENT  
W. H. HARRIS, ASST. SUPERINTENDENT  
W. H. HARRIS, ASST. SUPERINTENDENT  
W. H. HARRIS, ASST. SUPERINTENDENT

Mr. Felix A. Register  
North Carolina Department of  
Community Development  
Division of Environmental Management  
Groundwater Section  
P.O. Box 27687  
Raleigh, North Carolina 27611

Re: Seabrook Elementary  
Groundwater Research Station

Dear Mr. Register:

As per our telephone conversation and your letter of July 29, please accept this letter as authorization to drill several wells within the limits of your letter of July 29.

We reviewed the location of additional nitrification lines with your drilling foreman which were not drawn in by you on the plot plan. Mr. Oscar Howard indicated the additional lines were a sufficient distance from his project area.

We anticipate drilling to be complete prior to the opening of school on August 31. If we can be of further assistance, please feel free to call.

Sincerely yours,

Jerry C. Wood  
Assistant Superintendent  
Support Services

SEABROOK SCHOOL (U-41,a-)

CUMBERLAND COUNTY

● STATION SITE

RECEIVED

AUG 3 1981

GROUNDWATER SECTION

To FAYETTEVILLE

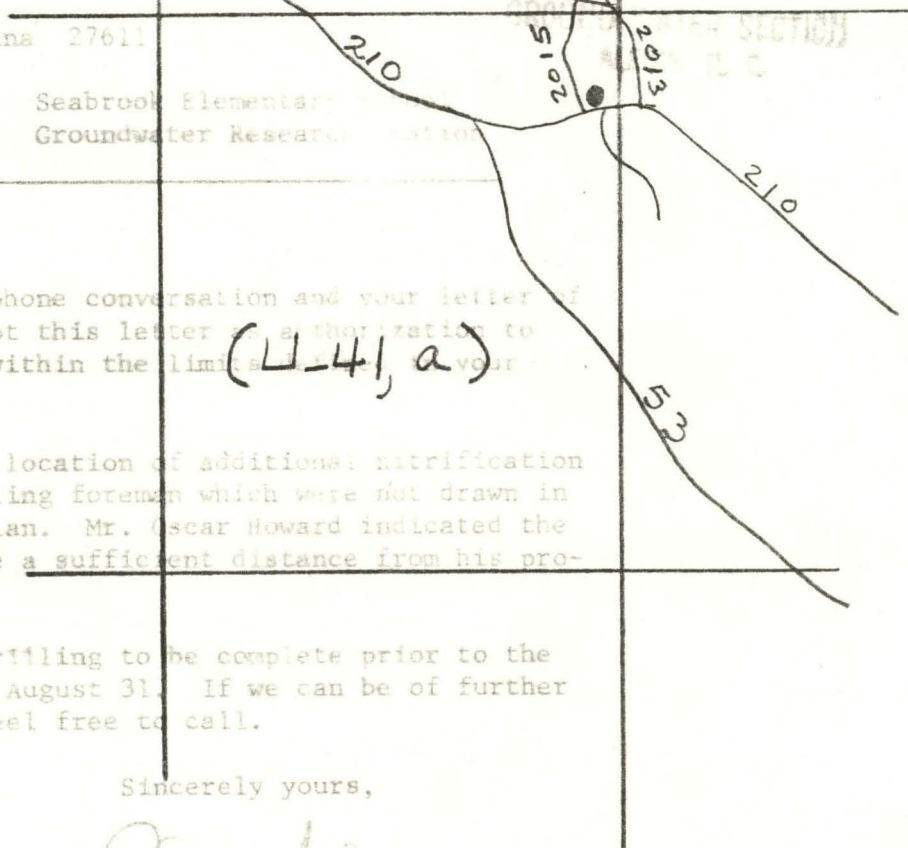

(U-41, a)



CUM-T-3-81

SEABROOK STA. U 41

CUMBERLAND CO.

TO FAYETTEVILLE ←

41

78° 50'

78° 45'

35° 00'

34° 55'

U

