

WELL RECORD

CUM-T-2-68

NORTH CAROLINA DEPARTMENT OF WATER AND AIR RESOURCES
 DIVISION OF GROUND WATER
 BOX 9392 - RALEIGH, N. C.

CU 1114
 T-40, W-1

Drilling Contractor North Pickland

Reg. No.

Well Permit No.

1. Town Steedman

2. Location High 24 base you set & Myrtlewood after

Show a sketch of location on back of form

County Cumberland
 Quadrangle No. High Steedman

3. Owner Reeves Realty

Address Myrtleville, N.C.

4. Topography: draw, slope, hilltop, valley, flat

5. Use of Well Sub-Irrigation Date Completed 9/26/68

6. Rig type or method Rotary Total Depth 146

7. Casing: Depth Diam. Type

From _____ to _____ ft. _____ in.

8. Grout: Depth Material Method

From _____ to _____ ft. _____

9. Screen: Depth Diam. Type and opening

From _____ to _____ ft. _____ in.

11. Water Zones (depth) _____

12. Static Water Level: _____ ft. ^{above}/_{below} top of casing
 which is _____ ft. above land surface.

Date _____

13. Yield (gpm) _____ Method of testing _____

14. Pumping Water Level: _____ ft. after _____ hrs.
 at _____ gpm.

15. Water Quality _____

16. Well sterilization method _____

17. Remarks: Sample picked sep.

35	00	21		
78	42	09		

(place this sheet over correct square on map, match corners and circle a dot at well location.)

10. Permanent Pump:

Installed- Date _____

By _____

Type _____ Make _____

Capacity _____ (gpm) Hp. _____

Intake depth _____

Airline depth _____

Temperature (°F) _____

I do hereby certify that this well record is true and exact.

SIGNATURE OF CONTRACTOR OR AGENT

Depth		Formation	Depth		Formation
From	To		From	To	

LOCATION: Draw sketch below showing location of well in relation to nearby towns, roads, and streams with North in the direction of the arrow. Show distance from well to least two nearby reference points, such as road junctions, stream crossings or other land marks.

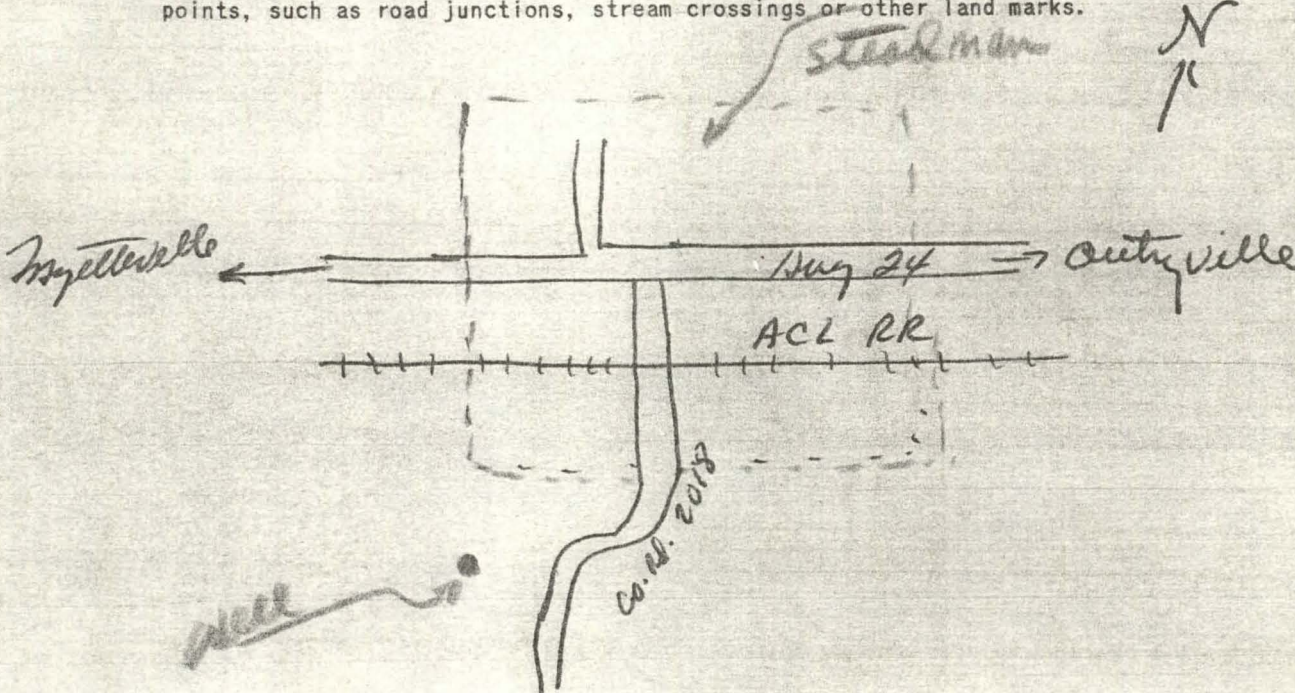

* Well is located in field but well be developed for housing.

preliminary examination
no geophysical logs for this hole
float - no microfossils

SAMPLE DESCRIPTION

elev. 120

Well # CUM-T-2-6B TD 146 Examined by: SRB Date 11/18/83

p. _____ of _____

Key: A - Abundant C - Common M - Minor T - Trace R - Rare X - Major Constituent

Interval	Rock Type	Color	Texture			Quartz	Feldspar	Glauconite	Phosphate	Calcite	Shell Frags	Mica	Pyrite	Lignite	Chalcedony	Amethyst	Rose Quartz	Tourmaline	Siderite	Limestone	Dolomite	M. Fossils	Re-Stain	Hematite + Limonite	Remarks			
			Grain Size	Grain Shape	Sorting																							
10/10	as below		f	SA									T										R	4/R				
10/20	slightly clay sd		f	SA									T											R	4/R			
20/30	loose sd		med	SA									T											R	4/R	white clay fragments		
30/40	as below		med	SA									T													med. gray - dark gray clay fragments		
40/50	slightly clay sd	sulphur bloom	crs	SA																					4/R			
50/60	loose sd		med	A/SA																							+ dark med gray clay fragments	
60/70	slightly clay sd		med	SA/A																					R	dark gray clay fragments		
70/80	aa		med/c	A																							light gray clay fragments	
80/90	aa		crs	SA/A																								
90/100	as below		crs	A SA																								aa
100/110	loose sd		med	A/SA																								aa
110/120	slightly clay sd		med/crs	A																								aa
120/130	aa		med	A																								aa + rare iron stained yellow and red clay fragments
130/146	loose sd		med/crs	A																								more light gray clay fragments
Surficial 0-30, un ^{dark} C? Bl [?]			30-80 Unit ^F 80-146 (Cope Fea)																									