

**B 1** 8712 SEQUENCE NO. (WRA USE ONLY)  
 1 2 3 (SEQ. NO.) 6  
 (THIS NUMBER IS TO BE PUNCHED IN COLS. 3-6 ON ALL CARDS)

**STATE OF MARYLAND**  
**WATER RESOURCES ADMINISTRATION**  
 TAWES STATE OFFICE BLDG., ANNAPOLIS, MARYLAND 21401  
**APPLICATION FOR PERMIT TO DRILL WELL**

**WRA PERMIT NUMBER**  
CE-DC 2  
**FILL IN THIS FORM COMPLETELY**

DATE RECEIVED (WRA USE ONLY)  
 8-13

**OWNER** DEPT. OF GENERAL SERVICES - STATE OF MARYLAND  
 COL 15 LAST NAME FIRST NAME COL. 34  
**STREET OR RFD** 301 West Preston Street **CE-DC 2**  
 COL 36 COL. 55  
**POST OFFICE** Edwards, Maryland 21201  
 COL 57 COL. 76

**B 1 CONTINUED DRILLER INFORMATION**  
 1 2 3 (SEQ. NO.) 6  
**DATE** 2/20/76 **LICENSE NUMBER** 7005  
 77 80  
**FIRST NAME** Tom **DRILLER** Downy **LAST NAME**  
**SIGNATURE** Tom A. Downy

**B 3 LOCATION OF WELL**  
 1 2 3 (SEQ. NO.) 6  
**COUNTY** Deale (DO NOT ABBREVIATE COUNTY NAME) 21  
**SUBDIVISION** 23 42  
**SECTION** 44 46 48 50  
**NEAREST TOWN** Grovesville 52 71  
**MILES FROM TOWN** (ENTER 0 IF IN TOWN) 8 M I 73 76 77 78

**B 2 WELL INFORMATION**  
 1 2 3 (SEQ. NO.) 6  
**MAXIMUM PUMPING RATE** (GALLONS PER MINUTE) None 8 12  
**AVERAGE DAILY QUANTITY NEEDED** (GALLONS PER DAY) None 14 20  
**USE FOR WATER** (CIRCLE APPROPRIATE BOX)  
 D HOME (SINGLE OR DOUBLE HOUSEHOLD UNIT ONLY)  
 F FARMING, AGRICULTURE, IRRIGATION  
 I INDUSTRIAL, COMMERCIAL, STATE AND FEDERAL GOVERNMENT.  
 M MUNICIPAL WATER SUPPLY } MUST HAVE STATE HEALTH DEPT. APPROVAL  
 P PRIVATE WATER COMPANY }  
 T TEST

**B 4 DIRECTION FROM TOWN**  
 (CIRCLE APPROPRIATE BOX)  
 N NORTH  E EAST  NE NORTHEAST  SE SOUTHEAST  
 S SOUTH  W WEST  NW NORTHWEST  SW SOUTHWEST  
**NEAR WHAT ROAD** Grove Neck Rd  
 ON WHICH SIDE OF ROAD (CIRCLE APPROPRIATE BOX)  N  S  E  W  
**DISTANCE FROM ROAD** (ENTER DISTANCE AND CIRCLE APPROPRIATE BOX) 100' +/- M I 34 37 38 39

**APPROXIMATE DEPTH OF WELL** 1,100 FEET  
 24 28

**APPROXIMATE DIAMETER OF WELL** 4 (NEAREST INCH)

**METHOD OF DRILLING USED** (CIRCLE APPROPRIATE METHOD)  
 BORED (OR AUGERED)  JETTED  DRIVEN  
 30-37  AIR-ROTARY  AIR-PERCUSSION  ROTARY (HYDRAULIC ROTARY)  
 CABLE  REVERSE-ROTARY  DRIVE-POINT  
 OTHER (DESCRIBE) \_\_\_\_\_

**REPLACEMENT OR DEEPEMED WELLS** (CIRCLE APPROPRIATE BOX)  
 N THIS WELL WILL NOT REPLACE AN EXISTING WELL  
 Y THIS WELL WILL REPLACE A WELL THAT WILL BE ABANDONED AND SEALED  
 S THIS WELL WILL REPLACE A WELL THAT WILL BE USED AS A STANDBY  
 D THIS WELL WILL DEEPEM AN EXISTING WELL PERMIT NUMBER OF WELL TO BE REPLACED OR DEEPEMED (IF AVAILABLE)  
 41 52

**NOT TO BE FILLED IN BY DRILLER** (WRA USE ONLY)  
**APPROPRIATION PERMIT NUMBER** 54 **ENGINEER REVIEW DISTRICT NO.** 63  
**FORCE**  T  U **WRITE INITIALS IN BOX** **CONDITIONS** 70 71 72 73 74 75 76 77 78 79

**B 4 CONTINUED HEALTH DEPARTMENT APPROVAL**  
 1 2 3 (SEQ. NO.) 6  
 S **STATE HEALTH (CIRCLE BOX)** COUNTY NAME Cecil COUNTY NO. \_\_\_\_\_  
 MO. DAY YR. 09 30 76 APPROVED BY \_\_\_\_\_  
 43 48

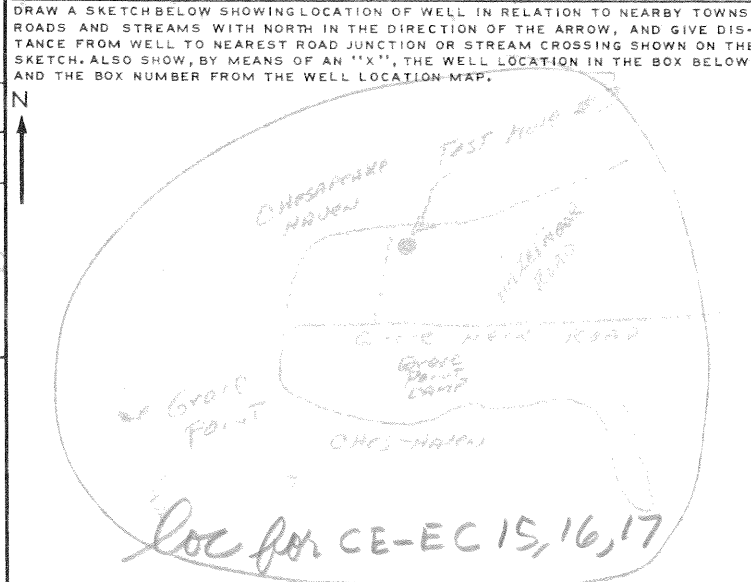

**BOX NUMBER** E 1070  
 N 570  
 0/5 5/5  
**NORTH COORDINATE** 50 51 52 53 54 55  
**EAST COORDINATE** 57 58 59 60 61 62 63  
**ELEVATION AT WELL HEAD (FEET)** 65 66 67 68  
 0/0 5/0

**B 5 SPECIAL CONDITIONS 8-63 (WRA USE ONLY)**  
 1 2 3 (SEQ. NO.) 6

C 1 2281  
 SEQUENCE NO. (WRA USE ONLY)  
 1 2 3 (SEQ. NO.) 6  
 (THIS NUMBER IS TO BE PUNCHED IN COLS. 3-6 ON ALL CARDS)

**STATE OF MARYLAND**  
**WATER RESOURCES ADMINISTRATION**  
 TAWES STATE OFFICE BLDG., ANNAPOLIS, MD. 21401  
**WELL COMPLETION REPORT**

THIS REPORT MUST BE SUBMITTED WITHIN 30 DAYS AFTER WELL COMPLETION  
**FILL IN THIS FORM COMPLETELY**  
 COUNTY NUMBER

DATE RECEIVED (WRA USE ONLY)  
 DATE WELL COMPLETED  
 8-13 15 20

DEPTH OF WELL  
 22 (TO NEAREST FOOT) 26

PERMIT NO. FROM "PERMIT TO DRILL WELL"  
**CE-73-1721**  
 28 29 30 31 32 33 34 35 36 37  
 DRILLERS IDENTIFICATION NO.

OWNER: **U.S.G.S - MGS (Test Well at Turkey Point, Cecil County**  
 LAST NAME FIRST NAME  
 STREET OR RFD POST OFFICE

**WELL LOG**  
 STATE THE KIND OF FORMATIONS PENETRATED, THEIR COLOR, DEPTH, THICKNESS AND IF WATER BEARING  
 DESCRIPTION (USE ADDITIONAL SHEETS IF NECESSARY)  
 FEET FROM TO CHECK IF WATER BEARING

**GROUTING RECORD**  
 WELL HAS BEEN GROUTED (CIRCLE APPROPRIATE BOX) YES  Y 44 NO  N 44  
 TYPE OF GROUTING MATERIAL (CIRCLE BOX)  
 CEMENT  C  M 45 46 BENTONITE CLAY  B  C 45 46  
 NO. OF BAGS NO. OF POUNDS  
 GALLONS OF WATER  
 DEPTH OF GROUT SEAL (TO NEAREST FOOT)  
 FROM 48 FT. TO 54 FT. (ENTER 0 IF FROM SURFACE)

**CASING RECORD**  
 CASING TYPES (INSERT APPROPRIATE CODE BELOW)  
 S  T STEEL  C  O CONCRETE  
 P  L PLASTIC  O  T OTHER  
 MAIN CASING TYPE NOMINAL DIAMETER TOP (MAIN) CASING (NEAREST INCH) TOTAL DEPTH OF MAIN CASING (NEAREST FOOT)  
 60 61 63 64 66 70

**OTHER CASING (IF USED)**  
 DIAMETER (INCH) DEPTH (FEET) FROM TO  
 E A C H C A S I N G

**SCREEN RECORD**  
 SCREEN TYPE OR OPEN HOLE (INSERT APPROPRIATE CODE BELOW)  
 S  T STEEL  B  R BRASS OR BRONZE  H  O OPEN HOLE  
 P  L PLASTIC  O  T OTHER

C 2  
 1 2 3 (SEQ. NO.) 6  
**DEPTH (NEAREST WHOLE FOOT)**  
 FROM TO  
 1 8 9 11 15 17 21  
 2 23 24 26 30 32 36  
 3 38 39 41 45 47 51  
 SLOTSIZE 1, 2, 3

DIAMETER OF SCREEN 56 (NEAREST INCH) FROM 60 TO  
 GRAVEL PACK  
 IF WELL DRILLED WAS A FLOWING WELL CIRCLE BOX 68  F

**WRA USE ONLY (NOT TO BE FILLED IN BY DRILLER)**  
 T (E.R.O.S.) W O  
 70  72  74 75 76  
 TELESCOPE CASING LOG INDICATOR OTHER DATA AVAILABLE

C 3  
 1 2 3 (SEQ. NO.) 6  
**PUMPING TEST**  
 HOURS PUMPED (TO NEAREST HOUR) 8 9  
 PUMPING RATE (GALLONS PER MINUTE TO NEAREST GALLON) 11 15  
 METHOD USED TO MEASURE PUMPING RATE  
**WATER LEVEL: (DISTANCE FROM LAND SURFACE)**  
 BEFORE PUMPING 17 (NEAREST FOOT) 20  
 WHEN PUMPING 22 (NEAREST FOOT) 25

**TYPE OF PUMPED USED (CIRCLE APPROPRIATE BOX) (FOR PUMPING TEST)**  
 A AIR 27  P PISTON 27  T TURBINE 27  
 C CENTRIFUGAL 27  R ROTARY 27  O OTHER (DESCRIBE BELOW) 27  
 J JET 27  S SUBMERSIBLE 27

**PUMP INSTALLED**  
 TYPE OF PUMP (WRITE APPROPRIATE LETTER IN BOX - SEE ABOVE: A, C, J, P, R, S, T, O) 29  
 DRILLER WILL INSTALL PUMP (CIRCLE APPROPRIATE BOX) YES  Y NO  N  
 CAPACITY:  
 GALLONS PER MINUTE (TO NEAREST GALLON) 31 35  
 PUMP HORSE POWER 37 41  
 PUMP COLUMN LENGTH (NEAREST FOOT) 43 47

**CASING HEIGHT (CIRCLE APPROPRIATE BOX AND ENTER CASING HEIGHT)**  
 + ABOVE } LAND SURFACE (NEAREST FOOT)  
 - BELOW } 49 50 51

**LOCATION OF WELL ON LOT**  
 SHOW PERMANENT STRUCTURE SUCH AS BUILDINGS, SEPTIC TANKS, AND/OR OTHER LAND MARKS AND INDICATE NOT LESS THAN TWO DISTANCES (MEASUREMENTS TO WELL).

**CIRCLE APPROPRIATE BOXES**  
 A A WELL WAS ABANDONED AND SEALED WHEN THIS WELL WAS COMPLETED  
 E ELECTRIC LOG OBTAINED  
 P TEST WELL CONVERTED TO PRODUCTION WELL

I HEREBY CERTIFY THAT I HAVE COMPLIED WITH ALL CONDITIONS STATED ON THE ABOVE-CAPTIONED "PERMIT TO DRILL WELL", AND THAT INFORMATION CONTAINED IN THIS REPORT IS TRUE, ACCURATE, AND COMPLETE TO THE BEST OF MY KNOWLEDGE, INFORMATION AND BELIEF.

DRILLERS NAME  
 (PLEASE PRINT)  
 SIGNATURE

Ce-Dc 2

Ce-Ec 15, 16, 17

Har-Dg 2, 3

In order to unscramble the confusion about the permit numbers for these test wells (i.e., mis-matched permits and completion reports), the microfiche record was examined, with the following results and correct permit numbers:

FIRST SITE DRILLED: Aug-Nov. 1976

HA-73-3413

Location: Spesutie Island.

Originally designated permit CE-73-1720, and later changed by DNR/WRA, presumably when it was discovered that the site had been incorrectly given a Cecil County permit number.

USGS well numbers Har-Dg 2 and Dg 3.

SECOND SITE DRILLED:

Dec. 1976 - Jan. 1977

CE-73-1721 ✓

Location: Elk Neck: Turkey Pt.  
USGS well number Ce-Dc 2.

Ce-Dc 2  
Ce-Ec 15, 16, 17  
Har-Dg 2, 3

THIRD SITE DRILLED: Feb.-Apr. 1977

CE-73-1722

Location = Cecilton: Grove Neck  
USGS well numbers Ce-Ec 15,  
16, and 17.

Apparently only one permit number was issued for each site, even though there was more than one hole put down at two of the three sites.

According to the microfiche edition of the printout for Cecil County, the permit number CE-73-1720 was dropped from the numbered sequence after it was discovered that this well was really in Harford County.

cc: R. Willey  
H. Hansen  
USGS-Towson + Balto.  
well sched. files

C. A. Richardson  
May 25, 1983

FOUNDATION TESTING and SOIL SAMPLING RECORD

NAME: General Services Div. State of Md. LOCATION: Turkey point site  
HOLE NO. 2 SURFACE ELEVATION \_\_\_\_\_ RIG NO. \_\_\_\_\_ DATE: From 12-7-76 To 1-21-77

BORING LOG		SPOON SAMPLE AND CORE DATA				BLOWS ON CASE	
DEPTH FROM-TO	DESCRIPTION OF MATERIAL Based On Samples Recovered Plus Observation Of Material Returned Between Samples	SAMPLE NUMBER	DEPTH FROM-TO	BLOWS PER FT. ON SAMPLES	ROCK CORE RECOV'D	D=DRY U=UNDISTURBED T=TRAP W=WASH R=ROD C=CORE	NO. PCS.
0'	Sand & gravel		0'-10'				0-1
176'	Some cobbles		10'-30'				1-2
			20'-30'				2-3
			30'-40'				3-4
			40'-50'				4-5
			50'-60'				5-6
			60'-70'				6-7
			70'-80'				7-8
76'	Red & grey clay	1	80'-82'		24"	3" splitspoon sample	8-9
126'			80'-90'			wash sample	9-10
			90'-100'				10-11
			100'-110'				11-12
126'	Sand & Fine gravel		110'-120'				12-13
208'			120'-130'				13-14
			130'-140'				14-15
			140'-150'				15-16
			150'-160'				16-17
			160'-170'				17-18
			170'-180'				18-19
			180'-190'				19-20

DATE	DEPTH	DATE
60'	8 1/2"	1-25-77

PIPE AND CASING LEFT IN HOLE		
SIZE	AMOUNT	REASON

DISTANCE	HAMMER DROP	INCH
46-47	DRIVE HAMMER	LBS.
47-48	SPOON HAMMER	LBS.
49-49	CASING SIZE	INCH
49-50	SPOON SIZE	INCH
50-51	SIZE OF CORE BIT	INCH

NOTE: Classification of soil has been made by the driller and has not been checked by a soils engineer. Classification of rock has been made by the driller and has not been checked by a geologist.

Under Remarks mention kind of Bit, loss of sample, loss of Drilling water, soft seamy or broken Rock, Caving, Cavities, unusual Ground at depth encountered.

Driller Carl Ward  
 Helper L.R. Dowdy  
 Helper Joseph Dowdy

321 C2 De 2

SPRAGUE & HENWOOD, Inc. SCRANTON, PA.

16321

FOUNDATION TESTING and SOIL SAMPLING RECORD

(2)

NAME: General Services Div. State of Pa. LOCATION: Turkey point rd.

HOLE NO. 2 SURFACE ELEVATION RIG NO. DATE: From 12-7-76 To 1-21-77 19

Main data table with columns: BORING LOG, SPOON SAMPLE AND CORE DATA, BLOWS ON CASE. Includes soil descriptions like 'Fine Brown Sand', 'grey clay', 'Hard Red & grey C. clay' and depth ranges from 208' to 390'.

Vertical handwritten notes on the right side: 'mud slump', 'Drill from 74' to 936' with NX bit', 'mud slump', 'mud slump'.

Summary tables for GROUND WATER, PIPE AND CASING LEFT IN HOLE, and DISTANCE HAMMER DROP.

NOTE: Classification of soil has been made by the driller and has not been checked by a soils engineer. Classification of rock has been made by the driller and has not been checked by a geologist.

Driller: O. Ward, Helper: L.R. Dowdy, Helper: JOSEPH Dowdy

302 Ce Dc 2

SPRAGUE & HENWOOD, Inc. SCRANTON, PA.

16321

FOUNDATION TESTING and SOIL SAMPLING RECORD

3

NAME: General Services Div. State of Ind. LOCATION: Turkey point ind.

HOLE NO. 2 SURFACE ELEVATION RIG NO. DATE: From 12-7-76 To 1-21-77 19

Main data table with columns: BORING LOG, SPOON SAMPLE AND CORE DATA, BLOWS ON CASING. Includes rows for depths 360-551' and descriptions like 'Sand', 'Brown & grey sandy clay'.

GROUND WATER table with columns: DEPTH, HOLE, DATE.

PIPE AND CASING LEFT IN HOLE table with columns: SIZE, AMOUNT, REASON.

DISTANCE HAMMER DROP table with columns: DRIVE HAMMER, SPOON HAMMER, CASING SIZE, SPOON SIZE, SIZE OF CORE BIT.

NOTE: Classification of soil has been made by the driller and has not been checked by a soils engineer. Classification of rock has been made by the driller and has not been checked by a geologist.

Driller: C. Ward, Helper: L.R. Dowdy, Helper: Joseph Dowdy

Ce DC 2

SPRAGUE & HENWOOD, Inc. SCRANTON, PA.

16321

FOUNDATION TESTING and SOIL SAMPLING RECORD

(4)

NAME: Element Services Div. State of Md. LOCATION: Turkey Point Md.

BOLE NO. 2 SURFACE ELEVATION \_\_\_\_\_ RIG NO. \_\_\_\_\_ DATE: From 12-7-76 To 1-21-77 19

BORING LOG		SPOON SAMPLE AND CORE DATA				BLOWS ON CASI					
DEPTH	DESCRIPTION OF MATERIAL	SAMPLE NUMBER	DEPTH FROM-TO	BLOWS PER FT. ON SAMPLES	ROCK CORE RECOV'D	D=DRY	U=UNDISTURBED	T=TRAP	0-1	1-2	
FROM-TO	Based On Samples Recovered Plus Observation Of Material Returned Between Samples					W=WASH	R=ROD	C=CORE	1-2	2-3	3-4
						CORE RECOV'D -- NO. PCS.					
						REMARKS *					
551'	Clay		540'								
			550'								
567'			550'								
567'	Clay & sand layers		560'								
			570'								
571'			570'								
571'	Red & grey sandy clay	7	578'								
				580'							
590'				580'							
590'	Red & grey clay		Sample taken from roller bit at 593'								
			590'								
640'-6"			600'								
			600'								
			Sample taken from roller bit at 610'								
			610'								
	limestone		620'								
			630'								
644'			640'								
	Sand & gravel		640'								
			650'								
708'			660'								
	grey clay - sandy		670'								
			680'								
725'			680'								
			690'								
			700'								
			710'								

GROUND WATER			PIPE AND CASING LEFT IN HOLE			DISTANCE HAMMER DROP		INCH
DEPTH	WATER	DATE	SIZE	AMOUNT	REASON	DRIVE HAMMER	LBS.	
						SPOON HAMMER	LBS.	
						CASING SIZE	INCH	
						SPOON SIZE	INCH	
						SIZE OF CORE BIT	INCH	

NOTE: \* Classification of soil has been made by the driller and has not been checked by a soils engineer. Classification of rock has been made by the driller and has not been checked by a geologist.

Under Remarks mention kind of Bit, loss of sample, loss of Drilling water, soft seamy or broken Rock, Caving, Cavities, unusual Ground water conditions, etc., at depth encountered.

Driller Carl Ward  
 Helper L.R. Dowdy  
 Helper JOSEPH DOWDY



FOUNDATION TESTING and SOIL SAMPLING RECORD

(5)

NAME: General Services Div. State of Ind. LOCATION: Turkey point rd.

HOLE NO. 2 SURFACE ELEVATION \_\_\_\_\_ RIG NO. \_\_\_\_\_ DATE: From 12-7-76 To 1-31-77

BORING LOG		SPOON SAMPLE AND CORE DATA				BLOWS ON CASING		
DEPTH	DESCRIPTION OF MATERIAL	SAMPLE NUMBER	DEPTH FROM-TO	BLOWS PER FT. ON SAMPLES	ROCK CORE RECOV'D	D=DRY U=UNDISTURBED T=TRAP W=WASH R=ROD C=CORE	C-1	C-2
FROM-TO	Based On Samples Recovered Plus Observation Of Material Returned Between Samples					CORE RECOV'D -- NO. PCS. REMARKS *	1-2	3-4
725'	Sand					sample taken from roller bit at 710'		
739'			710'/730'			wash sample		
739'	Sand with seams of clay		730'/730'			" "		
764'			730'/740'			" "		
764'	C clay		740'/750'			" "		
773'			750'/760'			" "		
773'			760'/770'			" "		
773'	Sand with small layers of ironstone		770'/780'			" "		
785'			780'/790'			sample taken from roller bit at 791'		
785'	Decomposed mica schist					started drilling at 791' with NX-WL core barrel		
898'			791'/801'			None Note - wash		
			801'/811'			None samples taken every 10' in		
			811'/821'			None Dep rock from 791' to 848'		
			821'/831'			None where no core was recovered		
			831'/841'			None		
			841'/848'			None		
			848'/849'			12" Recovery 2" split spoon sample		
			849'/859'			7'-0" c		
			859'/865'-6"			5'-8" c		

GROUND WATER			PIPE AND CASING LEFT IN HOLE			DISTANCE HAMMER DROP		
DEPTH	HOUR	DATE	SIZE	AMOUNT	REASON	DRIVE HAMMER	LBS.	INCH
						SPOON HAMMER	LBS.	INCH
						CASING SIZE	INCH	INCH
						SPOON SIZE	INCH	INCH
						SIZE OF CORE BIT	INCH	INCH

NOTE: \* Classification of soil has been made by the driller and has not been checked by a soils engineer. Classification of rock has been made by the driller and has not been checked by a geologist.  
Other Remarks mention kind of Bit, loss of sample, loss of Drilling rate, soft seamy or broken Rock, Caving, Cavities, unusual Ground conditions, etc., at depth encountered.

Driller Carlward  
Helper L.R. DOWDY  
Helper JOSEPH DOWDY

Ce Dc 2

SPRAGUE & HENWOOD, Inc.  
SCRANTON, PA.

16321

FOUNDATION TESTING and SOIL SAMPLING RECORD

6

NAME: General Services Div. State of Ind. LOCATION: Turkey point rd.  
 HOLE NO. 2 SURFACE ELEVATION \_\_\_\_\_ RIG NO. \_\_\_\_\_ DATE: From 12-7-76 To 1-21-77 19\_\_

BORING LOG		SPOON SAMPLE AND CORE DATA				BLOWS ON CASING	
DEPTH FROM-TO	DESCRIPTION OF MATERIAL Based On Samples Recovered Plus Observation Of Material Returned Between Samples	SAMPLE NUMBER	DEPTH FROM-TO	BLOWS PER FT. ON SAMPLES	ROCK CORE RECOV'D	D=DRY U=UNDISTURBED T=TRAP W=WASH R=ROD C=CORE CORE RECOV'D -- NO. PCS. REMARKS *	0-1 1-2 2-3 3-4 4-5 5-6 6-7 7-8 8-9 9-10 10-11 11-12 12-13 13-14 14-15 15-16 16-17 17-18 18-19 19-20 20-21 21-22 22-23 23-24 24-25 25-26 26-27 27-28 28-29 29-30 30-31 31-32 32-33 33-34 34-35 35-36 36-37 37-38 38-39 39-40 40-41 41-42 42-43 43-44 44-45 45-46 46-47 47-48 48-49 49-50 50-51
785'	Decomposed mica schist		865'-6"		None		50-52
			870'				53-54
898'			880'		2'-0" C	- Basement	55-56
				890'		9'-0" C	
			890'		2'-0" C	- Basement	59-60
				898'			
898'	Hard mica schist Rock.		898'		5'-0" C		63-64
				903'		10'-0" C	
936'-0"			913'		7'-6" C		67-68
				920'-6"		10'-0" C	
			930'-6"		5'-1" C	Bottom of hole.	71-72
				936'-0"			936'-0"
STANDBY TIME WHILE ENGINEERS ELECTRIC LOGGED HOLE.							75-76
12-21-76 - 3:00 PM to 6:30 PM - 3 HRS 30 MIN							77-78
12-30-76 - 11:00 AM to 1:00 PM - 2 HRS							79-80
1-7-77 - 1:30 PM to 4:30 PM - 3 HRS							81-82
1-21-77 - 10:30 AM to 1:30 PM - 3 HRS							83-84
TOTAL STANDBY TIME - 10 HRS. 30 MIN							85-86

GROUND WATER		
DEPTH	TIME	DATE
60"	8:00 AM	1-25-77

PIPE AND CASING LEFT IN HOLE		
SIZE	AMOUNT	REASON
HX W/L	220'	STUCK IN HOLE
DRILL RODS		FROM 600' TO 820'
3/4" OD		

DISTANCE HAMMER DROP		INCH
DRIVE HAMMER		LBS.
SPOON HAMMER		LBS.
CASING SIZE		INCH
SPOON SIZE		INCH
SIZE OF CORE BIT		INCH

NOTE: \*Classification of soil has been made by the driller and has not been checked by a soils engineer. Classification of rock has been made by the driller and has not been checked by a geologist.  
 \* Under Remarks mention kind of Bit, loss of sample, loss of Drilling water, soft seamy or broken Rock, Caving, Cavities, unusual Ground water conditions, etc., at depth encountered.

Driller Paul Ward  
 Helper L.R. Dowdy  
 Helper JOSEPH Dowdy