

State of Maryland
 Department of Natural Resources
 Energy & Coastal Zone Administration
 Tawes State Office Building
 Annapolis, Maryland 21401

Permit Number 110

Well Number 3

Company Texas Eastern

County Garrett

COMPLETION REPORT

(oil or gas well)

This report must be submitted within 30 days after completion of the well

WELL DESCRIPTION - KIND OF WELL: Gas Storage

(~~Oil~~, Gas, Other)

NAME & WELL NO. <u>E. Everly #3</u>	Size of Casting and Tubing	Used in Drilling	Left in Well	Packers: Type, Size and Depth
ELEVATION: <u>2287'</u> LEASE: <u>Everly</u>	20" OD		22'	
DRILLING COMMENCED: <u>6-9-77</u> DRILLING COMPLETED: <u>8-8-77</u>	13 3/8" OD		308'	
PRODUCTION: <u>Natural Flow Oriskany</u>	9 5/8" OD		2986'	
Open Hole completion 7,500 MCFGD	7" OD		7142'	
RESERVOIR PRESSURE <u>NA</u> psig ----- hrs.				
WELL TREATMENT: (Shooting , Acidizing, Fracturing, Etc.)				
Acid-sand-frac OH Oriskany w/3000 gals 7 1/2% MCA, 40,000 gals 3% HCL, 60,000# 100 mesh sd w/other additives.				PERFORATIONS AT:
RESERVOIR PRESSURE AFTER TREATMENT: <u>Not Taken</u>				
RESULTS AFTER TREATMENT: <u>33,000 MCFGD</u>				
REMARKS: <u>Halliburton Pkr. Shoe 7110'</u> <u>Halliburton DV Pkr 5385'</u>				

CEMENTING DATA: (Size Pipe, Depth, No. Bags, Date)

20" Casing - 13 sx Reg w/2% CaCl₂.

13 3/8" Casing - 115 sx Thixotropic & 100 sx Reg 2% CaCl₂.

9 5/8" Casing - 700 sx Halliburton Lite & 200 sx reg w/2% CaCl₂.

7" Casing - 1st stage - 490 sx 25-75 Poz & 50 sx Latex. 2nd Stage - 1280 sx 25-75 Poz & 50 sx Latex.

GEOPHYSICAL LOGS (Type of Geophysical Logs Run on Well)

Form-Den-CAL, Directional, Temp., GR

State of Maryland
 Department of Natural Resources
 Energy & Coastal Zone Administration
 Tawes State Office Building
 Annapolis, Maryland 21401

GEOLOGICAL LOG

FORMATION	TOP	BOTTOM	GAS AT	OIL AT	WATER AT (Fresh or Salt Water)	REMARKS
Tully Lime	6312	6327				
Onondaga Lime	6978	6993				
Chert	6993	7098				Chert 103 MCFGD
Needmore Shale	7098	7128				
Oriskany Sand	7122	7209				Orisk 7,500 MCFGD Natural
Heldeberg Lime	7209	----				

This completion report is accurate to the best of my knowledge.

Date January 18, 1978

APPROVED *A. J. Lunde*

By *Eng.*
(Title)

COMPANY Texas Eastern Trans Corp

APPLICATION FOR PERMIT TO DRILL OIL OR GAS WELL

(Applications must be submitted in triplicate)

E. Everly #3

OWNER Texas Eastern Transmission Corporation

STREET or R.F.D. P. O. Box 2521

POST OFFICE Houston, Texas 77001

LOCATION OF WELL

COUNTY Garrett

NEAREST POST OFFICE Accident

Distance from Post Office 13,956.94'

Direction from Post Office S 2° 25' 36" E

PERMIT TO DRILL WELL

NOT TO BE FILLED IN BY APPLICANT

PERMIT NO. 110

The permit is herewith granted subject to the conditions stipulated.

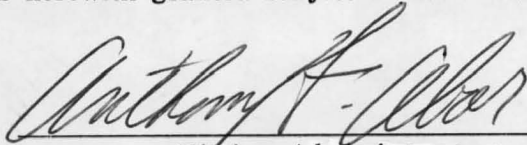
 Mining Administrator

Date June 7, 1977

Special conditions that may apply:

Gas Storage Only

Name of drillers must be furnished prior to drilling of well.

APPROXIMATE DEPTH OF WELL (feet) 7560

METHOD OF DRILLING Rotary

DEEPEST GEOLOGIC FORMATION
 WELL WILL BE DRILLED Into Helderberg

DISTANCE OF WELL LOCATION
 TO NEAREST BUILDING (feet) 990'±

NUMBER OF SHIFTS PER DAY 3

LICENSED DRILLER IN CREW OF EACH SHIFT
NAME ADDRESS

To be Furnished

These names may be supplied later but before drilling begins

The names and post office addresses of the owners of the tracts of land included on the plat or map accompanying the application are to be given below.

NOTE

A BOND FOR \$2,500 PAYABLE TO THE STATE OF MARYLAND MUST ACCOMPANY THE APPLICATION
 THIS APPLICATION FORM MUST BE FILLED OUT WITH TYPEWRITER OR IN BLOCK LETTERS

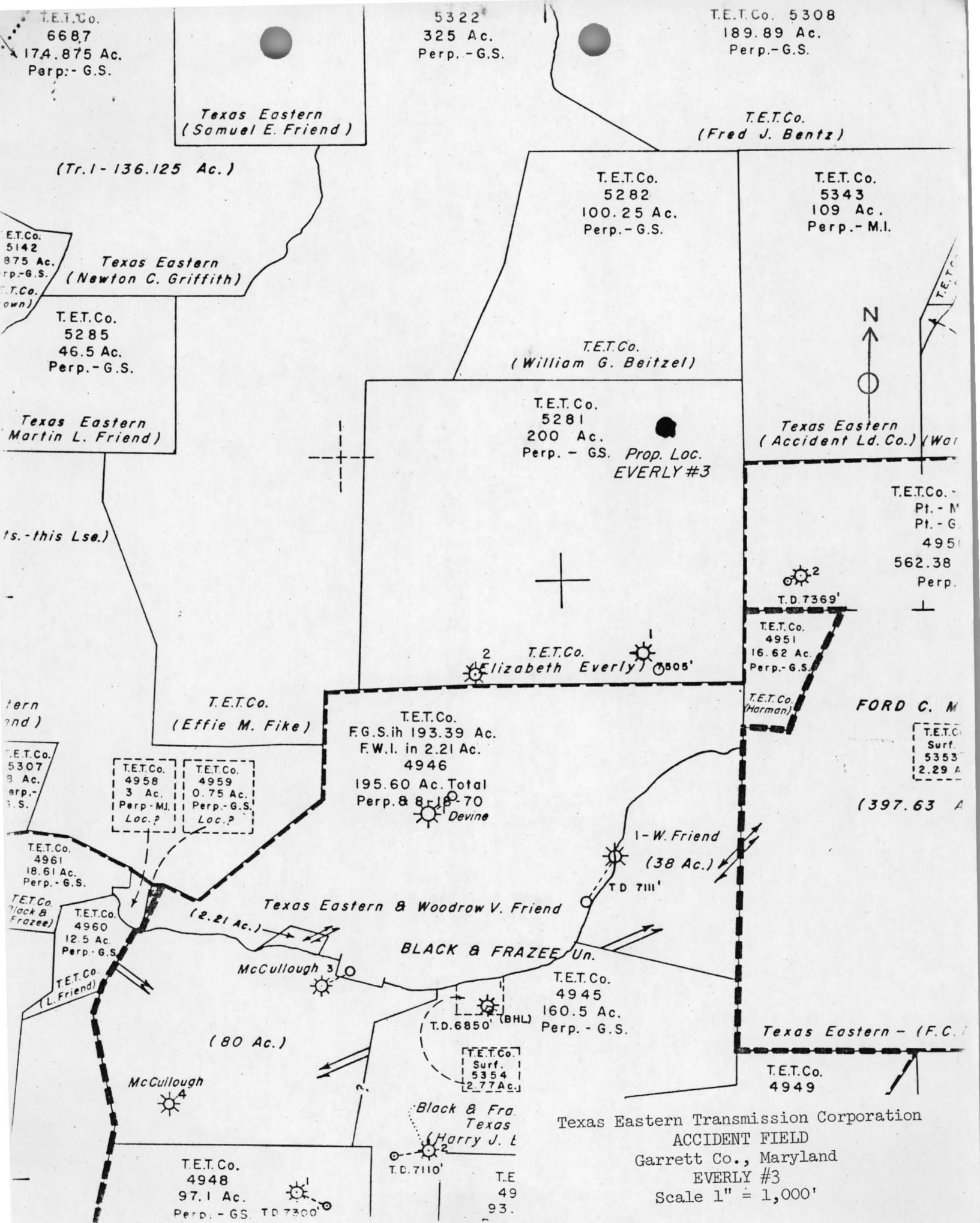

Texas Eastern
(Samuel E. Friend)

T.E.T.Co.
(Fred J. Bentz)

(Tr. 1-136.125 Ac.)

T.E.T.Co.
5282
100.25 Ac.
Perp.- G.S.

T.E.T.Co.
5343
109 Ac.
Perp.- M.I.

T.E.T.Co.
5142
875 Ac.
Perp.- G.S.

T.E.T.Co.
5285
46.5 Ac.
Perp.- G.S.

T.E.T.Co.
(William G. Beitzel)

Texas Eastern
Martin L. Friend)

T.E.T.Co.
5281
200 Ac.
Perp.- G.S. Prop. Loc.
EVERLY #3

Texas Eastern
(Accident Ld. Co.) (War

T.E.T.Co. -
Pt. - M
Pt. - G
4951
562.38
Perp.

T.E.T.Co.
4951
16.62 Ac.
Perp.- G.S.

T.E.T.Co.
(Effie M. Fike)

T.E.T.Co.
F.G.S. in 193.39 Ac.
F.W.I. in 2.21 Ac.
4946
195.60 Ac. Total
Perp. & 8-18-70
Devine

FORD C. M

T.E.T.Co.
Surf.
5353
2.29 A

(397.63 A

T.E.T.Co.
4958
3 Ac.
Perp.- M.J.
Loc. P

T.E.T.Co.
4959
0.75 Ac.
Perp.- G.S.
Loc. P

T.E.T.Co.
5307
9 Ac.
Perp.- G.S.

T.E.T.Co.
4961
18.61 Ac.
Perp.- G.S.

T.E.T.Co.
Black & Frazee

T.E.T.Co.
4960
12.5 Ac.
Perp.- G.S.

T.E.T.Co.
(L. Friend)

T.E.T.Co.
4945
160.5 Ac.
Perp.- G.S.

Texas Eastern - (F.C.)

T.E.T.Co.
4949

McCullough 4

T.E.T.Co.
Surf.
5354
2.77 Ac.

Black & Fra
Texas
Harry J. L

Texas Eastern Transmission Corporation
ACCIDENT FIELD
Garrett Co., Maryland
EVERLY #3
Scale 1" = 1,000'

T.E.
49
93.