

STATE OF MARYLAND
MARYLAND GEOLOGICAL SURVEY
 The Johns Hopkins University
 BALTIMORE, MARYLAND 21218

Permit Number 102
 Well Number 1
 Company Texas Eastern
 County Garrett

COMPLETION REPORT
 (oil or gas well)

This report must be submitted within 30 days after completion of the well

WELL DESCRIPTION - KIND OF WELL: Gas Storage
 (Oil, Gas, Other)

NAME & WELL NO. <u>E. Everly #2</u>	Size of Casting and Tubing	Used in Drilling	Left in Well	Packers: Type, Size and Depth
ELEVATION: <u>2273' GL</u> LEASE: _____	13 3/8"	293'	293'	-----
DRILLING COMMENCED: <u>4/27/75</u> DRILLING COMPLETED: <u>6/19/75</u>	9 5/8"	2996'	2996'	-----
PRODUCTION: <u>Storage Gas in Chert & Oriskany</u>	7 "	7189'	7189'	-----
RESERVOIR PRESSURE <u>2450</u> psig <u>3</u> hrs.				
WELL TREATMENT: (Shooting, Acidizing, Fracturing, Etc.) <u>OH Oriskany with 30,000 Gallons 15% HCL + FE Additives</u>				PERFORATIONS AT: <u>None</u>

CEMENTING DATA: (Size Pipe, Depth, No. Bags, Date)

13 3/8" 293' 250 sacks 5/3/75

9 5/8" 2996' 900 sacks 5/20/75

7" 7189' 360 sacks 6/6/75 1st Stage

1325 sacks 6/6/75 2nd Stage

RESERVOIR PRESSURE AFTER TREATMENT: _____

RESULTS AFTER TREATMENT: Estimated
30,000 MCF/D

REMARKS:

GEOPHYSICAL LOGS (Type of Geophysical Logs Run on Well)

Gamma-Ray Neutron
 Formation Density

MARYLAND GEOLOGICAL SURVEY

The Johns Hopkins University
BALTIMORE, MARYLAND 21218

GEOLOGICAL LOG

FORMATION	TOP	BOTTOM	GAS AT	OIL AT	WATER AT (Fresh or Salt Water)	REMARKS
					225', 401' 650'	Fresh Water
Tully LMS	6066					
Onondaga LMS	6931	6950				
Huntersville Chert	6950	7128	7065			84 MCF/D
Needmore Shale	7128	7178				
Oriskany Sandstone	7178	7282	7224			1858 MCF/D

This completion report is accurate to the best of my knowledge.

Date 12/8, 1975APPROVED W.J. VaughanBy Manager - Reserves & Dev.
(Title)COMPANY Texas Eastern Transmission

State of Maryland
MARYLAND GEOLOGICAL SURVEY
 The Johns Hopkins University
 Baltimore, Maryland 21218

McHenry Quad 102
Comp 6-19-75
TD 7282-3
Gas storage

APPLICATION FOR PERMIT TO DRILL OIL OR GAS WELL

(Applications must be submitted in triplicate)

ELIZABETH EVERLY WELL #2

OWNER TEXAS EASTERN TRANSMISSION CORPORATION
 STREET or R.F.D. P. O. BOX 2521
 POST OFFICE HOUSTON, TEXAS 77001

LOCATION OF WELL
 COUNTY GARRETT
 NEAREST POST OFFICE ACCIDENT MARYLAND
 Distance from Post Office 11,967.73'
 Direction from Post Office N 08° 31' 31" W of
NE Corner of Post Office

PERMIT TO DRILL WELL
 NOT TO BE FILLED IN BY APPLICANT

PERMIT NO. 102

APPROXIMATE DEPTH OF WELL (feet) 7415'
 METHOD OF DRILLING ROTARY

The permit is herewith granted subject to the conditions stipulated.

DEEPEST GEOLOGIC FORMATION
 WELL WILL BE DRILLED INTO DEFINITE HELDEBERG

Samuel D. Weaver
 Director

DISTANCE OF WELL LOCATION
 TO NEAREST BUILDING (feet) There are no
buildings within 1000' of well site.

Date 7-19-73

NUMBER OF SHIFTS PER DAY THREE

Special conditions that may apply:

LICENSED DRILLER IN CREW OF EACH SHIFT

<u>NAME</u>	<u>ADDRESS</u>
-------------	----------------

GAS STORAGE WELL ONLY. NAMES OF DRILLERS
MUST BE FURNISHED PRIOR TO DRILLING OF
WELL.

TO BE FURNISHED

<i>Clifford Holmes</i>	<i>Permit # 122</i>
<i>Wm. Kelly Jr.</i>	<i>" # 120</i>
<i>John J. Graham</i>	<i>" # 121</i>
<i>Melvin England</i>	<i>" # 123</i>

SEE ADDITIONAL REQUIREMENTS ATTACHED.

These names may be supplied later but before drilling begins

The names and post office addresses of the owners of the tracts of land included on the plat or map accompanying the application are to be given below.

See Attached List

NOTE

A BOND FOR \$2,500 PAYABLE TO THE STATE OF MARYLAND MUST ACCOMPANY THE APPLICATION
 THIS APPLICATION FORM MUST BE FILLED OUT WITH TYPEWRITER OR IN BLOCK LETTERS

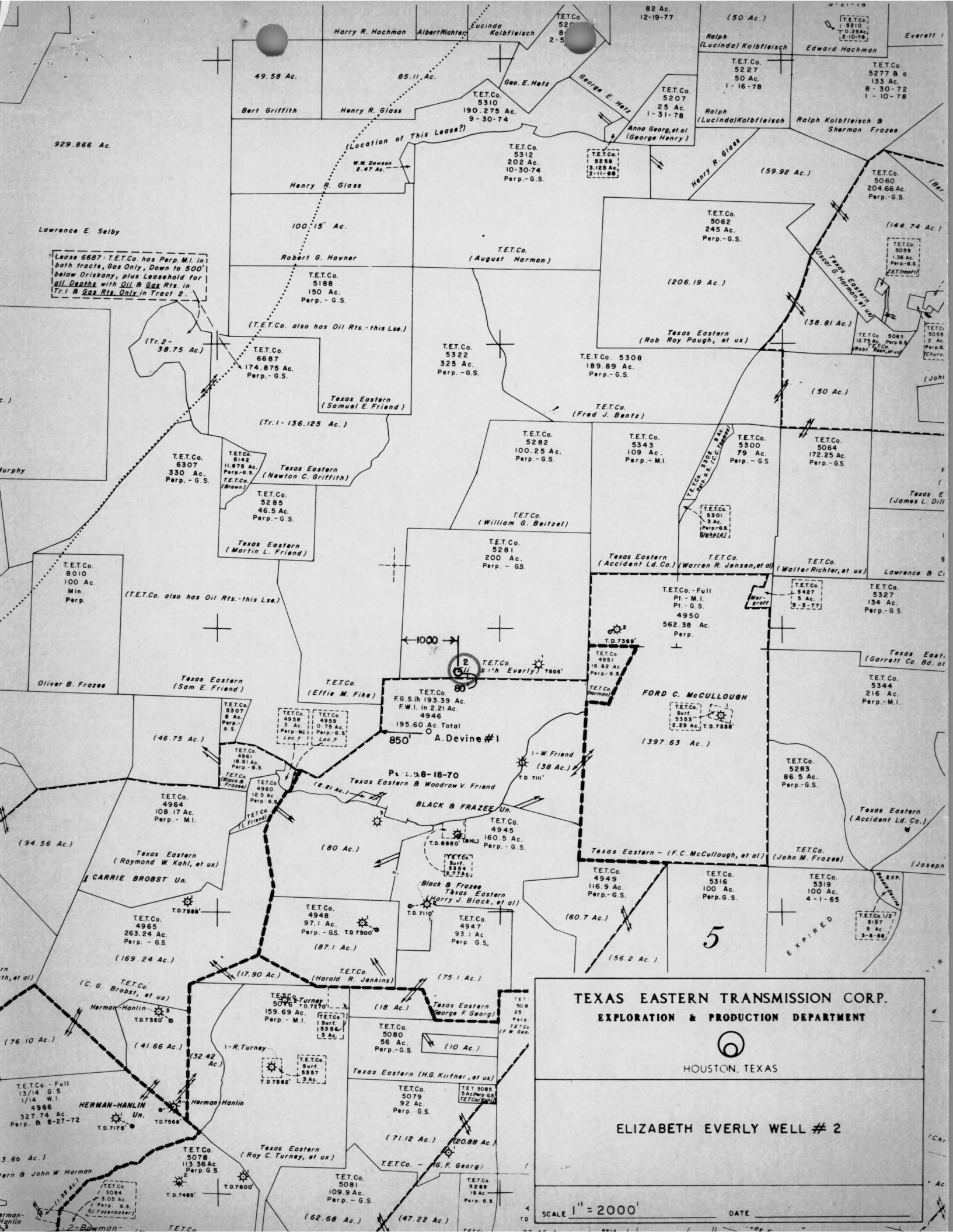

Lease 6607: TETCo. has Perp. M.I. in both tracts, Gas Only, Down to 500' below Oriskany, plus Leasehold for all Depths with Oil & Gas Rts. in Tr. 1 & Gas Rts. Only in Tract 2.

(TETCo. also has Oil Rts. - this Lse)

(TETCo. also has Oil Rts. - this Lse)

TEXAS EASTERN TRANSMISSION CORP.
EXPLORATION & PRODUCTION DEPARTMENT

HOUSTON, TEXAS

ELIZABETH EVERLY WELL # 2

SCALE 1" = 2000'

DATE

5

EXPIRED