

STATE OF MARYLAND  
**MARYLAND GEOLOGICAL SURVEY**  
 The Johns Hopkins University  
 BALTIMORE, MARYLAND 21218

Permit Number 93

Well Number 2

Texas Eastern Transmission Corporation  
 Company \_\_\_\_\_

**COMPLETION REPORT**

County Garrett

(oil or gas well)

*This report must be submitted within 30 days after completion of the well*

WELL DESCRIPTION - KIND OF WELL: Gas (Storage)  
 (Oil, Gas, Other)

NAME & WELL NO. <u>Charles E. Bowser, Well #2</u> <u>Charles E.</u>	Size of Casting and Tubing	Used in Drilling	Left in Well	Packers: Type, Size and Depth
ELEVATION: <u>2513' GR.</u> LEASE: <u>Bowser</u>	13 3/8"	100'	83'	None
DRILLING COMMENCED: <u>6/18/69</u> DRILLING COMPLETED: <u>8/9/69</u>	9 5/8"	3641'	3625'	None
PRODUCTION: <u>Gas - See Below</u>	7"	7499'	7484'	None 7" Stage Collar @ 6442'.
RESERVOIR PRESSURE <u>Not Measured</u> <u>psig</u> _____ hrs.				
WELL TREATMENT: (Shooting, Acidizing, Fracturing, Etc.)				
<u>See Attached Data</u>				PERFORATIONS AT: <u>Oriskany: Open Hole 7499-7631'</u> <u>Chert: 7344-7380'</u> <u>w/2 JSPF</u>

CEMENTING DATA: (Size Pipe, Depth, No. Bags, Date)

13 3/8", 100', 150 sx., 6-19-69

9 5/8", 3641', 924 sx., 7-11-69

7", 7499', 1st Stage 200 sx. around bottom

RESERVOIR PRESSURE AFTER TREATMENT: \_\_\_\_\_

casing. 2nd Stage 1130 sx. thru stage collar

Not Measured

@ 6442', 7-25-69.

RESULTS AFTER TREATMENT: \_\_\_\_\_

6,000 MCFGPD

REMARKS:

GEOPHYSICAL LOGS (Type of Geophysical Logs Run on Well)

Formation Density  
 Gamma Ray - Neutron

## MARYLAND GEOLOGICAL SURVEY

The Johns Hopkins University  
BALTIMORE, MARYLAND 21218

## GEOLOGICAL LOG

FORMATION	TOP	BOTTOM	GAS AT	OIL AT	WATER AT (Fresh or Salt Water)	REMARKS
Tully Lms.	6594'	6610'				No gas natural in Chert.
Onondaga Lms.	7314'	7330'				Encountered following gas while drilling Oriskany @
Huntersville Chert	7338'	7458'				7553' - 84 MCFGD
Needmore Shale	7458'	7493'				7583' - 103 MCFGD
Oriskany Ss.	7503'	7643'				7613' - 854 MCFGD
Helderberg Lms.	7643'					
Total Depth	7631'	Drillers Measurement				

This completion report is accurate to the best of my knowledge.

Date November 24, 19 69

APPROVED

By Walt Garner  
Production Manager

(Title)

COMPANY Texas Eastern Transmission Corp.

Completed  
Nov 19 69  
Gas Storage 93

State of Maryland  
**MARYLAND GEOLOGICAL SURVEY**  
 The Johns Hopkins University  
 Baltimore, Maryland 21218

**APPLICATION FOR PERMIT TO DRILL OIL OR GAS WELL**

(Applications must be submitted in triplicate)

Charles E. Bowser, Well No. 2

OWNER Texas Eastern Transmission Corporation

STREET or R.F.D. \_\_\_\_\_

POST OFFICE P. O. Box 2521  
Houston, Texas 77001

**PERMIT TO DRILL WELL**

NOT TO BE FILLED IN BY APPLICANT

PERMIT NO. Ninety-Three - 93

The permit is herewith granted subject to the conditions stipulated.

*Genneth D. Weaver*  
 Director

Date May 23, 1969

Special conditions that may apply:

"Gas Storage Well Only"

Names of Drillers must be furnished prior to drilling of well

LOCATION OF WELL

COUNTY Garrett

NEAREST POST OFFICE Accident, Maryland

Distance from Post Office 6,624.99 Feet

Direction from Post Office N 80° 41' 14" E

APPROXIMATE DEPTH OF WELL (feet) 7750'

METHOD OF DRILLING Rotary

DEEPEST GEOLOGIC FORMATION  
 WELL WILL BE DRILLED into Definite Helderberg

DISTANCE OF WELL LOCATION  
 TO NEAREST BUILDING (feet) 448.90 Feet

NUMBER OF SHIFTS PER DAY Three

LICENSED DRILLER IN CREW OF EACH SHIFT  
NAME ADDRESS

<u>To be furnished</u>	<u>O. Bergh # 67</u>
<u>6/10/69</u>	<u>F. Stafford # 68</u>
	<u>G. Braniff # 69</u>

These names may be supplied later but before drilling begins

The names and post office addresses of the owners of the tracts of land included on the plat or map accompanying the application are to be given below.

See Attached List

**NOTE**

A BOND FOR \$2,500 PAYABLE TO THE STATE OF MARYLAND MUST ACCOMPANY THE APPLICATION  
 THIS APPLICATION FORM MUST BE FILLED OUT WITH TYPEWRITER OR IN BLOCK LETTERS

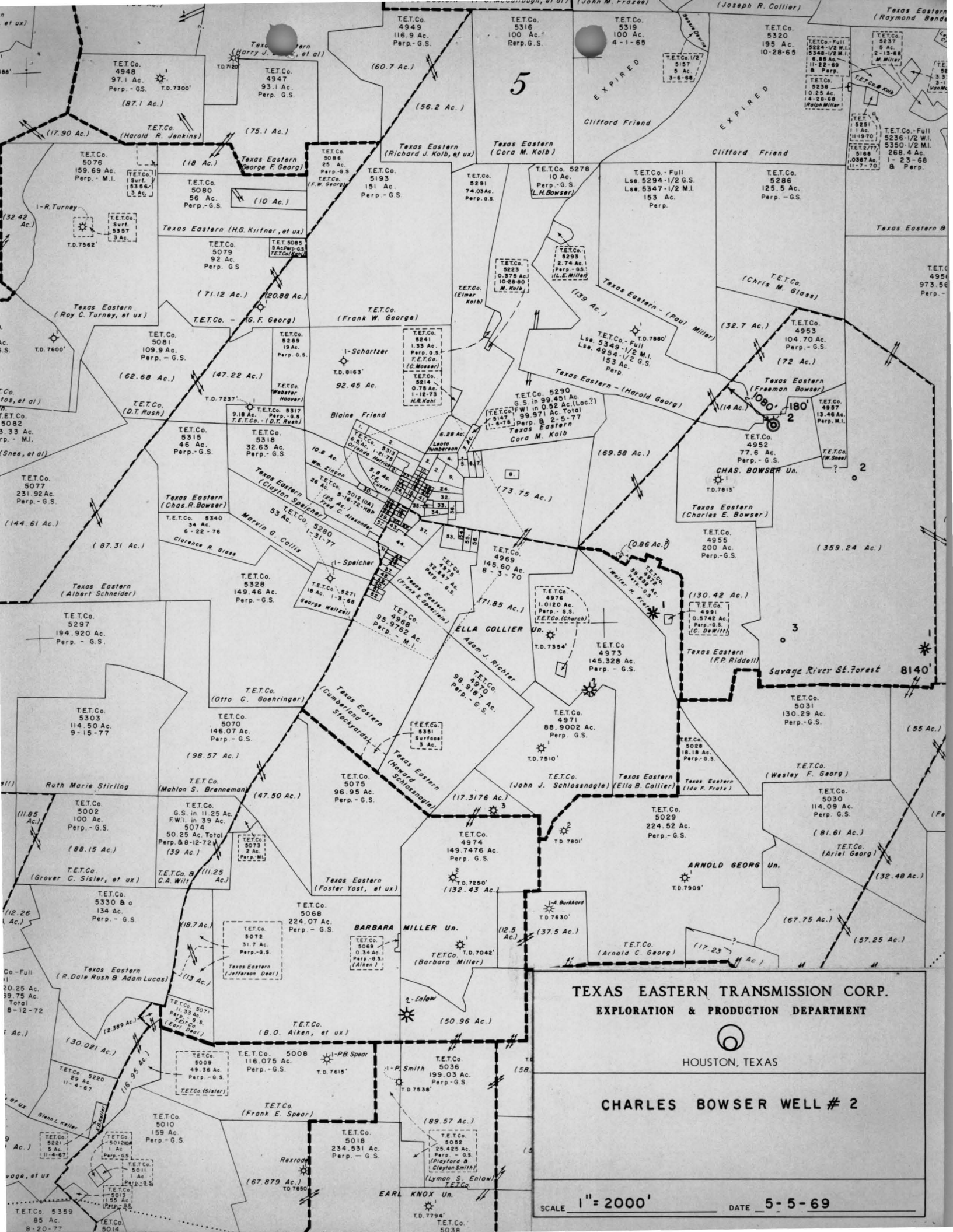

5

EXPIRED

EXPIRED

TEXAS EASTERN TRANSMISSION CORP.  
EXPLORATION & PRODUCTION DEPARTMENT

HOUSTON, TEXAS

CHARLES BOWSER WELL # 2

SCALE 1" = 2000' DATE 5-5-69