

STATE OF MARYLAND
MARYLAND GEOLOGICAL SURVEY
 The Johns Hopkins University
 BALTIMORE, MARYLAND 21218

Permit Number 72

Well Number 3

Texas Eastern Transmission Corporation
 Company _____

COMPLETION REPORT

County Garrett

(oil or gas well)

This report must be submitted within 30 days after completion of the well

WELL DESCRIPTION - KIND OF WELL: Gas Storage
 (Oil, Gas, Other)

NAME & WELL NO. <u>CHARLES A. REXRODE, WELL #3</u>	Size of Casting and Tubing	Used in Drilling	Left in Well	Packers: Type, Size and Depth
ELEVATION: <u>2,633'</u> G.L. LEASE: <u>Charles A. Rexrode</u>	13 3/8"	131'	131'	NONE
DRILLING COMMENCED: <u>6-27-66</u> DRILLING COMPLETED: <u>8-12-66</u>	9 5/8"	3,640'	3,640'	NONE
PRODUCTION: <u>Gas</u>	7"	7,548'	7,548'	NONE
<u>4,378 MCFD - Natural - Oriskany</u>	2 3/8"	7,638'	7,638'	NONE
RESERVOIR PRESSURE <u>1,925</u> psig <u>48</u> hrs.				
WELL TREATMENT: (Shooting, Acidizing, Fracturing, Etc.)				
<u>7,548'-7,669'</u> O. H. (Oris.) <u>2,000</u> gals. 10% Acid, with N ₂ .				PERFORATIONS AT:
<u>7,548'-7,669'</u> O. H. (Oris.) <u>7,500</u> gals. 10% Acid.				<u>7,440'-7,453'</u>
<u>7,548'-7,669'</u> O. H. (Oris.) <u>30,000</u> gals. H ₂ O, <u>27,000#</u> 20-40 Sand and <u>5,000#</u> 10-20 Sand.				Open Hole: <u>7,548'-7,669'</u>

Note: All casing cemented back to surface.

CEMENTING DATA: (Size Pipe, Depth, No. Bags, Date)

6-28-66
13 3/8" 48# H-40 set at 131', cement w/150 sx

Common Cement.

7-9-66
9 5/8" 36# J-55 set at 3,640', cement w/600 sx

Litepoz and 100 sx Common Cement.

7" 29# N-80 set at 7,548', cement w/315 sx Posmix
and 45 sx Latex Cement - First Stage.

Thru Stage Collar at 6,386' with 1,060 sx Posmix
and 50 sx Common Cement.

RESERVOIR PRESSURE AFTER TREATMENT: _____

2,105 psig - 48 HRS.

RESULTS AFTER TREATMENT: _____

5,270 MCFD at 210 psig.

REMARKS:

Gas Storage Well

GEOPHYSICAL LOGS (Type of Geophysical Logs Run on Well)
 Formation - Density Log
 Gamma Ray - Neutron Log
 Temperature Log
 Directional Log

GEOLOGICAL LOG

FORMATION	TOP	BOTTOM	GAS AT	OIL AT	WATER AT (Fresh or Salt Water)	REMARKS
Benson Sand	3,488	3,549	NONE	NONE	NONE	
Tully Lime	6,393	6,416	"	"	"	
1st Onondaga Lime	7,337	7,359	"	"	"	
1st Huntersville Chert	7,359	7,403	"	"	"	
2nd Onondaga Lime	7,403	7,420	"	"	"	
2nd Huntersville Chert	7,420	7,513	7,448	"	"	
Needmore Shale	7,513	7,544	NONE	"	"	
Oriskany Sand	7,544	7,666	7,648	"	"	
Helderberg Lime	7,666	7,669	NONE	"	"	T.D. 7,669' - Driller 7,665' - Logger <u>COMPLETION:</u> Chert: Perfs. 7,440'-7,453' Oriskany: O.H. 7,458'-7,669'

This completion report is accurate to the best of my knowledge.

Date September 28, 1966

APPROVED J. P. Sade

By Chief Production Clerk

(Title)

COMPANY Texas Eastern Transmission Corp.

72

Rider #9

~~CH...~~

State of Maryland
MARYLAND GEOLOGICAL SURVEY
 The Johns Hopkins University
 Baltimore, Maryland 21218

APPLICATION FOR PERMIT TO DRILL OIL OR GAS WELL

(Applications must be submitted in triplicate)

CHARLES A. REXRODE, WELL NO. 3

<p>OWNER <u>Texas Eastern Transmission Corporation</u></p> <p>STREET or R.F.D. <u>P. O. Box 2521</u></p> <p>POST OFFICE <u>Houston, Texas 77001</u></p> <p style="text-align: center;">PERMIT TO DRILL WELL</p> <p style="text-align: center;">NOT TO BE FILLED IN BY APPLICANT</p> <p>PERMIT NO. <u>72 - Seventy two</u></p> <p>The permit is herewith granted subject to the conditions stipulated.</p> <p style="text-align: center;"><i>Kenneth D. Weaver</i> Director</p> <p>Date <u>May 2, 1966</u></p> <p>Special conditions that may apply:</p> <p style="text-align: center;"><u>Gas Storage Well Only</u></p> <p style="text-align: center;"><u>Names of Drillers must be furnished prior to drilling of well</u></p>	<p>LOCATION OF WELL</p> <p>COUNTY <u>Garrett</u></p> <p>NEAREST POST OFFICE <u>Accident, Maryland</u></p> <p>Distance from Post Office <u>13,741'</u></p> <p>Direction from Post Office <u>S6°18'17" W</u></p> <p>APPROXIMATE DEPTH OF WELL (feet) <u>7500</u></p> <p>METHOD OF DRILLING <u>Rotary</u></p> <p>DEEPEST GEOLOGIC FORMATION WELL WILL BE DRILLED <u>Oriskany</u></p> <p>DISTANCE OF WELL LOCATION TO NEAREST BUILDING (feet) <u>1400' (to be furnished)</u></p> <p>NUMBER OF SHIFTS PER DAY <u>Three</u></p> <p>LICENSED DRILLER IN CREW OF EACH SHIFT</p> <table style="width: 100%; border-collapse: collapse;"> <thead> <tr> <th style="text-align: center; border-bottom: 1px solid black;">NAME</th> <th style="text-align: center; border-bottom: 1px solid black;">ADDRESS</th> </tr> </thead> <tbody> <tr> <td colspan="2" style="text-align: center;">To be furnished</td> </tr> <tr> <td><u>G. H. McClead #4841</u></td> <td><u>S. E. Hunter #4840</u></td> </tr> <tr> <td><u>C. W. Hames #4839</u></td> <td><u>D. S. Bryant #4838</u></td> </tr> </tbody> </table> <p>These names may be supplied later but before drilling begins</p>	NAME	ADDRESS	To be furnished		<u>G. H. McClead #4841</u>	<u>S. E. Hunter #4840</u>	<u>C. W. Hames #4839</u>	<u>D. S. Bryant #4838</u>
NAME	ADDRESS								
To be furnished									
<u>G. H. McClead #4841</u>	<u>S. E. Hunter #4840</u>								
<u>C. W. Hames #4839</u>	<u>D. S. Bryant #4838</u>								

The names and post office addresses of the owners of the tracts of land included on the plat or map accompanying the application are to be given below.

See attached list

NOTE

A BOND FOR \$2,500 PAYABLE TO THE STATE OF MARYLAND MUST ACCOMPANY THE APPLICATION THIS APPLICATION FORM MUST BE FILLED OUT WITH TYPEWRITER OR IN BLOCK LETTERS

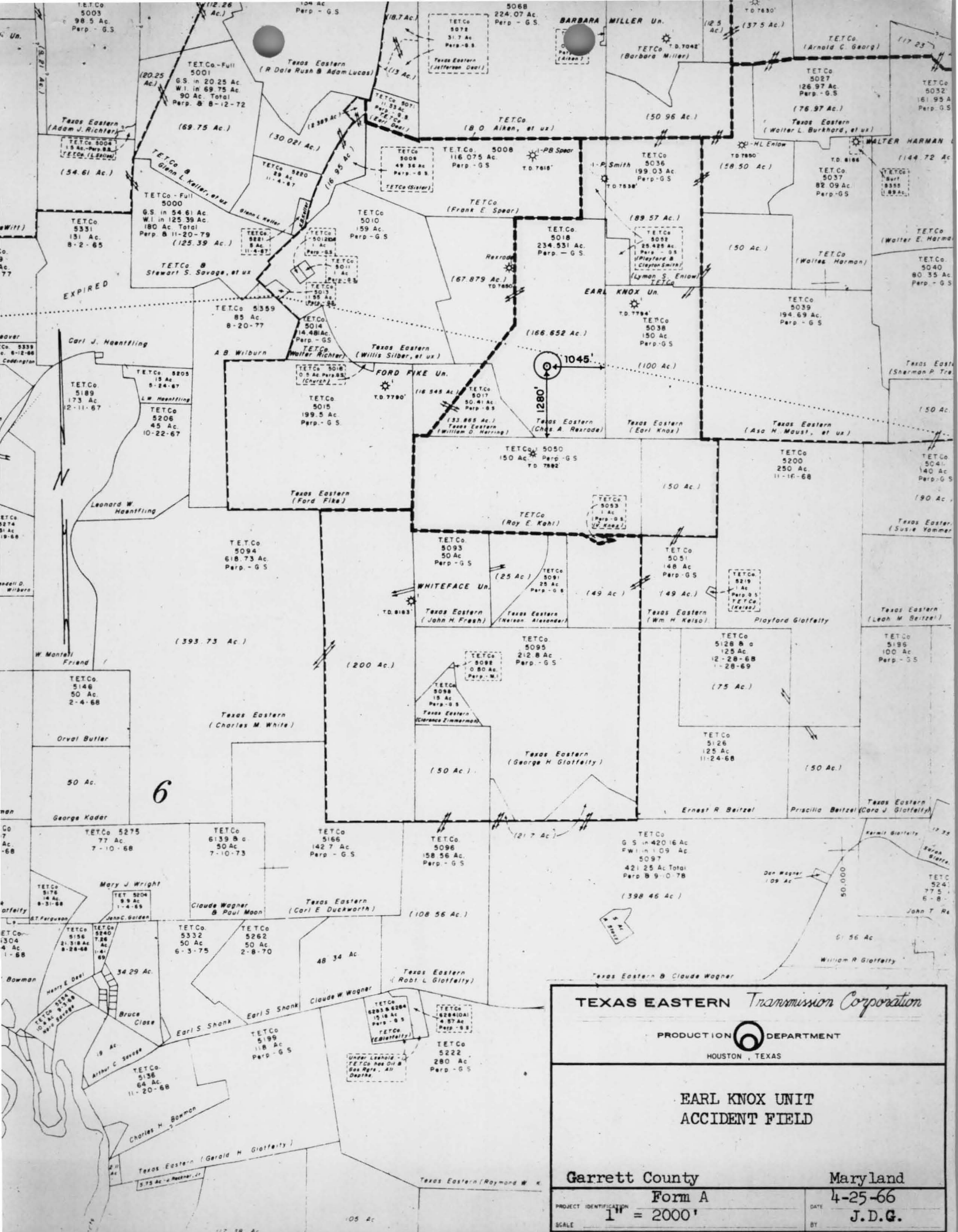

TEXAS EASTERN *Transmission Corporation*

PRODUCTION DEPARTMENT

HOUSTON, TEXAS

**EARL KNOX UNIT
ACCIDENT FIELD**

Garrett County	Maryland
Form A	4-25-66
PROJECT IDENTIFICATION 1" = 2000'	DATE J.D.G.
SCALE	BT