

STATE OF MARYLAND  
**MARYLAND GEOLOGICAL SURVEY**  
 The Johns Hopkins University  
 BALTIMORE, MARYLAND 21218

Permit Number 62Well Number 2  
Texas Eastern Transmission Corporation  
Company \_\_\_\_\_**COMPLETION REPORT**County Garrett

(oil or gas well)

*This report must be submitted within 30 days after completion of the well*WELL DESCRIPTION - KIND OF WELL: Gas

(Oil, Gas, Other)

| NAME & WELL NO.   | Size of Casting and Tubing | Used in Drilling | Left in Well                                     | Packers: Type, Size and Depth                           |
|---|----------------------------|------------------|--|---|
| Mark Lokotos, Well No. 2  |                            |                  |  |   |
| ELEVATION: <u>2398</u> LEASE: <u>Mark Lokotos</u>   | <u>13 3/8"</u>             | <u>132</u>       | <u>132</u>                                       | <u>NONE</u>   |
| DRILLING COMMENCED: <u>3/30/66</u> DRILLING COMPLETED: <u>5/20/66</u>                               | <u>9 5/8"</u>              | <u>2477</u>      | <u>2477</u>                                      |   |
| PRODUCTION: <u>Gas</u>  | <u>7"</u>                  | <u>7332</u>      | <u>7332</u>                                      |   |
|   | <u>2 3/8"</u>              |                  | <u>7419</u>                                      |   |
| RESERVOIR PRESSURE <u>1331</u> psig <u>12</u> hrs.  |                            |                  |  |   |
| WELL TREATMENT: (Shooting, Acidizing, Fracturing, Etc.)<br><u>Oriskany Open Hole - 7332 - 7485'</u> |                            |                  |  | PERFORATIONS AT:  |
| <u>Acidized with 1000 gals. 10% MCA. Fractured</u>  |                            |                  |  | <u>7235-41</u>  |
| <u>with 31,800 gals. gelled water w/32,500# sand.</u>   |                            |                  |  | <u>Open Hole</u>  |
| <u>Chert perforations - 7235 - 41'</u>  |                            |                  |  | <u>7332-7485</u>  |
| Acidized with 2000 gals. 10% MCA. Fractured   |                            |                  |  | CEMENTING DATA: (Size Pipe, Depth, No. Bags, Date)      |
| <u>with 29,000 gals. gelled water with 30,000# sand.</u>  | <u>13 3/8"</u>             | <u>132'</u>      | <u>125 sacks</u>                                 | <u>3-31-66.</u>   |
|   | <u>9 5/8"</u>              | <u>2477'</u>     | <u>500 sacks</u>                                 | <u>4-11-66.</u>   |
|   | <u>7"</u>                  | <u>7332'</u>     | <u>1st Stage 555 sacks</u>                       | <u>around bottom.</u>                                   |
| RESERVOIR PRESSURE AFTER TREATMENT:   |                            |                  | <u>2nd Stage 1550 sacks thru DV Tool @ 6423'</u> |   |
| <u>Not measured.</u>  |                            |                  | <u>4-30-66.</u>                                  |   |
| RESULTS AFTER TREATMENT: <u>Oriskany</u>  |                            |                  |  |   |
| <u>4650 MCF/Day. Chert 951 MCF/Day. Both zones</u>  |                            |                  |  |   |
| <u>5996 MCF/Day</u>   |                            |                  |  |   |
| REMARKS:  |                            |                  |  | GEOPHYSICAL LOGS (Type of Geophysical Logs Run on Well) |
|   |                            |                  |  | Formation Density                                       |
|   |                            |                  |  | Gamma Ray - Neutron                                     |

MARYLAND GEOLOGICAL SURVEY

The Johns Hopkins University  
BALTIMORE, MARYLAND 21218

MARK LOKOTOS, WELL NO. 2

GEOLOGICAL LOG

| FORMATION          | TOP  | BOTTOM | GAS AT             | OIL AT | WATER AT<br>(Fresh or<br>Salt Water) | REMARKS                          |
|--------------------|------|--------|--------------------|--------|--------------------------------------|----------------------------------|
| Tully              | 6294 | 6320   | <u>SEE REMARKS</u> |        |                                      | Drilling in Tests:               |
| Onondaga           | 7178 | 7200   |                    |        |                                      | <u>Huntersville Chert</u>        |
| Huntersville Chert | 7203 | 7306   |                    |        |                                      | Depth            Rate<br>MCF/Day |
| Needmore Shale     | 7306 | 7333   |                    |        |                                      | 7216                62           |
| 1st Oriskany       | 7338 | 7365   |                    |        |                                      | 7249                224          |
| 30' Fault          | 7365 |        |                    |        |                                      | 7277                240          |
| 2nd Oriskany       | 7369 |        |                    |        |                                      | 7332                400          |
|                    |      |        |                    |        |                                      | <u>Oriskany</u> (Csg. at 7332')  |
|                    |      |        |                    |        | Depth            Rate<br>MCF/Day     |                                  |
|                    |      |        |                    |        | 7338                2920             |                                  |
|                    |      |        |                    |        | 7358                2780             |                                  |

This completion report is accurate to the best of my knowledge.

Date July 25, 1966

APPROVED J. D. Lade

By Chief Production Clerk  
(Title)

COMPANY Texas Eastern Transmission Corp.

State of Maryland  
MARYLAND GEOLOGICAL SURVEY  
The Johns Hopkins University  
Baltimore, Maryland 21218

Blanket Bond  
11/28 1582

APPLICATION FOR PERMIT TO DRILL OIL OR GAS WELL

(Applications must be submitted in triplicate)

MARK LOKOTOS, WELL NO. 2

OWNER Texas Eastern Transmission Corporation

LOCATION OF WELL

STREET or R.F.D. P. O. Box 2521

COUNTY Garrett

POST OFFICE Houston, Texas 77001

NEAREST POST OFFICE Accident, Maryland

Distance from Post Office 3,958'

Direction from Post Office N 43° 48' 20" W

PERMIT TO DRILL WELL

NOT TO BE FILLED IN BY APPLICANT

PERMIT NO. 62 (Sixty-two)

APPROXIMATE DEPTH OF WELL (feet) 7350'

METHOD OF DRILLING Rotary

The permit is herewith granted subject to the conditions stipulated.

DEEPEST GEOLOGIC FORMATION  
WELL WILL BE DRILLED Oriskany

*Kenneth D. Weaver*  
Director

DISTANCE OF WELL LOCATION  
TO NEAREST BUILDING (feet)

No buildings within 1500'

Date February 28, 1966

NUMBER OF SHIFTS PER DAY Three

Special conditions that may apply:

"Gas Storage Well Only"

LICENSED DRILLER IN CREW OF EACH SHIFT  
NAME ADDRESS

Names of Drillers must be furnished  
prior to drilling of well

To be furnished 4/4/66

These names may be supplied later but before drilling begins

The names and post office addresses of the owners of the tracts of land included on the plat or map accompanying the application are to be given below.

See attached list

**NOTE**

A BOND FOR \$2,500 PAYABLE TO THE STATE OF MARYLAND MUST ACCOMPANY THE APPLICATION  
THIS APPLICATION FORM MUST BE FILLED OUT WITH TYPEWRITER OR IN BLOCK LETTERS

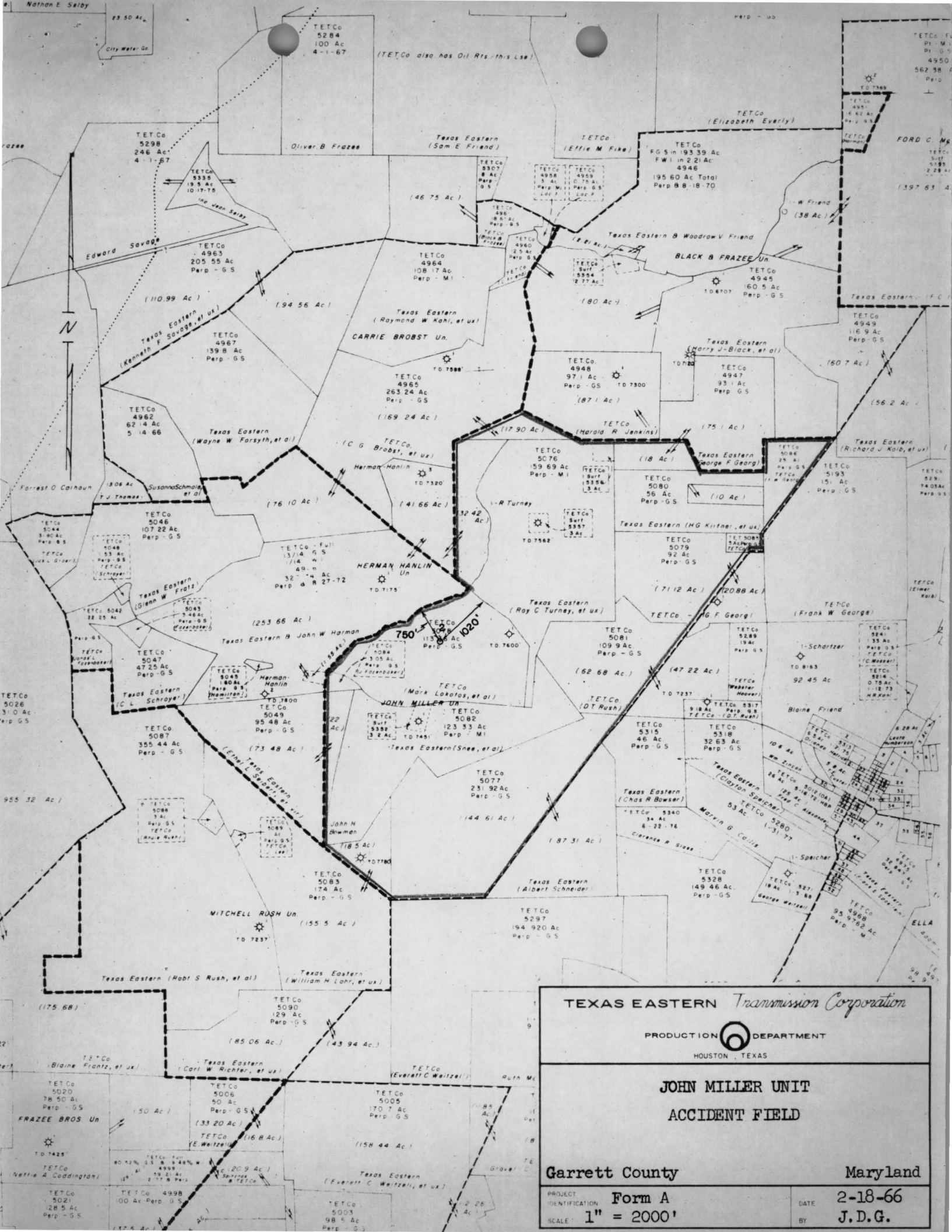

TEXAS EASTERN *Transmission Corporation*  
 PRODUCTION DEPARTMENT  
 HOUSTON, TEXAS

**JOHN MILLER UNIT  
 ACCIDENT FIELD**

Garrett County Maryland  
 PROJECT IDENTIFICATION Form A DATE 2-18-66  
 SCALE: 1" = 2000' BY J.D.G.