

STATE OF MARYLAND
MARYLAND GEOLOGICAL SURVEY
 The Johns Hopkins University
 BALTIMORE, MARYLAND 21218

Permit Number 58
 Well Number 1
 Texas Eastern Transmis-
 sion Corporation
 County Garrett

COMPLETION REPORT

(oil or gas well)

This report must be submitted within 30 days after completion of the well

WELL DESCRIPTION - KIND OF WELL: Gas Storage

(Oil, Gas, Other)

Texas Eastern Transmission Corporation's NAME & WELL NO. WALTER H. FRATZ, NO. 1	Size of Casing and Tubing	Used in Drilling	Left in Well	Packers: Type, Size and Depth
ELEVATION: <u>2483.6'</u> LEASE: <u>W. H. FRATZ</u>	13 3/8" OD	134'	134'	NONE
DRILLING COMMENCED: <u>Nov. 22, 1965</u> DRILLING COMPLETED: <u>January 26, 1966</u>	9 5/8" OD	3488'	3488'	"
PRODUCTION: <u>Gas</u>	7" OD	7160'	7160'	"
	2 3/8" OD		7172'	"
RESERVOIR PRESSURE <u>1425</u> psig <u>24</u> hrs.				
WELL TREATMENT: (Shooting, Acidizing, Fracturing, Etc.)				
NONE				PERFORATIONS AT: NONE
DATE	CEMENTING DATA: (Size Pipe, Depth, No. Bags, Date)			
11-23-65	13 3/8" OD 48# H-40 set at 134'; cement 150 sx. Common.			
12-3-65	9 5/8" OD 36# J-55 set at 3488' w/576 sx. Diacel & 200 sx. Common.			
1-21-66	7" OD 29# N-80 set 7160' cemented in two stages:			
RESERVOIR PRESSURE AFTER TREATMENT:	First Stage - 60 sx. 50-50 Pos A 2% GEL and 100 sx. Common. (After open D. V. Tool circulated Cement Surf)			
	Second Stage - Thru D. V. Tool AT 6307 w/1250 sx. 50-50 Pos A 2% GEL circulated cement to surface			
RESULTS AFTER TREATMENT:				
REMARKS:	GEOPHYSICAL LOGS (Type of Geophysical Logs Run on Well)			
Gas Storage Well	Formation Density Gamma Rag - Neutron			

MARYLAND GEOLOGICAL SURVEY

The Johns Hopkins University
BALTIMORE, MARYLAND 21218

GEOLOGICAL LOG

FORMATION	TOP	BOTTOM	GAS AT	OIL AT	WATER AT (Fresh or Salt Water)	REMARKS
Benson Sand	3313	3380'				
Tully Lime	6313	6325'				
Onondaga Lime	6997	7022'				
Huntersville Chert	7022	7113'				
Needmore Shale	7113	7151'				
Oriskany Sand	7151	7297'	7151'			
Helderberg Lime	7297	-				T. D. 7310' Driller T. D. 7301' Logger Well Completed Open Hole in Oriskany

This completion report is accurate to the best of my knowledge.

Date March 1, 19 66

APPROVED J. D. Luder

By Chief Production Clerk
(Title)

COMPANY Texas Eastern Transmission Corp.

State of Maryland
MARYLAND GEOLOGICAL SURVEY
The Johns Hopkins University
Baltimore, Maryland 21218

Blanket Bond
10/14/70

APPLICATION FOR PERMIT TO DRILL OIL OR GAS WELL
(Applications must be submitted in triplicate)

WALTER H. FRATZ, WELL NO. 1

OWNER <u>Texas Eastern Transmission Corporation</u>	LOCATION OF WELL
STREET or R.F.D. <u>P. O. Box 2521</u>	COUNTY <u>Garrett</u>
POST OFFICE <u>Houston, Texas 77001</u>	NEAREST POST OFFICE <u>Accident, Maryland</u>
	Distance from Post Office <u>4830'</u>
	Direction from Post Office _____
	<u>S 62° 15' 00"</u>
PERMIT TO DRILL WELL	
NOT TO BE FILLED IN BY APPLICANT	APPROXIMATE DEPTH OF WELL (feet) <u>7800'</u>
PERMIT NO. <u>58 (Fifty-eight)</u>	METHOD OF DRILLING <u>Rotary</u>
The permit is herewith granted subject to the conditions stipulated.	DEEPEST GEOLOGIC FORMATION WELL WILL BE DRILLED <u>Oriskany</u>
<u>Donnell M. Wear</u> Director	DISTANCE OF WELL LOCATION TO NEAREST BUILDING (feet) <u>355</u>
Date <u>November 10, 1965</u>	NUMBER OF SHIFTS PER DAY <u>3</u>
Special conditions that may apply: "Gas storage well only"	LICENSED DRILLER IN CREW OF EACH SHIFT
	NAME ADDRESS
Names of Drillers must be furnished prior to drilling.	<u>To be furnished</u> <u>Furnished</u>
	These names may be supplied later but before drilling begins

The names and post office addresses of the owners of the tracts of land included on the plat or map accompanying the application are to be given below.

See attached list

NOTE

A BOND FOR \$2,500 PAYABLE TO THE STATE OF MARYLAND MUST ACCOMPANY THE APPLICATION THIS APPLICATION FORM MUST BE FILLED OUT WITH TYPEWRITER OR IN BLOCK LETTERS

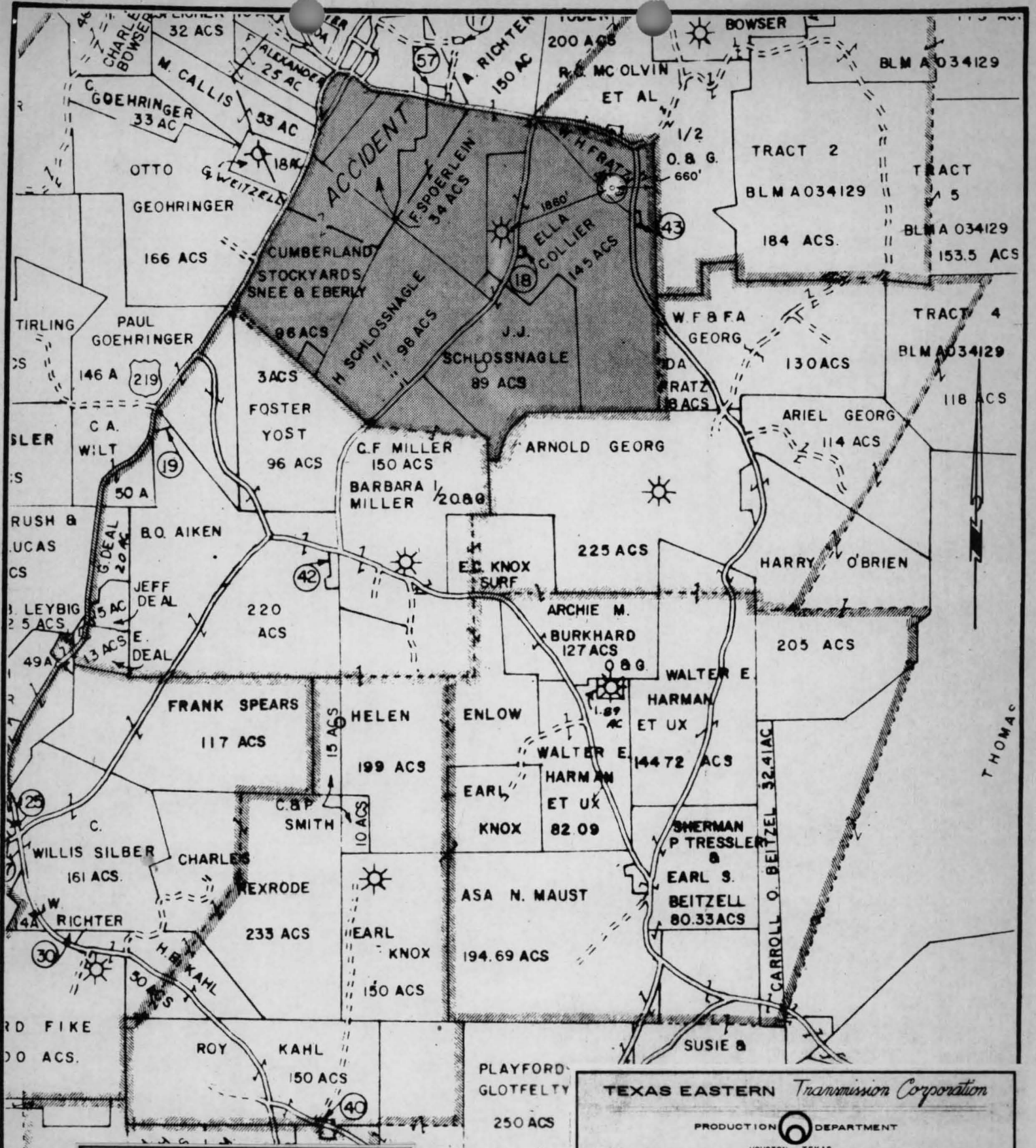

I do hereby certify that all information included on this plat is true and correct.

J.D. Guder

MRS
LEWIS
BEITZEL
75 ACS

TEXAS EASTERN *Transmission Corporation*
PRODUCTION DEPARTMENT
HOUSTON, TEXAS

ELLA B. COLLIER UNIT
Accident Field

Garrett County Maryland
PROJECT IDENTIFICATION Form A
SCALE 1" = 2000'
DATE 10-28-65
BY J.D.G.