

STATE OF MARYLAND
MARYLAND GEOLOGICAL SURVEY
The Johns Hopkins University
BALTIMORE, MARYLAND 21218

Permit Number 40
Well Number 1
Company Texas Eastern Transmission Corporation
County Garrett

REVISED REPORT

COMPLETION REPORT
(oil or gas well)

This report must be submitted within 30 days after completion of the well

WELL DESCRIPTION - KIND OF WELL: Gas Storage Well
(Oil, Gas, Other)

NAME & WELL NO.	Size of Casting and Tubing	Used in Drilling	Left in Well	Packers: Type, Size and Depth
Mark Lokotos #1 2440' G.L.				
ELEVATION: 2455' K.B. Zero LEASE Mark Lokotos Revised Report October 28, 1968				
DRILLING COMMENCED: 5-19-64 DRILLING COMPLETED: 7-19-64		Report filed July 19, 1964, with exception		
PRODUCTION: Gas Storage Well, Flow too small to measure		of 4-1/2" Liner shown below.		
RESERVOIR PRESSURE <u>N.A.</u> psig - - hrs.				
WELL TREATMENT: (Shooting, Acidizing, Fracturing, Etc.) SEE BACK OF REPORT				
				PERFORATIONS AT: 7266-76; 7375-80; 7033-47; 7054-69; 7074-86; 7110-22 and 7128-38.
				CEMENTING DATA: (Size Pipe, Depth, No. Bags, Date) 4-1/2" N-80 13.5# Liner set on Pkr. top of Liner 6778.98' Btm. of Liner 7,596.00' to 7605. Cemented with 40 sx. common and 70 sx. Latex.
RESERVOIR PRESSURE AFTER TREATMENT: Not available				Tubing, 1.66" tubing @ 7394'
RESULTS AFTER TREATMENT: Flow too small to measure.				
REMARKS: Well records same as filed on Form 5 dated July 19, 1964, with the excepting of the Liner and Acid Treatment as shown in this report.				GEOPHYSICAL LOGS (Type of Geophysical Logs Run on Well) NONE

STATE OF KENTUCKY
DEPARTMENT OF GEOLOGICAL SURVEY
BATHS AND THERMAL SPRINGS
COMPLETION REPORT

REVISIONS

1. Perforated Oriskany 7266-7276' and 7375-80' with 4 shots per foot and treated with 2000 gallons 10% MCA. Started treatment at 1/2 BPM psi., increased rate to 4 BPM pressure dropped to 3700 psi. Cleaned well - not gauged. Retreated with 5000 gallons retarded 10% MCA, 5000 gallons retarded 5% MCA and 30,000 gallons 5% jel acid with 50,000# sand. Rate 46.2 BPM @ 3250 psi. Cleaned well - flowing but not tested. Retarded with 5000 gallons 10% MCA @ 6 BPM @ 3200 psi. Cleaned hole - no test.
2. Set CI BP @ 7230' Perforate Chert 7033-47', 7054-69', 7074-86', 7110-22' and 7128-38' with two shots per foot. Treated Chert with 5000 gallons 15% retarded, 10,000 gallons 10% retarded and 30,000 gallons 10% jel acid with 44,000# sand. Injected 47.5 BPM @ 3856 psi. Cleaned well - no test.

MARYLAND GEOLOGICAL SURVEY

The Johns Hopkins University
BALTIMORE, MARYLAND 21218

GEOLOGICAL LOG

FORMATION	TOP	BOTTOM	GAS AT	OIL AT	WATER AT (Fresh or Salt Water)	REMARKS
ALL GEOLOGICAL LOGS HAVE BEEN PREVIOUSLY FILED.						

This completion report is accurate to the best of my knowledge.

Date October 28, 19 68

APPROVED

Jack E. Whiting
By Jack E. Whiting
Petroleum Engineer
(Title)

COMPANY TEXAS EASTERN TRANS. CORP.

STATE OF MARYLAND
DEPARTMENT OF GEOLOGY, MINES AND WATER RESOURCES

The Johns Hopkins University
BALTIMORE 18, MARYLAND

WELL COMPLETION REPORT

Mark Lokotos, Well No. 1

This report must be submitted within 30 days after completion of the well

Elevation: 2,440' G.L. **WELL DESCRIPTION**
2,455' K.B. (Zero) Permit Number... 40

WELL LOG

State the kind of formations penetrated, their depth, their thickness, and if water-bearing

CASING AND SCREEN RECORD

State the kind and size of casing, liner, shoe, screen, and other accessories (if no casing used, give diameter of well)

Name of Owner Texas Eastern Transmission Corporation

WELL LOG		CASING AND SCREEN RECORD		PUMPING TEST	
State the kind of formations penetrated, their depth, their thickness, and if water-bearing		State the kind and size of casing, liner, shoe, screen, and other accessories (if no casing used, give diameter of well)		Name of Owner Texas Eastern Transmission Corporation	
TOTAL DEPTH: 7,605'		DIAM. (Inches)	FEET	Hours Pumped	
FEET from.....to.....	FEET from.....to.....	FEET from.....to.....	FEET from.....to.....	Type of Pump Used	
		Conductor: 13 3/8	0-100'	Pumping Rate Gallons per Minute	
		Cemented to surface w/100 sx Common Cement w/3% Cacl. Good Returns	0-1,024'	WATER LEVEL	
		Surface: 9 5/8"	0-1,024'	Distance from land surface to water:	
		Cemented to surface w/500 sx litepoz and 100 sx Common Cement. Cemented around top with 50 sx litepoz and 103 sx Common Cement Good Returns Baker Float Collar at 990' Baker Guide Shoe at 1,024! 8 Baker Centralizers		Before Pumping.....Ft.	
Geological Information:				When Pumping.....Ft.	
Top - Tully 6,280'				APPEARANCE OF WATER	
Top - Onondaga Limestone 6,997'				Clear 157' 2060'	
Top - Huntersville Chert 7,030'				Cloudy	
Top - Needmore Shale 7,203'				Taste Fresh Salty	
Top - Oriskany Sandstone 7,263'				Odor None None	
Top - Helderberg Limestone 7,407'				Height of Casing Above Land Surface0.....Ft.	
25' Normal Fault 6,995'				PUMP INSTALLED	
Drilling Information:				Type None	
Rotary - Air 17 1/2" Hole 0-107'				Capacity	
Rotary - Air 12 1/4" Hole 107'-157'				Gallons per Minute.....	
Rotary - Foam 12 1/4" Hole 157'-1030'				Gallons per Hour.....	
Rotary - Air 8 3/4" Hole 1030'-2060'				Pump Column Length.....Ft.	
Rotary - Foam 8 3/4" Hole 2060'-4163'				REMARKS	
Rotary - Mud 8 3/4" Hole 4163'-7039'				Well Temporarily Abandoned.	
Rotary - Gas 6 1/8" Hole 7039'-7605'				Open Hole Completion 7,029 - 7,605'	
				Well flowing less than 12 MCFD Gas.	
				Well Was Completed	
				Date	
				Well Driller.....	
				Signature	

STATE OF MARYLAND
DEPARTMENT OF GEOLOGY, MINES AND WATER RESOURCES

The Johns Hopkins University
BALTIMORE 18, MARYLAND

WELL COMPLETION REPORT

Mark Lokotos, Well No. 1

This report must be submitted within 30 days after completion of the well

WELL DESCRIPTION

WELL LOG

State the kind of formations penetrated, their depth, their thickness, and if water-bearing

CASING AND SCREEN RECORD

State the kind and size of casing, liner, shoe, screen, and other accessories (if no casing used, give diameter of well)

Permit Number 40

Name of Owner Texas Eastern Transmission Corporation

F E E T

from.....to.....

D I A M.

(inches)

F E E T

from.....to.....

PUMPING TEST

Hours Pumped

Type of Pump Used.....

Pumping Rate
Gallons per Minute.....

WATER LEVEL

Distance from land surface to water:

Before Pumping.....Ft.

When Pumping.....Ft.

APPEARANCE OF WATER

Clear

Cloudy

Taste

Odor

Height of Casing Above Land SurfaceFt.

PUMP INSTALLED

Type

Capacity

Gallons per Minute.....

Gallons per Hour.....

Pump Column Length.....Ft.

REMARKS

Well Temporarily

Abandoned.....

Temp. Abdn.

Well Was Completed

Date July 19, 1964

Well Driller

J. D. Gaden
Signature

Well Temporarily Abandoned with following surface Wellhead Equipment:

- 1-McEvoy Type "S" Casing Head, Lower Female 9 5/8" x Upper 10" API 3000, w/ 2-2" API LPSO, each Bull Plugged.
- 1 - McEvoy Type "A-2" Tubing Head, 10" API 3000 x 6" API 3000, w/2 - 2" API 5000 SSO, each plugged and capped off.
- 1 - McEvoy Type SAD Tubing Head Adapter, 6" API 3000 x 2" API 5000.
- 1 - McEvoy Fig. 125 Gate Valve, 3000 psi, Serial No. 24337.

State of Maryland
DEPARTMENT OF GEOLOGY, MINES AND WATER RESOURCES
The Johns Hopkins University
Baltimore 18, Maryland

APPLICATION FOR PERMIT TO DRILL OIL OR GAS WELL
(Applications must be submitted in triplicate)

Mark Lokotos, Well No. 1

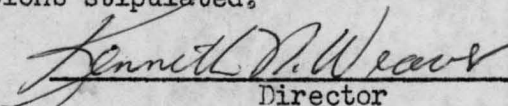
OWNER <u>Texas Eastern Transmission Corp.</u> STREET or R.F.D. <u>P. O. Box 2521</u> POST OFFICE <u>Houston, Texas 77001</u>	LOCATION OF WELL COUNTY <u>Garrett</u> NEAREST POST OFFICE <u>Accident, Maryland</u> Distance from Post Office <u>6,784 feet</u> Direction from Post Office <u>N 64°</u> <u>26 min. 15 sec. W</u>								
PERMIT TO DRILL WELL NOT TO BE FILLED IN BY APPLICANT	APPROXIMATE DEPTH OF WELL (feet) <u>7,800</u> METHOD OF DRILLING <u>Rotary (Air)</u>								
PERMIT NO. <u>40 (Forty)</u> The permit is herewith granted subject to the conditions stipulated. <div style="text-align: center;">  Director </div>	DEEPEST GEOLOGIC FORMATION WELL WILL BE DRILLED <u>Oriskany</u> DISTANCE OF WELL LOCATION TO NEAREST BUILDING (feet) <u>1,500'</u>								
Date <u>May 20, 1964</u> Special conditions that may apply: <div style="font-family: cursive;"> Production well Gas Storage well 10/28/68 absent well </div>	NUMBER OF SHIFTS PER DAY <u>3</u> LICENSED DRILLER IN CREW OF EACH SHIFT <table style="width: 100%; border-collapse: collapse;"> <thead> <tr> <th style="text-align: center; border-bottom: 1px solid black;">NAME</th> <th style="text-align: center; border-bottom: 1px solid black;">ADDRESS</th> </tr> </thead> <tbody> <tr> <td style="border-bottom: 1px solid black;">Robt. J. Muncy</td> <td style="border-bottom: 1px solid black;">Box 283 Gilbert, West Virginia 301 First Ave.</td> </tr> <tr> <td style="border-bottom: 1px solid black;">Robt. L. Morgan</td> <td style="border-bottom: 1px solid black;">Ripley, West Virginia P. O. Box 261</td> </tr> <tr> <td style="border-bottom: 1px solid black;">C. E. Mayberry</td> <td style="border-bottom: 1px solid black;">Kingwood, West Virginia</td> </tr> </tbody> </table> These names may be supplied later but before drilling begins	NAME	ADDRESS	Robt. J. Muncy	Box 283 Gilbert, West Virginia 301 First Ave.	Robt. L. Morgan	Ripley, West Virginia P. O. Box 261	C. E. Mayberry	Kingwood, West Virginia
NAME	ADDRESS								
Robt. J. Muncy	Box 283 Gilbert, West Virginia 301 First Ave.								
Robt. L. Morgan	Ripley, West Virginia P. O. Box 261								
C. E. Mayberry	Kingwood, West Virginia								

The names and post office addresses of the owners of the tracts of land included on the plat or map accompanying the application are to be given below.

See attached list.

NOTE

A BOND FOR \$2,500 PAYABLE TO THE STATE OF MARYLAND MUST ACCOMPANY THE APPLICATION THIS APPLICATION FORM MUST BE FILLED OUT WITH TYPEWRITER OR IN BLOCK LETTERS

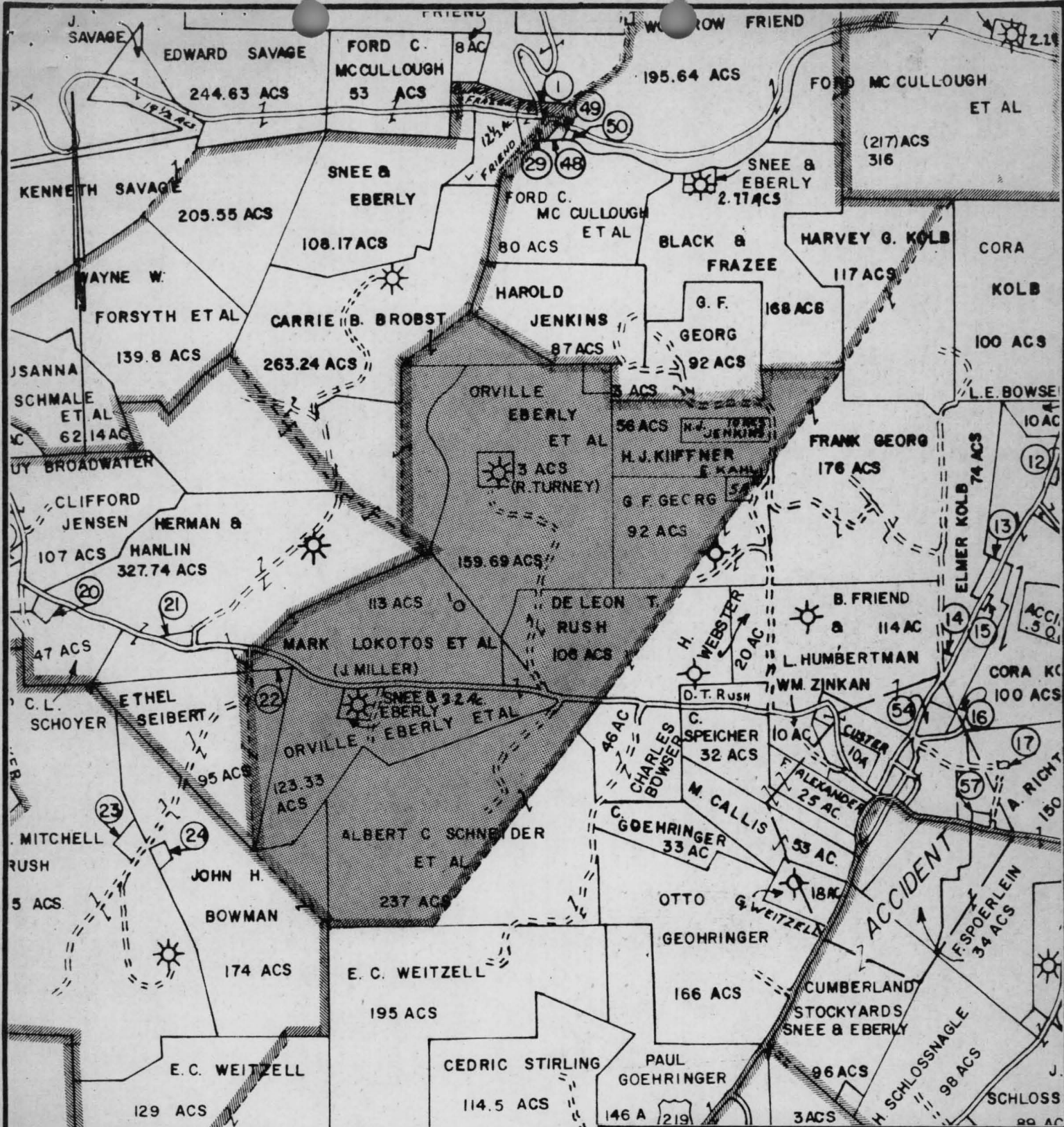

EARL CODDINGTON 50 ACS
 CARL W. SPITZNAS 50 ACS
 C.M. HARTIG ET AL 100 ACS
 E.C. WEITZELL 50 ACS
 E.C. WEITZELL 129 ACS
 E.C. WEITZELL 174 ACS
 JOHN H. BOWMAN 174 ACS
 G.C. SISLER 100 ACS
 CEDRIC STIRLING 114.5 ACS
 G.C. SISLER 256.94 ACS
 ADAM J. LUCAS 134 ACS
 GLEN KELLER 5 ACS
 LEYBI 5 ACS
 SPITZNAS 9.21 ACS

TEXAS EASTERN Transmission Corporation
 OIL DIVISION HOUSTON, TEXAS

JOHN MILLER UNIT

Accident Field Garrett County, Maryland

DESIGNED BY	DATE	CORRECTED BY	DATE
DRAWN BY	DATE	SIGNATURE OF APPROVAL	
CHECKED BY	DATE	PD	
SCALE 1" = 2000'	SHEET	OF	

I, J. D. Gaden, do hereby certify that this plat correctly reflects the data on this well unit as required by the State of Maryland.
 J. D. Gaden