

**STATE OF MARYLAND  
DEPARTMENT OF GEOLOGY, MINES AND WATER RESOURCES**

The Johns Hopkins University  
BALTIMORE 18, MARYLAND

**WELL COMPLETION REPORT**

*This report must be submitted within 30 days after completion of the well*

**WELL DESCRIPTION**

WELL LOG		CASING AND SCREEN RECORD			Permit Number <u>6272</u>
State the kind of formations penetrated, their depth, their thickness, and if water-bearing		State the kind and size of casing, liner, shoe, screen, and other accessories (if no casing used, give diameter of well)			Name of Owner
GW-1502, Norris K. Welch #1 Drilled deeper record	FEET from.....to.....		DIAM. (inches)	FEET from.....to.....	Columbian Carbon Co.....
Old T.D. 2869' Chert-top <u>2834'</u> O.D. 11-8-51 to 11-15-51		Pulled 2882'11" of 2-3/8" tubing before drilling deeper and re-ran this amount plus 106' additional when completed, making a total of 2988'11" now in well			PUMPING TEST Hours Pumped..... Pumping Rate Gallons per Minute.....
Chert 2869 - 2895 Shale 2895 - 2953 Oriskany Sand <u>2953</u> - 2977'		When tubed and shut in gas gauged 23/10 M. 7" 23# 7,556,000 cu. ft.			WATER LEVEL Distance from land surface to water: Before Pumping.....Ft. When Pumping.....Ft.
D.D. total depth - - - 2977'		Drilled deeper pays: 2955' 16/10 W. 7" 23# 1,708 MCF 2959' 29/10 M. 7" 23# 8,482 MCF 2963' 19/10 M. 7" 23# 6,863 MCF			APPEARANCE OF WATER Clear..... Cloudy..... Taste..... Odor.....
					Height of Casing Above Land Surface ..... Ft.
					PUMP Type..... Capacity Gallons per Minute..... Gallons per Hour..... Pump Column Length..... Ft.
					REMARKS Drilled deeper to 24' in Oriskany Sand
					Well Was Completed Date..... 11-15-51
					Well Driller Gene Campbell Signature

STATE OF MARYLAND  
DEPARTMENT OF GEOLOGY, MINES AND WATER RESOURCES

The Johns Hopkins University  
BALTIMORE 18, MARYLAND

WELL COMPLETION REPORT

This report must be submitted within 30 days after completion of the well

WELL DESCRIPTION

WELL LOG

State the kind of formations penetrated, their depth, their thickness, and if water-bearing

CASING AND SCREEN RECORD

State the kind and size of casing, liner, shoe, screen, and other accessories (if no casing used, give diameter of well)

Permit Number 6272

Name of Owner  
Columbian Carbon Co

PUMPING TEST

Hours Pumped.....  
Pumping Rate  
Gallons per Minute.....

WATER LEVEL

Distance from land surface to water:  
Before Pumping.....Ft.  
When Pumping.....Ft.

APPEARANCE OF WATER

Clear.....gas well  
Cloudy.....  
Taste.....  
Odor.....

Height of Casing Above Land Surface .....Ft.

PUMP

Type.....  
Capacity  
Gallons per Minute.....  
Gallons per Hour.....  
Pump Column Length.....Ft.

REMARKS

Gas Well. Tubed and shut in 9-26-50. Well was not shot.

Well Was Completed  
Date.....9-26-50  
Well Driller W. S. Moore

Signature

GW-1502, Norris K. Welch, et al  
#1 gas well-drilled by  
Columbian Carbon Company

	FEET	FEET
	from.....to.....	depth set
Sand	0 - 5	68'
Lime Rock	5 - 66	
Slate & Shells	66 - 290	
Lime	290 - 360	
Slate & Shells	360 - 416	
Lime	416 - 440	
Slate & Shells	440 - 1590	
670'SLM-675'DLM		
Lime	1590 - 1612	
Slate & Shells	1612 - 2005	
Brown Shale	2005 - 2282	
Lime Shells	2282 - 2290	
Brown Shale	2290 - 2377	
Slate & Shells	2377 - 2753	
Blue Shale	2753 - 2772	
Black Shale	2772 - 2834	
Lime	2834 - 2869	
2834'DLM-2816'SIM		

Total depth - - 2869'

Well spudded 8-7-50  
Well completed drilling 9-25-50  
Tubed and shut in 9-26-50  
Show of gas at 2834'

Gas Pays:  
2835-2869' 26/10 M. 7" 23# 8,029,000 cu. ft.  
7 hour rock pressure 1610#

K.P. Mc

13-3/8" drive pipe  
10-3/4" 40# casing  
w/ midget bottom  
hole packer  
7" 23# casing w/  
7" casing shoe  
7" Gas Anchor packer set at  
2-3/8" 4# tubing  
Fresh water at 40' 3-11" blr/hr  
Fresh water 118-124' 5-11" blrs/hr.

DIAM. (inches)	FEET
	from.....to.....
68' 5"	68'
680' 7"	670' SLM
2865' 2"	2846' DLM
2882' 11"	2150'

STATE OF MARYLAND  
DEPARTMENT OF GEOLOGY, MINES AND WATER RESOURCES -

The Johns Hopkins University  
BALTIMORE 18, MARYLAND

10/20/74: Purchased by  
Robert R. Price

Oakland (Oakland)

Well:

APPLICATION FOR PERMIT TO DRILL WELL

An application must be submitted and permit received before drilling a well

Norris K. Welch #1

Owner Columbian Carbon Company

Driller Wendell S. Moore

Street or R. F. D. Box 873

Street or R. F. D. Box 873, Charleston 23, W. Va.  
Post Office

Post Office Charleston 23, W.

Date July 12, 1950

Quantity of Water Needed (G. P. M.) -

Location of Well

Use for Water for drilling purposes

County Garrett County

Approximate Depth of Well (feet) 5000'

Nearest Town Mountain Lake Park

Method of Drilling to be used Cable Tools

Distance from Town 1 1/2 miles

Direction from Town Southwest

PERMIT TO DRILL WELL

(Permit to be returned to Driller)

NOT TO BE FILLED IN BY DRILLER

Permit No. 6272

Samples of Cuttings Required by Department  Yes  No

Owner Requires Permit to Appropriate Water  Yes  No

Owner Has Permit to Appropriate Water  Yes  No

The applicant is herewith granted a permit to drill this well subject to the conditions stipulated.

*John T. Siegel*  
Director

Date July 17, 1950.

Special conditions that may apply:

~~Cuttings samples desired from every 10-foot depth interval. Sample sacks being sent under separate cover.~~

Description of Location of Well

(This information should be definite enough to permit locating well on a county map)

Near what road U. S. Route #219

On which side of road East  
(North, East, South, West)

Distance from road about 3500'

Draw a sketch below showing location of well in relation to nearby towns, roads and streams with north in the direction of the arrow.

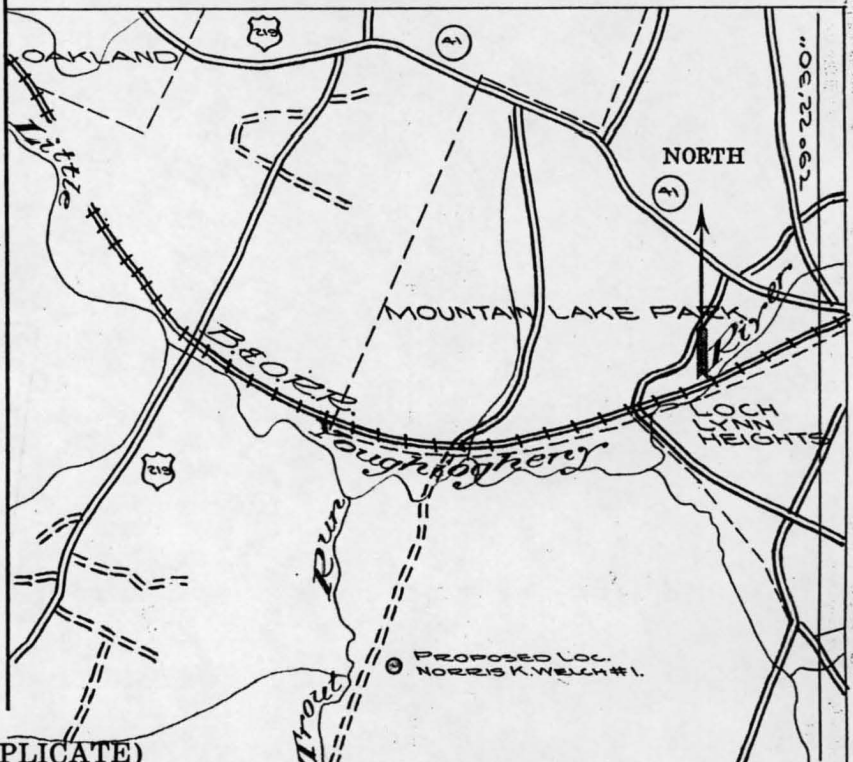

(DUPLICATE)

SCALE: 1" = 2000'