

STATE OF MARYLAND
MARYLAND GEOLOGICAL SURVEY
 The Johns Hopkins University
 BALTIMORE, MARYLAND 21218

Permit Number 95
 Well Number 4
 Company TETCO
 County Garrett

COMPLETION REPORT
 (oil or gas well)

This report must be submitted within 30 days after completion of the well

WELL DESCRIPTION - KIND OF WELL: Gas (Storage)
 (Oil, Gas, Other)

| NAME & WELL NO. <u>USA - Savage River #4</u> | Size of Casting and Tubing | Used in Drilling | Left in Well | Packers: Type, Size and Depth |
|--|---|------------------|--------------|---|
| ELEVATION: <u>GR 2760</u> LEASE: _____ | 13-3/8" | 267' | 267' | None |
| DRILLING COMMENCED: <u>5-31-72</u> DRILLING COMPLETED: <u>7-10-72</u> | 9-5/8" | 4032' | 4032' | None |
| PRODUCTION: _____ | 7" | 7900' | 7900' | None |
| RESERVOIR PRESSURE _____ psig _____ hrs. | 2-3/8" | | 7876' | None |
| WELL TREATMENT: (Shooting, Acidizing, Fracturing, Etc.) <u>Oriskany, Open Hole 7876-8122'</u> | | | | |
| <u>Acidized w/15,000 gals 15% HCL + 5000 gals 15%</u> | | | | PERFORATIONS AT: 7709-13, 7715-24 7728-32, 7734-37 7739-43, 7751-53, 7766-68, 7774-81, 7783-90, 7805-09, & 7816-21; Open Hole 7876-8122' |
| <u>MCA. Reacidized w/30,000 gals 15% HCL.</u> | | | | |
| <u>Acidized Chert perforations w/5,000 gals 10%</u> | | | | |
| <u>MCA. Reacidized w/40,000 gals 10% HCL</u> | | | | |
| <u>w/19,500 + 20-40 sand.</u> | | | | |
| RESERVOIR PRESSURE AFTER TREATMENT: _____ | CEMENTING DATA: (Size Pipe, Depth, No. Bags, Date) | | | |
| | 13-3/8", 267', 300 sx + 2% CaCl 6-3-72 | | | |
| | 9-5/8", 4032', 1250 sx 6-19-72 | | | |
| | 7", 7900', 1st stage 370 sx around bottom | | | |
| | 2nd stage 1310 sx thru DV tool | | | |
| | @ 6976', 7-3-72 | | | |
| RESULTS AFTER TREATMENT: <u>Well tested</u> | | | | |
| <u>4,153 MCFD 10-10-72</u> | | | | |
| REMARKS: | GEOPHYSICAL LOGS (Type of Geophysical Logs Run on Well) | | | |
| | Formation Density Gamma Ray-Neutron | | | |

State of Maryland
MARYLAND GEOLOGICAL SURVEY
The Johns Hopkins University
Baltimore, Maryland 21218

? Accident well 95
Chas. Sawyer Unit
TD 8122
gas storage

Compl
July 72

APPLICATION FOR PERMIT TO DRILL OIL OR GAS WELL

(Applications must be submitted in triplicate)

USA - Savage River #4

OWNER Texas Eastern Transmission Corporation

STREET or R.F.D. _____

POST OFFICE P. O. Box 2521

Houston, Texas 77001

PERMIT TO DRILL WELL

NOT TO BE FILLED IN BY APPLICANT

PERMIT NO. Ninety Five - 95

The permit is herewith granted subject to the conditions stipulated.

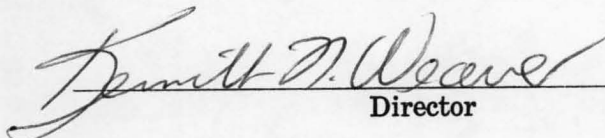
Director

Date September 8, 1971

Special conditions that may apply:

GAS STORAGE WELL ONLY

NAMES OF DRILLERS MUST BE FURNISHED PRIOR TO DRILLING OF WELL.

LOCATION OF WELL

COUNTY Garrett

NEAREST POST OFFICE Accident, Maryland

Distance from Post Office 8752.69'

Direction from Post Office S 85° 42' 06" E

APPROXIMATE DEPTH OF WELL (feet) 8,025'

METHOD OF DRILLING Rotary (Air)

DEEPEST GEOLOGIC FORMATION
WELL WILL BE DRILLED into Definite Helderberg

DISTANCE OF WELL LOCATION
TO NEAREST BUILDING (feet) No Building
within 1500' of well.

NUMBER OF SHIFTS PER DAY Three

LICENSED DRILLER IN CREW OF EACH SHIFT
NAME ADDRESS

TO BE FURNISHED _____

These names may be supplied later but before drilling begins

The names and post office addresses of the owners of the tracts of land included on the plat or map accompanying the application are to be given below.

SEE ATTACHED LIST

NOTE

A BOND FOR \$2,500 PAYABLE TO THE STATE OF MARYLAND MUST ACCOMPANY THE APPLICATION
THIS APPLICATION FORM MUST BE FILLED OUT WITH TYPEWRITER OR IN BLOCK LETTERS

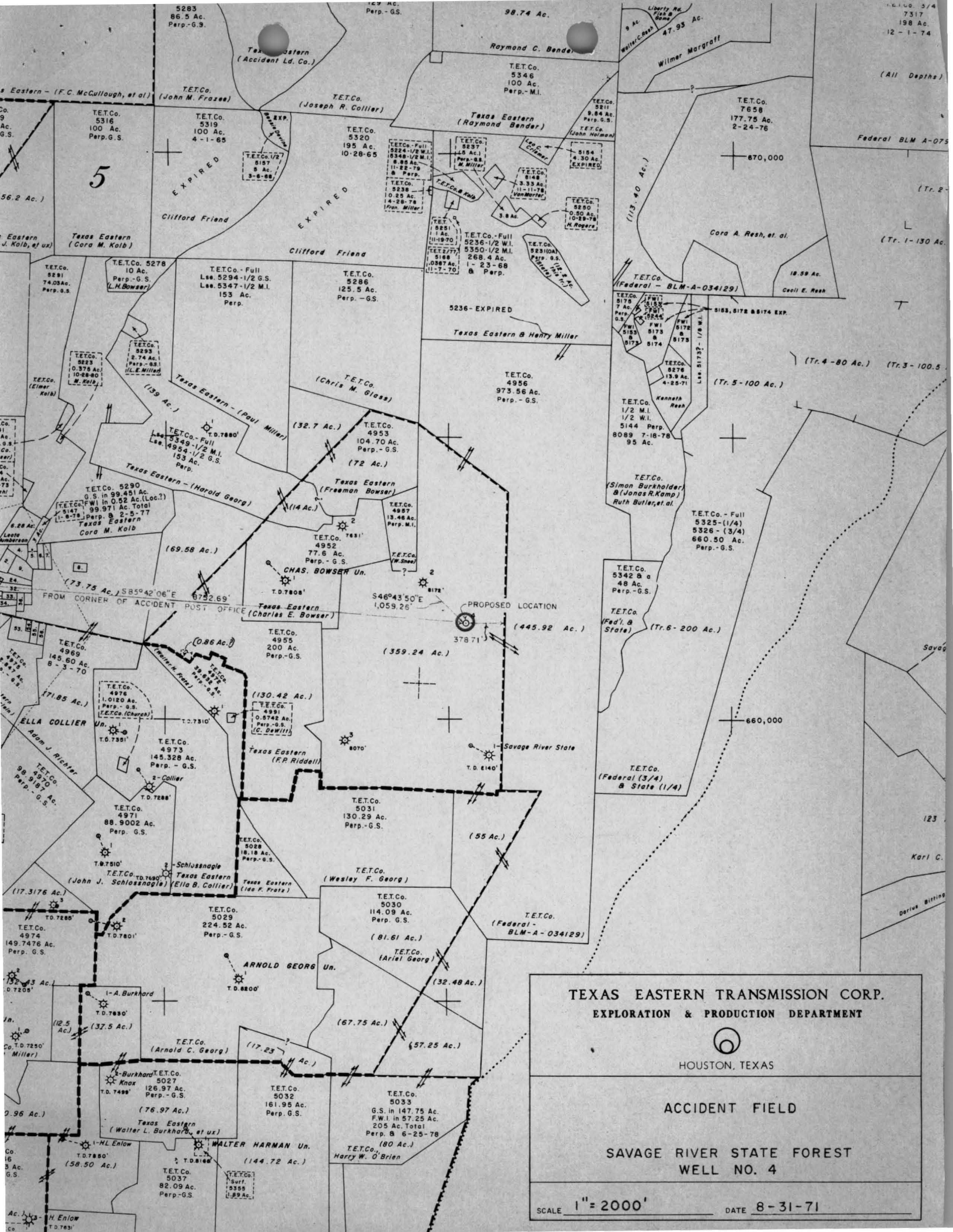

TEXAS EASTERN TRANSMISSION CORP.
 EXPLORATION & PRODUCTION DEPARTMENT

 HOUSTON, TEXAS
 ACCIDENT FIELD
 SAVAGE RIVER STATE FOREST
 WELL NO. 4
 SCALE 1" = 2000'
 DATE 8-31-71