



## MARYLAND GEOLOGICAL SURVEY

The Johns Hopkins University  
BALTIMORE, MARYLAND 21218

## GEOLOGICAL LOG

FORMATION	TOP	BOTTOM	GAS AT	OIL AT	WATER AT (Fresh or Salt Water)	REMARKS
Tully Lms.	6957'	6972'				Chert-measure gas, natural @ 300 MCFGD between 7814' & 7834' and @ 7922 well flowed gas natural @ 1,000 MCFGD.  Oriskany gas Natural - @ 7950' - 200 MCFGD @ 8070' - 720 MCFGD
Onondaga Lms.	7756'	7780'				
Huntersville Chert	7784'	7881'				
Needmore Shale	7881'	7912'				
Oriskany Ss.	7921'	8068'				
Helderberg Lms.	8068'					
Total Depth	8070'	Drillers Measurements				

This completion report is accurate to the best of my knowledge.

Date November 24, 1969APPROVED *Dale B. ...*By Production Manager  
(Title)COMPANY Texas Eastern Transmission Corp.

State of Maryland  
MARYLAND GEOLOGICAL SURVEY  
The Johns Hopkins University  
Baltimore, Maryland 21218

comp 11-2469 90

APPLICATION FOR PERMIT TO DRILL OIL OR GAS WELL

(Applications must be submitted in triplicate)

USA - Savage River State Forest, Well #3

OWNER Texas Eastern Transmission Corporation

LOCATION OF WELL

STREET or R.F.D. P. O. Box 2521

COUNTY Garrett

POST OFFICE Houston, Texas 77001

NEAREST POST OFFICE Accident, Maryland

Distance from Post Office 7,152.95'

Direction from Post Office S 67° 20' 40" E

PERMIT TO DRILL WELL

NOT TO BE FILLED IN BY APPLICANT

PERMIT NO. 90 - Ninety

APPROXIMATE DEPTH OF WELL (feet) 7975'

The permit is herewith granted subject to the conditions stipulated.

METHOD OF DRILLING Rotary

DEEPEST GEOLOGIC FORMATION  
WELL WILL BE DRILLED Into Definite Helderberg

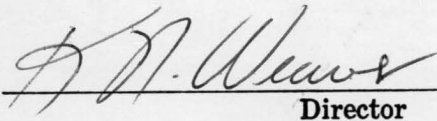
  
Director

DISTANCE OF WELL LOCATION  
TO NEAREST BUILDING (feet) No Buildings

Within 1500' of Location

Date April 14, 1969

NUMBER OF SHIFTS PER DAY \_\_\_\_\_

Special conditions that may apply:

"GAS STORAGE WELL ONLY"

LICENSED DRILLER IN CREW OF EACH SHIFT

NAME

ADDRESS

Names of Drillers must be furnished  
prior to drilling of well

~~To be~~ Furnished E. G. Davis

6/10/69

J. K. Eastwood

J. Hyatt

These names may be supplied later but before drilling begins

The names and post office addresses of the owners of the tracts of land included on the plat or map accompanying the application are to be given below.

NOTE

A BOND FOR \$2,500 PAYABLE TO THE STATE OF MARYLAND MUST ACCOMPANY THE APPLICATION  
THIS APPLICATION FORM MUST BE FILLED OUT WITH TYPEWRITER OR IN BLOCK LETTERS

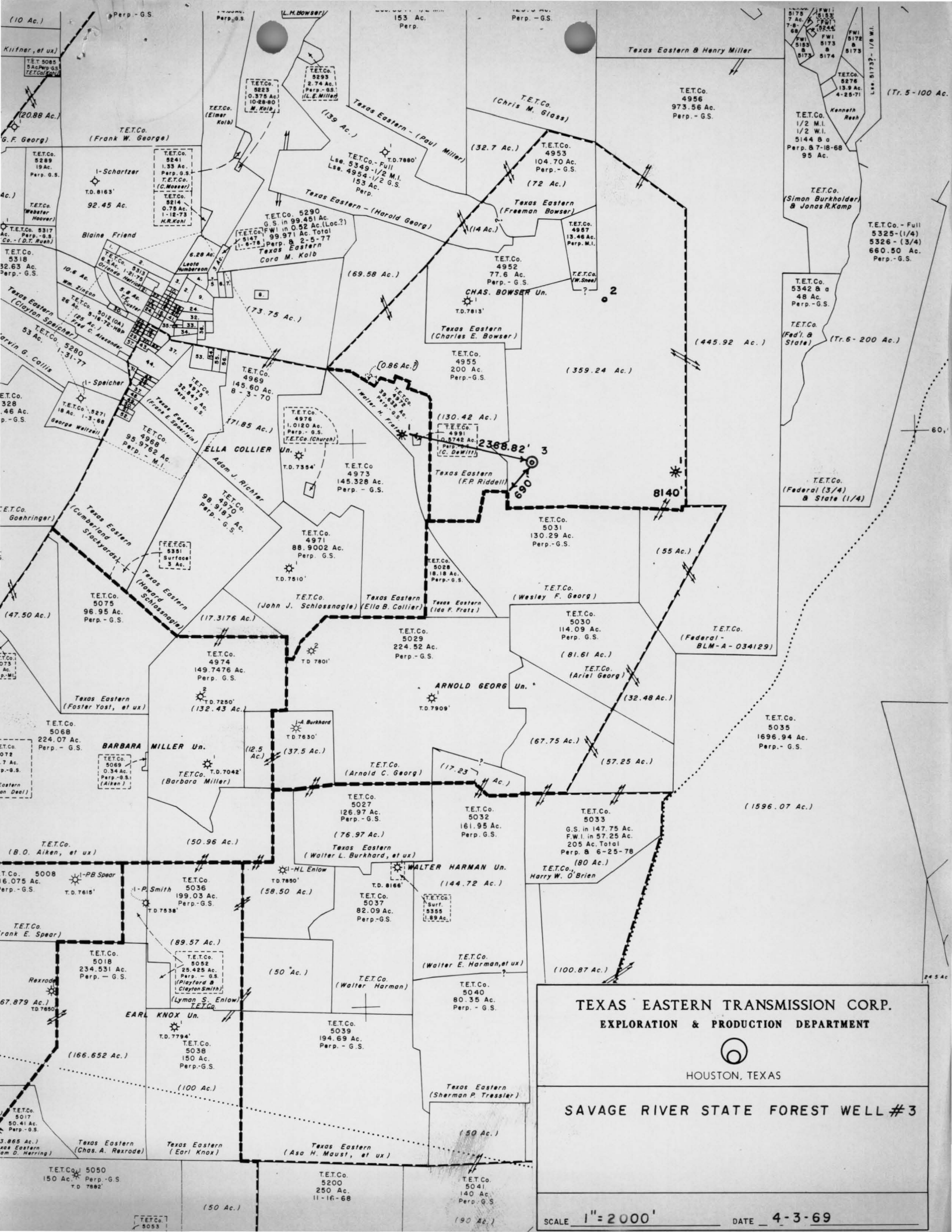

**TEXAS EASTERN TRANSMISSION CORP.**  
**EXPLORATION & PRODUCTION DEPARTMENT**

HOUSTON, TEXAS

**SAVAGE RIVER STATE FOREST WELL #3**

SCALE 1" = 2000'      DATE 4-3-69