

STATE OF MARYLAND
MARYLAND GEOLOGICAL SURVEY
 The Johns Hopkins University
 BALTIMORE, MARYLAND 21218

Permit Number 59
 Well Number 1
 Texas Eastern Transmission
 Company
 Corporation
 County Garrett

COMPLETION REPORT
 (oil or gas well)

This report must be submitted within 30 days after completion of the well

WELL DESCRIPTION - KIND OF WELL: Gas Storage
 (Oil, Gas, Other)

Texas Eastern Transmission Corporation's NAME & WELL NO. <u>CHARLES A. REXRODE, NO. 1</u>	Size of Casing and Tubing	Used in Drilling	Left in Well	Packers: Type, Size and Depth
ELEVATION: <u>2623'</u> LEASE: <u>C. A. REXRODE</u>	13 3/8"	132'	132'	NONE
DRILLING COMMENCED: <u>12/9/65</u> DRILLING COMPLETED: <u>1/15/66</u>	9 5/8"	3654'	3654'	NONE
PRODUCTION: <u>Gas</u>	7"	7534'	7534'	NONE
RESERVOIR PRESSURE <u>1410</u> psig <u>24</u> hrs.	2 3/8"	7557'	7557'	NONE
WELL TREATMENT: (Shooting, Acidizing, Fracturing, Etc.)				
NONE				PERFORATIONS AT: NONE
DATE	CEMENTING DATA: (Size Pipe, Depth, No. Bags, Date)			
	SIZE	WT & GRADE	DEPTH	CEMENT
12/11/65	13 3/8"	48# H-40	132'	150 sx Com Cement to Surface.
12/23/65	9 5/8"	36# J-55	3654'	552 sx 20% Diacel & 200 sx Common Cement ret to Sur.
1/10/66	7"	29# N-80	7534'	First Stage 50 sx 50-50 Pos A and 80 sx Common-Open D.V. Tool Cement to Surface Second Stage Through D.V. Tool at 6890' w/1050 sx. 50-50 Pos A 2% GEL. Lost returns while displacing plug
RESERVOIR PRESSURE AFTER TREATMENT: _____				
RESULTS AFTER TREATMENT: _____				
REMARKS: Gas Storage Well	GEOPHYSICAL LOGS (Type of Geophysical Logs Run on Well) Formation - Density Log Gamma Rag - Neutron			

MARYLAND GEOLOGICAL SURVEY
 The Johns Hopkins University
 BALTIMORE, MARYLAND 21218

GEOLOGICAL LOG

FORMATION	TOP	BOTTOM	GAS AT	OIL AT	WATER AT (Fresh or Salt Water)	REMARKS
BENSON SAND	3532	3608				
TULLY LIME	6674	6701				
ONONDAGA LIME	7364	7390				
HUNTERSVILLE CHERT	7390	7485				
NEEDMORE SHALE	7485	7521				
ORISKANY SAND	7521	7640	7568' 7599' 7629' 7640'			
HELDERBERG LIME	7640	-				T. D. 7650 Driller T. D. 7642 Logger Well completed open hole in Oriskany

This completion report is accurate to the best of my knowledge.

Date March 1, 1966

APPROVED

By Chief Production Clerk
(Title)

COMPANY Texas Eastern Transmission Corp.

State of Maryland
MARYLAND GEOLOGICAL SURVEY
The Johns Hopkins University
Baltimore, Maryland 21218

Blanket Bond
12/1/20
59

APPLICATION FOR PERMIT TO DRILL OIL OR GAS WELL
(Applications must be submitted in triplicate)

 CHARLES A REXRODE, WELL #1

 OWNER Texas Eastern Transmission Corporation LOCATION OF WELL
 STREET or R.F.D. P. O. Box 2521 COUNTY Garrett
 POST OFFICE Houston, Texas 77001 NEAREST POST OFFICE Accident, Maryland
 Distance from Post Office 12.150'
 Direction from Post Office _____
 S 10° 00' W
 PERMIT TO DRILL WELL
 NOT TO BE FILLED IN BY APPLICANT
 APPROXIMATE DEPTH OF WELL (feet) 7650'
 PERMIT NO. 59 (Fifty-nine) METHOD OF DRILLING Rotary
 The permit is herewith granted subject to the conditions stipulated.
 DEEPEST GEOLOGIC FORMATION WELL WILL BE DRILLED Oriskany
 DISTANCE OF WELL LOCATION TO NEAREST BUILDING (feet) 697'
 Date December 17, 1965
 NUMBER OF SHIFTS PER DAY Three
 Special conditions that may apply:
"Gas storage well only"
 LICENSED DRILLER IN CREW OF EACH SHIFT
 NAME ADDRESS
Raymond E. King (4812) War, W. Virginia
DeForest Johnston (4813) New Martinsville, W. Va.
Wm. A. Weekley (4814) Accident, Maryland
 These names may be supplied later but before drilling begins

The names and post office addresses of the owners of the tracts of land included on the plat or map accompanying the application are to be given below.

See Attached List

NOTE

A BOND FOR \$2,500 PAYABLE TO THE STATE OF MARYLAND MUST ACCOMPANY THE APPLICATION THIS APPLICATION FORM MUST BE FILLED OUT WITH TYPEWRITER OR IN BLOCK LETTERS

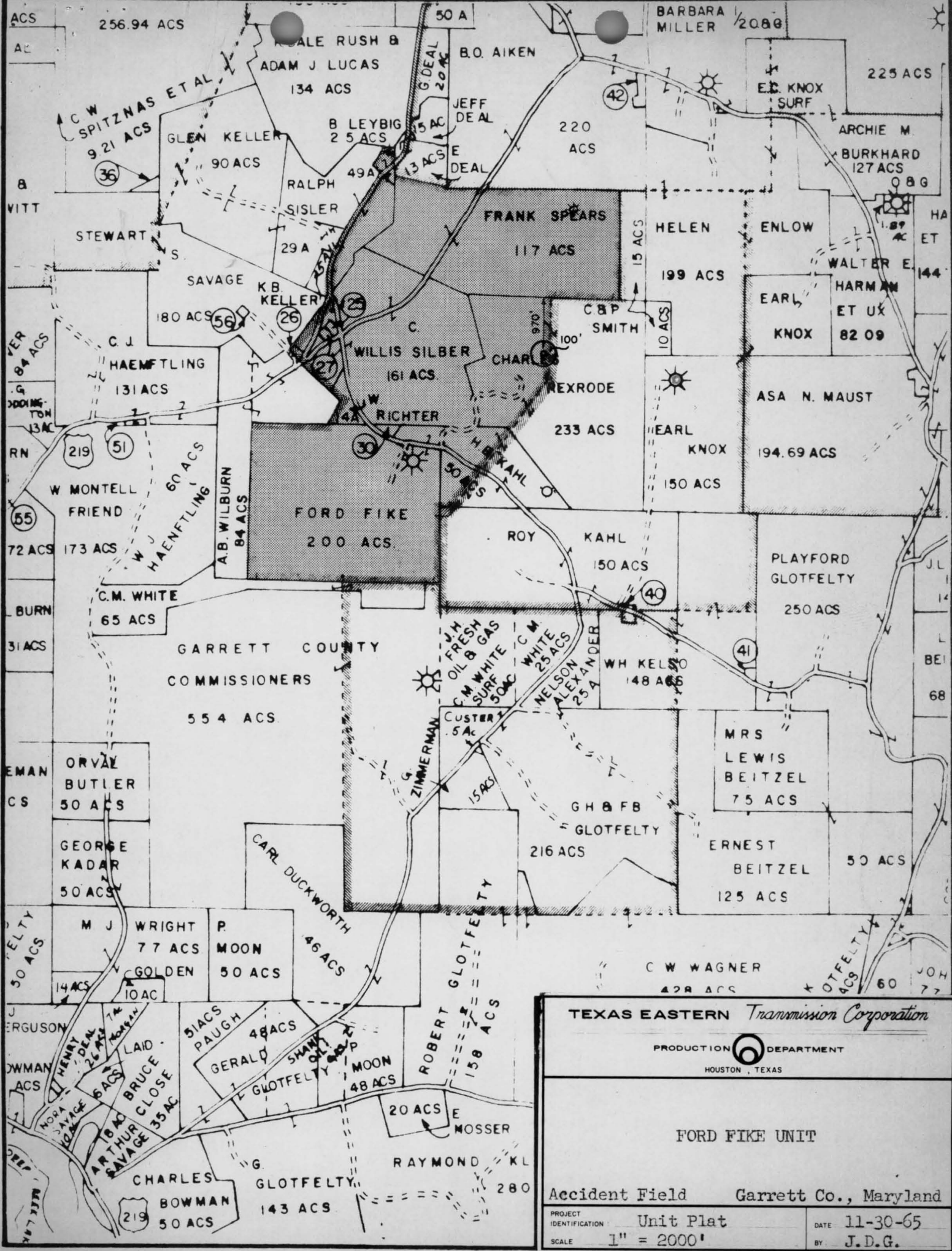

TEXAS EASTERN *Transmission Corporation*

PRODUCTION DEPARTMENT
HOUSTON, TEXAS

FORD FIKE UNIT

Accident Field Garrett Co., Maryland

PROJECT IDENTIFICATION	Unit Plat	DATE	11-30-65
SCALE	1" = 2000'	BY	J.D.G.